

JOYTUTUS 8 Gang Switch Panel

JOYTUTUS Wireless RGB 8 Gang Switch Panel Instruction Manual

Model: 8 Gang Switch Panel

1. PRODUCT OVERVIEW

The JOYTUTUS Wireless RGB 8 Gang Switch Panel is a universal circuit control relay system designed to manage up to eight auxiliary electrical devices in vehicles such as trucks, boats, UTVs, SUVs, and pickups. It features wireless control, customizable RGB lighting, and multiple operating modes for enhanced functionality and convenience.

3. PACKAGE CONTENTS

The following components are included in your JOYTUTUS Wireless RGB 8 Gang Switch Panel kit:

- Wireless 8 Gang Switch Panel
- Circuit Control Box (Fuse Box)
- Circuit Breaker (100A)
- Positive and Negative Pole Harnesses
- USB Charging Cable
- Antenna and Adhesive
- Zip Ties (10x)
- Screwdriver
- Fuse Link Wire (Green)
- Screw Sets
- Spare Brackets (for control box and switch panel)
- 140 Customizable Stickers
- Instruction Manual

4. INSTALLATION GUIDE

This section provides detailed steps for installing your switch panel system. For a visual guide, please refer to the installation video below.

4.1 Control Box Mounting

1. Select a suitable location in your vehicle's engine bay for the circuit control box. Ensure it is away from moving parts and excessive heat.
2. Attach the appropriate mounting bracket to the control box using the provided screws. For Wrangler JL (2018-2023) models, a dedicated bracket is included that requires no additional drilling. Universal brackets are also provided for other vehicles.
3. Secure the control box with its bracket to the chosen location in the engine bay.

EXCLUSIVE MOUNTING BRACKET FOR CONTROL BOX

FOR WRANGLER JL 2018-2023

(No Drilling Required)



FOR UNIVERSAL MODEL

(2 Ways)

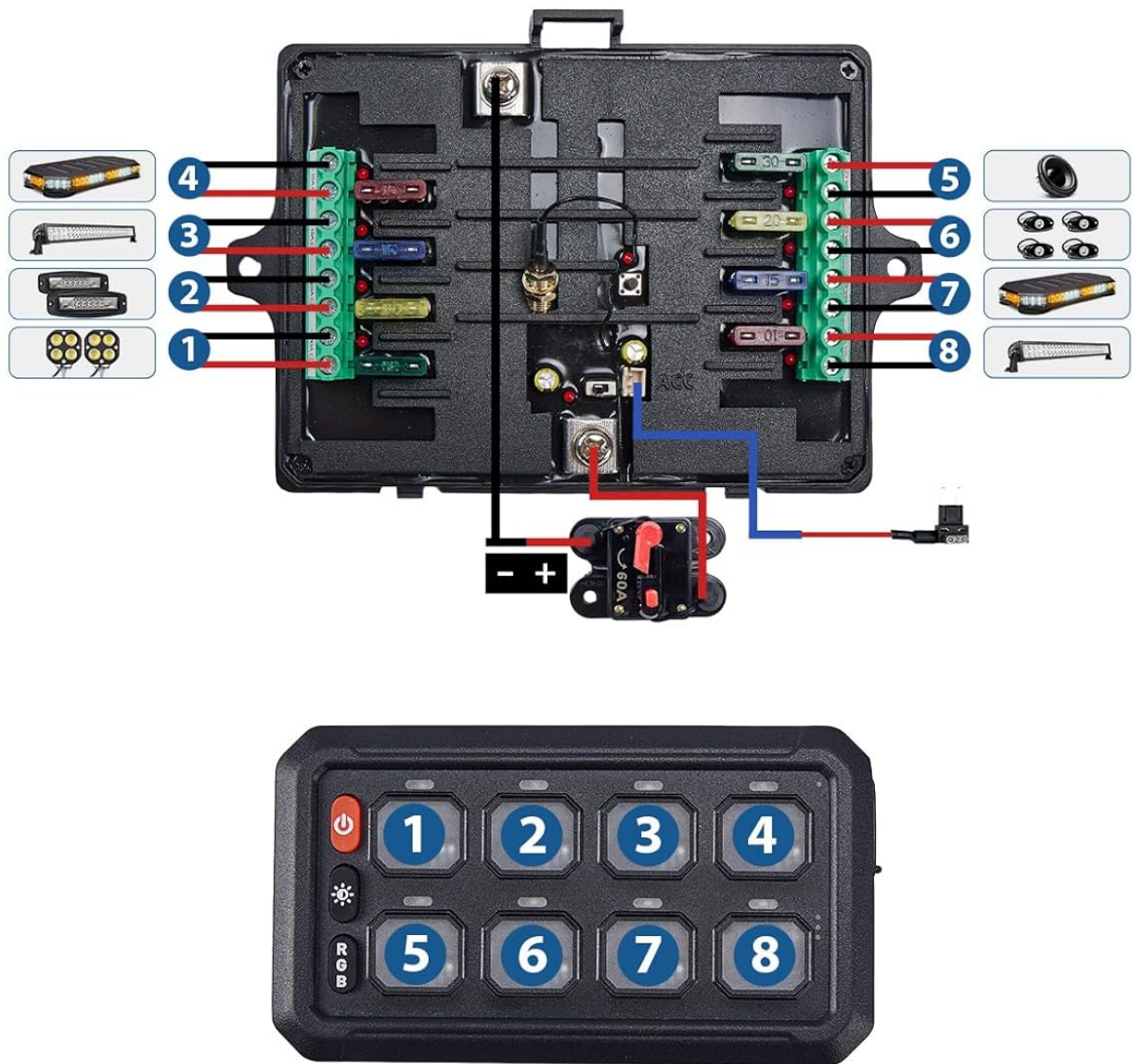

Image 4.1: Various mounting brackets for the control box, including a specific one for Wrangler JL models.

4.2 Wiring Connections

Refer to the wiring diagram for proper connection of the control box to your vehicle's electrical system and accessories.

WIRING METHOD



2x30A	2x20A	2x15A	2x10A
-------	-------	-------	-------

Image 4.2: Wiring diagram illustrating connections for the control box and individual circuits.

1. Connect the positive (+) terminal of the control box to the positive terminal of your vehicle's battery using the provided positive pole harness.
2. Connect the negative (-) terminal of the control box to the negative terminal or a suitable ground point on your vehicle's chassis using the provided negative pole harness.
3. Install the 100A circuit breaker between the positive terminal of the battery and the control box for overcurrent protection.
4. Connect the ACC (Accessory) wire from the control box to an ignition-switched power source using the fuse link wire. This ensures the panel powers on and off with the vehicle's ignition.

5. Connect your auxiliary lights or other electrical devices to the corresponding output terminals on the control box. Each output is individually fused.
6. Connect the antenna to the designated port on the control box. Position the antenna for optimal signal reception.

4.3 Switch Panel Installation

The switch panel can be installed in various locations within your vehicle's cabin. Two common methods are:

1. **Method 1 (Surface Mount):** Attach the switch panel mounting bracket to a flat surface using screws. Then, slide the switch panel onto the bracket.
2. **Method 2 (Flush Mount):** Use the flush mount bracket to integrate the switch panel into a dashboard opening or other custom location.

UPGRADED VERSION 140 STICKERS

140 stickers for all your needs



SWITCH PANEL INSTALLATION

Way 1



Way 2



Image 4.3: Customizing the switch panel with stickers and two installation methods.

4.4 Installation Video

Your browser does not support the video tag.

Video 4.1: Official JOYTUTUS installation and feature demonstration video for the Wireless RGB 8 Gang Switch Panel.

5. OPERATING INSTRUCTIONS

The wireless switch panel provides intuitive control over your connected accessories.

5.1 Basic Operation

- **Power Button:** Press the red power button to turn the entire switch panel ON or OFF. The panel features a memory function that recalls the last setting when powered on.
- **Individual Switches:** Each of the eight buttons controls a separate circuit. Press a button to activate or deactivate the connected accessory.



SPECIFICATION

Voltage	Power	Maximum Current	Operating Temperature
12V/24V DC	720W at 12V 1440W at 24V	80A	- 40°C ~ + 85°C

Image 5.1: The switch panel mounted on a dashboard, demonstrating its compact design and accessible controls.

5.2 Brightness and Color Adjustment

- **Brightness Adjustment:** Use the dedicated brightness button (sun icon) to cycle through 5 levels of backlight brightness for the switch panel. This allows adaptation to different ambient light conditions.
- **RGB Color Switching:** Press the RGB button to cycle through 8 different backlight colors (white, red, blue, etc.) for the switch panel.

5 LEVELS OF BRIGHTNESS ADJUSTMENT



8 Light Colors Adjustable



Image 5.2: Visual representation of the switch panel's 5-level brightness and 8 color options.

5.3 Lighting Modes

The switch panel supports three distinct lighting modes for connected accessories:

- **Toggle (Constant Light):** Standard ON/OFF operation, providing continuous power to the accessory.
- **Momentary (Ignition Power):** Activates the accessory only while the button is pressed, suitable for horns or temporary functions.
- **Pulsed (Strobe Mode):** Causes the connected accessory to flash, ideal for warning lights or emergency signals.

These modes can be customized for individual switches to suit specific needs.

3 LIGHTING MODES



Toggle
Constant Light

Momentary
Ignition Power



Pulsed
Strobe Mode

Image 5.3: Examples of accessories operating in Toggle, Momentary, and Pulsed modes.

6. MAINTENANCE

- Regularly inspect all wiring connections for tightness and corrosion.
- Check fuses periodically and replace any blown fuses with ones of the correct amperage. Spare fuses are included in the kit.
- Keep the control box and switch panel clean and free from dust and debris. Use a soft, dry cloth for cleaning.
- Ensure the antenna is securely connected and not obstructed for optimal wireless performance.

7. TROUBLESHOOTING

- **No Power to Switch Panel:** Check the main circuit breaker and all power connections to the control box. Ensure the vehicle's ignition is on if the ACC wire is connected.
- **Accessory Not Working:** Verify the individual fuse for the corresponding circuit in the control box. Check the wiring connection from the control box to the accessory.
- **Intermittent Wireless Connection:** Ensure the antenna is securely connected and positioned correctly. Check for any potential sources of interference.
- **Switch Panel Backlight Issues:** If the backlight is not functioning correctly, check the brightness and RGB color settings.

8. SPECIFICATIONS



Feature	Specification
Working Voltage	DC 12-24V
Maximum Current	80A
Maximum Rated Power (12V)	720W
Maximum Rated Power (24V)	1440W
Working Temperature	-40°C to +85°C (-104°F to +185°F)
Brightness Levels	5-level dimmable
RGB Colors	8 colors (white, red, blue, etc.)
Lighting Modes	Toggle (Constant), Momentary, Pulsed (Strobe)
Protection Features	Reverse polarity, overcurrent, overvoltage, overheating
Control Type	Wireless



9. WARRANTY AND SUPPORT

JOYTUTUS products are designed for durability and performance. For warranty information, technical support, or any questions regarding your Wireless RGB 8 Gang Switch Panel, please contact JOYTUTUS customer service through the retailer where the product was purchased or visit the official JOYTUTUS website. Please retain your proof of purchase for warranty claims.

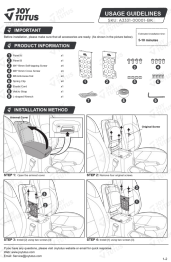
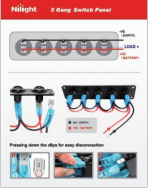
© 2025 JOYTUTUS. All rights reserved.

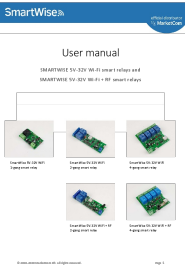
Related Documents - 8 Gang Switch Panel

	<p>Joytutus Vehicle Armrest Cover Installation Guide - Model A3331-00001-BK</p> <p>Step-by-step installation guide for the Joytutus vehicle armrest cover (SKU: A3331-00001-BK), including parts list and application scenarios for Wrangler JL and Gladiator JT.</p>
	<p>Nilight 5 Gang Switch Panel Installation and Wiring Guide</p> <p>A guide to installing and wiring the Nilight 5 Gang Switch Panel, including wiring diagrams and disconnection instructions.</p>
	<p>MICTUNING P1s APP Control Switch Panel User Manual</p> <p>Detailed user manual for the MICTUNING P1s APP Control Switch Panel. Covers installation guides for switch panels and control boxes, comprehensive wiring diagrams for 8-gang and 12-gang configurations, fuse block specifications, control mode settings (Constant, Momentary, Strobe), Bluetooth app integration, backlight customization, and frequently asked questions. Essential guide for automotive accessory installation.</p>
	<p>SmartWise 5V-32V Smart Relays User Manual - Wi-Fi and RF Control</p> <p>Comprehensive user manual for SmartWise 5V-32V smart relays, covering Wi-Fi and Wi-Fi+RF models. Includes product overview, setup with eWeLink app, wiring instructions, operation modes, pairing procedures, and RF control.</p>

<div><p>3 STAR INDUSTRIES KAWASAKI KRX Polycarbonate Rear Panel Installation Guide</p><p>WARNING: Do not touch the rear panel or the rear panel assembly until the rear panel is properly installed. The rear panel is made of Lexan polycarbonate and is not to be touched or handled until it is properly installed. Do not touch the rear panel or the rear panel assembly until it is properly installed. Do not touch the rear panel or the rear panel assembly until it is properly installed.</p><p>DO NOT REMOVE PROTECTIVE PLASTIC FILM FROM THE REAR PANEL AT THIS TIME.</p><table><thead><tr><th>ITEM</th><th>QTY</th><th>DESCRIPTION</th></tr></thead><tbody><tr><td>1</td><td>1</td><td>REAR PANEL</td></tr><tr><td>2</td><td>1</td><td>REAR PANEL ASSEMBLY</td></tr><tr><td>3</td><td>1</td><td>REAR PANEL ASSEMBLY</td></tr></tbody></table><p>ATTACHMENT: KAWASAKI KRX POLYCARBONATE REAR PANEL INSTALLATION GUIDE</p></div>	ITEM	QTY	DESCRIPTION	1	1	REAR PANEL	2	1	REAR PANEL ASSEMBLY	3	1	REAR PANEL ASSEMBLY	<h3>Kawasaki KRX Polycarbonate Rear Panel Installation Guide - 3 Star Industries</h3> <p>Detailed installation instructions for the 3 Star Industries Polycarbonate Rear Panel designed for the Kawasaki KRX UTV. Includes parts list, step-by-step assembly, velcro placement guide, and important cleaning and care recommendations for the Lexan material.</p>
ITEM	QTY	DESCRIPTION											
1	1	REAR PANEL											
2	1	REAR PANEL ASSEMBLY											
3	1	REAR PANEL ASSEMBLY											
<div><p>BrightSource RGB Switch Panel Manual: Installation, Wiring, and Operation Guide</p><p>WARNING: Do not touch the RGB switch panel or the RGB switch panel assembly until the RGB switch panel is properly installed. The RGB switch panel is made of Lexan polycarbonate and is not to be touched or handled until it is properly installed. Do not touch the RGB switch panel or the RGB switch panel assembly until it is properly installed. Do not touch the RGB switch panel or the RGB switch panel assembly until it is properly installed.</p><p>DO NOT REMOVE PROTECTIVE PLASTIC FILM FROM THE RGB SWITCH PANEL AT THIS TIME.</p><table><thead><tr><th>ITEM</th><th>QTY</th><th>DESCRIPTION</th></tr></thead><tbody><tr><td>1</td><td>1</td><td>RGB SWITCH PANEL</td></tr><tr><td>2</td><td>1</td><td>RGB SWITCH PANEL ASSEMBLY</td></tr><tr><td>3</td><td>1</td><td>RGB SWITCH PANEL ASSEMBLY</td></tr></tbody></table><p>ATTACHMENT: BRIGHTSOURCE RGB SWITCH PANEL MANUAL: INSTALLATION, WIRING, AND OPERATION GUIDE</p></div>	ITEM	QTY	DESCRIPTION	1	1	RGB SWITCH PANEL	2	1	RGB SWITCH PANEL ASSEMBLY	3	1	RGB SWITCH PANEL ASSEMBLY	<h3>BrightSource RGB Switch Panel Manual: Installation, Wiring, and Operation Guide</h3> <p>Comprehensive guide for BrightSource RGB Switch Panels, covering installation, wiring diagrams for 6, 8, and 12-gang models, control modes, button functions, and frequently asked questions. Enhance your vehicle's electrical system with BrightSource.</p>
ITEM	QTY	DESCRIPTION											
1	1	RGB SWITCH PANEL											
2	1	RGB SWITCH PANEL ASSEMBLY											
3	1	RGB SWITCH PANEL ASSEMBLY											