

EUGAD B0CXPPMD8F

EUGAD Space-Saving Bathroom Column Cabinet

Model: B0CXPPMD8F

1. INTRODUCTION

Thank you for choosing the EUGAD Space-Saving Bathroom Column Cabinet. This manual provides detailed instructions for the safe assembly, operation, and maintenance of your new cabinet. Please read this manual thoroughly before beginning assembly and keep it for future reference. Proper assembly and care will ensure the longevity and functionality of your product.

2. SAFETY INFORMATION

WARNING: To prevent tipping, this cabinet must be securely attached to the wall using the provided anti-tip device. Failure to do so can result in serious injury.

- Always follow the illustrated assembly instructions carefully to ensure stability and safety.
- Do not allow children to climb on or play with the cabinet.
- Ensure all screws and fasteners are tightened securely before use. Periodically check and re-tighten if necessary.
- Place the cabinet on a flat, stable surface.
- Do not exceed the maximum weight capacity of 30 kg for the entire cabinet.

3. PRODUCT FEATURES

The EUGAD Bathroom Column Cabinet is designed for versatile storage in various rooms, including

bathrooms, living rooms, bedrooms, kitchens, and hallways. Key features include:

- **High-Quality Materials:** Constructed from durable MDF with a lacquer finish, making it water-resistant, easy to clean, and moisture-proof.
- **Space-Saving Design:** Compact dimensions (32 x 30 x 99 cm) make it ideal for corners and smaller spaces.
- **Multiple Storage Options:** Features an open shelf, a top compartment, two sections behind the door, and a hidden storage area under the top panel.
- **Hidden Top Storage:** The top panel can be opened to reveal a concealed compartment, perfect for discreetly storing small items.
- **Magnetic Door:** Ensures the door closes easily and securely.
- **Adjustable Shelf:** The shelf behind the door can be adjusted to 3 different heights (10 cm intervals) to accommodate items of various sizes.

Großer Stauraum für einfache und bequeme Aufbewahrung



Image: Key features including water-resistant surface, metal handle, magnetic door, and raised legs.

4. COMPONENTS LIST

Please check that all the following components are present before starting assembly. If any parts are missing or damaged, please contact customer support.

- Cabinet Panels (various sizes)
- Shelves
- Door with magnetic closure
- Mounting Hardware (screws, dowels, hinges, anti-tip device)
- Illustrated Assembly Manual

5. SETUP AND ASSEMBLY

Assembly of the EUGAD cabinet is straightforward with the included illustrated manual and accessories. Follow these general steps:

1. **Unpack:** Carefully remove all components from the packaging and lay them out on a clean, soft surface to prevent scratches.
2. **Identify Parts:** Refer to the illustrated manual to identify each panel and piece of hardware.
3. **Assemble Frame:** Follow the step-by-step diagrams to connect the main cabinet panels.
4. **Install Shelves:** Insert the fixed and adjustable shelves as indicated. For the adjustable shelf, choose your desired height.
5. **Attach Door:** Secure the door using the provided hinges and ensure the magnetic closure functions correctly.
6. **Install Anti-Tip Device:** This is a critical safety step. Securely attach the anti-tip device to the back of the cabinet and to a wall stud or appropriate wall anchor.

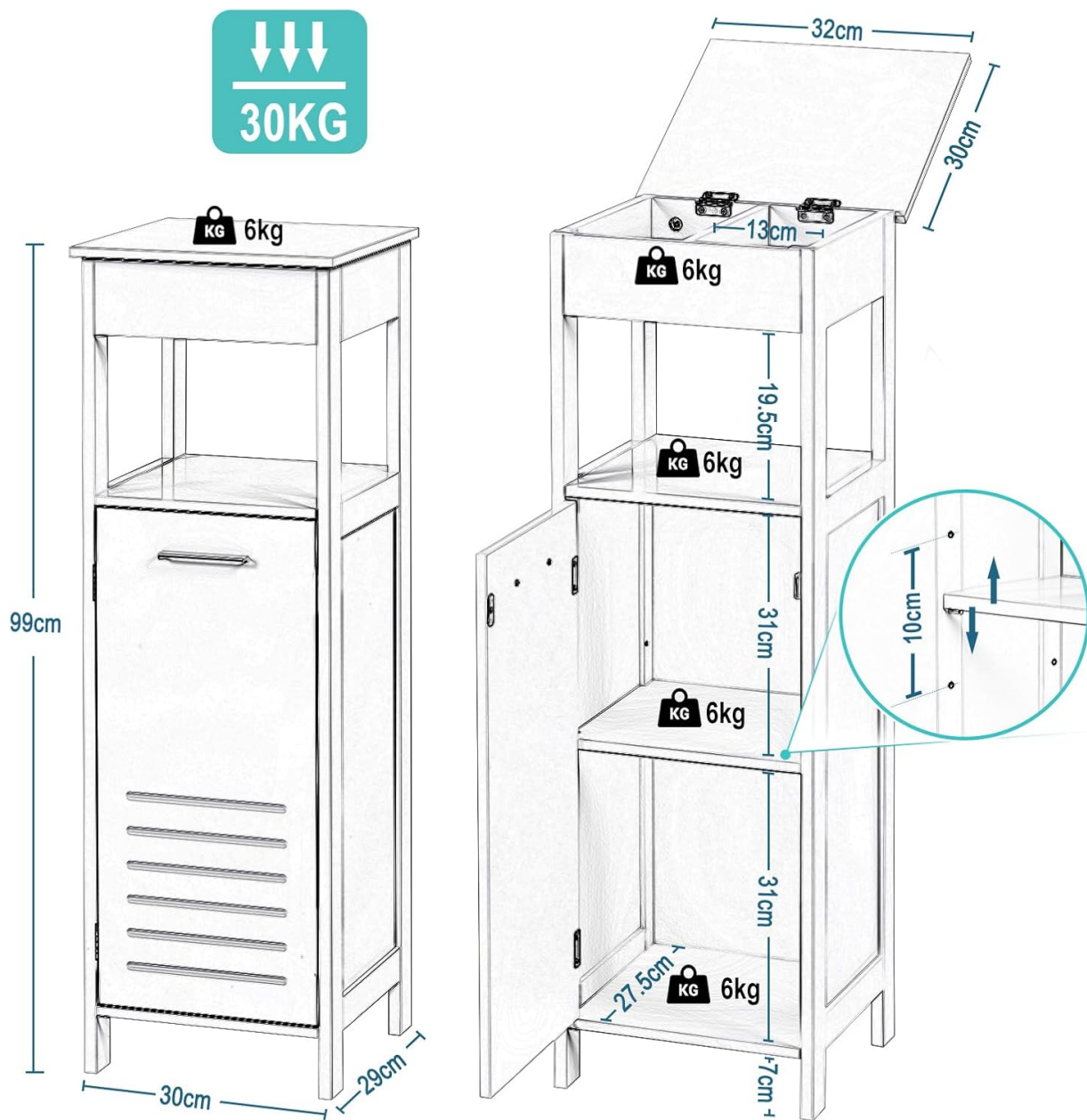

Image: Cabinet dimensions and internal structure for assembly reference.

6. OPERATING INSTRUCTIONS

The EUGAD cabinet offers versatile storage for various items:

- **Open Shelf:** Use the open shelf for frequently accessed items or decorative displays.
- **Door Compartment:** Store towels, toiletries, or other bathroom essentials behind the magnetic door. Adjust the shelf height as needed.
- **Hidden Top Compartment:** Lift the top panel to access the concealed storage area. This is ideal for personal items or small valuables you wish to keep out of sight.



Für viele Szenarien



Image: Demonstrates storage capacity and adjustable shelf.





Image: The hidden top compartment with its lid open.

7. MAINTENANCE

To keep your EUGAD cabinet in optimal condition:

- **Cleaning:** Wipe the surfaces with a soft, damp cloth. Avoid abrasive cleaners or harsh chemicals that could damage the lacquer finish.
- **Moisture:** While water-resistant, avoid prolonged exposure to excessive moisture. Wipe up spills immediately.
- **Inspection:** Periodically check all fasteners and connections to ensure they remain tight. Re-tighten if

necessary.

8. TROUBLESHOOTING

If you encounter any issues with your cabinet, consider the following:

- **Instability:** Ensure the cabinet is placed on a level surface. Verify that all assembly screws are tightened. Confirm the anti-tip device is correctly installed and secured to the wall.
- **Door Not Closing Properly:** Check hinges for proper alignment and tightness. Ensure no obstructions are preventing the magnetic closure from engaging.
- **Damaged Parts:** If any part is damaged during assembly or use, discontinue use and contact customer support for replacement parts.

9. SPECIFICATIONS

Attribute	Value
Brand	EUGAD
Model	B0CXPPMD8F
Color	White
Material	Engineered Wood (MDF)
Product Dimensions (D x W x H)	30D x 32W x 99H cm
Mounting Type	Floor Mount, Freestanding
Maximum Weight Capacity	30 Kilograms
Number of Shelves	3 (including adjustable)
Number of Compartments	4 (open shelf, top, 2 behind door, hidden top)
Assembly Required	Yes
Special Features	Water-resistant, Adjustable Shelf, Hidden Storage, Anti-tip device included

10. WARRANTY AND SUPPORT

Specific warranty information for this product is not provided in the available data. For warranty details, replacement parts, or further assistance, please contact EUGAD customer support directly through their official website or the retailer where the product was purchased. Please have your model number (B0CXPPMD8F) and purchase date ready when contacting support.

