

## Manuals+

[Q & A](#) | [Deep Search](#) | [Upload](#)

manuals.plus /

- › [OBO HANDS](#) /
- › [OBO HANDS GYS Electronic Smart Lock User Manual](#)

## OBO HANDS GYS

# OBO HANDS GYS Electronic Smart Lock User Manual

Model: GYS

## 1. INTRODUCTION

---

Thank you for choosing the OBO HANDS GYS Electronic Smart Lock. This manual provides detailed instructions for the installation, operation, and maintenance of your smart lock. Please read this manual thoroughly before installation and use to ensure proper function and security.

## 2. PRODUCT OVERVIEW

---

### 2.1 Key Features

- **Multiple Unlocking Methods:** Supports Fingerprint, RFID Card, PIN Code, Mechanical Key, and WeChat applet unlocking.
- **Virtual Password Function:** Enhances security by allowing random digits before and after the actual password.
- **Administrator Management:** Centralized control for managing user access.
- **Emergency Power Supply:** USB interface for temporary power using a power bank in case of battery depletion.
- **Low Battery Reminder:** Alerts when battery power is low (below 4.8V).
- **High Capacity:** Stores up to 100 fingerprints, 100 passwords, and 100 cards.

### 2.2 Unlocking Methods Overview

# Multi-Types of Unlocking

Choose Different Unlocking Methods According to Your Needs for More Flexible Use



Fingerprint Unlocking  
(Support 100users)



Password Unlocking  
(Support 100users)



RFID Card Unlocking  
(Support 100users)



Metal Key Unlocking



WeChat applet

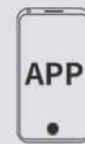

TUYA  
Remote control  
Can be customised  
(Optional)

Figure 1: Overview of available unlocking methods for the smart lock.

## 2.3 Internal Components

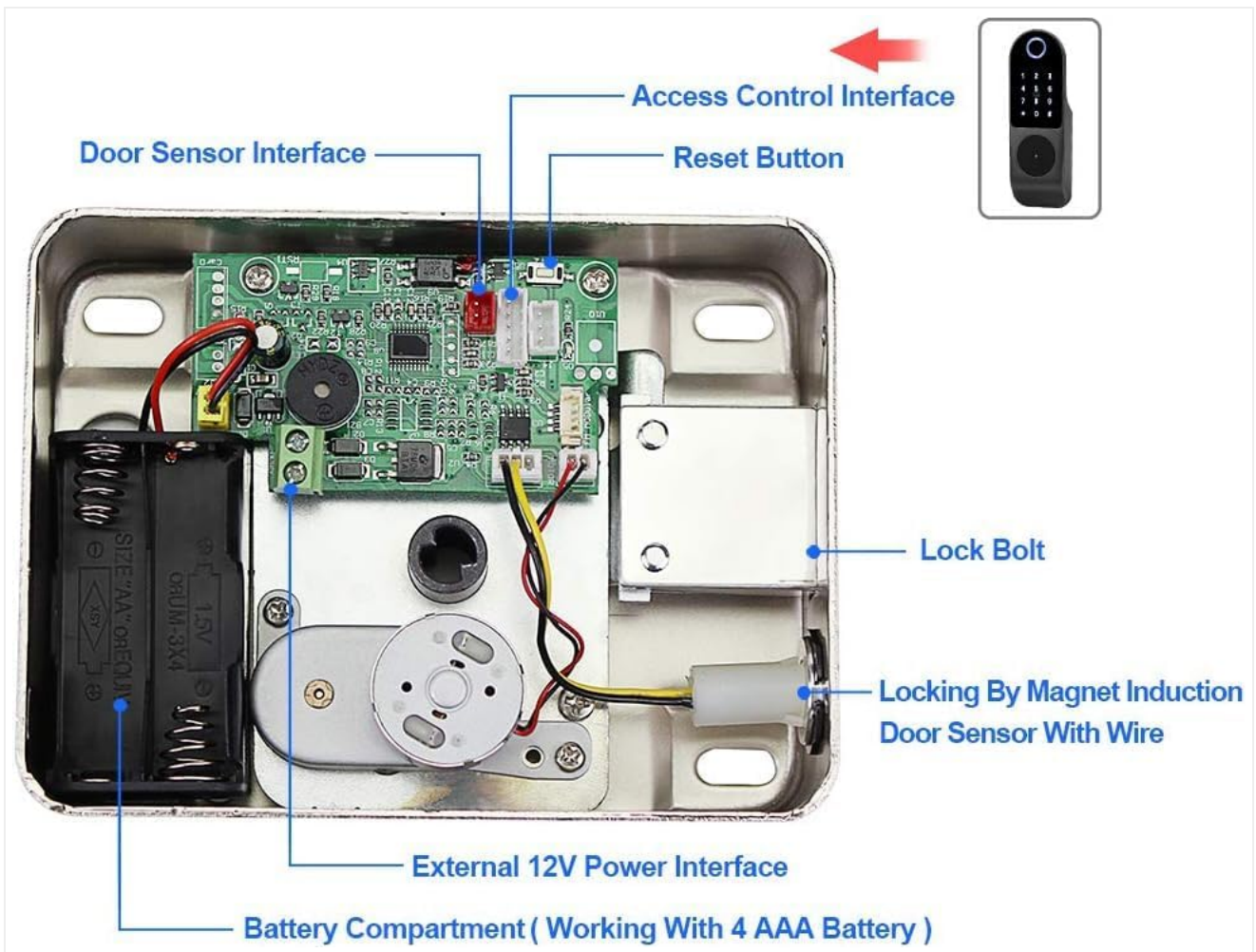

Figure 2: Internal components of the smart lock, including the battery compartment for 4 AAA batteries, circuit board, and various interfaces.

### 3. SETUP AND INSTALLATION

---

#### 3.1 Pre-Installation Checks

Before beginning installation, ensure your door meets the following requirements:

- The door may require an additional small hole to be drilled.
- Measure the door's thickness.
- Measure the length of the guide plate.
- Measure the width of the guide plate.
- The lock is compatible with exterior wooden doors where keyed entry is standard.

#### 3.2 Installation Steps

Installation typically takes approximately 20 minutes with a screwdriver and a drill. Follow the detailed instructions provided in the included installation guide (not part of this document) for precise steps. The general process involves:

1. Prepare the door by drilling necessary holes according to the template.
2. Install the mortise lock into the door edge.
3. Mount the front and rear panels of the smart lock.
4. Connect the internal wiring.
5. Install the batteries.

6. Test the lock's functionality.

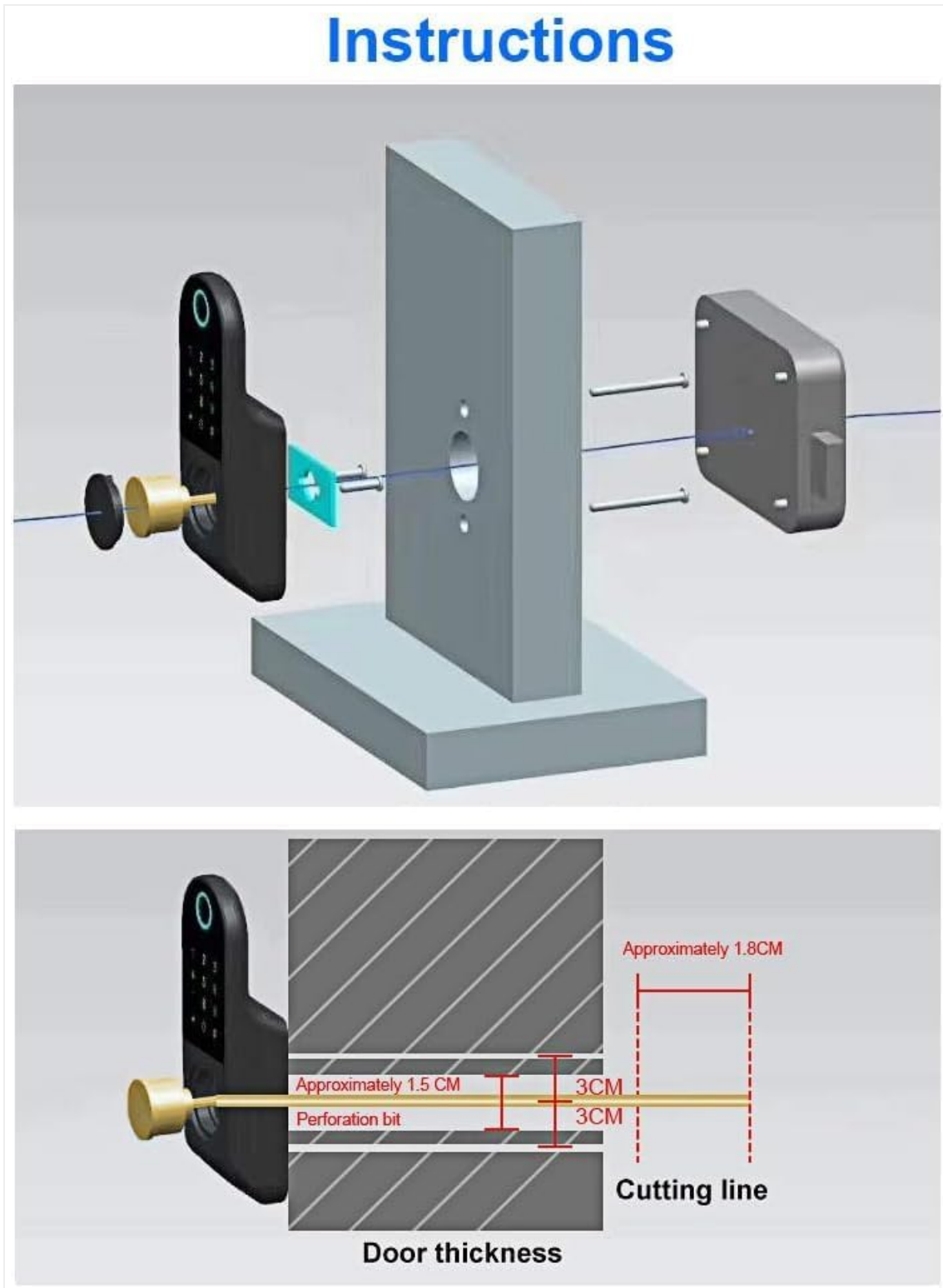

Figure 3: Visual guide for smart lock installation and door preparation.

### 3.3 Initial Configuration

After physical installation, the lock requires initial configuration:

- **Set Administrator:** The first user registered (fingerprint, password, or card) will typically be designated as the administrator. This user has privileges to add or delete other users.
- **Add Users:** Follow the on-screen prompts or voice guidance to add additional fingerprints, PIN codes, or RFID cards for other users.

## 4. OPERATING INSTRUCTIONS

### 4.1 Unlocking with Fingerprint

Place your registered finger flat on the fingerprint sensor. The lock will unlock if the fingerprint is recognized.



Figure 4: Fingerprint recognition area on the smart lock.

### 4.2 Unlocking with PIN Code (Virtual Password)

To use the virtual password function, enter any random digits before and after your actual PIN code. This prevents others from observing your correct code.

- **Example:** If your correct PIN is **123456**, you can enter **0000 + 123456 + 0000** to unlock the door. The lock will identify the correct sequence within the longer input.

# Unlock with Virtual Password

Support to set the virtual password to open the door to avoid prying eyes

For example: 12586327895474, then you can open the door with 632789.



Figure 5: Virtual password input method for enhanced security.

## 4.3 Unlocking with RFID Card

Present a registered RFID card to the card reader area on the lock. The lock will unlock upon successful recognition.

## 4.4 Unlocking with Mechanical Key

In case of electronic failure or battery depletion, insert the mechanical key into the hidden keyhole and turn to unlock the door manually.

## 4.5 Unlocking with WeChat Applet

Refer to the specific instructions for connecting and operating the lock via the WeChat applet, usually found within the app itself after pairing.

## 4.6 User Management

Access the administrator menu (typically by entering the administrator PIN or fingerprint) to add, modify, or delete user fingerprints, PIN codes, and RFID cards. Consult the full installation guide for specific menu navigation steps.

## 5. MAINTENANCE

## 5.1 Battery Replacement and Emergency Power

The lock is powered by 4x AA batteries (not included). A low battery reminder will activate when the voltage drops below 4.8V. Replace batteries promptly when this occurs.

- **Battery Type:** 4 x AA Batteries.
- **Emergency Power:** If batteries are completely depleted, connect a power bank to the emergency USB charging port on the lock to temporarily power it and gain access.



Figure 6: Emergency USB charging port and low battery alarm feature.

## 5.2 Cleaning

Wipe the lock's exterior with a soft, dry cloth. Avoid using abrasive cleaners or solvents that could damage the finish or electronic components.

## 6. TROUBLESHOOTING

- **Lock not responding:** Check battery level. If low, replace batteries or use emergency USB power. Ensure no obstructions are preventing the bolt from moving.
- **Fingerprint not recognized:** Ensure your finger is clean and dry. Try re-registering your fingerprint if issues persist.
- **PIN code not working:** Verify the correct PIN is being entered. Ensure the virtual password sequence is correctly applied.
- **RFID card not recognized:** Ensure the card is properly registered. Try re-registering the card.
- **Lock beeps continuously:** This may indicate a low battery or a system error. Check battery first. If the issue persists, perform a factory reset (refer to the full installation guide for reset procedures).

## 7. SPECIFICATIONS

---

<b>Model Name</b>	GYS
<b>Unlocking Methods</b>	Fingerprint, RFID Smart Card, PIN Code, Mechanical Key, WeChat Applet
<b>Materials</b>	Zinc Alloy, Aluminum, Plastic
<b>Fingerprint Capacity</b>	Up to 100
<b>Password Capacity</b>	Up to 100
<b>Card Capacity</b>	Up to 100
<b>Battery Type</b>	4 x AA Batteries (12V)
<b>Low Battery Reminder</b>	Yes (below 4.8V)
<b>Emergency Power</b>	USB Interface
<b>Working Temperature</b>	-10°C to 60°C (14°F to 140°F)
<b>Product Dimensions (L x W x H)</b>	5.43 x 1.31 x 7.25 inches (approximate)
<b>Item Weight</b>	3.25 pounds



Figure 7: Dimensional drawing of the smart lock components.

## 8. WARRANTY AND SUPPORT

---

### 8.1 Warranty Information

Please refer to your purchase documentation or contact the seller directly for specific warranty terms and conditions applicable to your OBO HANDS GYS Electronic Smart Lock.

### 8.2 Customer Support

For any questions, technical assistance, or issues, please contact OBO HANDS customer service:

- **WhatsApp:** [+86 177 2255 8183](https://wa.me/8617722558183)
- **Availability:** Monday - Sunday, 24/7

