

[Manuals.plus](#) /

› [ERGOMAKER](#) /

› ERGOMAKER 43" Electric Standing Desk User Manual (Model SM203-110-WFWD)

ERGOMAKER SM203-110-WFWD

ERGOMAKER 43" Electric Standing Desk User Manual

Model: SM203-110-WFWD

1. PRODUCT OVERVIEW

The ERGOMAKER 43" Electric Standing Desk is designed to provide a versatile and ergonomic workspace. It features an adjustable height mechanism, allowing users to easily switch between sitting and standing positions to promote better posture and reduce discomfort during prolonged work sessions. The spacious desktop accommodates various monitors, laptops, and office essentials, making it suitable for home offices and computer workstations.



Figure 1: ERGOMAKER 43 inch Electric Standing Desk in a modern office setting.

2. SAFETY INFORMATION

Please read all safety instructions before assembly and use.

- Do not exceed the recommended weight limit of 65 kilograms (143 lbs) on the desktop.
- Ensure the desk is adjusted to a stable height before placing heavy items or applying pressure to prevent potential injuries.
- Keep children and pets away from the desk during operation to avoid accidents.
- Ensure all cables are properly managed to prevent tripping hazards or damage to the electrical components.
- Do not attempt to disassemble or repair the electrical components yourself. Contact qualified personnel for service.

3. PACKAGE CONTENTS

Verify that all components are present before beginning assembly. If any parts are missing or damaged, please contact customer support.

- Desktop (43 x 23.6 inches)
- Desk Legs (2)
- Crossbar/Frame
- Control Panel with LED Display
- Power Adapter and Cables
- Assembly Hardware (screws, bolts, Allen wrench)
- Side Hooks (2)
- User Manual

4. ASSEMBLY INSTRUCTIONS

Assembly typically requires one person and can be completed in approximately one hour. All necessary tools are included in the package.

1. **Assemble the Frame:** Connect the desk legs to the crossbar using the provided screws and Allen wrench. Ensure all connections are secure.
2. **Attach Feet:** Secure the feet to the bottom of the desk legs.
3. **Mount Desktop:** Carefully place the desktop upside down on a soft, clean surface. Align the pre-drilled holes on the desktop with the frame. Secure the desktop to the frame using the provided screws.
4. **Install Control Panel:** Mount the digital control panel to the underside of the desktop in the designated area.
5. **Connect Wiring:** Connect the motor cables from the legs to the control panel, and then connect the control panel to the power adapter. Ensure all connections are firm.
6. **Install Side Hooks:** Attach the two side hooks to the designated areas on the underside of the desktop for hanging bags or headphones.
7. **Initial Reset:** After installation, plug in the desk. Press and hold the 'down' button until the desk reaches its lowest point, then rises slightly and stops. This calibrates the desk.

For a visual guide, please refer to the official assembly video:

Your browser does not support the video tag.

Official assembly guide for the ERGOMAKER 43 inch Electric Standing Desk, demonstrating step-by-step installation.

5. OPERATING INSTRUCTIONS

The ERGOMAKER Electric Standing Desk features a user-friendly digital control panel for height adjustment and memory presets.

DIGITAL CONTROL PANEL

LED Display: Height Display

UP & Down: adjust the height

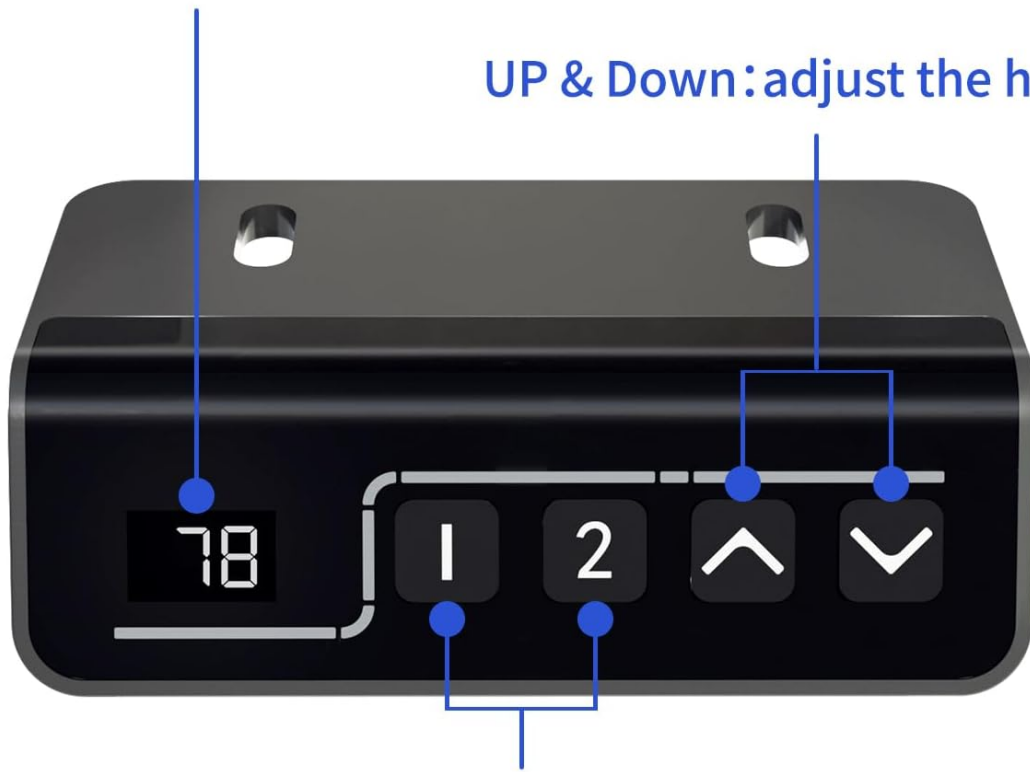

Memory Height: Press and hold for more than 3 seconds

Figure 2: Digital Control Panel.

5.1 Height Adjustment

- **Up/Down Buttons (▲ / ▼):** Press and hold the up or down arrow buttons to smoothly adjust the desk height to your desired level. The LED display will show the current height.
- The desk adjusts between 28.7 inches (73 cm) and 46.5 inches (118 cm).

DESK MEASUREMENTS



Figure 3: Desk dimensions and height range.

5.2 Memory Presets

The control panel includes two memory buttons (1 and 2) to save and recall your preferred sitting and standing heights.

1. **To Save a Height:** Adjust the desk to your desired height. Press and hold one of the memory buttons (1 or 2) for more than 3 seconds until you hear a beep or see the display flash, indicating the height has been saved.
2. **To Recall a Height:** Simply press the corresponding memory button (1 or 2) once. The desk will automatically move to the saved height.

5.3 Child Lock Function

To activate the child lock, press and hold both the up (▲) and down (▼) buttons simultaneously for 5 seconds. The display will show 'LOC' to indicate the lock is active. To deactivate, repeat the process.

6. MAINTENANCE

- **Cleaning:** Wipe the desktop and frame with a soft, damp cloth. Avoid harsh chemicals or abrasive cleaners.
- **Cable Management:** Regularly check and organize cables to prevent tangles and damage.
- **Weight Distribution:** Distribute weight evenly across the desktop to ensure stable operation and prolong the life of the motor.
- **Periodic Checks:** Periodically check all screws and bolts to ensure they are tight. Retighten if necessary.

7. TROUBLESHOOTING

Problem	Possible Cause	Solution
Desk does not move	Power cable disconnected; Overload; Motor error	Check power connections; Reduce weight on desk; Perform reset procedure.
Desk moves unevenly	Uneven weight distribution; Loose connections	Distribute weight evenly; Check and tighten all screws.
Error code on display	Specific error detected by control box	Refer to the full user manual for specific error code meanings and solutions, or perform a reset.
Desk stops mid-movement	Overheat protection; Obstruction detected	Allow motor to cool down (approx. 20 minutes); Remove any obstructions.

7.1 Reset Procedure

If the desk is not functioning correctly, a reset may resolve the issue:

1. Unplug the desk from the power outlet.
2. Wait for at least 10 seconds.
3. Plug the desk back into the power outlet.
4. Press and hold the 'down' button until the desk reaches its lowest point, then rises slightly and stops. This completes the reset.

8. SPECIFICATIONS

Brand: ERGOMAKER

Model Number: SM203-110-WFWD

Desktop Dimensions (D x W): 43" x 23.6" (110 cm x 60 cm)

Height Adjustment Range: 28.7" - 46.5" (73 cm - 118 cm)

Weight Capacity: 143 lbs (65 kg)

Lifting Speed: 0.6" per second (14 mm/s)

Noise Level: <50dB

Material: Alloy Steel frame, Wood desktop

Color: White

Special Features: Adjustable height, Memory presets, Side hooks, Adjustable feet, Rounded edges

Assembly Required: Yes (Recommended 1 person)

QUICK&SMOOTH ADJUSTMENT



Weight Capacity:
65KG/143lbs



Height Adjustable Range:
730-1180mm



Mute: <50db



Lifting Speed:14mm/s



Figure 4: Key performance specifications.

9. WARRANTY AND SUPPORT

The ERGOMAKER 43" Electric Standing Desk comes with a Limited & Lifetime Warranty. For specific warranty details, claims, or technical support, please refer to the warranty card included in your package or contact ERGOMAKER customer service directly.

Contact Information: Please visit the official ERGOMAKER website or refer to your purchase documentation for the most up-to-date contact details.