



Manuals.plus /

› ACCULENZ /

› Acculenz 5MP WiFi Home Security Camera with 360° View & AI Human/Sound Detection | Pet, Dog Camera & Baby Monitor | Night Vision, 2-Way Audio, Work with Alexa User Manual

## ACCULENZ R5

# Acculenz 5MP WiFi Home Security Camera User Manual

Model: R5

## INTRODUCTION

Thank you for choosing the Acculenz 5MP WiFi Home Security Camera. This manual provides detailed instructions for setting up, operating, and maintaining your camera to ensure optimal performance and security. The Acculenz R5 camera offers advanced features such as 5MP Ultra HD resolution, 360° pan and tilt, AI-powered detection, two-way audio, and night vision, making it an ideal solution for monitoring your home, pets, or children.



Image: The AccuLenz R5 camera, a white dome-shaped device, shown next to a smartphone displaying a golden retriever. This illustrates the camera's primary function for home security and monitoring.

## PACKAGE CONTENTS

- 1 x AccuLenz R5 Security Camera
- 1 x User Manual
- 1 x Mounting Plate
- 1 x Pack of Screws & 1 x Reset Needle
- 1 x Power Cable & Adapter

## SETUP GUIDE

Follow these steps to set up your AccuLenz R5 camera:

### 1. Step 1: Download the ACCULENZ App

Search for "ACCULENZ" in the App Store (iOS) or Google Play Store (Android) and download the official application.

## 2. Step 2: Power On and Scan QR Code

Connect the camera to power using the provided adapter. Once powered on, open the AccuLenz app and follow the on-screen prompts to add a new device. The app will instruct you to scan a QR code displayed on your phone screen with the camera lens. Ensure the QR code is 4-6 inches away from the camera.

## 3. Step 3: Connect to 2.4GHz WiFi

The AccuLenz R5 camera supports 2.4GHz Wi-Fi networks only. Select your 2.4GHz Wi-Fi network and enter the password in the app. 5GHz Wi-Fi is not supported.

## 4. Step 4: Connection Successful

Once the camera successfully connects to your Wi-Fi network, the app will confirm the connection. You can then name your device and set its purpose (e.g., Indoor Security, Baby Monitoring, Pet Monitoring).

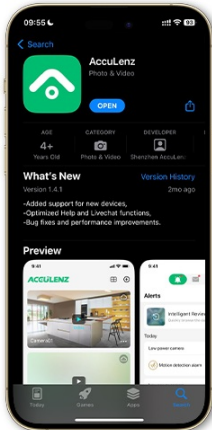

### Step 1

Download ACCULENZ APP

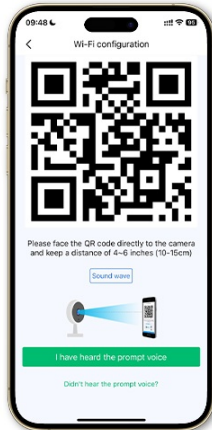

### Step 2

Scan QR Code

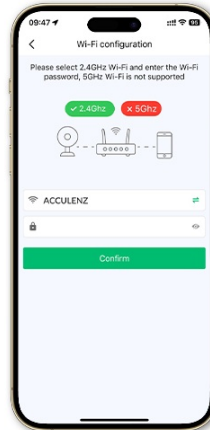

### Step 3

Connect to 2.4GHz WiFi

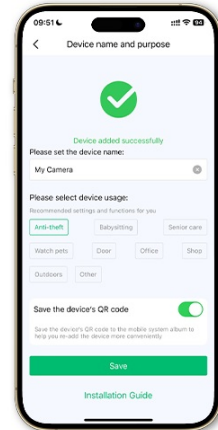

### Step 4

Connection successful

Image: A visual guide showing the four steps for camera setup: downloading the AccuLenz app, scanning a QR code with the camera, connecting to a 2.4GHz Wi-Fi network, and confirming successful connection.

## OPERATING INSTRUCTIONS

### Live View and Pan/Tilt Control

Access the live video feed through the AccuLenz app. Use the on-screen controls to remotely pan the camera 3500 horizontally and tilt it 700 vertically, providing comprehensive coverage of your space. You can also set up to 6 preset surveillance points for quick navigation to specific areas.



Image: An illustration of the camera's 70-degree vertical and 350-degree horizontal rotation capabilities, with multiple preset points indicated in a living room setting, demonstrating full room coverage.

## Two-Way Audio

The camera features a built-in microphone and speaker, enabling two-way communication. Use this function to speak to family members, pets, or visitors directly through the app.

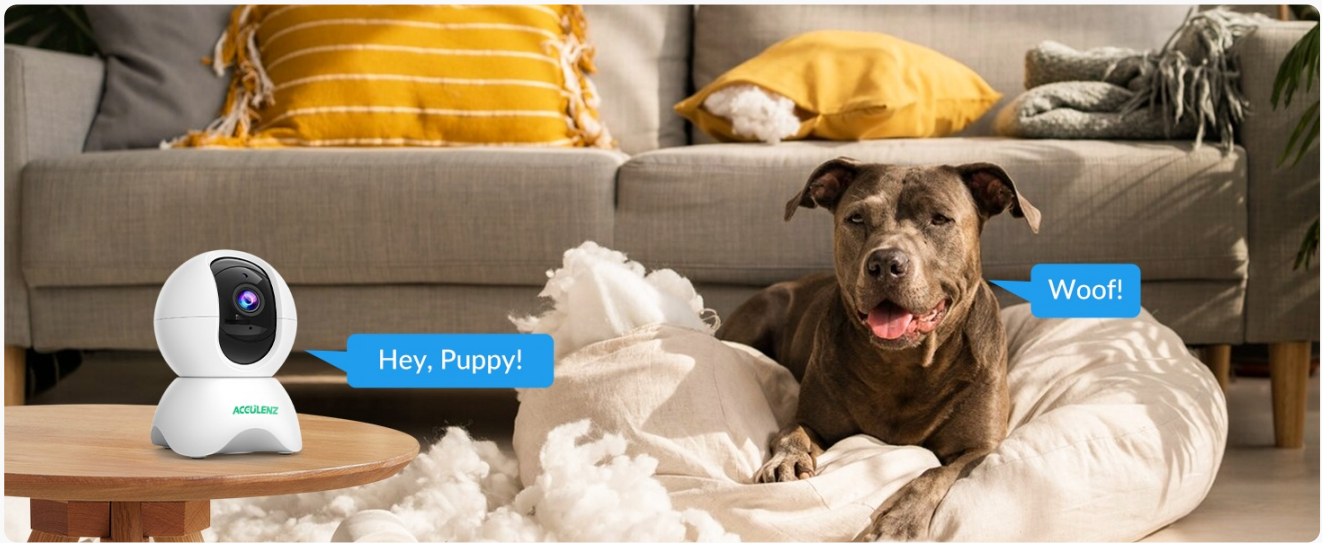

Image: The Acculenz camera positioned near a dog, with speech bubbles illustrating the two-way audio feature, allowing communication with pets.

## AI Detection & Instant Alerts

The camera's AI recognition system can detect various events, including human motion, pet activity, vehicle movement, sound, and package delivery. Upon detection, the camera sends instant alerts to your phone and uploads the event to the cloud, reducing false alarms and providing specific classifications.



Image: A scene depicting the camera's AI detection capabilities, showing notifications on a smartphone for detected human and pet activity, highlighting the smart alert system.

## Night Vision

The camera provides clear and smooth video streams even in low-light conditions, with night vision extending up to 30 feet.



Image: A child sleeping peacefully in a dimly lit room, illustrating the camera's effective night vision capabilities for monitoring in low-light conditions.

## Storage and Playback

The camera supports local recording via an SD card (up to 256GB) and offers cloud storage options. You can review recorded footage and event history through the AccuLenz app.

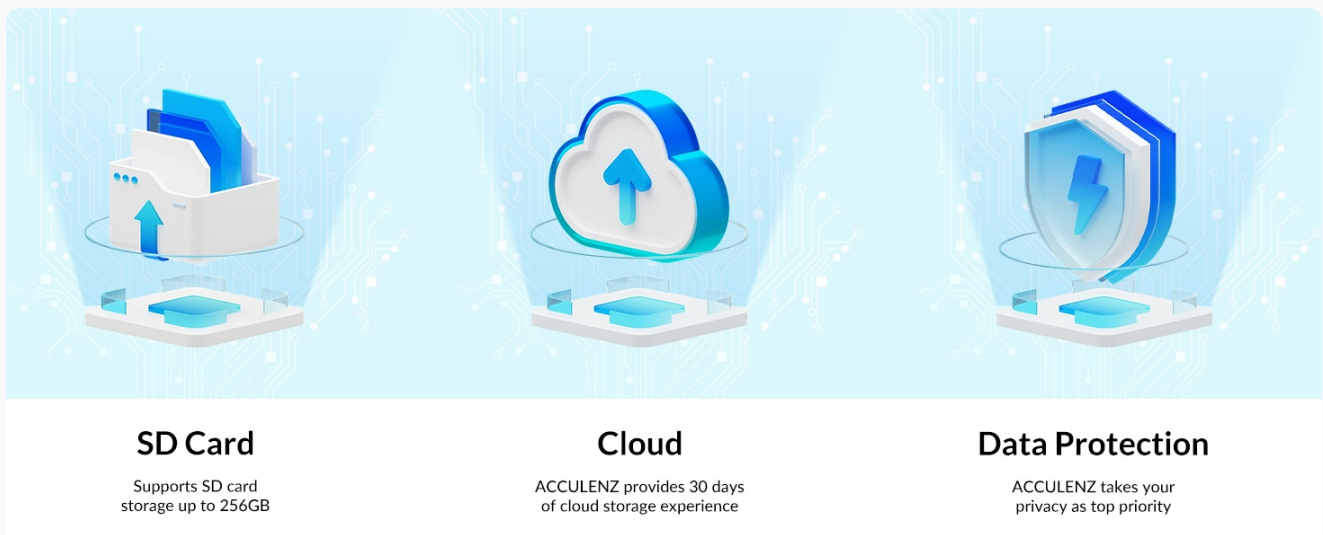

Image: A diagram illustrating the camera's storage options, including SD card support and cloud storage, emphasizing data protection as a priority.

## Privacy Mode

Activate privacy mode through the app to temporarily disable video recording and live streaming for enhanced privacy when needed.

## FEATURES OVERVIEW

- **2.5K 5MP HD Vision:** Captures sharper details and richer colors compared to 1080P cameras.
- **3600 View Coverage:** 3500 pan and 700 tilt for a broader and more flexible view.
- **AI Detection:** Compatible with AWS AI recognition for human, pet, vehicle, sound, and package detection.
- **Instant Alerts:** Sends notifications to your phone and cloud upon detection.
- **Two-Way Audio:** Built-in mic and speaker for communication.
- **Night Vision:** Clear video up to 30 ft in low light.

- **Local & Cloud Storage:** Supports SD card up to 256GB and offers cloud service (free month included).
- **Wider Compatibility:** Works with Alexa and Google Assistant.
- **Privacy Mode:** Option to disable recording and streaming.



Image: The AccuLenz camera with icons highlighting its core features: Privacy Mode, Motion Detection, 5MP Ultra HD, Instant Alerts, Playback, Pan & Tilt, and 2-way Audio.

## MAINTENANCE

- **Cleaning:** Gently wipe the camera lens and body with a soft, dry cloth. Avoid using harsh chemicals or abrasive materials.
- **Software Updates:** Regularly check the AccuLenz app for firmware updates. Keeping your camera's software up-to-date ensures optimal performance, security, and access to new features.
- **Placement:** Ensure the camera is placed in a stable location, away from direct sunlight, extreme temperatures, and high humidity.

## TROUBLESHOOTING

Problem	Possible Cause	Solution
Camera fails to connect to Wi-Fi	Incorrect Wi-Fi password; 5GHz Wi-Fi network selected; Camera too far from router; Network interference.	Ensure correct 2.4GHz Wi-Fi password is entered. Confirm your router is broadcasting a 2.4GHz signal. Move camera closer to the router. Try setting up a dedicated 2.4GHz guest network if your main network is dual-band.
Poor video quality	Insufficient network bandwidth; Dirty lens; Low light conditions.	Ensure stable Wi-Fi connection. Clean the camera lens. Verify night vision is active in low light.
No audio or low audio during two-way talk	Microphone/speaker muted in app; Volume too low; Network delay.	Check audio settings in the AccuLenz app. Increase volume on your phone. Ensure stable network connection.
False alerts	Sensitivity too high; Environmental factors (e.g., shadows, light changes).	Adjust detection sensitivity settings in the app. Define specific detection zones to exclude high-traffic areas.
Camera offline frequently	Weak Wi-Fi signal; Power supply issue.	Relocate camera closer to the router or use a Wi-Fi extender. Check power adapter and cable for secure connection.

## SPECIFICATIONS

Feature	Detail
Model	R5
Resolution	5MP (2560 x 1700)
Connectivity	2.4GHz Wi-Fi (Wired Power)
Pan/Tilt Range	3500 Horizontal Pan, 700 Vertical Tilt
Night Vision Range	Up to 30 ft
Audio	Two-Way Audio (Built-in Mic & Speaker)
Detection	AI Human/Pet/Vehicle/Sound/Package Detection
Storage Options	MicroSD Card (up to 256GB), Cloud Storage
Compatibility	AccuLenz App (iOS/Android), Amazon Alexa, Google Assistant
Power Source	Corded Electric
Dimensions	17.3 x 9.3 x 9.2 cm
Weight	310 g

## WARRANTY AND SUPPORT

Your Acculenz R5 Security Camera comes with a **1-year warranty service** from the date of purchase.

For any inquiries, technical assistance, or warranty claims, please contact the AccuLenz After-sales Team:

- **Email:** [support@acculenz.com](mailto:support@acculenz.com)
- **Live Chat:** Available via the AccuLenz APP
- **Telephone (US/CA):** +1-833-587-5008