

Voltas 183V Vectra CAW

Voltas 1.5 Ton 3 Star Inverter Split AC User Manual

Model: 183V Vectra CAW

1. INTRODUCTION

This user manual provides essential information for the safe and efficient operation of your Voltas 1.5 Ton 3 Star Inverter Split AC. Please read this manual thoroughly before using the appliance and retain it for future reference. Proper installation, operation, and maintenance are crucial for optimal performance and longevity of your air conditioner.

2. PRODUCT OVERVIEW

The Voltas 1.5 Ton 3 Star Inverter Split AC is designed to provide efficient and comfortable cooling for medium-sized rooms. It features an inverter compressor for variable speed operation, adjusting power based on heat load, and offers 4-in-1 adjustable cooling modes to suit different needs. Key components include a copper condenser for enhanced heat transfer and durability, and an anti-dust filter with antimicrobial coating for improved air quality.



Image: The indoor unit of the Voltas 1.5 Ton 3 Star Inverter Split AC, showcasing its sleek design and key features like 4-step adjustable cooling and anti-dust filter.

3. SETUP AND INSTALLATION

Your Voltas Split AC requires professional installation. Ensure that the installation is performed by a qualified technician to guarantee proper functioning and safety. The package includes both an indoor and an outdoor unit, along with necessary accessories.

3.1 Included Components

- 1 Indoor Unit
- 1 Outdoor Unit
- 1 Interconnecting Cable (9.84 ft)
- 1 Set (2 nos) Interconnecting Pipe (Copper) (9.84 ft)
- 1 Remote Control
- 2 AAA Remote Batteries

- 1 Indoor Mounting Plate
- Plastic Sleeves + Screws for Indoor Mounting Plate
- 4 Outdoor Vibration Pads
- 1 User Manual
- 1 Warranty Card

3.2 Dimensions and Weight

Understanding the dimensions of your AC units is important for proper placement and installation.

- **Indoor Unit (IDU):** 80 cm (W) x 29.2 cm (H) x 22.2 cm (D)
- **Outdoor Unit (ODU):** 83.5 cm (W) x 59.5 cm (H) x 30 cm (D)
- **IDU Net Weight:** 9.5 Kg
- **ODU Net Weight:** 25 Kg



Image: Diagram illustrating the precise dimensions of both the indoor and outdoor units of the Voltas Split AC for installation planning.

3.3 Electrical Requirements

The unit operates on a standard 230 Volts power supply. It features a wide operating voltage range of 110V - 285V, which helps protect the unit from voltage fluctuations.

4. OPERATING INSTRUCTIONS

Your Voltas AC is equipped with various features to enhance your comfort and convenience.

4.1 4-in-1 Adjustable Cooling Modes

The AC offers four distinct cooling modes, allowing you to adjust the cooling capacity based on the ambient temperature and the number of occupants in the room. This feature helps optimize energy consumption.

- **Mode 1:** Gentle Cooling for Energy-Savings (Upto 2 People)
- **Mode 2:** Moderate Cooling (Upto 3 People)
- **Mode 3:** Accelerated Cooling (Upto 5 People)
- **Mode 4:** Turbo Fast Cooling (More Than 5 People)

4-IN-1 Adjustable Cooling

Runs at 4 different capacities depending on the ambient temperature or number of people in the room.



Mode 1

Gentle Cooling For Energy-Savings
Upto 2 People



Mode 2

Moderate Cooling
Upto 3 People



Mode 3

Accelerated Cooling
Upto 5 People



Mode 4

Turbo Fast Cooling
More Than 5 People

Image: Visual representation of the four adjustable cooling modes, demonstrating how the AC adapts its capacity for different room occupancy and cooling needs.

4.2 Remote Control Operation

The included remote control allows you to conveniently manage all functions of your AC, including mode selection, temperature adjustment, fan speed, and special features.

4.3 Special Features

- **Digital Temperature Display & Hidden Display:** Provides clear temperature readings, with an option for a sleek, hidden display for aesthetic purposes.
- **Sleep Mode:** Adjusts temperature and fan speed automatically during sleep for enhanced comfort and energy saving.
- **Turbo Mode:** Provides rapid cooling to quickly reach the desired temperature.
- **SuperDry Mode:** Effectively removes excess moisture from the air, ideal for humid conditions.
- **Memory Restart:** Automatically resumes the last set cooling program after a power cut.
- **Anti-freeze Thermostat:** Prevents ice buildup in the unit, ensuring efficient and uninterrupted operation.
- **Self Diagnosis:** The unit can detect and display certain operational issues, aiding in troubleshooting.
- **5-Speed Fan Function:** Allows for customizable airflow options to suit your preference.

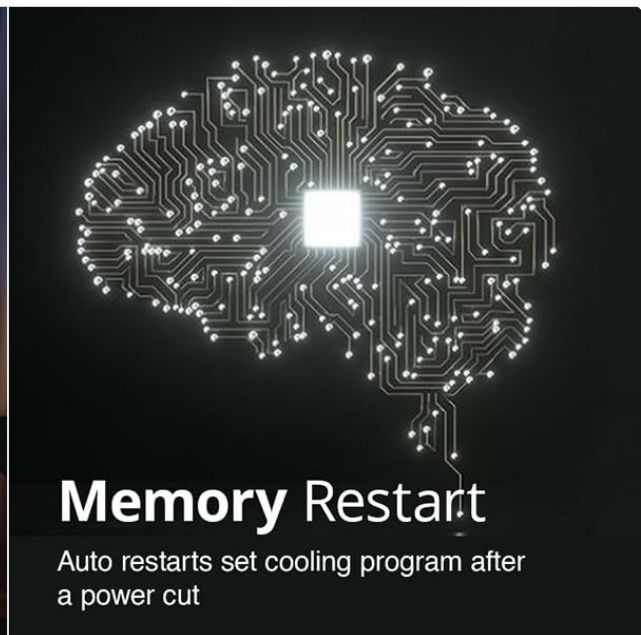

Image: Visuals demonstrating key operational features such as Sleep Mode for quiet cooling, Memory Restart for power cut recovery, SuperDry Mode for dehumidification, and Anti-Freeze Thermostat for efficient operation.

5. MAINTENANCE

Regular maintenance ensures the efficiency and longevity of your Voltas AC.

5.1 Filter Cleaning

The AC is equipped with an **Anti-Dust Filter with Anti-Microbial Coating**. This filter helps to kill air microbes, including germs, bacteria, and fungi. Regularly clean the filter to maintain air quality and cooling efficiency. Refer to the detailed cleaning instructions in the full manual for proper procedure.

5.2 Anti-Corrosive Coating

The unit features an **Anti-Corrosive Coating**, built to withstand rusting and wear, enhancing the durability of the components. While this coating provides protection, periodic inspection for any signs of wear is recommended.

5.3 Copper Condenser

The **100% Copper Condenser Tubes** ensure superior heat transfer and long-lasting durability with excellent corrosion resistance. No specific user maintenance is required for the condenser tubes beyond ensuring proper airflow to the outdoor unit.

Anti-Dust Filter with Anti-Microbial Coating

Kills air microbes including germs,
bacteria & fungi



Anti-Corrosive Coating

Built to last with anti-corrosive
coating that withstands rusting
and wear.

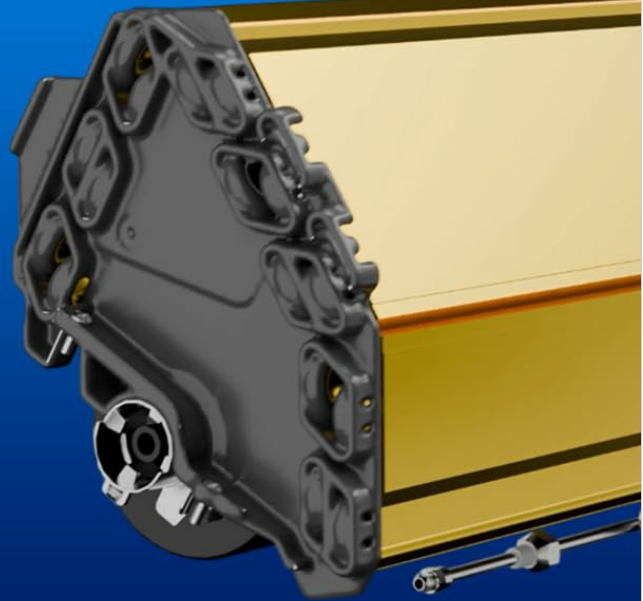

Image: Close-up views of the Anti-Dust Filter with Anti-Microbial Coating and the Anti-Corrosive Coating, highlighting their roles in air purification and unit durability.

Inverter Compressor

Smartly adjusts speed
for faster & consistent cooling
with maximum energy efficiency.



100% Copper Condenser Tubes

Ensures faster cooling
& long-lasting durability
with superior corrosion resistance.



Image: Depiction of the Inverter Compressor, which adjusts speed for efficient cooling, and the 100% Copper Condenser Tubes, known for faster cooling and durability.

6. TROUBLESHOOTING

This section provides guidance on common issues you might encounter. For complex problems, contact authorized service personnel.

6.1 Common Issues and Solutions

- **AC not turning on:** Check power supply, circuit breaker, and ensure the remote control batteries are not depleted.
- **Insufficient cooling:** Ensure doors and windows are closed. Clean air filters. Check for obstructions around the outdoor unit. Verify the selected mode and temperature settings.
- **Unusual noises:** Minor operational sounds are normal. If loud or unusual noises occur, check for loose parts or contact service.
- **Water leakage:** Check if the drain pipe is clogged or improperly installed. Ensure the indoor unit is level.

- **Error codes on display:** Refer to the self-diagnosis feature. Note down the code and consult the full manual or contact customer support.

7. SPECIFICATIONS

Detailed technical specifications of your Voltas 1.5 Ton 3 Star Inverter Split AC.

Feature	Specification
Brand	Voltas
Model	183V Vectra CAW
Capacity	1.5 Tons
Energy Efficiency	3 Star
Annual Energy Consumption	975.26 kWh/year (4800 Watts Cooling Power)
Noise Level (IDU)	44/43/42/38 dB(A)
Installation Type	Split System
Refrigerant Gas	R32 (Environmental Friendly)
Voltage	230 Volts (Wide Operating Range 110V - 285V)
Material	Plastic (Indoor Unit)
Special Features	Remote Controlled, Inverter Compressor, Dust Filter, Fast Cooling, 4 Adjustable Cooling Modes, Digital Temperature Display, Hidden Display, Anti-Corrosive Coating, LED Display, Self Diagnosis, Sleep Mode, Turbo, Memory Restart, Anti-freeze thermostat

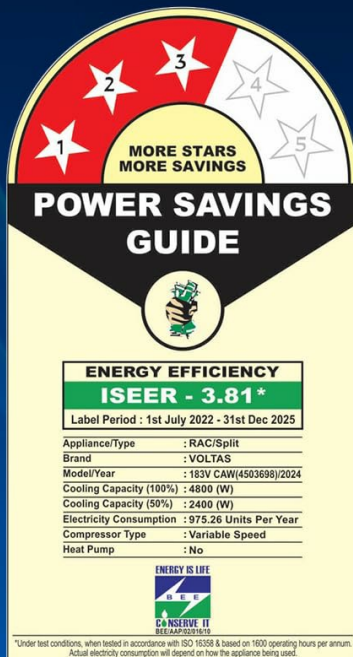

Annual Energy
Consumption

975.26
Units Per Year

Image: The Power Savings Guide label for the Voltas AC, indicating its 3-star energy efficiency rating and annual energy consumption of 975.26 units per year.

8. WARRANTY AND SUPPORT

Voltas provides comprehensive warranty coverage for your peace of mind.

- **1 Year Comprehensive Warranty** on the Product
- **10 Years Warranty** on the Inverter Compressor
- **5 Years Warranty** on the PCB (Printed Circuit Board)

For service requests or technical support, please refer to the contact information provided in your warranty card or visit the official Voltas website.

Ensure Long-lasting Performance



Image: Visual representation of the warranty terms: 1 year for the product, 5 years for the PCB, and 10 years for the compressor, ensuring long-lasting performance.

© 2024 Voltas. All rights reserved.

For more information, visit www.voltas.com