

STUDIOFINIX ST-602BX2

STUDIOFINIX 6.5 Inch Outdoor Speakers Instruction Manual

Model: ST-602BX2 | Brand: STUDIOFINIX

1. INTRODUCTION

Thank you for choosing STUDIOFINIX 6.5 Inch Outdoor Speakers. This manual provides essential information for the proper setup, operation, and maintenance of your new speakers. Designed for both indoor and outdoor environments, these speakers deliver high-performance audio with robust weather resistance. Please read this manual thoroughly before installation and use to ensure optimal performance and safety.

2. PACKAGE CONTENTS

Verify that all items listed below are present in your package:

- 4 x Passive Speakers
- 4 x Speaker Cables (5 Meters Each)
- Mounting Brackets and Hardware
- Instruction Manual (this document)

What is in the box

- 1. Passive speakers(2 pair)
- 2. Speaker connection cable,16' Ft X4



Figure 2.1: Contents of the STUDIOFINIX speaker package.

3. SPECIFICATIONS

Brand	STUDIOFINIX
Model Name	ST-602BX2
Speaker Type	Outdoor
Speaker Size	6.5 Inches (Woofer)
Tweeter Size	1 Inch Silk Dome
Speaker Maximum Output Power	800 Watts (Peak)
Connectivity Technology	Wired
Water Resistance Level	IP44 Waterproof
Material	Acrylonitrile Butadiene Styrene (ABS)
Product Dimensions (Each Speaker)	L:11.81" (30cm) x W:8.27" (21cm) x H:6.69" (17cm)

Installation Size

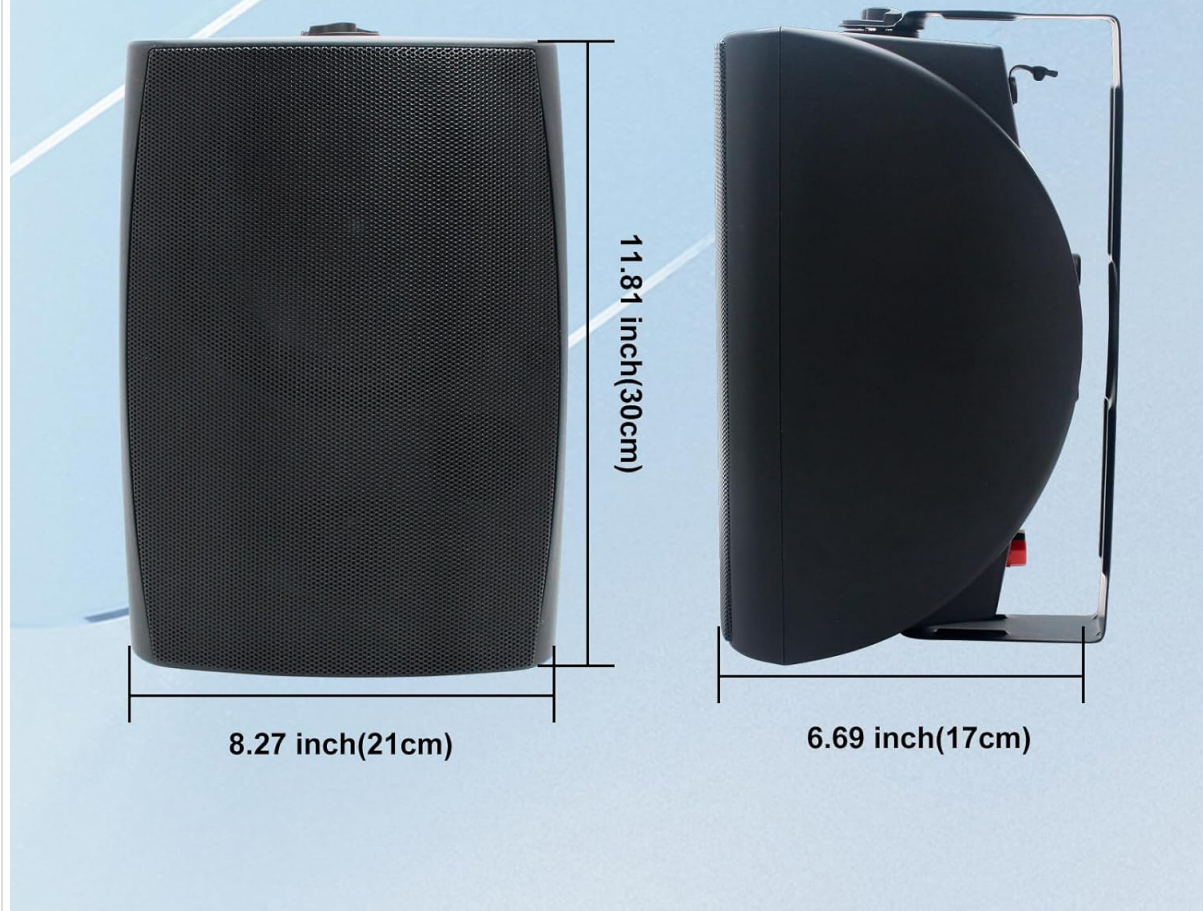

Figure 3.1: Detailed dimensions of a single speaker unit.

4. SAFETY INFORMATION

- **Power Source:** These are passive speakers and require an external amplifier. Ensure the amplifier's power output matches the speakers' requirements to prevent damage.
- **Wiring:** Always use appropriate gauge speaker wire. Incorrect wiring can lead to poor sound quality or damage to the speakers/amplifier.
- **Placement:** While waterproof (IP44 rated), avoid submerging the speakers in water. Ensure proper drainage if installed in areas prone to heavy rain.
- **Mounting:** Securely mount speakers to a stable surface using the provided hardware. Improper mounting can result in speakers falling, causing injury or damage.
- **Volume Levels:** Prolonged exposure to high volume levels can cause hearing damage. Adjust volume to a comfortable level.
- **Maintenance:** Disconnect power from the amplifier before performing any maintenance or cleaning.



Figure 4.1: The speakers feature an IP44 waterproof rating, suitable for various weather conditions.

5. SETUP & INSTALLATION

These speakers are designed for easy wall-mounted installation using the included U-shaped brackets. For optimal sound dispersion, consider the listening area when choosing placement.

5.1 Mounting the Speakers

1. **Detach the Bracket:** Carefully detach the U-shaped mounting bracket from the speaker unit.
2. **Mark Drilling Points:** Hold the bracket against the desired mounting surface and mark the drilling points for the screws. Ensure the surface is sturdy enough to support the speaker's weight.
3. **Drill Holes:** Drill pilot holes at the marked points. Use appropriate drill bits for your mounting surface (wood, masonry, etc.).
4. **Secure Bracket:** Attach the U-shaped bracket to the wall using the provided screws and anchors (if necessary). Ensure it is firmly secured.
5. **Attach Speaker:** Slide the speaker onto the bracket and secure it using the side knobs. Adjust the angle for desired sound direction and tighten the knobs to lock it in place.

Installation Steps with flexible U shape bracket

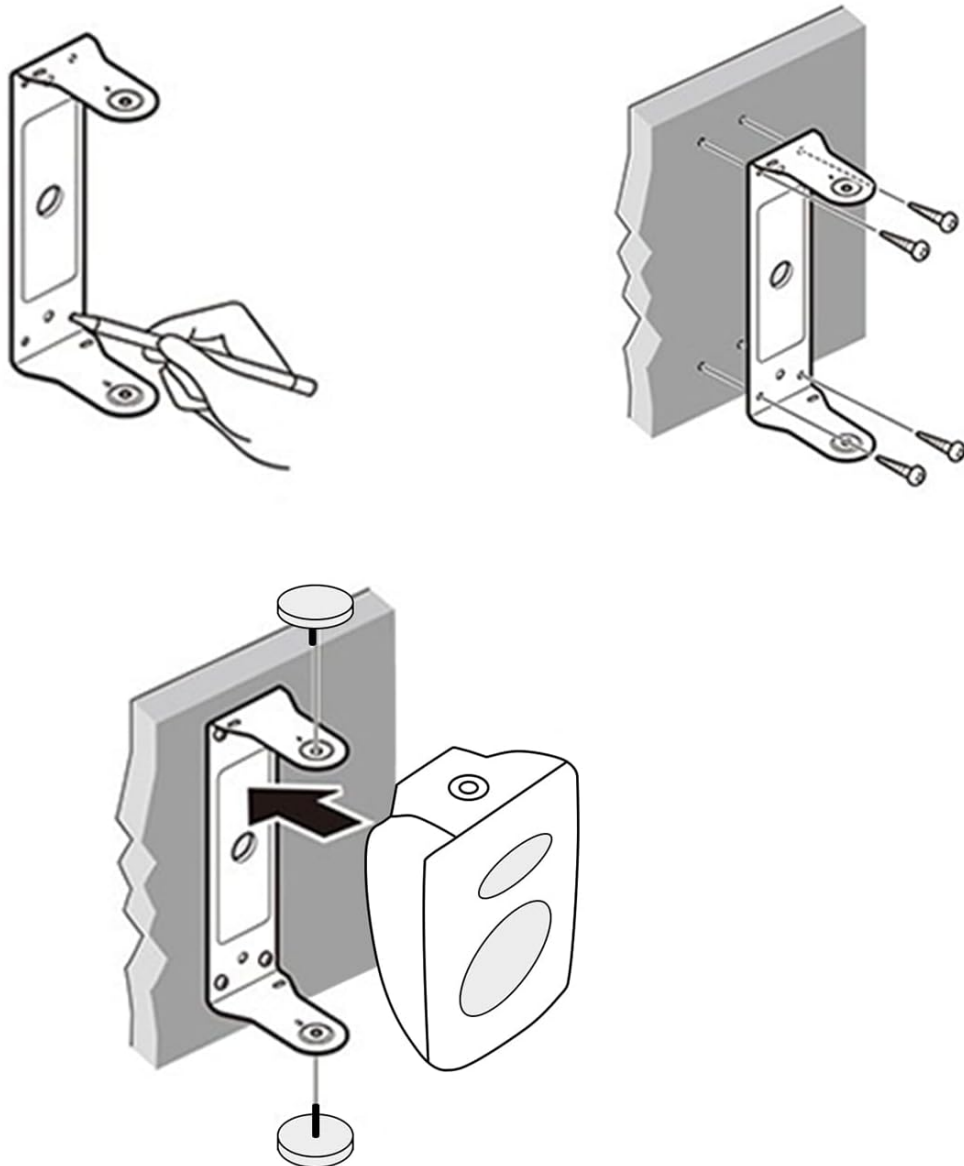

Figure 5.1: Step-by-step diagram for speaker mounting.

5.2 Wiring the Speakers

These passive speakers require connection to an external audio amplifier. Use the included speaker cables or suitable speaker wire for connection.

1. **Identify Terminals:** Locate the red (+) and black (-) terminals on the back of each speaker.
2. **Connect to Amplifier:** Connect the red wire from the speaker to the red (+) terminal on your amplifier, and the black wire from the speaker to the black (-) terminal on your amplifier. Ensure correct polarity for all speakers.
3. **Secure Connections:** Ensure all wire connections are secure to prevent signal loss or short circuits.

How to Use

(Extra Buy) →

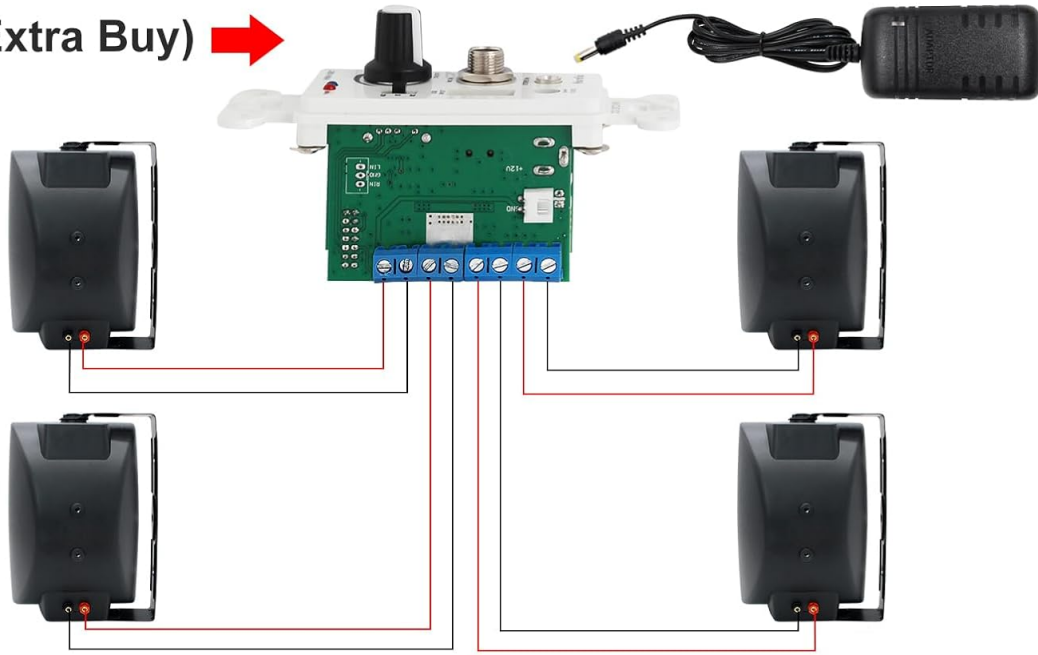

- ① 4*Passive(Include)
- ② 4*Speaker Cable(Include)
- ③ Amplifier (Not include)
- ④ Power Cord (Not include)

Speaker wier “+”

Speaker wier “-”



Figure 5.2: Wiring diagram for connecting speakers to an amplifier (amplifier and power cord not included). The speakers are versatile and can be installed in various settings, both indoors and outdoors, to enhance your audio experience.



Figure 5.3: Example installations in indoor and outdoor environments.

6. OPERATING INSTRUCTIONS

Once properly installed and connected to a compatible amplifier, operating your STUDIOFINIX speakers is straightforward:

1. **Power On:** Turn on your audio amplifier.
2. **Select Source:** Choose your desired audio source (e.g., Bluetooth receiver, CD player, streaming device) connected to your amplifier.
3. **Adjust Volume:** Start with the amplifier volume at a low setting and gradually increase it to a comfortable listening level.
4. **Sound Adjustment:** Use your amplifier's controls to adjust bass, treble, and balance for your preferred sound profile.

4X200W Max Power



Figure 6.1: The speaker's internal design, featuring a 6.5-inch woofer and a 1-inch silk dome tweeter for balanced audio output.

7. MAINTENANCE

Regular maintenance will help ensure the longevity and performance of your speakers:

- **Cleaning:** Wipe the speaker enclosures with a soft, damp cloth. Avoid using harsh chemicals or abrasive cleaners.
- **Grille Care:** The rustproof mesh grilles are designed for durability. If dust accumulates, gently brush it off.
- **Environmental Exposure:** While waterproof, it is recommended to protect speakers from extreme weather conditions (e.g., heavy snow, prolonged direct sunlight) when not in use, if possible, to maximize lifespan.
- **Connection Check:** Periodically check speaker wire connections for corrosion or looseness, especially in outdoor installations.

8. TROUBLESHOOTING

If you encounter issues with your speakers, refer to the following common problems and solutions:

Problem	Possible Cause	Solution
---------	----------------	----------

No Sound	Incorrect wiring; Amplifier off; Source not selected; Volume too low.	Check all wire connections for correct polarity and secure fit. Ensure amplifier is powered on and correct input source is selected. Increase volume gradually.
Distorted Sound	Volume too high; Amplifier clipping; Loose connections; Damaged speaker.	Reduce volume. Check amplifier's power output and ensure it's not overdriven. Verify all connections are secure. If distortion persists, contact support.
One Speaker Not Working	Loose wire connection; Damaged speaker wire; Faulty speaker.	Check connections for that specific speaker. Test with a different speaker wire if possible. If issue persists, the speaker may be faulty.

9. WARRANTY & SUPPORT

STUDIOFINIX speakers come with a **Full Warranty**. For detailed warranty terms and conditions, please refer to the warranty card included in your package or visit the official STUDIOFINIX website. If you require technical assistance, troubleshooting beyond this guide, or have any questions, please contact STUDIOFINIX customer support through the contact information provided on our website or your purchase platform.