

[Manuals.plus](#) /

> [upscreen](#) /

> upscreen Matte Screen Protector for TOKVIA T102 GSM Instruction Manual

upscreen T102 GSM

upscreen Matte Screen Protector for TOKVIA T102 GSM Instruction Manual

1. INTRODUCTION

This manual provides instructions for the proper installation and care of your upscreen Matte Hybrid Glass Premium Screen Protector, specifically designed for the TOKVIA T102 GSM device. This screen protector offers enhanced scratch protection, reduces glare, and minimizes fingerprints, ensuring optimal display visibility and touch sensitivity.

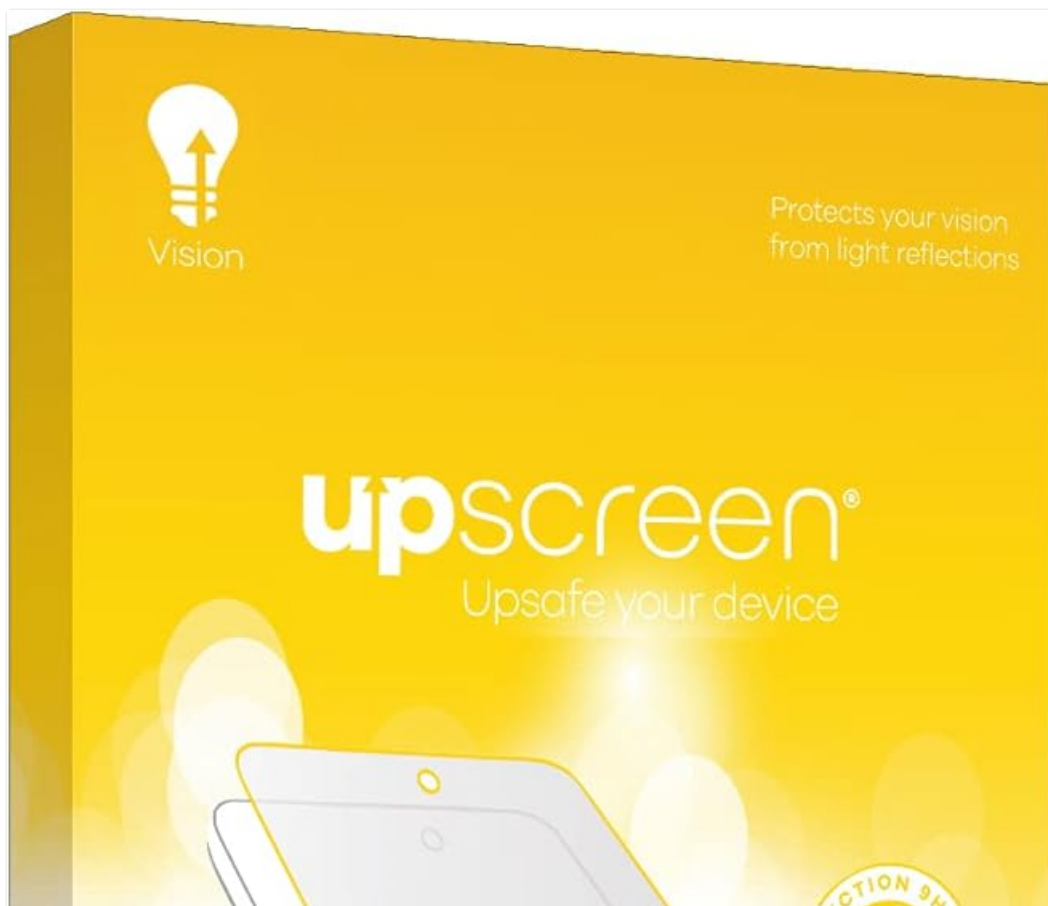

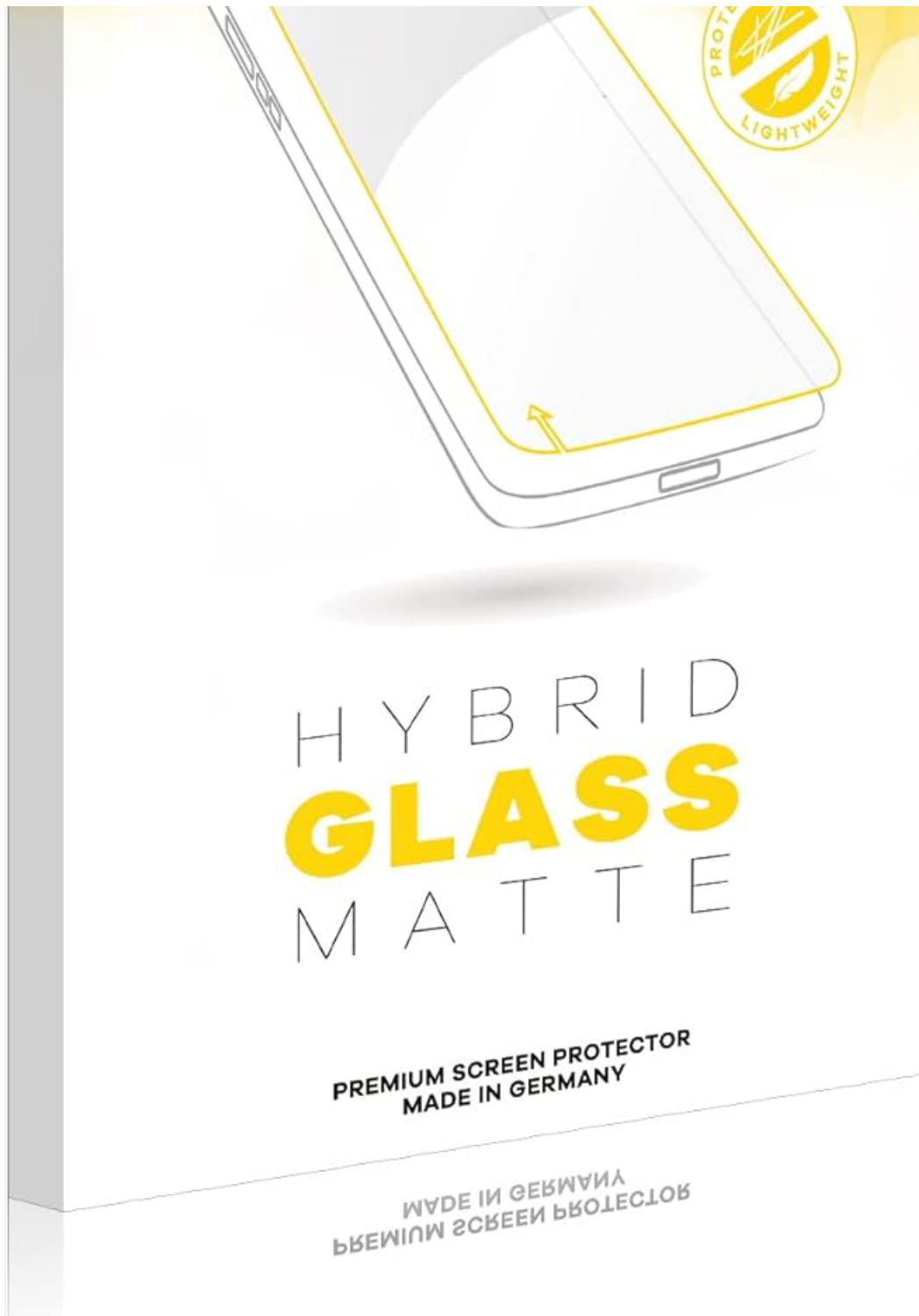

Figure 1: upscreen Matte Screen Protector product packaging.

Product Features:

- **9H Scratch Protection:** Provides robust defense against scratches and damage.
- **Anti-Glare:** Matte surface reduces reflections from light and sun.
- **Anti-Fingerprint:** Special coating resists grease and smudges, making cleaning easier.
- **Flexible Hybrid Glass:** More flexible than traditional tempered glass while maintaining high protection.
- **Bubble-Free Installation:** Optimized adhesive layer for easy, smooth application.
- **Made in Germany:** Manufactured to high quality standards.



Figure 2: Key features of the upscreen Matte Screen Protector.

2. SETUP AND INSTALLATION

Careful preparation is essential for a successful, bubble-free installation. Ensure you are in a clean, dust-free environment.

Package Contents:

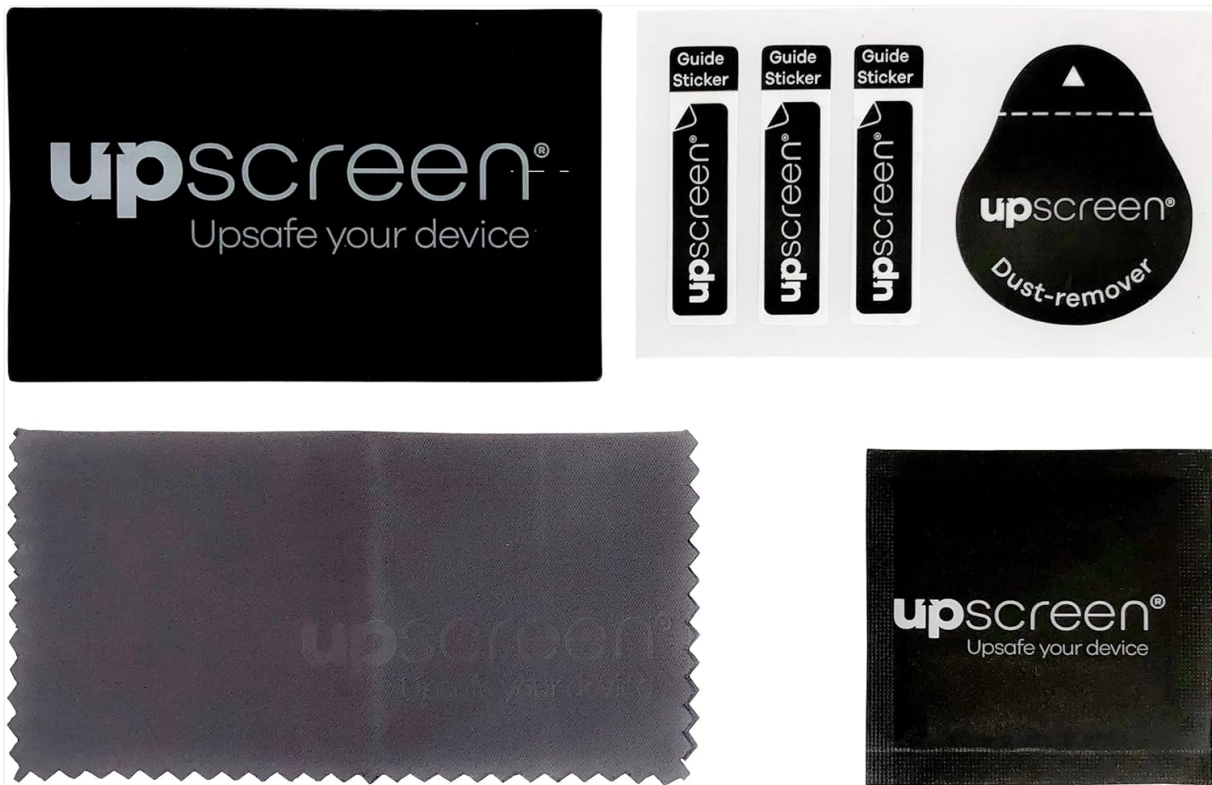

Figure 3: Included installation kit components.

- 1x upscreen Hybrid Glass Matte Screen Protector
- 1x Cleaning Wipe
- 1x Smoothing Card
- 1x Wet Pad
- 1x Dust Remover Sticker
- 3x Guide Stickers (Positioning Aid)
- Installation Instructions (this document)

Installation Steps:

1. **Clean the Device Screen:** Use the provided wet pad to thoroughly clean the TOKVIA T102 GSM screen. Follow with the cleaning wipe to dry and remove any residue.
2. **Remove Dust:** Use the dust remover sticker to lift any remaining dust particles from the screen. Ensure the screen is completely free of dust before proceeding.
3. **Positioning:** Carefully align the screen protector with your device's screen. Use the guide stickers to temporarily secure the protector in place, ensuring perfect alignment with the edges and cutouts.
4. **Application:** Gently peel off the protective film from the adhesive side of the screen protector. Slowly lower the protector onto the device screen, starting from one edge and allowing it to adhere gradually.
5. **Remove Bubbles:** Use the smoothing card to gently push out any air bubbles towards the edges of the screen. Apply light, even pressure. Small bubbles may disappear within 24-48 hours.
6. **Final Touches:** Once applied, remove the guide stickers and any remaining protective films from the top surface of the screen protector.

3. OPERATING AND DAILY USE

Once installed, the upscreen Matte Screen Protector operates seamlessly with your TOKVIA T102 GSM. Its design ensures that the original touch sensitivity of your device is maintained. The matte finish actively reduces glare from ambient light, improving screen visibility in various conditions. The anti-fingerprint coating helps keep

your screen cleaner for longer during daily interactions.



Figure 4: The flexible nature of the hybrid glass material.

4. MAINTENANCE

To maintain the clarity and effectiveness of your screen protector, follow these simple cleaning guidelines:

- Use a soft, lint-free cloth (like the included cleaning wipe) to gently wipe the screen protector.
- For stubborn smudges, slightly dampen the cloth with water or a screen-safe cleaning solution. Avoid harsh chemicals or abrasive materials.
- Do not apply excessive pressure when cleaning, as this could potentially dislodge the protector or damage the device screen.

5. TROUBLESHOOTING

Common Issues and Solutions:

- **Air Bubbles After Installation:**
Solution: For small bubbles, gently push them towards the nearest edge with the smoothing card. If large bubbles persist, carefully lift the nearest edge of the protector and reapply, ensuring no dust is trapped

underneath.

- **Dust Particles Trapped Underneath:**

Solution: If dust is visible, carefully lift the nearest edge of the protector. Use the dust remover sticker to gently dab and lift the particle from both the screen and the adhesive side of the protector. Reapply carefully.

- **Screen Protector Not Adhering Properly:**

Solution: Ensure the screen was thoroughly cleaned and free of oils or residues before application. If the issue persists, the protector may need to be replaced.

- **Reduced Touch Sensitivity:**

Solution: The upscreen protector is designed to maintain original touch sensitivity. If you experience issues, ensure the protector is correctly aligned and fully adhered. Check device settings for touch sensitivity adjustments if available.

6. SPECIFICATIONS

Attribute	Detail
Brand	upscreen
Compatible Devices	TOKVIA T102 GSM
Material	Hybrid Glass (Plastic-Glass Composite)
Hardness	9H
Features	Anti-Glare, Anti-Fingerprint, Scratch Resistant, Bubble-Free Installation
Product Dimensions	7 x 4 x 0.5 inches (packaging) / 7"L x 4"W (protector)
Manufacturer	upscreen

7. WARRANTY AND SUPPORT

For specific warranty information regarding your upscreen Matte Screen Protector, please refer to the documentation provided at the point of purchase or contact the seller directly. General product support and further inquiries can be directed to the manufacturer, upscreen, through their official website or customer service channels.