

[Manuals.plus](#) /

› [Baseus](#) /

› Baseus A5 16000Pa Cordless Car Vacuum Cleaner User Manual

Baseus VCAQ040001

Baseus A5 16000Pa Cordless Car Vacuum Cleaner User Manual

Model: VCAQ040001 | Brand: Baseus

INTRODUCTION

Thank you for choosing the Baseus A5 16000Pa Cordless Car Vacuum Cleaner. This compact and powerful device is designed for efficient cleaning of car interiors and other small spaces. Featuring a robust 16000Pa suction, a washable HEPA filter, and versatile nozzles, it provides a convenient solution for maintaining cleanliness. Please read this manual carefully to ensure proper use, maintenance, and optimal performance of your vacuum cleaner.

WHAT'S IN THE BOX

Upon unboxing your Baseus A5 Cordless Car Vacuum Cleaner, please verify that all components listed below are present:

- Baseus A5 Cordless Car Vacuum Cleaner Unit
- Crevice Nozzle
- Suction Nozzle
- Brush + Suction Nozzle
- Air Pumping Nozzle
- USB Charging Cable
- User Manual (this document)



Image: Contents of the Baseus A5 package, showing the main unit, multiple nozzles, and charging cable.

SETUP

Charging the Device

Before first use, fully charge the vacuum cleaner. Connect the provided USB charging cable to the charging port on the device and to a compatible USB power source (e.g., car USB port, wall adapter). The charging indicator will show the charging status. A full charge typically takes approximately 30 minutes and provides up to 30 minutes of runtime.

Attaching Nozzles

To attach a nozzle, align the desired nozzle with the suction opening of the vacuum cleaner and push firmly until it clicks into place. Ensure a secure connection for optimal suction.

Dust-Air Separate Design

Exhausts dust and air separately to avoid secondary pollution



Baseus A5 Air

Exhausts clean air and traps dust inside.



Others

Sprays out dust while vacuuming.

Image: The Baseus A5 vacuum cleaner connected to a USB charging cable.

OPERATING INSTRUCTIONS

Power On/Off and Suction Modes

Press the power button to turn on the vacuum cleaner. The device may have multiple suction modes. Press the power button again to cycle through available modes (e.g., standard, ECO mode). Press and hold the power button to turn off the device.

Using the Nozzles

- **Crevice Nozzle:** Ideal for reaching tight spaces, corners, and gaps in car seats or upholstery.
- **Suction Nozzle:** Suitable for general dust cleaning on various surfaces like seats, sofas, and cabinet corners.
- **Brush + Suction Nozzle:** Best for removing dust from cushion surfaces, carpeted areas, air conditioning vents, and other textured surfaces.
- **Air Pumping Nozzle:** Install this nozzle to use the vacuum cleaner for vacuum compression, such as for storage bags or inflatables, saving space.

Various Nozzles to Meet your Needs

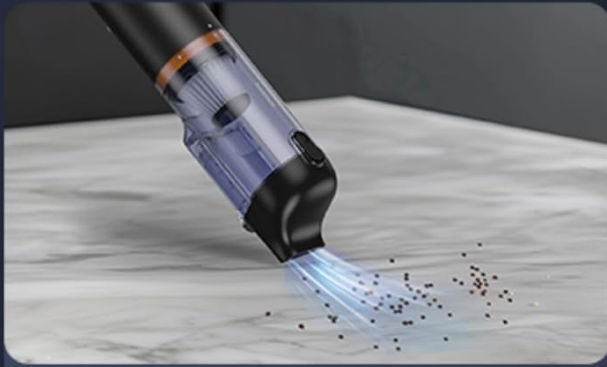

Crevice Nozzle

Suitable for some larger garbage



Suction Nozzle

Suitable for dust cleaning in various crevices such as seats, sofas, cabinet corners, drawers, etc.



Brush+Suction Nozzle

Suitable for removing dust from cushion surfaces, carpeted areas, air conditioning vents, and other surfaces.



Air pumping Nozzle

Install the air nozzle to store your air bed and inflatables with ease, saving more space

Image: Illustration of the different nozzles and their recommended uses for the Baseus A5 vacuum cleaner.

12000Pa Powerful Suction & 2-in-1 suction nozzle



Image: The Baseus A5 vacuum cleaner demonstrating its 12000Pa suction power in ECO mode.

Powerful Vacuum Compression

Air nozzle is included for vacuum compression,
saving more space for storage.

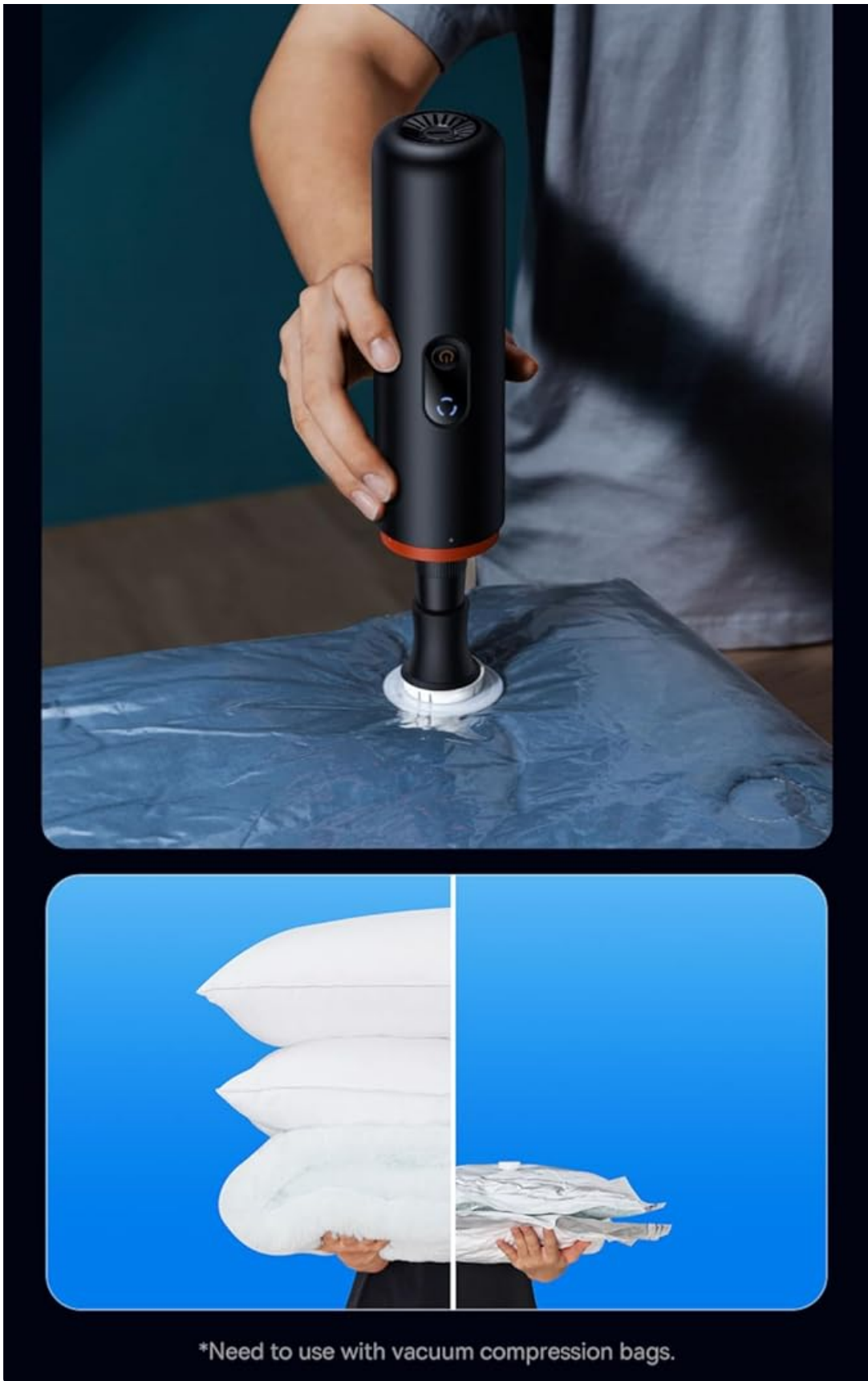

Image: The Baseus A5 vacuum cleaner utilizing its air pumping nozzle for vacuum compression, useful for storage.

MAINTENANCE

Emptying the Dustbin

To maintain optimal suction and prevent blockages, empty the dustbin regularly. Press the release button to detach the dustbin from the main unit. Dispose of the collected debris and reattach the dustbin securely.

Cleaning the HEPA Filter

The Baseus A5 features a washable and reusable HEPA filter. After emptying the dustbin, remove the HEPA filter. Rinse it under running water until clean. Ensure the filter is completely dry before reinserting it into the vacuum cleaner. Regular cleaning of the filter is crucial for maintaining high filtration efficiency.



Image: The washable HEPA filter of the Baseus A5, demonstrating its easy removal and cleaning process.

Dust-Air Separate Design

Exhausts dust and air separately to avoid secondary pollution

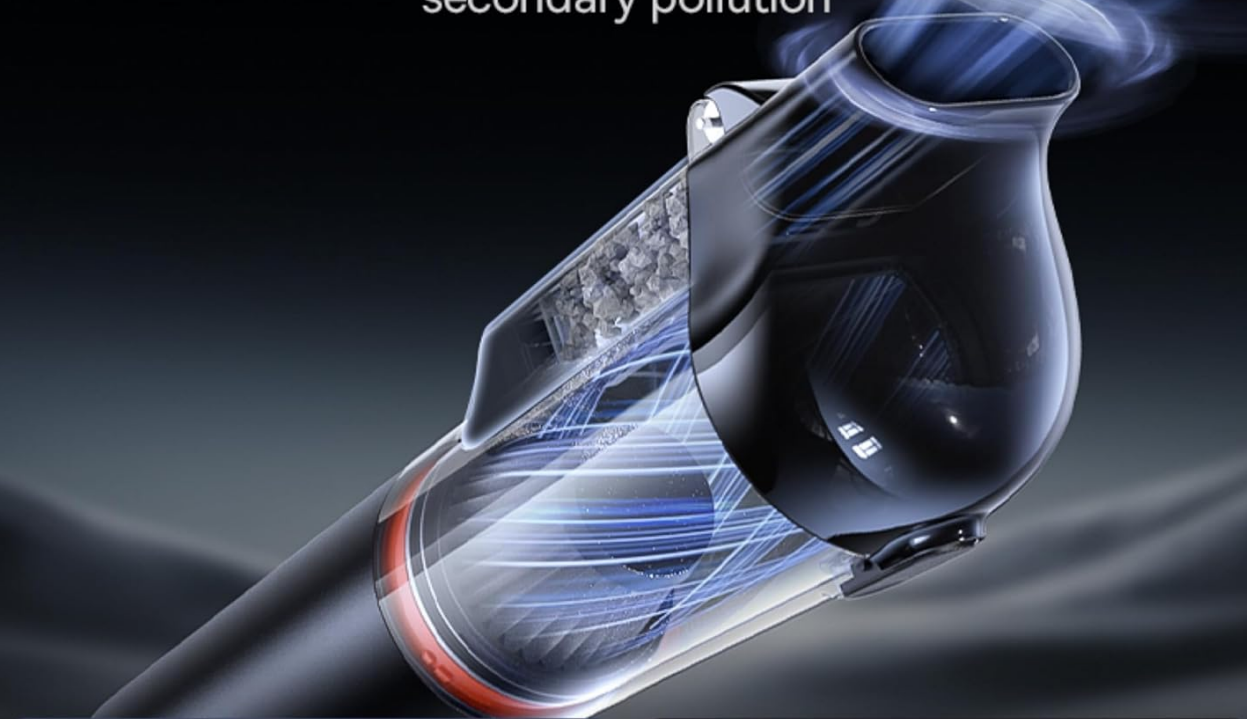

Baseus A5 Air

Exhausts clean air and traps dust inside.



Others

Sprays out dust while vacuuming.

Image: The dust-air separate design of the Baseus A5, which exhausts dust and air separately to avoid secondary pollution.

TROUBLESHOOTING

- **Low Suction Power:** Check if the dustbin is full and empty it if necessary. Ensure the HEPA filter is clean and properly installed. Verify that no nozzles or the main suction inlet are blocked.
- **Short Battery Life:** Ensure the device is fully charged before use. Battery performance can vary based on the selected suction mode and age of the battery.
- **Device Not Turning On:** Confirm the battery is charged. If the device still does not turn on, ensure the power button is pressed correctly.
- **Smart Blockage Alert:** If the device indicates a blockage, immediately turn it off. Inspect the dustbin, filter, and nozzles for any obstructions and clear them before resuming operation.



Image: The Baseus A5 vacuum cleaner highlighting its easy dust emptying mechanism and smart blockage alert system.

SPECIFICATIONS

Brand	Baseus
Model Name	VCAQ040001
Special Feature	Cordless, Portable
Filter Type	HEPA, Cyclonic
Surface Recommendation	Upholstery, Car Interiors
Power Source	Battery Powered (Lithium-ion)
Voltage	12 Volts
Included Components	1 package (Vacuum Cleaner, Nozzles, USB Cable)

Capacity	150 Milliliters
Power	130 Watts
Maximum Suction	16 Kilopascals (16000Pa)
Color	Black
Number of Power Levels	1
Connectivity Technology	USB
Battery Life / Runtime	30 minutes

WARRANTY AND SUPPORT

The Baseus A5 16000Pa Cordless Car Vacuum Cleaner comes with a **2-year manufacturer's warranty**. For warranty claims, technical support, or any product-related inquiries, please refer to the contact information provided in your product packaging or visit the official Baseus store on Amazon: [Baseus Amazon Store](#).