

## Mecer M17QF6-3G+

# Mecer Xpress Smartlife 10.1-Inch M17QF6-3G+ Android 11 Tablet User Manual

Model: M17QF6-3G+

## 1. INTRODUCTION

This manual provides detailed instructions for the Mecer Xpress Smartlife 10.1-inch M17QF6-3G+ Android 11 Tablet. Please read this manual thoroughly before using your device to ensure proper operation and to maximize its performance and longevity.

The Mecer Xpress Smartlife M17QF6-3G+ is a 10.1-inch tablet featuring Android 11, a quad-core processor, 3G/HSPA+ connectivity, and dual SIM card support. It is designed for everyday tasks, media consumption, and staying connected on the go.



Image 1.1: Front view of the Mecer Xpress Smartlife 10.1-inch M17QF6-3G+ Tablet. The tablet features a black bezel and a vibrant display showing abstract orange, yellow, and blue shapes.

## 2. KEY FEATURES

---

- **Display:** 10.1-inch IPS display with 1280 x 800 resolution.
- **Processor:** SC7731 Quad Core CPU (1.3GHz).
- **Operating System:** Android 11 (Google Certified).
- **Memory & Storage:** 4GB RAM, 32GB internal storage, expandable via MicroSD card.
- **Connectivity:** Embedded 802.11 b/g/n Wireless LAN, Bluetooth 4.2, Integrated 3G/HSPA+ (voice and data, 21Mbps), Dual SIM card slots.
- **Cameras:** 0.3M Pixel Front Camera, 2.0M Pixel Rear Camera.
- **Audio:** Built-in sound, speakers, and microphone.

## 3. SETUP

---

### 3.1 Initial Power On

1. Ensure the tablet is sufficiently charged. Connect the provided charger to the tablet and a power outlet if the battery is low.
2. Press and hold the Power button (usually located on the side) for a few seconds until the Mecer logo appears on the screen.
3. Follow the on-screen prompts to select your language, region, and agree to the terms and conditions.

### 3.2 SIM Card and MicroSD Card Installation

The tablet supports dual SIM cards and a MicroSD card for expanded storage.

1. Locate the SIM/MicroSD card tray on the side of the tablet.
2. Use the provided SIM ejector tool (if applicable) or a small paperclip to gently press into the small hole on the tray to eject it.
3. Carefully place your SIM card(s) and/or MicroSD card into the designated slots on the tray, ensuring correct orientation.
4. Gently push the tray back into the tablet until it clicks into place.

### 3.3 Connecting to Wi-Fi

1. From the home screen, swipe down from the top to open the Quick Settings panel.
2. Tap and hold the Wi-Fi icon to open Wi-Fi settings.
3. Toggle Wi-Fi ON if it's off.
4. Select your desired Wi-Fi network from the list.
5. Enter the network password if prompted, then tap "Connect".

### 3.4 Google Account Setup

A Google account is required to download apps from the Google Play Store and access Google services.

1. During initial setup, you will be prompted to sign in with your Google account. Enter your Gmail address and password.
2. If you skip this step, you can add an account later by going to **Settings > Accounts > Add account > Google**.
3. Follow the on-screen instructions to complete the setup.

---

## 4. OPERATING INSTRUCTIONS

### 4.1 Basic Navigation

- **Touch:** Tap an icon to open an app or select an item.
- **Touch and Hold:** Press and hold an item to access additional options or move it.
- **Swipe:** Drag your finger across the screen to scroll through pages or lists.
- **Pinch:** Use two fingers to zoom in or out on images and web pages.
- **Home Button:** Returns to the home screen.
- **Back Button:** Returns to the previous screen.
- **Recent Apps Button:** Displays recently opened applications.

## 4.2 App Management

- **Installing Apps:** Open the Google Play Store app, search for your desired app, and tap "Install".
- **Uninstalling Apps:** Touch and hold an app icon on the home screen or app drawer, then drag it to "Uninstall" (if available) or go to **Settings > Apps & notifications > See all apps**, select the app, and tap "Uninstall".

## 4.3 Connectivity

- **Bluetooth:** Enable Bluetooth in Quick Settings or **Settings > Connected devices > Connection preferences > Bluetooth** to pair with headphones, speakers, or other devices.
- **3G/HSPA+ (Mobile Data):** Ensure a valid SIM card is inserted. Enable Mobile Data in Quick Settings or **Settings > Network & internet > Mobile network**

## 4.4 Camera Usage

1. Open the Camera app from the home screen or app drawer.
2. Tap the shutter button to take a photo.
3. Tap the video icon to switch to video recording mode.
4. Use the front/rear camera switch icon to change cameras.

## 5. MAINTENANCE

---

### 5.1 Charging the Battery

Connect the tablet to the provided power adapter and a wall outlet. The battery indicator on the screen will show charging status. For optimal battery life, avoid fully discharging the battery frequently.

### 5.2 Cleaning the Tablet

Use a soft, lint-free cloth to clean the screen and body of the tablet. Do not use harsh chemicals or abrasive materials. Avoid getting moisture into ports.

### 5.3 Software Updates

Periodically check for system updates to ensure your tablet has the latest features and security patches. Go to **Settings > System > System update** to check for and install available updates.

### 5.4 Storage Management

To manage internal storage, go to **Settings > Storage**. You can free up space by uninstalling unused apps, deleting old files, or moving media to a MicroSD card.

## 6. TROUBLESHOOTING

---

- **Tablet not turning on:** Ensure the battery is charged. Connect the charger and try again. If unresponsive, press and hold the power button for 10-15 seconds for a forced restart.
- **Wi-Fi connection issues:** Check if Wi-Fi is enabled. Restart your Wi-Fi router. Forget the network in tablet settings and reconnect.
- **Apps crashing or freezing:** Close and reopen the app. Clear the app's cache (**Settings > Apps & notifications > See all apps > [App Name] > Storage & cache > Clear cache**). Restart the tablet.
- **Slow performance:** Close unused apps. Clear cache. Check available storage. Consider a factory reset as a last resort (backup data first).
- **No sound:** Check volume levels. Ensure headphones are not connected. Restart the tablet.

## 7. SPECIFICATIONS

Feature	Detail
Brand	Mecer
Model Name	Xpress Smartlife M17QF6-3G+
Screen Size	10.1 Inches
Operating System	Android 11
Processor	SC7731 Quad Core CPU (1.3GHz)
RAM Memory	4 GB
Internal Storage	32 GB (expandable via MicroSD)
Wireless Communication	Wi-Fi (802.11 b/g/n), Bluetooth 4.2, 3G/HSPA+
Cameras	0.3M Pixel Front, 2.0M Pixel Rear
Included Components	1 x Xpress Smartlife 10.1 Inch M17QF6-3G+ Android 11 Google Certified Tablet
Product Dimensions	25L x 1W x 15Th centimetres





## 8. WARRANTY AND SUPPORT

### 8.1 Warranty Information

The Mecer Xpress Smartlife M17QF6-3G+ Tablet comes with a **1 Year Limited Warranty**. Please retain your proof of purchase for warranty claims. The warranty covers manufacturing defects but typically excludes damage caused by misuse, accidents, or unauthorized repairs.

### 8.2 Customer Support

For technical assistance, warranty claims, or further inquiries, please contact your retailer or the Mecer customer support channels. Refer to the packaging or Mecer's official website for contact details.

 <p><b>Mecer IP-S300FF7-2</b> 300W 80 Plus Universal TFX 2.0 Power Supply</p> <p>Product Overview</p> <p>Technical Specifications</p> <p>Features</p> <p>Warranty</p>	<p><a href="#">Mecer IP-S300FF7-2 300W 80 Plus Universal TFX 2.0 Power Supply</a></p> <p>Detailed information on the Mecer IP-S300FF7-2, a 300W 80 Plus Universal TFX 2.0 Power Supply from ComX Computers. Includes product overview and specifications.</p>
 <p><b>Q2400-2400</b> Mecer Kapa Energy Q2400 Portable Power Station Pure Sine Wave - 2400W with 1700Wh Battery</p> <p>Product Overview</p> <p>Technical Specifications</p> <p>Features</p> <p>Warranty</p>	<p><a href="#">Mecer Kapa Energy Q2400 Portable Power Station - 2400W Pure Sine Wave</a></p> <p>Detailed specifications for the Mecer Kapa Energy Q2400 Portable Power Station, featuring a 2400W pure sine wave output, 1700Wh battery capacity, 1300W MPPT solar charger, and multiple USB ports.</p>
	<p><a href="#">M3000 ESS Lithium Iron Phosphate Battery Energy Storage System User Manual</a></p> <p>Comprehensive user manual for the M3000 ESS Lithium Iron Phosphate Battery Energy Storage System by MECER, covering specifications, installation, operation, maintenance, and troubleshooting.</p>
 <p><b>MANUAL</b> <b>MOBII TABLET</b></p> <p>English Manual.....3-19</p> <p>English Manual.....38-55</p> <p>Deutsch Manual.....38-60</p> <p>Portuguese Manual.....38-65</p> <p>Manual de usuario.....61-74</p> <p>Ukrainian Manual.....75-84</p> <p>Буклет на українській.....85-104</p> <p>Буклет на російській.....105-121</p> <p><b>Tablet</b></p> <p>www.pontoview.online.com</p>	<p><a href="#">Manual de la Tablet Mobii: Guía Completa</a></p> <p>Descubra cómo usar su tablet Mobii con este manual detallado. Aprenda sobre sus características, botones, carga, transferencia de archivos, navegación web y personalización.</p>
 <p><b>Tab8 3G V8</b> MANUALE UTENTE USER MANUAL</p>	<p><a href="#">Trevi Tab8 3G V8 User Manual - Guida all'uso e Specifiche Tecniche</a></p> <p>Manuale utente completo per il tablet Trevi Tab8 3G V8. Scopri come configurare il dispositivo, utilizzare le sue funzioni, connetterti a reti Wi-Fi e 3G, e accedere a tutte le specifiche tecniche.</p>

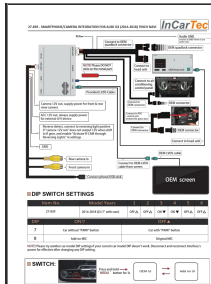

[27-839 - Smartphone/Camera Integration for Audi Q3 \(2014-2018\) 7-inch Navi](#)

User manual and installation guide for the 27-839 module, enabling smartphone integration (Apple CarPlay, Android Auto) and camera input for Audi Q3 (2014-2018) with 7-inch MMI navigation systems. Features wireless and wired connectivity, audio settings, parking assistance, and advanced options.