

Rheem RHE-CHN06P

Rheem Essentials RHE-CHN06P 6L/Min LP Gas Instant Water Heater User Manual

Model: RHE-CHN06P

1. INTRODUCTION

This manual provides essential instructions for the safe and efficient installation, operation, and maintenance of your Rheem Essentials RHE-CHN06P 6 Liters Per Minute LP Gas Instant Water Heater. Please read this manual thoroughly before installation and use, and retain it for future reference. This appliance is designed to provide instant and continuous hot water for single-service applications, such as one shower, making it ideal for apartments or small homes.



Figure 1.1: Front view of the Rheem Essentials RHE-CHN06P Instant Water Heater. This image displays the compact design of the water heater, featuring the Rheem logo at the top, ventilation grilles, and two control knobs at the bottom for temperature and water flow adjustment. The gas and water connections are visible at the very bottom.

2. SAFETY INFORMATION

WARNING: Improper installation, adjustment, alteration, service, or maintenance can cause property damage, injury, or death. Read the installation, operating, and maintenance instructions thoroughly before installing or servicing this equipment.

- **Professional Installation Required:** Installation must be performed by a qualified and licensed professional in accordance with all local codes and regulations.
- **Ventilation:** Ensure adequate ventilation for the appliance. This water heater must be installed in roofed places with proper air circulation to prevent carbon monoxide accumulation.
- **Gas Supply:** Verify that the gas type (LP Gas) matches the appliance specifications. Do not use natural gas with this unit.
- **Water Pressure:** The unit requires a minimum water pressure of 2 liters per minute for operation. Ensure your water supply meets this requirement.

- **Leak Detection:** After installation, check all gas and water connections for leaks using appropriate methods (e.g., soapy water for gas lines).
- **Overheat Protection:** The unit is equipped with overheat protection. Do not tamper with safety devices.
- **Children and Pets:** Keep children and pets away from the appliance during operation.

3. PACKAGE CONTENTS

Upon unpacking, please verify that all components listed below are present and undamaged:

- Rheem Essentials 6L/Min Gas LP Instant Water Heater (1 unit)
- Instruction Manual
- Warranty Certificate

Note: Additional installation accessories such as gas hoses, water connectors, and mounting hardware are typically not included and must be purchased separately.

4. PRODUCT FEATURES

The Rheem Essentials RHE-CHN06P Instant Water Heater offers several key features designed for convenience and efficiency:

- **Instant and Unlimited Hot Water:** Provides hot water on demand, eliminating the need for a storage tank.
- **Reduced Gas Consumption:** Efficient design helps minimize LP gas usage.
- **Easy Electronic Spark Ignition:** The unit ignites automatically when the hot water faucet is opened, without a pilot light.
- **High Efficiency Burner:** Ensures optimal heating performance.
- **Ergonomic Knobs:** For precise control over water temperature and flow.
- **Ultra Fit Design:** Compact dimensions (33 x 33 x 49 cm) make it suitable for installation in small spaces.
- **Low Water Pressure Operation:** Designed to function effectively with a minimum water flow of 2 liters per minute.
- **Multiple Safety Systems:** Includes overheat protection for user safety.

 **Máximo**
Ahorro de Gas

 **Agua caliente**
al instante

 **Ajuste de**
Temperatura por perilla



Figure 4.1: Key features of the water heater, highlighting maximum gas savings, instant hot water delivery, and temperature adjustment via a knob. This image visually reinforces the benefits of the instantaneous heating system.

5. SETUP AND INSTALLATION

IMPORTANT: Installation must be carried out by a certified professional to ensure safety and compliance with all local regulations.

1. **Location Selection:** Choose a roofed location with adequate ventilation. The compact "Ultra Fit" design allows for installation in small spaces. Ensure the wall can support the unit's weight (6 kg).
2. **Mounting:** Securely mount the water heater to a sturdy wall using appropriate hardware (not included). Refer to the dimensions provided in the specifications section for proper spacing.
3. **Gas Connection:** Connect the LP gas supply line to the designated inlet at the bottom of the unit. Use only approved gas connectors and ensure all connections are tight and leak-free.
4. **Water Connections:** Connect the cold water inlet and hot water outlet lines to the corresponding ports at the bottom of the unit. The unit requires a minimum water flow of 2 liters per minute to operate.
5. **Ventilation System:** Ensure the exhaust flue is properly installed and vented to the outside according to local

codes.

6. **Battery Installation:** The unit requires batteries for the electronic ignition system. Install the specified batteries (typically D-cell, refer to the unit's battery compartment for exact type and quantity).

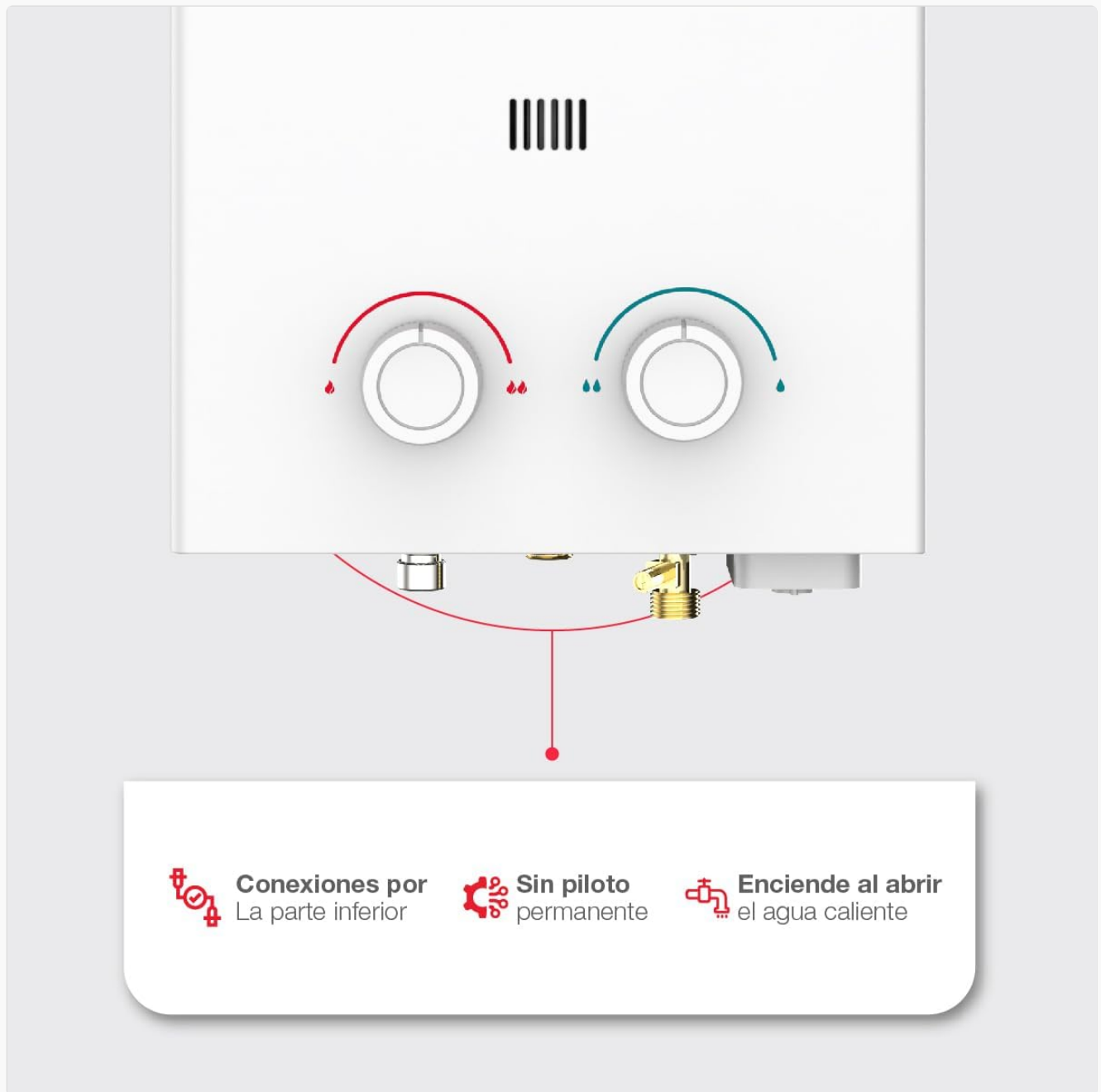

Figure 5.1: Illustration showing the bottom connections of the water heater, indicating where water and gas lines attach. It also highlights the "no permanent pilot" feature and that the unit ignites automatically when the hot water faucet is opened.

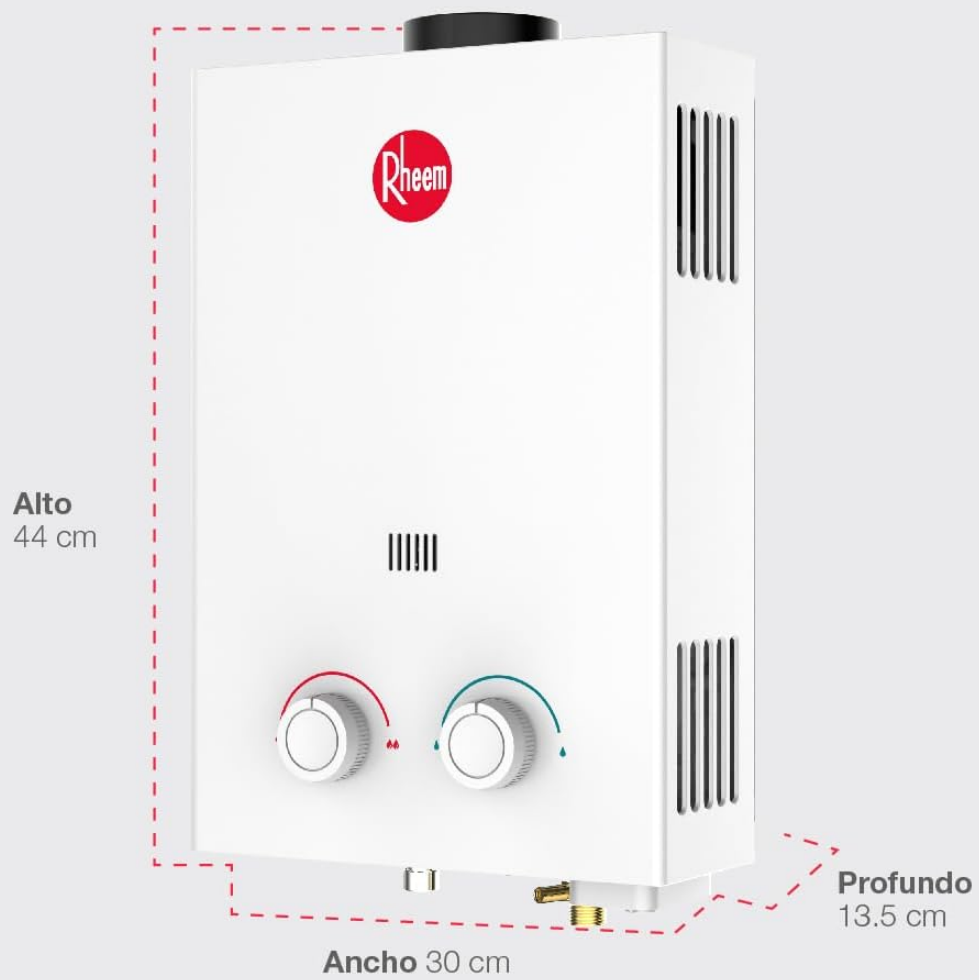

Figure 5.2: Dimensional diagram of the water heater, showing its height (44 cm), width (30 cm), and depth (13.5 cm). These measurements are crucial for planning the installation space.



Figure 5.3: Example installation of the Rheem Instant Water Heater in a compact laundry area. This image demonstrates how the unit's slim design allows it to fit discreetly above a washing machine, optimizing space.

6. OPERATING INSTRUCTIONS

Operating your Rheem Essentials Instant Water Heater is straightforward:

1. **Power On:** Ensure the gas supply is open and batteries are correctly installed.
2. **Activate Hot Water:** Simply open any hot water faucet connected to the unit. The electronic ignition system will automatically detect water flow and ignite the burner, providing instant hot water.
3. **Adjust Temperature:** Use the ergonomic knob on the front panel to adjust the desired water temperature. Turning the knob towards the red indicator typically increases temperature, while turning towards the blue indicator decreases it.
4. **Adjust Water Flow:** A separate knob may be present to adjust the water flow rate, which can also influence the final water temperature.
5. **Shut Off:** Close the hot water faucet. The unit will automatically turn off the burner.



Figure 6.1: Diagram illustrating the instantaneous LP Gas operation and its suitability for a single service point (e.g., one shower). This image visually explains the core functionality and capacity of the water heater.

7. MAINTENANCE

Regular maintenance ensures the longevity and efficient operation of your water heater. Always turn off the gas supply and disconnect power (remove batteries) before performing any maintenance.

- **Exterior Cleaning:** Clean the exterior casing with a soft, damp cloth. Do not use abrasive cleaners or solvents.
- **Ventilation Check:** Periodically inspect the ventilation grilles and flue for any obstructions. Ensure proper airflow is maintained.
- **Gas and Water Connections:** Annually inspect all gas and water connections for signs of leaks or corrosion. Tighten any loose connections.
- **Battery Replacement:** Replace the ignition batteries as needed, typically when ignition becomes inconsistent or fails.
- **Professional Inspection:** It is recommended to have a qualified technician inspect and service the unit

annually to ensure optimal performance and safety.

8. TROUBLESHOOTING

If you encounter issues with your water heater, refer to the following common problems and solutions:

Problem	Possible Cause	Solution
No hot water / Unit does not ignite	<ul style="list-style-type: none">No gas supplyLow water pressure/flowDead batteriesOverheat protection activated	<ul style="list-style-type: none">Check gas valve and LP tank level.Ensure minimum 2 L/min water flow.Replace batteries.Turn off water, wait 5 minutes, then restart. If persistent, contact service.
Water not hot enough	<ul style="list-style-type: none">Temperature knob set too lowExcessive water flowInadequate gas supply	<ul style="list-style-type: none">Adjust temperature knob higher.Reduce water flow at the faucet.Check gas supply and pressure.
Unit cycles on and off rapidly	<ul style="list-style-type: none">Insufficient water flowFluctuating water pressure	<ul style="list-style-type: none">Ensure consistent water flow above 2 L/min.Check for kinks in water lines or issues with household water pressure.

If the problem persists after attempting these solutions, please contact a qualified service technician.

9. SPECIFICATIONS

Detailed technical specifications for the Rheem Essentials RHE-CHN06P Instant Water Heater:

Brand	Rheem
Model Number	RHE-CHN06P
Capacity	6 Liters per minute (Maximum)
Minimum Water Flow for Operation	2 Liters per minute
Gas Type	LP Gas
Product Dimensions (L x W x H)	33 x 33 x 49 cm
Item Weight	6 kg
Material	Metal
Colour	White
Style	Ultra Slim Fit, compact design

Special Features	Lightweight, Overheat Protection
Batteries Required	Yes (Type not specified, typically D-cell)
Manufacturer	Rheem
GTIN	07502276810985

 **Capacidad máxima**
6 litros por minuto.
2200 m de altura (CDMX) 4L/min

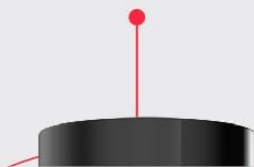

Figure 9.1: Information regarding the maximum capacity of the water heater, stating 6 liters per minute. It also notes that at 2200 meters altitude (like CDMX), the capacity is 4 liters per minute, indicating performance variation with elevation.

10. WARRANTY AND SUPPORT

Your Rheem Essentials RHE-CHN06P Instant Water Heater comes with a warranty. Please refer to the included Warranty Certificate for specific terms, conditions, and duration of coverage.
For technical assistance, service, or warranty claims, please contact Rheem customer support:





- **Rheem Official Website:** www.rheem.com

- **Customer Service:** Refer to your Warranty Certificate or the Rheem website for regional contact information.

When contacting support, please have your model number (RHE-CHN06P) and serial number (found on the product label) readily available.

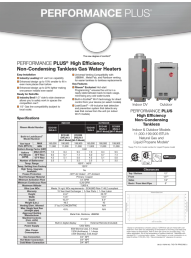
© 2025 Rheem. All rights reserved. Information in this manual is subject to change without notice.

Related Documents - RHE-CHN06P

	<p>Rheem Performance Plus High Efficiency Non-Condensing Tankless Gas Water Heaters</p> <p>Detailed specifications, features, and installation clearances for Rheem Performance Plus High Efficiency Non-Condensing Tankless Gas Water Heaters, including indoor and outdoor models with natural gas and liquid propane options.</p>
	<p>Rheem Condensing Tankless Gas Water Heater Service Manual</p> <p>Comprehensive service manual for Rheem Condensing Tankless Gas Water Heaters, models RTGH-RH11DV and RTGH-RH10DV. Covers specifications, component descriptions, troubleshooting, maintenance, and diagrams.</p>
	<p>Rheem Residential Gas Water Heater Use & Care and Installation Manual</p> <p>Comprehensive guide for Rheem residential gas water heaters (FVIR Certified), covering installation, operation, safety precautions, maintenance, troubleshooting, and replacement parts. Includes instructions for natural and LP gas models.</p>
	<p>Rheem Tankless Water Heater Easy Installation Guide: Tips for Professional Setup</p> <p>Comprehensive installation guide for Rheem tankless water heaters, covering setup, connections, venting, electrical, troubleshooting, and maintenance. Includes step-by-step instructions and important safety information.</p>

