

Indesit I3B L634 X

Indesit I3B L634 X Semi-Integrated Dishwasher User Manual

Model: I3B L634 X

1. SAFETY INFORMATION

Read these safety instructions carefully before using the appliance. Keep them nearby for future reference. This manual provides important information regarding the safe installation, use, and maintenance of your dishwasher.

General Safety

- This appliance can be used by children aged from 8 years and above and persons with reduced physical, sensory or mental capabilities or lack of experience and knowledge if they have been given supervision or instruction concerning use of the appliance in a safe way and understand the hazards involved.
- Children shall not play with the appliance. Cleaning and user maintenance shall not be made by children without supervision.
- The appliance is intended for domestic use only.
- Do not install the appliance outdoors or in damp conditions.
- Ensure the appliance is properly earthed.
- Do not touch the heating element during or immediately after the wash cycle.
- Keep detergents and rinse aid out of reach of children.

Installation Safety

- Installation must be carried out by a qualified technician in accordance with local regulations.
- Ensure the appliance is disconnected from the power supply during installation.
- Do not damage the power cable or water hoses during installation.
- The appliance must be placed on a stable and level floor.

2. PRODUCT OVERVIEW

The Indesit I3B L634 X is a semi-integrated dishwasher designed for efficient dish cleaning. It features an electronic

control panel and a capacity for 14 place settings.

Control Panel

The control panel is located on the top edge of the dishwasher door and includes buttons for power, program selection, delayed start, and indicators for salt and rinse aid levels.



Image: Detailed view of the electronic control panel, showing power button, program selector, delay start, and indicators for salt and rinse aid.



Image: Another detailed view of the electronic control panel, highlighting the Indesit logo and program options.

Interior Components

The dishwasher features adjustable upper and lower baskets for flexible loading, along with a cutlery basket. It can accommodate up to 14 place settings.



Image: The interior of the dishwasher with empty racks, illustrating the layout for loading dishes.



Image: The dishwasher interior with various dishes, glasses, and cutlery loaded, demonstrating its capacity.

3. INSTALLATION INSTRUCTIONS

This Indesit dishwasher is a semi-integrated model, designed to be installed within kitchen cabinetry. Professional installation is recommended to ensure proper functioning and safety.

Placement and Dimensions

The appliance is designed for built-in installation. Ensure the niche dimensions are compatible with the dishwasher's measurements.

- Product Height: 820 mm
- Product Width: 598 mm
- Product Depth: 555 mm
- Minimum Niche Height: 820 mm
- Maximum Niche Height: 900 mm
- Minimum Niche Width: 600 mm
- Maximum Niche Width: 600 mm
- Niche Depth: 560 mm

The dishwasher features adjustable feet, all accessible from the front, to ensure a level installation.



Image: The Indesit dishwasher seamlessly integrated into a modern kitchen setting, with its door closed.



Image: The Indesit dishwasher integrated into kitchen cabinetry, with its door open and racks loaded with dishes.

Electrical Connection

- Nominal Electrical Connection: 1900 W
- Current: 10 A
- Voltage: 220-240 V
- Frequency: 50 Hz
- Power Cord Length: 130 cm
- Plug Type: Schuko
- Ensure the electrical outlet is easily accessible after installation.

Water Connection

- Inlet Hose Length: 155 cm
- Outlet Hose Length: 150 cm
- Maximum Water Inlet Temperature: 60°C
- Connect the inlet hose to a cold water tap.
- Ensure the drain hose is properly connected to a suitable drainage system.

4. OPERATING INSTRUCTIONS

Follow these steps for optimal performance of your Indesit dishwasher.

Initial Setup

1. **Fill Salt Dispenser:** If the salt indicator light is on, fill the salt dispenser with dishwasher salt. This helps soften hard water.
2. **Fill Rinse Aid Dispenser:** If the rinse aid indicator light is on, fill the rinse aid dispenser. Rinse aid improves

drying and prevents streaks.

Loading the Dishwasher

- Scrape off large food particles from dishes before loading.
- Place glasses, cups, and smaller items in the upper basket.
- Place plates, bowls, and larger items in the lower basket.
- Ensure items do not block the spray arms.
- Place cutlery in the cutlery basket with handles down for most items, but knives with handles up for safety.

Adding Detergent

Add the appropriate amount of dishwasher detergent to the dispenser before each wash cycle.

Program Selection and Start

1. **Power On:** Press the power button to turn on the dishwasher.
2. **Select Program:** Use the program selection button to choose the desired wash cycle. Refer to the program table in the full manual for details on each program.
3. **Delay Start (Optional):** If desired, press the delay start button to set a delayed start time (up to 8 hours).
4. **Start Cycle:** Press the start/pause button to begin the wash cycle.

5. MAINTENANCE AND CLEANING

Regular maintenance ensures the longevity and efficiency of your dishwasher.

Cleaning the Filters

The filter system should be checked and cleaned regularly to prevent blockages and ensure optimal washing results.

1. Turn off and unplug the dishwasher.
2. Remove the lower basket.
3. Twist and lift out the filter assembly from the bottom of the wash tub.
4. Separate the coarse filter, fine filter, and microfilter.
5. Rinse all filter components under running water to remove food particles. Use a soft brush if necessary.
6. Reassemble the filters and place them back into the dishwasher, ensuring they are securely locked in place.

Cleaning the Spray Arms

Check the spray arm nozzles for blockages. If necessary, remove the spray arms and clean the holes with a thin object like a toothpick.

Exterior Cleaning

Wipe the exterior surfaces of the dishwasher with a soft, damp cloth. Do not use abrasive cleaners or solvents.

Salt and Rinse Aid Indicators

- The salt indicator light will illuminate when the salt reservoir needs refilling.
- The rinse aid indicator light will illuminate when the rinse aid dispenser needs refilling.

6. TROUBLESHOOTING

Before contacting customer service, refer to this section for solutions to common issues.

Problem	Possible Cause	Solution
Dishwasher does not start	Power cord not plugged in; door not closed properly; program not selected.	Check power connection; ensure door is fully latched; select a wash program.
Dishes are not clean	Incorrect loading; blocked spray arms; insufficient detergent; clogged filters.	Reload dishes correctly; clean spray arm nozzles; add more detergent; clean filters.
Water remains in the tub	Clogged drain hose or filter; drain pump malfunction.	Clean filters and check drain hose for kinks; if problem persists, contact service.
Excessive noise	Dishes rattling; foreign object in pump; improper installation.	Rearrange dishes; check for foreign objects; ensure dishwasher is level.

7. TECHNICAL SPECIFICATIONS

Detailed technical information for the Indesit I3B L634 X Dishwasher.

Model: I3B L634 X

Type: Semi-integrated Dishwasher

Control Type: Electronic

Capacity: 14 Place Settings

Energy Efficiency Class (EU 2017/1369): D

Energy Consumption per 100 cycles (Eco program): 85 kWh

Water Consumption per cycle (Eco program): 9.5 liters

Airborne Acoustical Noise Emissions (EU 2017/1369): 44 dB(A)

Airborne Acoustical Noise Emission Class (EU 2017/1369): B

Program Duration (Eco program): 3:10 hours

Dimensions (H x W x D): 820 mm x 598 mm x 555 mm

Net Weight: 35.5 kg

Gross Weight: 37.5 kg

Electrical Connection: 220-240 V, 50 Hz, 1900 W, 10 A

Material: Stainless Steel (main color Inox)

Adjustable Feet: Yes, all from the front

Maximum Delay Start Time: 8 hours

Salt Indicator: Yes

Rinse Aid Indicator: Yes

8. WARRANTY AND SUPPORT



This product is covered by a manufacturer's warranty. For specific details regarding warranty terms, conditions, and duration, please refer to the warranty card included with your appliance or visit the official Indesit website.

For technical assistance, spare parts, or to report a fault, please contact Indesit customer service. Have your appliance model number (I3B L634 X) and serial number ready when contacting support.

General return policies for products purchased online typically allow returns within 30 days if you change your mind. For defective or damaged products, specific return policies apply. Consult the retailer's return policy for more information.

© 2024 Indesit. All rights reserved.

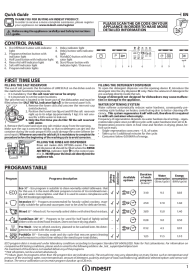
Related Documents - I3B L634 X

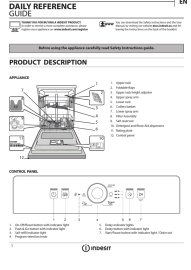
	<p>Indesit Dishwasher Quick Guide: Operation, Programs, and Maintenance</p> <p>Concise guide for Indesit dishwashers, covering control panel functions, program details, loading instructions, cleaning, and troubleshooting. Learn how to use your Indesit dishwasher efficiently.</p>
	<p>Indesit DSIO 3M24 C S Dishwasher Technical Specifications and Energy Label</p> <p>Comprehensive technical specifications, main features, technical features, and energy label details for the Indesit DSIO 3M24 C S built-in dishwasher.</p>
	<p>Indesit Dishwasher Daily Reference Guide</p> <p>User guide for Indesit dishwashers, providing essential information on product description, first-time use, salt, rinse aid, and detergent, program selection, options, rack loading, daily operation, advice, care, maintenance, and troubleshooting.</p>

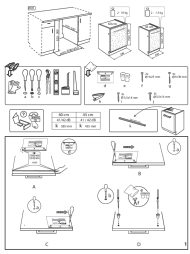

[Integrated Dishwasher Installation Guide](#)

This guide provides instructions for the installation of an integrated dishwasher, covering dimensions, mounting, and connections.

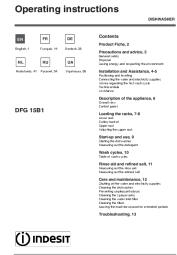

[Indesit DFG 15B1 Dishwasher Operating Instructions](#)

User manual for the Indesit DFG 15B1 dishwasher, covering installation, operation, maintenance, safety precautions, and troubleshooting.

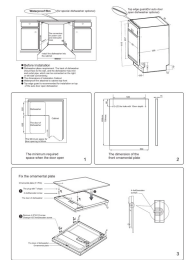

[Indesit Dishwasher Installation Guide: IN2IE13CNO8](#)

Comprehensive installation instructions for the Indesit IN2IE13CNO8 built-in dishwasher. Learn about cabinet requirements, electrical and water connections, level adjustments, and securing the appliance.