

[Manuals.plus](#) /

› [TERGTIRY](#) /

› [TERGTIRY C7735A1000 Discharge Air Temperature Sensor Instruction Manual](#)

TERGTIRY C7735A1000

TERGTIRY C7735A1000 Discharge Air Temperature Sensor Instruction Manual

[Contents](#) [Installation](#) [Operation](#) [Maintenance](#) [Troubleshooting](#) [Specifications](#) [Warranty & Support](#)

[Overview](#) [Compatibility](#) [Package](#)

1. PRODUCT OVERVIEW

The TERGTIRY C7735A1000 Discharge Air Temperature Sensor is designed to monitor the temperature of air discharged from heating and cooling systems. This sensor helps maintain a safe operating environment by preventing potential overheating or equipment damage. It contributes to optimizing energy efficiency in HVAC systems through precise temperature control.

**WORKS WITH THE THM5320R1000 DEVICE INTERFACE MODULE
TO MAINTAIN A SAFE ROOM TEMPERATURE WHEN THE WIRELESS²
THERMOSTAT IS POWERED OFF**



Controls the unit by turning on the blower and sensing room temperature



Controls heating at 62 degrees F and cooling at 82 degrees F



Installs in minutes



Image: The TERGTIRY C7735A1000 Discharge Air Temperature Sensor, showing its compact design and wiring.

Key Features:

- Ensures a safe operating environment by monitoring discharge air temperature.
- Optimizes energy efficiency in HVAC systems through precise temperature control.
- Protects HVAC equipment from freeze-ups and high-limit tripping.
- Compatible with various Honeywell zone systems and thermostats.

Video: An overview of the C7735A1000 Discharge Air Temperature Sensor, highlighting its features and function.

2. COMPATIBILITY

The C7735A1000 Discharge Air Temperature Sensor is compatible with a range of Honeywell zone systems and thermostats. This includes:

- **Honeywell Zone Systems:** HZ221, HZ311, HZ322, HZ432
- **Honeywell Thermostats:** TH5320U, TH5320R1002, TH6320R1004, THM5320R1000

COMPATIBLE PANEL

HZ221 HZ311 HZ322 HZ432

COMPATIBLE DAMPERS

CPRD10

UNIVERSAL MOUNT TRANSFORMER

AT140A1042



Compatible Thermostats



TH5320U



TH5320R1002



TH6320R1004



THM5320R1000

Image: Visual representation of compatible Honeywell thermostats (TH5320U, TH5320R1002, TH6320R1004, THM5320R1000) and zone panels (HZ221, HZ311, HZ322, HZ432).

3. PACKAGE CONTENTS

Please verify that all items are present in your package:

- C7735A1000 Discharge Air Temperature Sensor
- Mounting hardware (screws, clips)

Video: An unboxing and display of components for a similar temperature sensor, providing an idea of typical package contents.

4. INSTALLATION

The C7735A1000 sensor is designed for quick and simple mounting in the air ducts of HVAC systems. Professional installation is recommended for optimal performance and safety.

Installation Steps:

1. **Safety First:** Ensure the power to the HVAC system is turned off at the circuit breaker before beginning installation.
2. **Select Location:** Choose an appropriate location within the supply air duct where the sensor can accurately measure discharge air temperature. Avoid areas with direct airflow from coils or fans that might provide inaccurate readings.
3. **Mount the Sensor:** Use the provided mounting hardware to secure the sensor to the ductwork. The compact design allows for flexible placement.
4. **Wire the Sensor:** Connect the sensor wires to the appropriate terminals on your Honeywell zone panel or thermostat, following the wiring diagram provided with your HVAC system or zone panel.
5. **Secure Connections:** Ensure all wiring connections are secure and properly insulated.
6. **Restore Power:** Once installation is complete and verified, restore power to the HVAC system.



Avoids freezing and tripping of the upper limit by detecting the supply air pipe duct temperature. When the DATS limit is exceeded, the zone panel shuts off the unit. The unit automatically turns back on.

Image: The C7735A1000 sensor being installed into an air duct, demonstrating the physical placement.

Video: A demonstration of the temperature sensor, including its components and basic assembly, which can aid in understanding the installation process.

Video: Another visual guide showing the temperature sensor and its features, useful for understanding its physical characteristics during installation.

5. OPERATION

The C7735A1000 sensor operates by continuously monitoring the temperature of the air discharged from your HVAC system. It provides accurate, real-time temperature readings to the connected Honeywell zone panel or thermostat.

Functional Aspects:

- **Temperature Monitoring:** The sensor constantly measures the air temperature within the supply duct.
- **System Control:** Based on the temperature data, the connected zone panel or thermostat can adjust the system's operation to maintain desired heating or cooling setpoints.
- **Safety Mechanism:** The sensor plays a critical role in preventing damage to HVAC equipment by detecting extreme temperatures (e.g., potential freeze-ups or excessively high temperatures).



Image: The sensor's role in controlling the HVAC unit by turning on the blower and sensing room temperature, and controlling heating/cooling setpoints.

6. MAINTENANCE

The C7735A1000 Discharge Air Temperature Sensor is designed for reliable, long-term operation with minimal maintenance. However, periodic checks can help ensure continued accuracy and performance.

Recommended Maintenance:

- **Visual Inspection:** Annually inspect the sensor and its wiring for any signs of physical damage, corrosion, or loose connections.
- **Cleanliness:** Ensure the sensor probe is free from dust, debris, or obstructions that could affect temperature readings. Gently wipe with a soft, dry cloth if necessary.
- **Professional Check:** During routine HVAC system maintenance, have a qualified technician verify the sensor's readings and overall functionality.

7. TROUBLESHOOTING

If you experience issues with your HVAC system that you suspect are related to the temperature sensor, consider the following:

Common Issues and Solutions:

- **Inaccurate Temperature Readings:**
 - Check for obstructions or debris on the sensor probe.
 - Verify the sensor is correctly positioned in the air duct.
 - Ensure wiring connections are secure and free from corrosion.
- **HVAC System Cycling Off Unexpectedly:**
 - The sensor is designed to protect equipment. If supply duct temperature limits are exceeded (e.g., due to a freeze-up or overheating), the zone panel will automatically cycle off the equipment. This is a safety feature.
 - Investigate the root cause of the extreme temperature (e.g., clogged filter, refrigerant issues, fan malfunction).
- **No Response from Sensor:**
 - Check all wiring connections for continuity and proper attachment.
 - Ensure the sensor is compatible with your specific zone panel/thermostat model.

For complex issues or if troubleshooting steps do not resolve the problem, it is recommended to contact a qualified HVAC technician.



Avoids freezing and tripping of the upper limit by detecting the supply air pipe temperature. duct temperature. When the DATS limit is exceeded, the zone panel shuts off the unit. The unit automatically turns back on.

Image: The sensor's function in detecting supply air pipe temperature to avoid freezing and tripping of the upper limit, leading to automatic equipment shutdown by the zone panel.

8. SPECIFICATIONS

Feature	Detail
Model Number	C7735A1000
Brand	TERGTIRY
Manufacturer	TERGTIRY
Product Dimensions	4.7 x 3.3 x 1.6 inches
Item Weight	1.76 ounces (0.05 Kilograms)
Material	Plastic
Color	Black

Batteries Required	No
Included Components	C7735A1000

PRODUCT SIZE

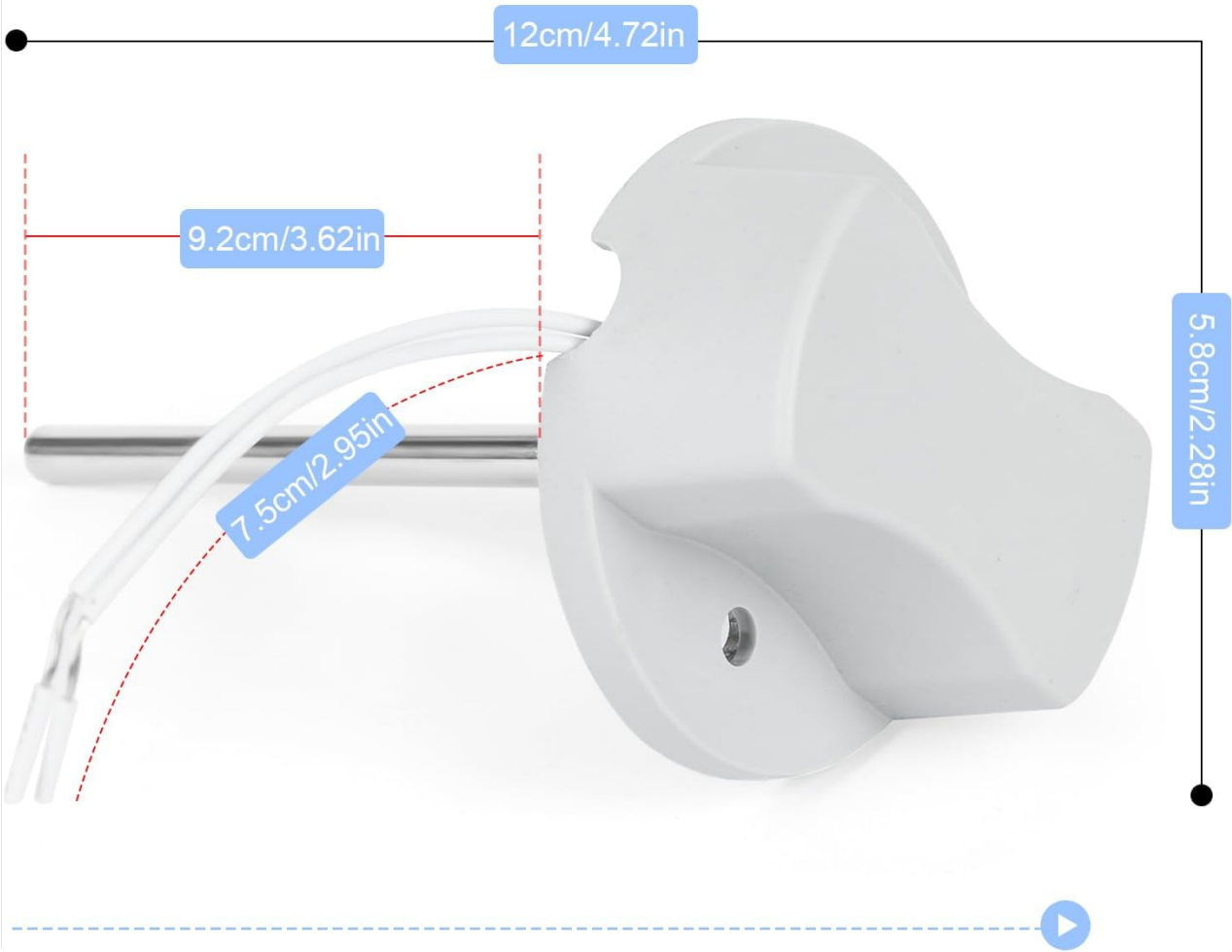

Image: Detailed product dimensions of the C7735A1000 sensor.

PRODUCT DETAILS



Image: Close-up view of the C7735A1000 sensor's components, including the probe and wiring.

9. WARRANTY AND SUPPORT

Each TERGTIRY C7735A1000 sensor undergoes stringent quality inspections to ensure reliability. We are committed to providing reliable customer service and guarantee the quality of our products.

Customer Service:

If you encounter any issues during your purchase or installation, please contact our dedicated customer service team. We are ready to provide prompt and sincere support to ensure a worry-free experience.

For further assistance, please refer to the contact information provided with your product packaging or visit the official TERGTIRY website.

