

[Manuals.plus](#) /

> [CHWARES](#) /

> CHWARES 5Kg/11lb Digital Kitchen Food Scale User Manual (Model ek3331)

CHWARES ek3331

CHWARES 5Kg/11lb Digital Kitchen Food Scale User Manual

Model: ek3331

1. INTRODUCTION

Thank you for choosing the CHWARES Digital Kitchen Food Scale. This scale is designed for precise measurements in various kitchen applications, including cooking, baking, meal preparation, and portion control. It offers a maximum capacity of 5 kg (11 lb) with an accuracy of 1 g (0.1 oz) and features multiple unit options for versatility.

2. IMPORTANT SAFETY INFORMATION

- Do not immerse the scale in water or any other liquid.
- Clean the scale with a damp cloth; avoid abrasive cleaners.
- Do not overload the scale beyond its maximum capacity of 5 kg (11 lb).
- Place the scale on a hard, flat, and stable surface for accurate readings.
- Keep the scale away from extreme temperatures and direct sunlight.
- This device is for household use only.

3. PACKAGE CONTENTS

Please check the package for the following items:

- CHWARES Digital Kitchen Food Scale (Model ek3331)
- 3 x AAA Batteries
- User Manual

4. PRODUCT OVERVIEW

The CHWARES Digital Kitchen Food Scale features a sleek design with a stainless steel weighing platform and an easy-to-read LED display. It includes intuitive buttons for unit conversion and tare functionality.



Image: The CHWARES Digital Kitchen Food Scale, showing its stainless steel platform, digital display, 'UNIT' and 'TARE' buttons, and three AAA batteries.



Image: A visual representation of the scale's dimensions, indicating a length of 6.69 inches (17 cm) and a width of 5.12 inches (13 cm), with two plates of berries and cherries on top.

5. SETUP

1. **Unpack:** Carefully remove the scale and all components from the packaging.
2. **Install Batteries:** Open the battery compartment on the underside of the scale. Insert the 3 AAA batteries, ensuring correct polarity (+/-). Close the battery compartment securely.
3. **Placement:** Place the scale on a firm, flat, and level surface to ensure accurate measurements. Avoid placing it on soft or uneven surfaces.

6. OPERATING INSTRUCTIONS

6.1. Power On/Off

- **Power On:** Press the **TARE** button (often doubles as power) or simply place an item on the scale. The display will

illuminate.

- **Power Off:** The scale features an automatic shut-off function to conserve battery power. It will turn off after a period of inactivity. To manually turn off, press and hold the **TARE** button for a few seconds.

6.2. Unit Conversion

The scale supports 6 different units of measurement. To switch between units:

1. Ensure the scale is powered on.
2. Press the **UNIT** button repeatedly to cycle through the available units: g (grams), water ml (milliliters for water), milk ml (milliliters for milk), lb:oz (pounds and ounces), water fl'oz (fluid ounces for water), milk fl'oz (fluid ounces for milk).
3. The selected unit will be displayed on the screen.



Image: The scale displaying various units of measurement (g, water ml, milk ml, lb:oz, water fl'oz, milk fl'oz) and indicating a maximum capacity of 5kg/11lb with 1g/0.1oz division.

6.3. Tare Function

The Tare function allows you to subtract the weight of a container, so you can measure only the net weight of your ingredients.

1. Place an empty container on the weighing platform. The display will show the container's weight.
2. Press the **TARE** button. The display will reset to zero (0).
3. Add your ingredients to the container. The display will now show only the weight of the ingredients.
4. To clear the tare and return to normal weighing, remove all items from the scale and press the **TARE** button again if the display does not automatically reset to zero.

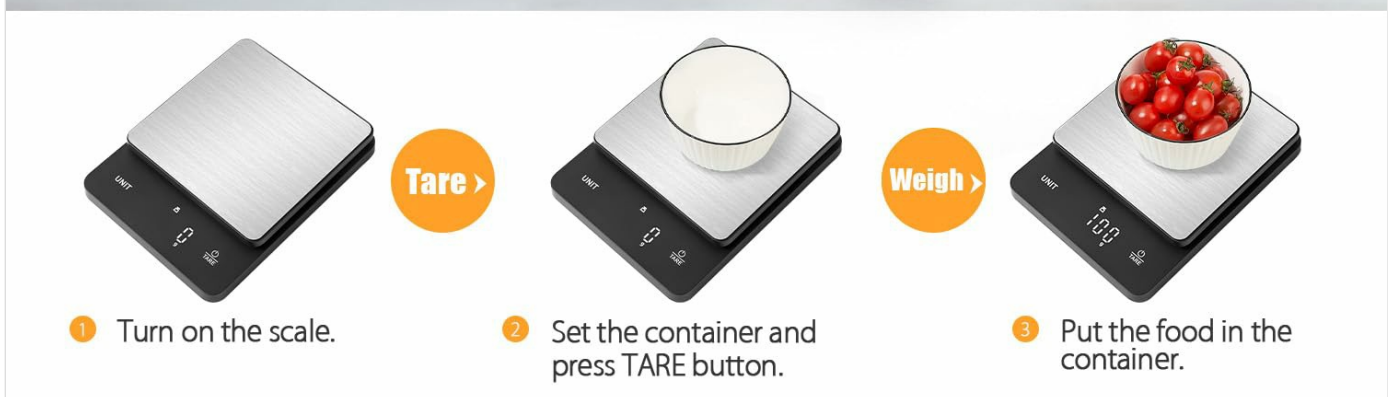

Image: A three-step visual guide demonstrating the Tare function: 1) Turn on the scale, 2) Place an empty container and press TARE, 3) Add food to the container to weigh only the contents.

6.4. Weighing Items

1. Ensure the scale is on a flat surface and powered on.
2. If using a container, perform the Tare function as described above.
3. Gently place the item(s) to be weighed onto the center of the weighing platform.

4. Read the weight displayed on the LED screen.

6.5. Auto Shut-off

To conserve battery life, the scale will automatically turn off after a period of inactivity. This feature helps extend the lifespan of the batteries.

7. MAINTENANCE AND CARE

- **Cleaning:** The stainless-steel platform is easy to clean. Wipe the scale with a slightly damp cloth or tissue. Do not use harsh chemicals or abrasive cleaning agents.
- **Avoid Water Immersion:** Never submerge the scale in water or place it under running water, as this can damage the internal electronic components.
- **Storage:** Store the scale in a cool, dry place when not in use.
- **Battery Replacement:** If the display indicates low battery or the scale becomes unresponsive, replace all 3 AAA batteries with new ones.

LARGE PLATFORM AND EASY TO USE



Image: A hand wiping the stainless steel surface of the CHWARES Digital Kitchen Food Scale with a white cloth, demonstrating easy cleaning.

8. TROUBLESHOOTING

Problem	Possible Cause	Solution
Scale does not turn on	Low or dead batteries; Incorrect battery installation	Replace batteries; Ensure batteries are inserted with correct polarity.
Inaccurate readings	Uneven surface; Overload; External interference	Place on a flat, stable surface; Do not exceed 5kg/11lb; Avoid strong electromagnetic fields.
Display shows "Lo"	Low battery power	Replace batteries.
Display shows "O-Ld"	Overload	Remove item immediately to prevent damage. Do not exceed maximum capacity.

9. SPECIFICATIONS

Feature	Detail
Model Number	ek3331
Capacity	5 kg / 11 lb
Accuracy	1 g / 0.1 oz
Units	g, water ml, milk ml, lb:oz, water fl'oz, milk fl'oz
Display Type	LED with Backlit Display
Power Source	3 x AAA Batteries (Included)
Product Dimensions	6.69 x 5.12 x 1.1 inches (17 x 13 x 2.8 cm)
Special Features	Auto Shut Off, Tare Function, Precision Balanced
Material	Food-grade Stainless Steel Platform

10. WARRANTY AND SUPPORT

For warranty information or technical support, please refer to the documentation included with your purchase or contact the retailer where the product was acquired. You may also visit the official CHWARES store for additional resources and contact options: [CHWARES Store](#).

