

Manuals+

[Q & A](#) | [Deep Search](#) | [Upload](#)

[manuals.plus](#) /

- › [Carrera](#) /
- › [Carrera 370200010 2.4GHz RC Construction Racer Instruction Manual](#)

Carrera 370200010

Carrera 370200010 2.4GHz RC Construction Racer Instruction Manual

Model: **370200010**

Brand: **Carrera**

1. INTRODUCTION AND OVERVIEW

The Carrera 370200010 2.4GHz RC Construction Racer is an all-wheel-drive remote-controlled vehicle designed for various terrains. This model can achieve speeds of up to 12 km/h and features large tires to navigate obstacles effectively. The vehicle measures approximately 22 cm in length. This manual provides essential information for setting up, operating, and maintaining your RC Construction Racer.



Image 1.1: Front-side view of the Carrera 370200010 RC Construction Racer. This image displays the vehicle's red body, black wheels, and "35" racing decals.

2. SAFETY INFORMATION

- **Age Recommendation:** This product is suitable for users aged 8 years and older. Adult supervision is recommended for younger users.
- **Battery Safety:**
 - Use only the specified battery type (AA/LR06).
 - Do not mix old and new batteries, or different types of batteries.
 - Ensure batteries are inserted with correct polarity (+/-).
 - Remove exhausted batteries promptly.
 - Do not attempt to recharge non-rechargeable batteries.
 - Keep batteries away from children and pets.
- **Operating Environment:**
 - Operate the vehicle in open areas, away from people, pets, and obstacles.
 - Avoid operating near water, sand, or excessive dirt to prevent damage to electronic components.
 - Do not operate in public streets or near moving traffic.
- **General Precautions:**
 - Do not touch moving parts while the vehicle is in operation.
 - Avoid dropping or subjecting the vehicle to strong impacts.
 - Store the vehicle and remote control in a cool, dry place when not in use.

3. PACKAGE CONTENTS

Please check the package to ensure all items are present:

- Carrera 370200010 2.4GHz RC Construction Racer Vehicle
- 2.4GHz Remote Control
- 6 x AA (LR06) Batteries (for vehicle and remote control)
- Instruction Manual (this document)



PRELIMINARY

Image 3.1: Top-side view of the RC Construction Racer, showing the overall design and transparent cockpit.

4. SETUP

4.1. Vehicle Battery Installation

1. Locate the battery compartment on the underside of the RC Construction Racer.
2. Using a small screwdriver (not included), carefully open the battery compartment cover.
3. Insert the required AA (LR06) batteries, ensuring correct polarity as indicated inside the compartment.
4. Replace the battery compartment cover and secure it with the screw.



Image 4.1: Exploded view of the RC Construction Racer, illustrating its modular design which may indicate battery access points.

4.2. Remote Control Battery Installation

1. Locate the battery compartment on the back of the remote control.
2. Open the battery compartment cover.
3. Insert the required AA (LR06) batteries, observing the correct polarity.
4. Close the battery compartment cover securely.



Image 4.2: The 2.4GHz remote control for the Carrera RC Construction Racer, showing its dual joysticks and power switch.

4.3. Pairing the Vehicle and Remote Control

The 2.4GHz technology typically allows for automatic pairing. Follow these steps:

1. Ensure both the vehicle and the remote control have fresh batteries installed.
2. Turn on the vehicle using its power switch.
3. Turn on the remote control using its power switch.
4. The remote control and vehicle should automatically connect. An indicator light on the remote control may change from flashing to solid once connected.
5. If pairing fails, turn both devices off, wait a few seconds, and repeat the process.

5. OPERATING INSTRUCTIONS

Once paired, you can begin operating your RC Construction Racer.

- **Forward/Backward:** Use the left joystick (or corresponding control) to move the vehicle forward or backward.
- **Steering (Left/Right):** Use the right joystick (or corresponding control) to steer the vehicle left or right.
- **Speed Control:** The vehicle's speed is proportional to how far you push the joystick.

Driving Tips:

- Start in an open area to get accustomed to the controls.
- Practice smooth turns and acceleration.
- The all-wheel drive system provides good traction on various surfaces, but avoid extremely rough terrain or steep inclines that could damage the vehicle.

- When the vehicle's performance decreases, it's an indication that the batteries are running low and need replacement.



Image 5.1: Rear-side view of the RC Construction Racer, highlighting the large tires and rear design.

6. MAINTENANCE

- **Cleaning:**
 - After each use, especially outdoors, gently wipe the vehicle with a soft, dry cloth to remove dust and dirt.
 - Do not use water or chemical cleaners, as these can damage electronic components.
 - Remove any debris that may have accumulated around the wheels or axles.
- **Battery Care:**
 - Always remove batteries from both the vehicle and the remote control when not in use for extended periods.
 - Dispose of used batteries responsibly according to local regulations.
- **Storage:** Store the RC Construction Racer and its remote control in a cool, dry place, away from direct sunlight and extreme temperatures.

7. TROUBLESHOOTING

Problem	Possible Cause	Solution
Vehicle does not respond to remote control.	Batteries are low or incorrectly installed.	Replace batteries in both vehicle and remote, ensuring correct polarity.
	Vehicle and remote are not paired.	Turn both devices off and on again to re-establish pairing.
	Vehicle or remote is switched off.	Ensure both power switches are in the "ON" position.
Vehicle moves slowly or erratically.	Low batteries in vehicle or remote.	Replace batteries.
	Interference from other 2.4GHz devices.	Move to an area with less electronic interference.

Problem	Possible Cause	Solution
Short operating range.	Low batteries in remote control. Obstacles between remote and vehicle.	Replace remote control batteries. Operate in an open area with a clear line of sight.

8. SPECIFICATIONS

- **Model Number:** 370200010
- **Brand:** Carrera
- **Control Frequency:** 2.4 GHz
- **Drive Type:** All-Wheel Drive (4WD)
- **Maximum Speed:** Up to 12 km/h
- **Vehicle Dimensions (L x W x H):** Approximately 36 x 8 x 26 cm
- **Vehicle Weight:** Approximately 200 grams
- **Recommended Age:** 8 years and up
- **Main Material:** Plastic
- **Color:** Multicolored (predominantly red)
- **Batteries Required:** Yes (6 x AA/LR06 included)
- **Assembly Required:** No
- **Educational Value:** Promotes creativity, technical skills, and understanding of remote control technology.

9. WARRANTY AND SUPPORT

Warranty information for your Carrera 370200010 2.4GHz RC Construction Racer is typically provided at the point of purchase or included with the product packaging. Please refer to those documents for specific warranty terms and conditions.

For technical support, spare parts, or further assistance, please visit the official Carrera website or contact their customer service department. Contact details can usually be found on the product packaging or the manufacturer's website.

10. VIDEO RESOURCES

No official product videos from the seller are available for embedding at this time.

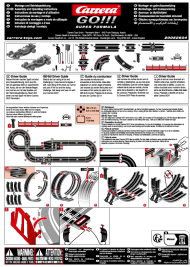

[Carrera GO!!! SUPER FORMULA Slot Car Racing Set Assembly and Operating Instructions](#)

Official assembly and operating instructions for the Carrera GO!!! SUPER FORMULA slot car racing set (Model 20062604). Learn how to set up your track, operate the cars, and enjoy the racing experience.

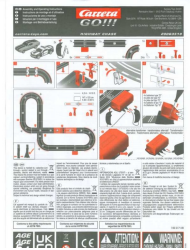

[Carrera GO!!! Highway Chase Slot Car Racing Set: Assembly & Operating Instructions \(Model 20063519\)](#)

Assembly and operating instructions for the Carrera GO!!! Highway Chase slot car racing set (model 20063519). Provides detailed guidance on setup, safe operation, and technical specifications for this toy racing track.

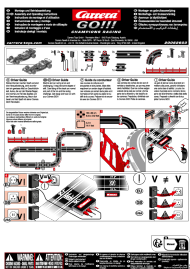

[Carrera GO!!! Champions Racing Slot Car Set - Assembly and Operating Instructions](#)

Comprehensive assembly and operating instructions for the Carrera GO!!! Champions Racing slot car set (Model 20062603). Includes track layout guide, car setup, power connection details, and safety warnings.

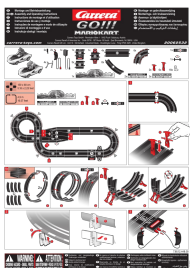

[Carrera GO!!! MARIOKART Slot Car Track Set Assembly Instructions](#)

Comprehensive assembly and operating instructions for the Carrera GO!!! MARIOKART slot car track set, including parts list, layout guide, and safety warnings. The document is presented in English, with notes on other languages present.



[Carrera GO!!! 370410529 User Manual - Slot Car Racing Set Guide](#)

Official user manual for the Carrera GO!!! 370410529 slot car racing set. Learn how to set up, operate, maintain, and troubleshoot your racing experience.

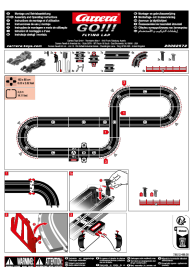

[Carrera GO!!! Flying Lap Slot Car Racing Set Assembly and Operating Instructions](#)

Comprehensive guide to assembling and operating the Carrera GO!!! Flying Lap slot car racing set (Model 20062572), including track layout, parts, assembly steps, and safety information.