

RunCam RUNCAM6

RunCam 6 4K FPV Action Camera User Manual

Model: RUNCAM6

1. INTRODUCTION

The RunCam 6 is a compact and powerful 4K FPV action camera designed for capturing high-quality video in various dynamic environments. It features 4K video recording at 30 frames per second, Electronic Image Stabilization (EIS), GyroFlow stabilization support, and Wi-Fi connectivity for easy control and sharing. This manual provides essential information for setting up, operating, and maintaining your RunCam 6 camera.



Figure 1: RunCam 6 4K FPV Action Camera overview.

2. PACKAGE CONTENTS

Verify that all items are present in your package:

- RunCam 6 Camera
- Battery (1x)
- USB Cable
- 1/4 Tripod Adapter
- Mount
- Type-C Control Cable (Note: Type-C control cable is not supported for the time being as per manufacturer information.)
- User Manual

Depending on the purchased option, additional accessories such as an ND Filter Set or a 128GB Micro SD Card may be included.

Package



1 x Camera

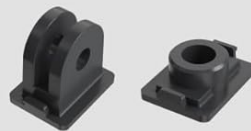

1 x 1/4 Tripod adapter



1 x Battery



1x USB cable



1x Type-C Control cable



1 x Mount

+ND Filter Set



+ND Filter Set & 128g SAMSUNG Micro SD CARD



Figure 2: Standard package contents for the RunCam 6 camera.

3. SETUP

3.1 Battery Installation and Charging

1. Locate the battery compartment on the camera.
2. Insert the provided 850mAh Lithium Ion battery, ensuring correct polarity.
3. Close the battery compartment securely.
4. Connect the camera to a USB power source using the supplied USB cable for charging. The camera accepts DC 5-20V input.

3.2 Micro SD Card Installation

A Micro SD card (up to 512GB, U3 or above recommended for 2.7K60/2.7K50/1080P120) is required for recording. Ensure the card is formatted to exFAT to prevent errors.

1. Locate the Micro SD card slot on the camera.
2. Insert the Micro SD card gently until it clicks into place.
3. To remove, press the card inward until it springs out.

3.3 Mounting the Camera

Use the included mount and 1/4 tripod adapter to secure the camera to your desired platform (e.g., RC plane, drone, helmet). Ensure the camera is firmly attached before use.

Comprehensive Upgrade

- 12MP 1/2.3 inch Sensor
- EIS & GyroFlow Supported
- HDMI
- Detachable Lens Protective Cover
- Replaceable ND Filter
- 128 x 64 OLED Screen Display
- Replaceable Battery
- Type C Port (5-20V Input)
- CVBS Real-time Output
- Support Serial PWM Control



Dimensions



67mm

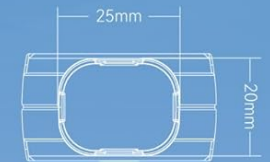

25mm

20mm

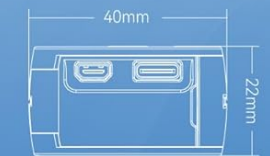

40mm

22mm

Figure 3: Overview of RunCam 6 features and dimensions, including mounting points.

4. OPERATING INSTRUCTIONS

4.1 Power On/Off

- **Power On:** Press and hold the Power button until the screen display illuminates.
- **Power Off:** Press and hold the Power button until the screen display turns off.



Figure 4: The OLED screen display showing camera status and settings.

4.2 Video Recording

The RunCam 6 supports various resolutions, including 4K@30fps, 2.7K@60fps, 1080P@120fps, and more. The camera automatically saves video files if power is suddenly lost during recording.

- **Start Recording:** Press the Record button once. The indicator light will change to show recording is active.
- **Stop Recording:** Press the Record button again.

4K Recording

Camera supports high-definition resolution and high frame rate recording up to 4K@30fps, which not only can meet the needs of delicate and clear pictures, but also shoot fast-moving targets, allowing you to review and share the best moments.

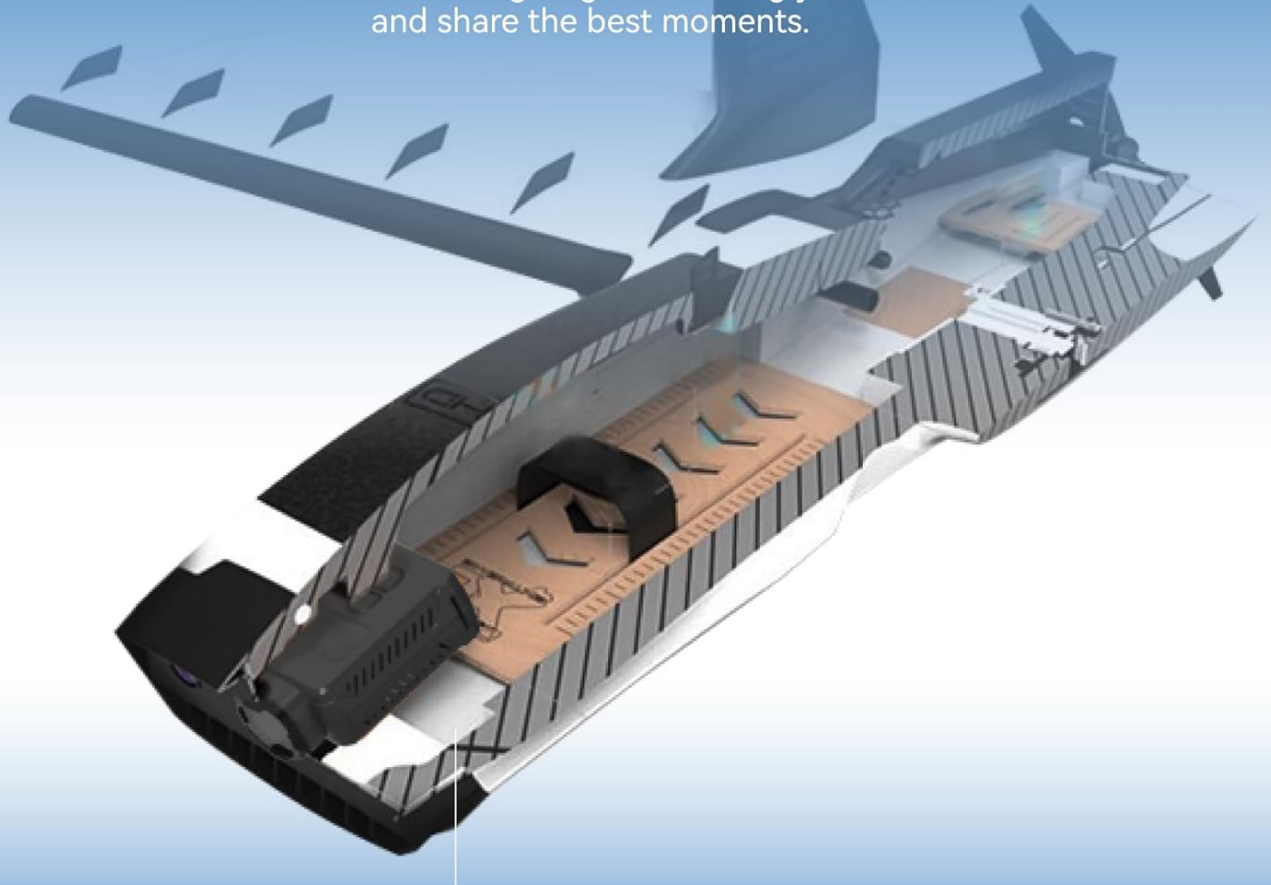

ZOH D Dart XL Extreme (Not included in sale)

Figure 5: Illustration of 4K recording capability, capturing high-definition footage.

4.3 Stabilization (EIS & GyroFlow)

The camera features built-in Electronic Image Stabilization (EIS) and supports GyroFlow for post-stabilization, ensuring smooth video footage even in challenging conditions.

- **EIS:** Enabled by default for in-camera stabilization.
- **GyroFlow:** Gyro data is recorded for advanced post-production stabilization using GyroFlow software.

Support EIS and GyroFlow Stabilization

Built-in gyroscope supports EIS and GyroFlow, outputting smooth and stable videos.



Figure 6: Comparison of unstabilized versus stabilized video footage using EIS and GyroFlow.

4.4 Wi-Fi Connectivity and App

Connect your RunCam 6 to the dedicated iOS or Android app via Wi-Fi for live preview, settings adjustment, and file management.

- **Enable Wi-Fi:** Refer to the camera's on-screen menu or specific button combination to activate Wi-Fi.
- **Connect to App:** Search for the camera's Wi-Fi network on your smartphone and connect. Open the RunCam app to control the camera.

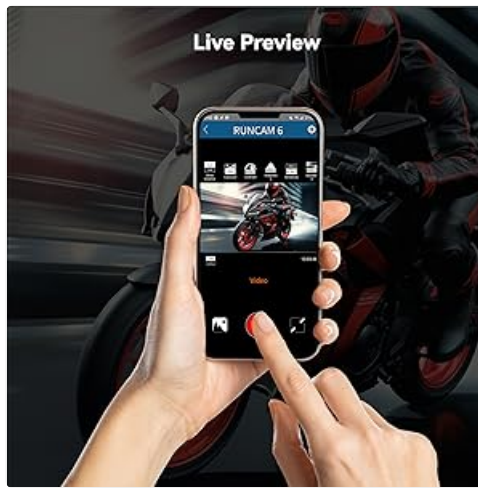

Figure 7: Live preview of camera feed on a smartphone via the RunCam app.

4.5 HDMI and CVBS Output

The camera provides HDMI output for connecting to a television or monitor, and CVBS real-time output for FPV systems.

- **HDMI:** Connect an HDMI cable from the camera to an HDMI-enabled display.
- **CVBS:** Use the appropriate cable to connect the CVBS output to your FPV goggles or monitor.



Figure 8: RunCam 6 connected to FPV goggles and an external monitor via CVBS/HDMI.

4.6 PWM Control

The RunCam 6 supports Serial PWM control, allowing integration with RC systems for remote operation.

- Connect the Type-C control cable (if supported by your setup) to your flight controller or RC receiver for remote control functions.



Figure 9: RunCam 6 connected for Serial and PWM control with a flight controller.

4.7 Advanced Features

- **Adjustable FOV:** The camera offers Large (155°), Middle (142°), and Small (130°) fields of view. Adjust this setting via the camera menu or app.
- **Pre-Record:** Capture footage before you press the record button. Consult the camera settings for activation.
- **Time-Lapse:** Create time-lapse videos. Settings for interval and duration can be configured in the camera menu or app.



Figure 10: Pre-Record feature in action.

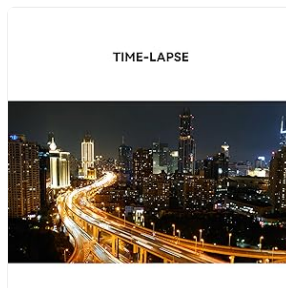

Figure 11: Time-Lapse feature capturing a city skyline.

5. MAINTENANCE

5.1 Lens Care

Keep the camera lens clean for optimal image quality. Use a soft, lint-free cloth specifically designed for optical lenses. Avoid abrasive materials or harsh chemicals.

- The camera includes a detachable lens protective cover. Ensure it is in place when not recording to prevent scratches.
- Replaceable ND filters can be used to achieve better recording effects under different outdoor lighting conditions.

Lens Protection + Replaceable ND Filter

Strengthen lens protection and use ND filters to achieve better recording effects under different outdoor lighting conditions.



Figure 12: Detachable lens protective cover and replaceable ND filter.

5.2 Battery Care

- Store batteries in a cool, dry place.
- Avoid fully discharging the battery frequently.
- If storing for extended periods, charge the battery to approximately 50-60%.

5.3 Micro SD Card Formatting

Regularly format your Micro SD card using the camera's menu option to maintain optimal performance and prevent data corruption. Ensure all important files are backed up before formatting.

6. TROUBLESHOOTING

- **Camera not turning on:** Ensure the battery is charged and correctly inserted. Try charging the camera for at least 30 minutes.

- **Recording issues (e.g., freezing, corrupted files):**

- Ensure the Micro SD card is a high-speed card (U3 or above for higher resolutions).
- Format the Micro SD card in the camera.
- Try a different Micro SD card.

- **Wi-Fi connection problems:**

- Ensure Wi-Fi is enabled on the camera.
- Restart both the camera and your smartphone.
- Ensure you are within close proximity to the camera.

- **Poor image quality:**

- Clean the camera lens.
- Check lighting conditions and consider using an ND filter if too bright.
- Ensure the correct resolution and frame rate settings are selected.

7. SPECIFICATIONS

Feature	Detail
Brand	RunCam
Model	RUNCAM6
Video Resolution	4K@30fps, 2.7K@60fps, 2.7K@30fps, 1080P@120fps, 1440P@60fps, 1080P@60fps
Video File Format	MP4
Image Sensor	SONY IMX377 (12MP)
Stabilization	EIS and GyroFlow Supported
FOV (Adjustable)	Large: 155°, Middle: 142°, Small: 130°
Max Micro SD Card	Max. 512GB (exFAT format, U3 or above for high resolutions)
Battery Capacity	850mAh 4.35V (replaceable)
Run Time	60 Mins/4K30fps, 110 Mins/1080p60fps, 135 Mins/1080p30fps
Micro-USB Power Input	DC 5~20V
Connectivity	Wi-Fi, HDMI, USB
Output	HDMI, CVBS Real-time Output
Control	Serial PWM Supported
Dimensions	66.5 x 40 x 20 mm (approx. 2.6" x 1.5" x 0.8")
Weight	49g (with battery)

Feature	Detail
Special Features	Detachable Lens Protective Cover, Replaceable ND Filter, 128x64 OLED Screen Display, Pre-Record, Time-Lapse



<div> <div>NEW PRODUCT ARRIVAL</div> <div>   </div> </div>		
Camera	RunCam6	RunCam2 4K
Image Sensor	SONY IMX377 (12MP)	SONY(8MP)
Stabilization	EIS and GyroFlow	×
Replaceable ND filter	✓	×
HDMI&CVBS output	✓	×
Screen Display	✓	×
Pre-Record	✓	×
Time-Lapse	✓	×
Run Time	110Mins/1080p60fps	90Mins/1080p60fps
Dimensions	66.5*40*20mm	66*38* 21mm
Weight	49g(with battery)	49g(with battery)
WIFI&APP Preview	✓	✓

Figure 13: Detailed specifications of the RunCam 6, including comparison with previous models.

8. WARRANTY AND SUPPORT

For warranty information, please refer to the official RunCam website or contact your retailer. Keep your proof of purchase for warranty claims.

For technical support, product inquiries, or to explore additional accessories, please visit the official RunCam store or contact their customer service:

- **RunCam Official Store:** [Visit RunCam Store on Amazon](#)
- **Manufacturer Website:** Refer to the product packaging or official documentation for the most current website address.



Related Documents

<div><p>User Manual Runcam6</p><div></div></div>	<p>Runcam 6 User Manual: Features, Operations, and Specifications</p> <p>Comprehensive user manual for the Runcam 6 action camera, covering basic operations, OLED display, component handling, firmware updates, remote control, app connection, and technical specifications.</p>
	<p>RunCam Thumb Pro 4K Action Camera Manual & Setup Guide</p> <p>Comprehensive user manual for the RunCam Thumb Pro 4K FPV action camera. Learn about setup, basic operations, flight controller integration, firmware updates, and specifications.</p>

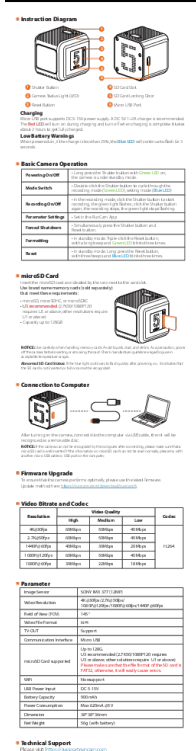

Comprehensive user manual for the RunCam 5 action camera. Covers setup, basic operation, microSD card usage, computer connection, firmware upgrades, video settings, technical specifications, and support resources.



[RunCam 6 User Manual](#)

This user manual provides comprehensive instructions for operating the RunCam 6 camera, including setup, basic operations, features, and specifications.
lang:en score:53 filesize: 612.75 K page_count: 8 document date: 2024-03-05



[\[pdf\] User Manual Diagram](#)

RunCam 6 EN 20240305 6 Action Camera 4K 30FPS Edition Instruction ManualRunCam with SD Card
RC RUNCAM6 128G Motion RCRUNCam manual encdn shopify s files 1 1052 4162 en |||
User Manual **Runcam6** 1 Diagram 4 5 3 6 2 7 8 9 1 10 1 Lens protection hood 3 Wi-Fi/Menu button 5 Power light indicator 2 OLED Display 7 Type-C port 4 Power/Shutter button 6 Wi-Fi/Menu light indicator 9 MicroSD card holder 8 HDMI port 10 Battery holder Power indicator light Red: recor...
lang:en score:52 filesize: 612.75 K page_count: 8 document date: 2024-03-05



[\[pdf\] User Manual Diagram](#)

RunCam 6 EN 20240417 hereRunCam 6 w 128gb MicroSD Additive AerospaceRunCam manual encdn
shopify s files 1 0797 9921 en v 1713665260 Great HobbieshereUser Manual Runcam6 Page 2 Diagram
3 4 Type C Control cable instruction Power wire It Radiomaster TX12 as an example assigning
the RunCam AerospaceRuncam6 manualRunCam engreathobbies manuals r run runcam6 srsItid
AfmBOouWzAATuzYuUB6NZNpoiPR4c smFVOlsgSN 5WoBmaxJfejCZNcdn ||| ||| User Manual
Runcam6 1 Diagram 4 5 3 6 2 7 8 9 1 10 1 Lens protection hood 3 Wi-Fi/Menu button 5 Power light
indicator 2 OLED Display 7 Type-C port 4 Power/Shutter button 6 Wi-Fi/Menu light indicator 9 MicroSD
card holder 8 HDMI port 10 Batt
User Manual **Runcam6** 1 Diagram 4 5 3 6 2 7 8 9 1 10 1 Lens protection hood 3 Wi-Fi/Menu button 5 Power light indicator 2 OLED Display 7 Type-C port 4 Power/Shutter button 6 Wi-Fi/Menu light indicator 9 MicroSD card holder 8 HDMI port 10 Battery holder Power indicator light Red: recor...
lang:en score:48 filesize: 679.08 K page_count: 8 document date: 2024-04-17



[Runcam 6 User Manual: Features, Operations, and Specifications](#)

Comprehensive user manual for the Runcam 6 action camera, covering basic operations, OLED display, component handling, firmware updates, remote control, app connection, and technical specifications.

lang:en [score:46](#) filesize: 752.61 K page_count: 8 document date: 2024-02-28



[\[pdf\] User Manual](#)

RunCam 6 CN 20240305 6 Store manual cn store m8o52p mybigcommerce product images img
RunCam6 |||

Runcam6 1 4 5 3 6 2 7 8 9 1 10 1 3 Wi-Fi/ 5 / 7 Type-C 9 SD 2 OLED 4 6 Wi-Fi 8 HDMI
10 : Wi-Fi:Wi-Fi/, 2 ,/ 3,,, ,/ 4K30FPS TF 5,, ,/ 1,,, 00:00:01 TF ,/ 2,,, ,Wi-Fi/ ,1, ,/ 2 12M
TF , Wi-Fi ,Wi-Fi/ 1, Wi-Fi/,WIFI Wi-Fi Wi-Fi SSID :RunCam6 XXXX PASSW...

lang:it [score:46](#) filesize: 710.6 K page_count: 8 document date: 2024-03-05



[\[pdf\] User Manual Diagram](#)

RunCam 6 EN 5 hours ago — Page 1 User Manual Runcam6 2 Diagram 3 4 7 8 9 10 Lens protection
hood OLED Display Wi manual en unmannedtechshop co uk 2024 02 |||

User Manual **Runcam6** 1 Diagram 4 5 3 6 2 7 8 9 1 10 1 Lens protection hood 3 Wi-Fi/Menu button 5 Power light indicator 2 OLED Display 7 Type-C port 4 Power/Shutter button 6 Wi-Fi/Menu light indicator 9 MicroSD card holder 8 HDMI port 10 Battery holder Power indicator light Red: recor...

lang:en [score:44](#) filesize: 622.44 K page_count: 8 document date: 2024-01-11

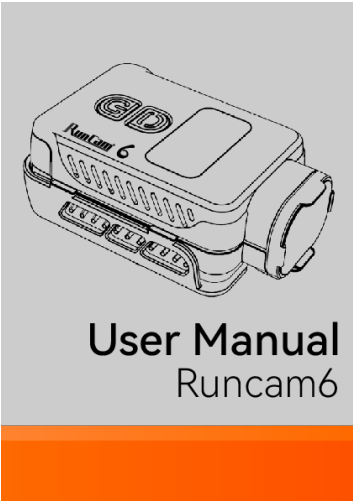

[pdf] User Manual Diagram

RunCam 6 EN StuntcamsHere we take Flight Controller Speedy Bee F7 for an example Solder the wires of TypeC control cable to pads on V3 with Power wire 5V pad RunCam6 Manualstuntcams pub media resources RUNCAM6 RunCam6 Manual srsItd

AfmBOoriRssAXVeaVq1DG6949ofNoYRmaUqIjB5D3EteIOmhBYIJPfv StuntcamsRunCam pad Use BetaFlight configure setting UART3 SpeedyBee as device Configure at Modes Find tab and there are stuntcams AfmBOoriRssAXVeaVq1DG6949ofNoYRmaUqIjB5D3EteIOmhBYIJPfvstuntcams AfmBOopycmUSSaBPbSBZQtGAnObRCodOIAXnQbVcXpEcmT5ng7R56p I ||| ||| User Manual Runcam6 1 Diagram 4 5 3 6 2 7 8 9 1 10 1 Lens protection hood 3 Wi-Fi/Menu button 5 Power light indicator 2 OLED Display 7 Type-C port 4 Power/Shutter button 6 Wi-Fi/Menu light indicator 9 MicroSD card holder 8 HDMI port 10 Batt

User Manual **Runcam6** 1 Diagram 4 5 3 6 2 7 8 9 1 10 1 Lens protection hood 3 Wi-Fi/Menu button 5 Power light indicator 2 OLED Display 7 Type-C port 4 Power/Shutter button 6 Wi-Fi/Menu light indicator 9 MicroSD card holder 8 HDMI port 10 Battery holder Power indicator light Red: recor...

lang:en score:40 filesize: 622.44 K page_count: 8 document date: 2024-01-11



[pdf] User Manual Diagram

RunCam 6 EN 20240417 manual 679 1 kB Action camera 6 With ND filters na Hobbydrone cz runcam en hobbydrone user related files |||

User Manual **Runcam6** 1 Diagram 4 5 3 6 2 7 8 9 1 10 1 Lens protection hood 3 Wi-Fi/Menu button 5 Power light indicator 2 OLED Display 7 Type-C port 4 Power/Shutter button 6 Wi-Fi/Menu light indicator 9 MicroSD card holder 8 HDMI port 10 Battery holder Power indicator light Red: recor...

lang:en score:39 filesize: 679.08 K page_count: 8 document date: 2024-04-17

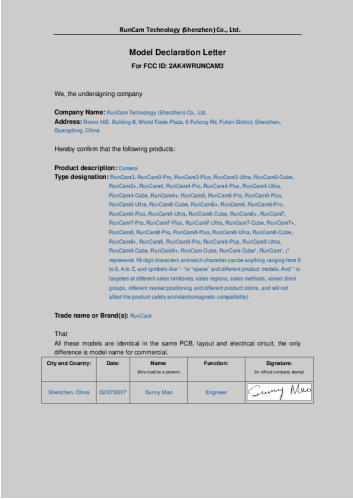

[pdf] Decleration of Conformity

Microsoft Word Model Declaration Letter doc toby81818 RunCam Technology Shenzhen Co Ltd RUNCAM3 Camera 2AK4WRUNCAM3 runcam3

RunCam Technology Shenzhen Co., Ltd. Model Declaration Letter For FCC ID: 2AK4WRUNCAM3 We, the undersigning company Company Name: RunCam Technology Shenzhen Co., Ltd. Address: Room 16E, Building B, World Trade Plaza, 9 Fuhong Rd, Futian District, Shenzhen, Guangdong, China Hereby confirm that...

lang:en score:30 filesize: 61.09 K page_count: 1 document date: 2017-02-10

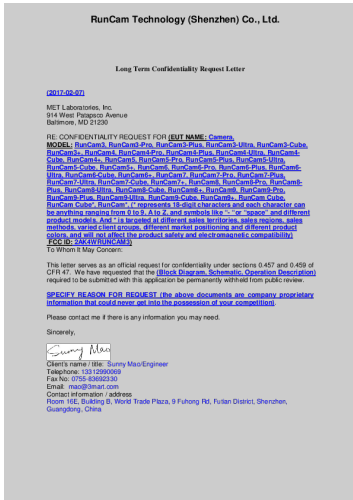

lang:en score:29 filesize: 30.75 K page_count: 1 document date: 2017-12-22

lang:en score:24 filesize: 10.1 M page_count: 91 document date: 2017-12-22