



Manuals.plus /

› Bloom Lume /

› Bloom Lume LED Grow Lights BL-CB201 User Manual

Bloom Lume BL-CB201



Bloom Lume LED Grow Lights

MODEL: BL-CB201 USER MANUAL

1. Product Overview

The Bloom Lume LED Grow Light (Model BL-CB201) is designed to provide optimal lighting for indoor plants, mimicking natural sunlight. It features full-spectrum LED technology, a flexible gooseneck design, a sturdy clip, and an integrated control panel for versatile operation.



Image 1.1: Bloom Lume LED Grow Light product packaging, showing the dual-head light unit with clip and flexible goosenecks, illuminating potted plants.

2. Package Contents

Verify that all components are present in the package:

- Bloom Lume LED Grow Light Unit (with two light tubes, flexible goosenecks, and clip)
- Integrated Control Panel
- Power Adapter
- User Manual (this document)

FULL SPECTRUM BRILLIANCE: ENDLESS GROWTH POSSIBILITIES



Multi Mode Options

88 High Efficiency LED Bulbs

Flexible Gooseneck

Strong Metal Clip

Connected power supply

Image 2.1: Individual components of the Bloom Lume LED Grow Light, including the multi-mode control panel, two LED light tubes, flexible gooseneck, strong metal clip, and connected power supply.

3. Setup Instructions

1. **Attach the Clip:** Securely attach the integrated clip to a stable surface such as a table edge, shelf, or plant stand. Ensure the surface thickness is compatible with the clip's opening.
2. **Position the Lights:** Adjust the flexible goosenecks to direct the LED light tubes towards your plants. The goosenecks allow for 360-degree rotation and precise positioning to cover multiple plants or specific areas.
3. **Connect Power:** Plug the power adapter into a standard 120V AC electrical outlet. Ensure the connection is secure.



Image 3.1: The Bloom Lume LED Grow Light set up on a desk, with its flexible goosenecks positioned to illuminate several potted indoor plants, demonstrating its application.

4. Operating Instructions

The control panel allows you to manage power, light intensity, spectrum modes, and timer settings.

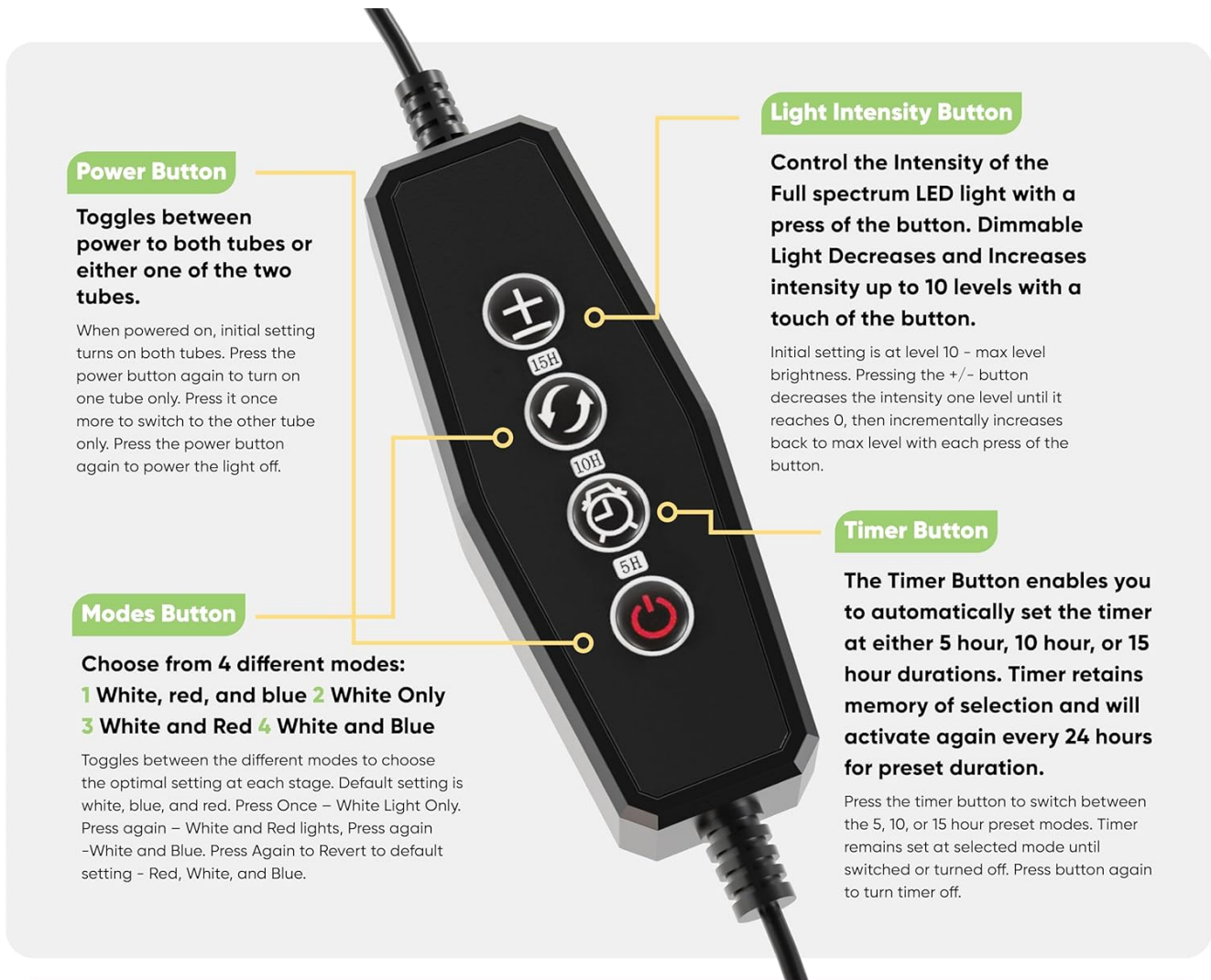

MULTI-MODE FUNCTIONS

- 10 Levels of Light
- 5h 10h 15h Timer
- 4 Spectrum Modes

Image 4.1: Detailed diagram of the Bloom Lume LED Grow Light control panel, highlighting the Power, Light Intensity, Timer, and Modes buttons with their respective functions.

4.1. Power Button ()

- Press once to turn on both light tubes.
- Press a second time to activate only one light tube.
- Press a third time to switch to the other single light tube.
- Press a fourth time to turn off the light.

4.2. Light Intensity Button (+/-)

- Adjusts the brightness of the LED lights across 10 levels.
- Initial setting is maximum brightness (level 10).
- Press the '-' button to decrease intensity.
- Press the '+' button to increase intensity.

4.3. Timer Button (🕒)

Sets the automatic daily operation duration. The timer retains its memory and activates daily at the set time.

- Press once for 5 hours of operation.
- Press a second time for 10 hours of operation.
- Press a third time for 15 hours of operation.
- Press a fourth time to deactivate the timer.

4.4. Modes Button (U)

Cycles through different light spectrum combinations to suit various plant growth stages.

- **Default Mode:** White, Red, and Blue (Full Spectrum).
- Press once for **White Only:** Simulates natural sunlight, suitable for general growth.
- Press a second time for **White and Blue:** Promotes strong root development, foliage, and vegetative growth.
- Press a third time for **White and Red:** Encourages flowering, fruiting, and budding, increasing yield.
- Press a fourth time to revert to the default White, Red, and Blue mode.



Image 4.2: Visual representation of the different light spectrum modes (White, White + Blue, White + Red) provided by the Bloom Lume LED Grow Light and their effects on plant growth.

5. Maintenance

- **Cleaning:** Disconnect the power before cleaning. Use a soft, dry cloth to wipe the light tubes and control panel. Do not use liquid cleaners or immerse any part of the unit in water.
- **Storage:** When not in use, store the grow light in a cool, dry place away from direct sunlight and moisture.
- **Safety:** Do not attempt to disassemble or modify the unit. Keep out of reach of children and pets. Ensure proper ventilation around the light during operation.

6. Troubleshooting

Problem	Possible Cause	Solution
Light does not turn on	No power, loose connection, faulty adapter.	Check power outlet. Ensure all connections are secure. Try a different outlet.
Lights flicker or turn off unexpectedly	Unstable power supply, internal component issue.	Ensure stable power source. If problem persists, contact customer support.
Control panel buttons are unresponsive	Power interruption, internal malfunction.	Unplug and re-plug the power adapter. If issue continues, contact customer support.
Loud noise from power adapter	Electrical interference, component defect.	Discontinue use immediately and contact customer support for assistance.
Plants are not thriving under light	Incorrect light intensity, wrong spectrum mode, insufficient duration, improper distance.	Adjust light intensity and spectrum mode according to plant needs. Ensure appropriate distance from plants. Verify timer settings.

7. Specifications

Feature	Detail
Model Number	BL-CB201
Light Source Type	LED
Wattage	10 Watts
Voltage	120 Volts (AC)
Light Color	Blue, Red, White 6000K
Special Features	Dimmable (10 levels), Full Spectrum, Auto Timer (5/10/15 hours)
Mounting Type	Desktop/Tabletop (Clip-on)
Material	Metal, Plastic
Product Dimensions	4 x 1 x 26 inches
Item Weight	1.19 pounds
Indoor/Outdoor Usage	Indoor

8. Warranty and Support

Bloom Lume products are manufactured with quality and reliability in mind. For warranty information, technical support, or any inquiries regarding your Bloom Lume LED Grow Light, please refer to the contact information provided on the product packaging or visit the official Bloom Lume website. Please have your model number (BL-CB201) and purchase details ready when contacting support.

For additional resources and product information, you may visit the [Bloom Lume Store on Amazon](#).