

## Philips Lighting 8720169279100

# Philips LED Bliss DC Fan Ceiling User Manual

Model: 8720169279100

## 1. INTRODUCTION

---

This manual provides essential information for the safe and efficient operation of your Philips LED Bliss DC Fan Ceiling. Please read these instructions carefully before installation and use, and retain them for future reference.

The Philips LED Bliss DC Fan Ceiling combines efficient lighting with powerful air circulation. It features transparent blades that retract into the light fixture when not in use, a quiet DC motor, and various light and fan settings for optimal comfort.

## 2. SAFETY INFORMATION

---

Always adhere to the following safety precautions to prevent injury or damage:

- Ensure the power supply is disconnected before installation, cleaning, or maintenance.
- Installation must be performed by a qualified electrician and in accordance with local electrical codes.
- The mounting structure must be capable of supporting the weight of the fan (approximately 7.2 Grams).
- Do not insert objects into the fan blades while the fan is operating.
- This product is designed for indoor use only.
- The fan includes drop-resistant screws and a sturdy design for enhanced safety.
- For information on cleaning and disposing of damaged lamps, refer to relevant recycling guidelines.

## 3. PACKAGE CONTENTS

---

Verify that all components are present and undamaged before beginning installation:

- Philips LED Bliss DC Fan Ceiling unit
- Remote Control
- Mounting hardware (screws, anchors, etc.)
- User Manual (this document)



Image: The Philips LED Bliss DC Fan Ceiling, showing the main unit with retractable blades, the remote control, and the product packaging.

## 4. SETUP AND INSTALLATION

---

Proper installation is crucial for the performance and safety of your ceiling fan. It is recommended to have this product installed by a certified electrician.

### 4.1 Pre-Installation Checks

- Ensure the ceiling joist or support structure can safely hold the fan's weight.
- Verify that the electrical wiring at the installation site is compatible with the fan's requirements.
- Unpack all components and inspect for any damage.

### 4.2 Dimensions and Clearance

Consider the product dimensions for optimal placement and air circulation. The fan has a diameter of 51 cm (when blades

are retracted) and a height of 41.8 cm from the ceiling.

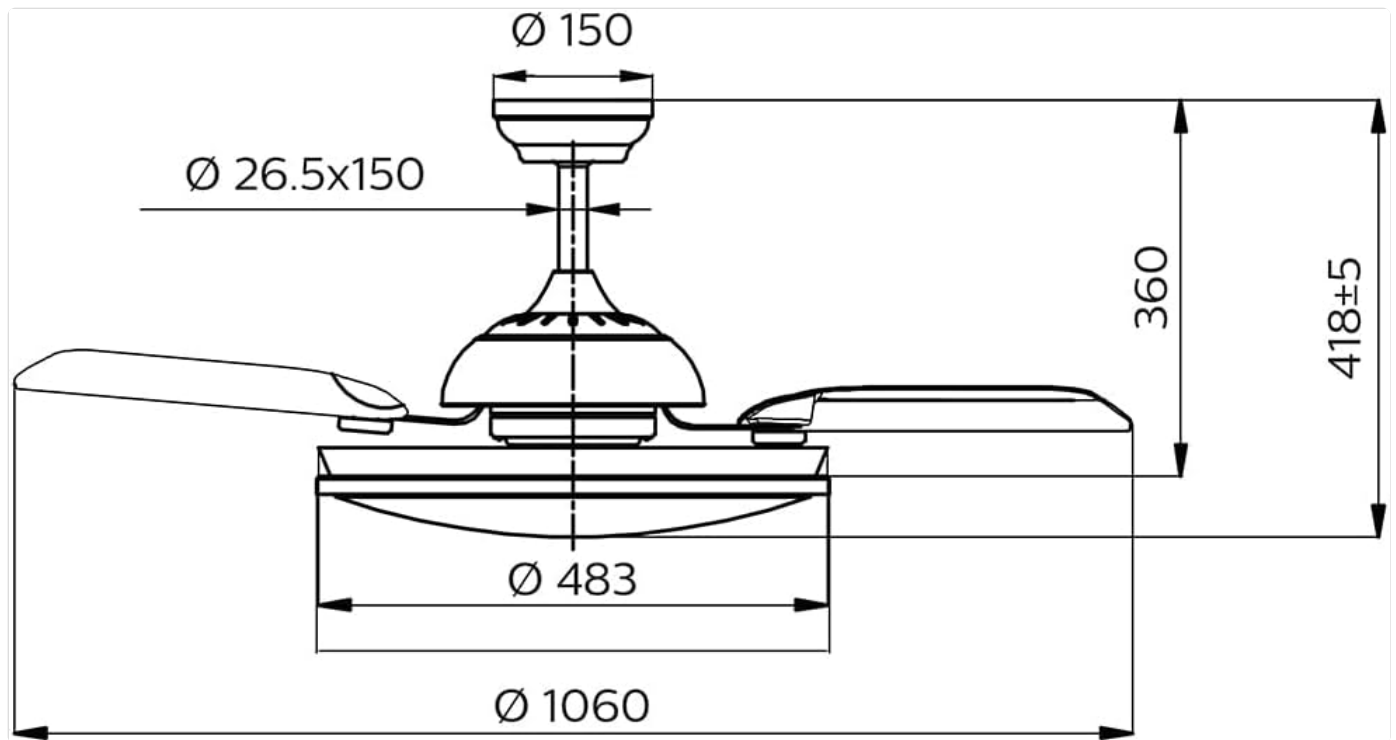

Image: Technical drawing illustrating the dimensions of the Philips LED Bliss DC Fan Ceiling, including height and diameter measurements.

### 4.3 Mounting Steps (General)

1. Turn off power at the main circuit breaker.
2. Secure the mounting bracket to the ceiling joist using appropriate hardware.
3. Connect the electrical wiring according to the wiring diagram provided in the separate installation guide (not included in this manual).
4. Attach the fan assembly to the mounting bracket.
5. Ensure all connections are secure and the fan is stable.
6. Restore power and test the fan and light functions.

## 5. OPERATING INSTRUCTIONS

Your Philips LED Bliss DC Fan Ceiling is operated via the included remote control, offering comprehensive control over both lighting and fan functions.

### 5.1 Remote Control Functions

- **Power On/Off:** Activates or deactivates the fan and light.
- **Light Control:** Adjusts light brightness and color temperature (2700K Warm White, 4000K Cool White, 6500K Daylight).
- **Fan Speed:** Selects from 1 to 6 wind strength settings.
- **Natural Breeze Function:** Provides dynamic speed settings to simulate a natural breeze.
- **Timer Function:** Sets the fan or light to turn off automatically after a specified period.
- **Summer/Winter Operation:** Toggles between modes to optimize air circulation for different seasons. In summer mode, the fan rotates counter-clockwise to create a cooling breeze. In winter mode, it rotates clockwise to redistribute warm air.

## Why choose Philips EyeComfort LED



Poor light quality could cause eye strain. Philips LED lights are designed to be easy on your eyes. Look for the EyeComfort icon to choose bulbs that meet our strict criteria for visual comfort.



Image: Visual representation of key features including remote control, quiet operation, adjustable wind strength, seasonal operation modes, EyeComfort lighting, and timer functions.

| Family Name                           | Amigo  | Amigo  | Atlas           | Bliss                                    |
|---------------------------------------|--|--|-----------------|--|
| Consumption power Light/Fan (W)       | 20W+42W  | 25W+60W  | 28W+35W         | 28W+35W                                  |
| Color temperature (K)                 | 2700/4000/6500K  | 2700/4000/6500K  | 2700/4000/6500K | 2700/4000/6500K                          |
| Dimensions – height and diameter (mm) | 137/485  | 142/577  | 485 x 418       | 510 x 418                                |
| Perfect for low ceilings              | ✓  | ✓  | ✗               | ✗  |
| Foldable transparent blades           | ✗  | ✗  | ✓               | ✓  |
| Colors available                      | White/White with sparking diffuser*<br>*not in all countries | White/White with sparking diffuser*<br>*not in all countries | Nickel          | White, white with black, white with gold |

Image: Illustration highlighting the summer and winter operation modes for year-round air circulation optimization.

### 5.2 EyeComfort LED Lighting

The integrated Philips LED lighting is designed to be easy on your eyes, providing comfortable light quality that minimizes eye strain. It delivers consistent light quality, output, and color throughout its lifespan.

The Philips LED ceiling fan light offers powerfully bright — yet comfortable — light for your home, which you can control with the included remote control or a wall switch.

## 6. MAINTENANCE

Regular maintenance ensures the longevity and optimal performance of your Philips LED Bliss DC Fan Ceiling.

### 6.1 Cleaning

- Before cleaning, ensure the power supply to the fan is turned off at the circuit breaker.
- Wipe the fan blades and light fixture with a soft, damp cloth. Do not use abrasive cleaners or solvents.
- Avoid getting water into the motor housing or electrical components.
- For information on how to clean up and dispose of broken or damaged lamps, consult relevant guidelines.

### 6.2 General Care

- Periodically check all screws and connections to ensure they are secure.
- The LED light source is integrated and not user-replaceable.

## 7. TROUBLESHOOTING

If you encounter issues with your Philips LED Bliss DC Fan Ceiling, refer to the following common problems and solutions:

| Problem   | Possible Cause  | Solution  |
|---|---|---|
| Fan does not operate / Light does not turn on           | No power supply;<br>Loose wiring; Remote control battery low. | Check circuit breaker; Verify wiring connections (consult electrician); Replace remote control batteries.   |
| Fan makes unusual noise                                 | Loose screws;<br>Unbalanced blades;<br>Obstruction.           | Ensure all mounting screws are tightened; Check for any obstructions around the blades. The fan is designed with a quiet motor, but minor operational sounds may occur.     |
| Remote control not responding / Timer setting difficult | Remote control out of range; Battery low; Interference.       | Ensure remote is within range; Replace batteries; Minimize interference from other electronic devices. Refer to the remote control's specific instructions for timer setup. |
| Light flickers or dims unexpectedly                     | Loose electrical connection; Power fluctuations.              | Check electrical connections (consult electrician); Ensure stable power supply.   |

If the problem persists after attempting these solutions, please contact Philips customer support.

## 8. SPECIFICATIONS

| Feature            | Detail            |
|--------------------|-------------------|
| Brand              | Philips Lighting  |
| Model Number       | 8720169279100     |
| Product Dimensions | 41.8 x 51 x 51 cm |

| Feature                         | Detail  |
|---------------------------------|---|
| Item Weight                     | 7.2 Grams   |
| Material                        | Plastic, Metal  |
| Colour                          | Black (Zwart)   |
| Light Fixture Form              | Ceiling   |
| Power Consumption (Light + Fan) | 28W + 35W (as per A+ content table for Bliss family)                  |
| Color Temperature (Light)       | 2700K / 4000K / 6500K (as per A+ content table)                       |
| Specific Uses                   | Home  |
| Assembly Required               | No (as per specifications, but professional installation recommended) |
| Batteries Required              | No (for main unit, remote control requires batteries)                 |

With operation modes for both summer and winter, you'll get the best settings to circulate the air in your space all year round.



Summer/winter operation

Image: A comparison table detailing specifications for various Philips fan ceiling models, including the Bliss series, highlighting power consumption, color temperature, and dimensions.

9. WARRANTY AND SUPPORT

Philips products are manufactured to the highest standards and are designed for high performance and ease of use. For information regarding warranty coverage and customer support, please refer to the warranty card included with your product or visit the official Philips Lighting website.

For recycling information for this and other types of lamps, please visit the relevant recycling guidelines provided by Philips or local authorities.

Online Resources:

- Philips Official Website: [www.philips.com](http://www.philips.com)
- Philips Store on Amazon: [Philips Store](#)

