

## Manuals+

[Q & A](#) | [Deep Search](#) | [Upload](#)

manuals.plus /

> [AOTIQUAL](#) /

> [AOTIQUAL Smoke and Carbon Monoxide Detector \(Model: XY-S510COM\) User Manual](#)

## AOTIQUAL XY-S510COM

# AOTIQUAL Smoke and Carbon Monoxide Detector

## MODEL: XY-S510COM USER MANUAL

Your guide to safe and effective use.

### 1. Introduction

---

This manual provides essential information for the proper installation, operation, and maintenance of your AOTIQUAL Smoke and Carbon Monoxide Detector. This device is designed to provide early warning of both smoke and carbon monoxide (CO) presence in your home, enhancing your safety. Please read this manual thoroughly before installation and keep it for future reference.

### 2. Important Safety Information

---

- **WARNING:** This device detects both smoke and carbon monoxide. It is not designed to detect natural gas, propane, butane, or other combustible fuels.
- **WARNING:** This device is battery-operated and requires 3 AA batteries (not included). Ensure batteries are installed correctly and replaced when the low battery indicator appears.
- **WARNING:** Do not paint the detector. Paint can clog the sensing chambers and prevent the unit from operating correctly.
- **WARNING:** Test the alarm weekly to ensure proper operation.
- **CAUTION:** Carbon monoxide is a colorless, odorless, and tasteless gas. This detector is designed to detect CO gas from any source of combustion.

### 3. Product Overview and Features

---

The AOTIQUAL Smoke and Carbon Monoxide Detector is a 2-in-1 device offering comprehensive protection. It features dual high-stability sensors for accurate detection of both smoke and CO.

# 2-in-1 Protection

## Smoke and Carbon Monoxide Alarm



Image: The AOTIQUAL detector, highlighting its dual smoke and carbon monoxide detection capabilities.

### Key Features:

- **Dual Sensor Technology:** Equipped with both photoelectric smoke sensor and electrochemical CO sensor for enhanced accuracy.
- **Loud Alarm:** Emits an 85dB alarm to alert occupants of detected hazards.
- **Informative LCD Display:** Shows real-time CO concentration (in PPM), remaining battery life, and working status. The display activates during device tests or when CO levels reach an alarm threshold to conserve power.
- **Visual Warnings:** Red LED flashes during an audible alarm for visual indication.
- **Battery Operated:** Powered by 3x 1.5V AA batteries, ensuring operation during power outages.
- **Easy Installation:** Compact and portable design for simple setup without requiring electrical outlets.

# UL217&UL2034 Safety Standards



Image: Diagram illustrating the various components and features of the detector, such as the LCD display, test button, loudspeaker, air inlets, and LED indicators.

## 4. Setup and Installation

---

### 4.1 Battery Installation

1. Open the battery compartment cover on the back of the detector.
2. Insert three (3) 1.5V AA batteries, ensuring correct polarity (+ and -).
3. Close the battery compartment cover securely.

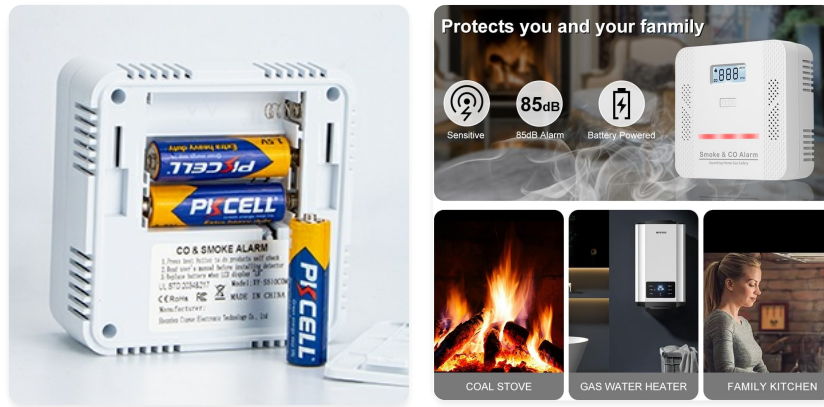

Image: Steps for installing the 3 AA batteries into the detector's battery compartment.

## 4.2 Initial Power-On and Self-Check

Upon battery installation, the detector will perform a self-check and a countdown will appear on the LCD display. Once complete, the device will enter power-saving mode, and the display will typically be blank unless a test is performed or an alarm condition is met.

## 4.3 Mounting Location

Proper placement is crucial for effective detection. Smoke rises, while carbon monoxide mixes with air and can be found at various heights. For optimal performance of this combination alarm:

- Install on a wall or ceiling. If on a wall, place the detector at least 15 cm (6 inches) below the ceiling.
- Avoid placing near windows, doors, or areas with high airflow, as this can interfere with detection.
- Do not install in kitchens, bathrooms, or garages where high humidity, smoke from cooking, or vehicle exhaust could cause false alarms.
- For best protection, install a detector on every level of your home, inside each sleeping area, and in the hallway outside of each separate sleeping area.



Image: A person installing the detector on a ceiling, demonstrating typical mounting.

## 5. Operation

### 5.1 Normal Operation

In normal operating conditions, the LCD display will typically be blank to conserve battery life. A green

LED indicator may flash periodically to confirm the unit is functioning.

## 5.2 Testing the Detector

Press the 'TEST' button located on the front of the detector. The unit will perform a self-test, sound the alarm, and the LCD will display a reading (e.g., '000' or a low CO level) before returning to normal operation. This confirms the alarm and display are working correctly.



Image: Demonstrating the use of the 'TEST' button and a close-up of the LCD display during operation.

## 5.3 Alarm Conditions

When smoke or carbon monoxide is detected at dangerous levels, the detector will:

- Sound a loud 85dB alarm.
- Flash the red LED indicator.
- The LCD display will show the detected CO concentration (in PPM) if CO is the cause.



Image: Visual representation of the detector's 85dB alarm sound propagation.

## 5.4 Video Demonstration

Your browser does not support the video tag.

Video: A demonstration of the AOTIQUAL Smoke and Carbon Monoxide Detector, showing its display and alarm functions. This video illustrates how to install batteries, test the unit, and observe its response to simulated smoke and CO.

## 6. Maintenance

## 6.1 Regular Testing

Test your detector weekly by pressing the 'TEST' button. This ensures the electronic circuitry, alarm, and battery are functioning correctly.

## 6.2 Battery Replacement

Replace the batteries immediately when the LCD display indicates low battery life. Use only three (3) new 1.5V AA alkaline batteries. Refer to section 4.1 for battery installation instructions.

## 6.3 Cleaning

Clean the detector regularly (at least once a month) to remove dust and debris. Use a soft, damp cloth to wipe the exterior. Do not use cleaning solvents or spray directly onto the unit. Do not paint the detector.

## 7. Troubleshooting

Problem	Possible Cause	Solution
Alarm sounds intermittently or for no apparent reason.	Dust accumulation, high humidity, cooking fumes, or actual low-level smoke/CO.	Clean the detector. Relocate if near sources of steam or cooking. Ventilate the area. If alarm persists, evacuate and seek professional help.
Detector does not respond when 'TEST' button is pressed.	Dead or improperly installed batteries. Unit malfunction.	Replace batteries with new ones, ensuring correct polarity. If issue persists, the unit may be faulty and require replacement.
LCD display is blank during normal operation.	This is normal behavior for power-saving mode.	The display will only activate during a test or when an alarm condition is met. Press the 'TEST' button to confirm functionality.
Flashing blue light or error message on display.	Internal fault or sensor error.	Try replacing the batteries. If the error persists, the unit may be faulty and require replacement.

## 8. Specifications

Feature	Specification
Brand	AOTIQUAL
Model Number	XY-S510COM
Power Source	3 x 1.5V AA Batteries (not included)

Feature	Specification
Sensor Type	Photoelectric (Smoke), Electrochemical (CO)
Alarm Loudness	85 dB
Product Dimensions	1.6"D x 3.78"W x 3.78"H
Item Weight	5 ounces
Material	Plastic
Color	White

## 9. Warranty and Support

---

For warranty information, technical support, or further assistance, please refer to the manufacturer's official website or contact their customer service directly. Contact details are typically provided on the product packaging or the manufacturer's website.