

Satisure B14WET01-2T3-KB

Satisure Wireless Doorbell Extender System User Manual

Model: B14WET01-2T3-KB | Brand: Satisure



1. INTRODUCTION

The Satisure Wireless Doorbell Extender System is designed to upgrade your existing hardwired doorbell into a wireless system, allowing you to hear your doorbell chime from various locations within your home or property. This system provides greater flexibility and convenience by extending the range of your doorbell notifications.



Having a doorbell extender allows you to not miss any visitors.

Keep your wired doorbell system and give you a wireless experience

Image 1.1: Overview of the Satisure Wireless Doorbell Extender System in operation, illustrating how it connects to a wired doorbell and transmits signals to a wireless receiver, ensuring visitors are not missed even in remote areas like a garage.

200 M / 656 tFT IM FREIFELD

cover your home or business completely

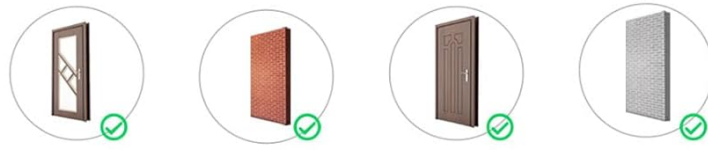

Image 1.2: This diagram illustrates the extensive coverage of the doorbell extender, reaching up to 656 feet (200 meters) in open areas, ensuring reliable signal transmission throughout a home or business, even through different types of doors.

2. PACKAGE CONTENTS

Please verify that all components are present in your package:

- 2 x Wireless Doorbell Extenders (Transmitters)
- 3 x Wireless Doorbell Receivers
- User Manual (this document)

3. SPECIFICATIONS



NOTE

■ Frequency and Transmission Power:

433.92 MHz

■ Operating Voltage of the Receiver:

AC100V-240V

■ Operating Voltage of the Transmitter:

3-24V AC/DC

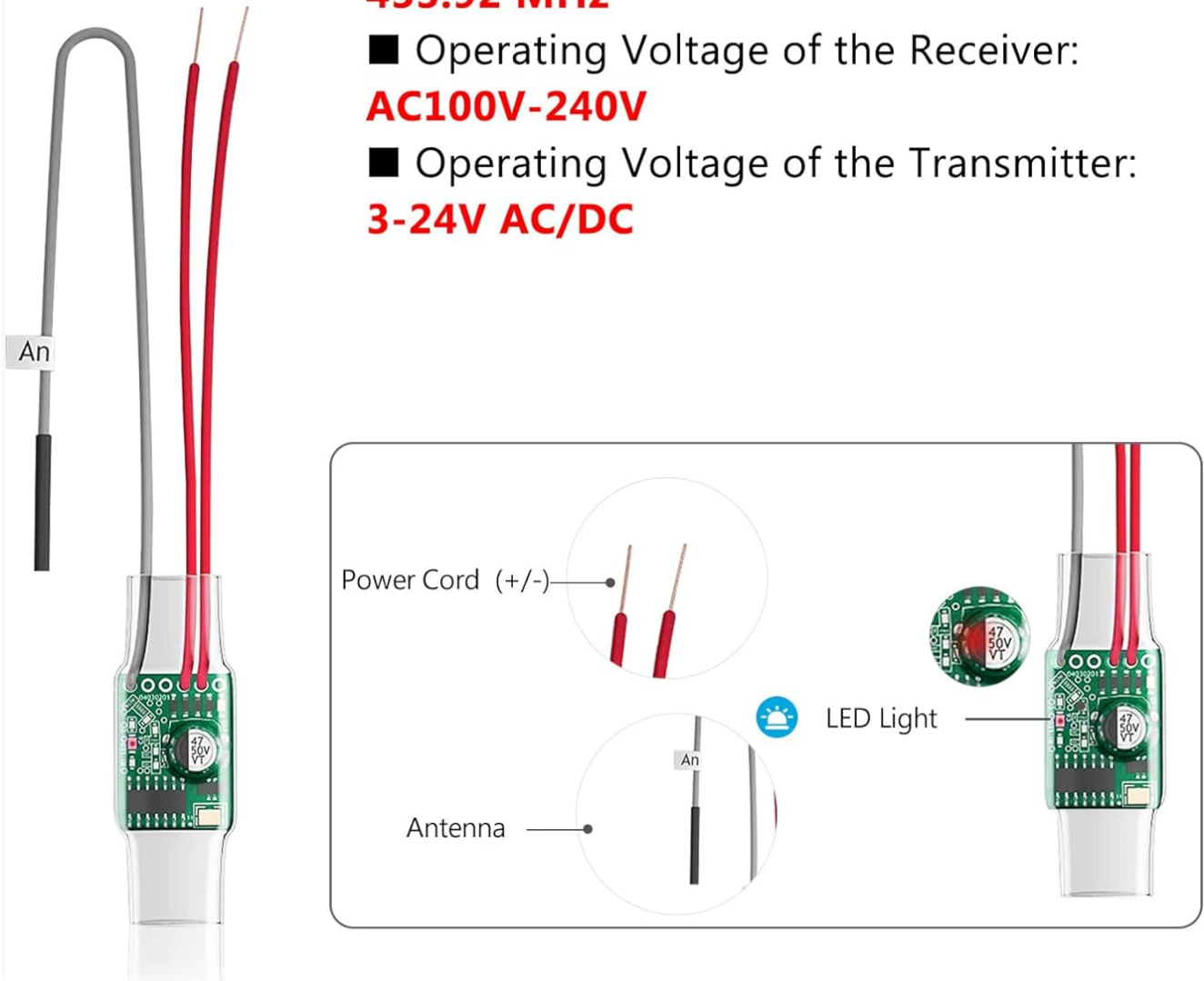

Image 3.1: A detailed view of the doorbell extender's internal components and key technical specifications, including frequency and voltage requirements for both the transmitter and receiver.

Feature	Specification
Frequency	433.92 MHz
Operating Voltage (Receiver)	AC100V-240V
Operating Voltage (Transmitter)	3-24V AC/DC
Wireless Range	Up to 656 feet (200 meters) in open areas
Chime Options	58 different chimes

Feature	Specification
Volume Levels	5 levels (0-110dB)

4. SAFETY INFORMATION

Please read and follow these safety guidelines carefully to prevent injury or damage to the product:

- **Electrical Safety:** Ensure power is disconnected from your existing doorbell system before installing the transmitter. If you are unsure about electrical wiring, consult a qualified electrician.
- **Voltage Compatibility:** The transmitter requires 3-24V AC/DC. Ensure your existing doorbell system operates within this voltage range. A transformer may be required for systems outside this range. The receiver operates on AC100V-240V.
- **Indoor Use Only:** The receivers are designed for indoor use. Do not expose them to water or extreme humidity.
- **Avoid Obstructions:** For optimal performance, avoid placing the transmitter or receiver near large metal objects or other sources of electromagnetic interference.
- **Children and Pets:** Keep the product out of reach of children and pets to prevent accidental ingestion of small parts or electrical hazards.

5. SETUP AND INSTALLATION

5.1 Transmitter Installation (Connecting to your Wired Doorbell)

The wireless doorbell extender (transmitter) connects to your existing wired doorbell button. Follow these steps:

QUICK INSTALLATION



1. Open the doorbell cover.



2. The radio transmitter is connected to the doorbell control box (there is no distinction between + and - poles).

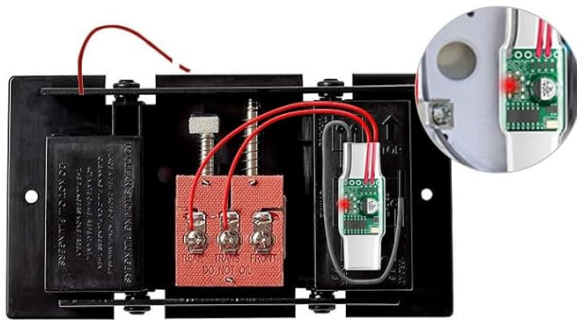

3. Turn on the circuit, the LED will light up and the receiver will ring, the connection is successful.



4. Secure the transmitter to the cover with tape to prevent it from coming loose. If you need to install both front and back doors, simply purchase 2 sets

Image 5.1: A visual guide detailing the four steps for quickly installing the doorbell extender, from opening the existing doorbell cover to securing the transmitter inside.

1. **Open the Doorbell Cover:** Carefully open the cover of your existing wired doorbell control box.
2. **Connect the Transmitter:** Connect the wires from the wireless transmitter to the terminals of your doorbell control box. There is no distinction between positive (+) and negative (-) poles for this connection. Ensure the voltage is within the 3-24V AC/DC range.
3. **Test Connection:** After connecting, press your wired doorbell button. The LED on the transmitter should light up, and if a receiver is plugged in and paired, it should ring, indicating a successful connection.
4. **Secure the Transmitter:** Secure the transmitter inside the doorbell control box cover. You may use tape to prevent it from coming loose. Close the doorbell cover. If you have both front and back wired doorbells, you will need a separate extender for each.

Doorbell Expander Connection Diagram

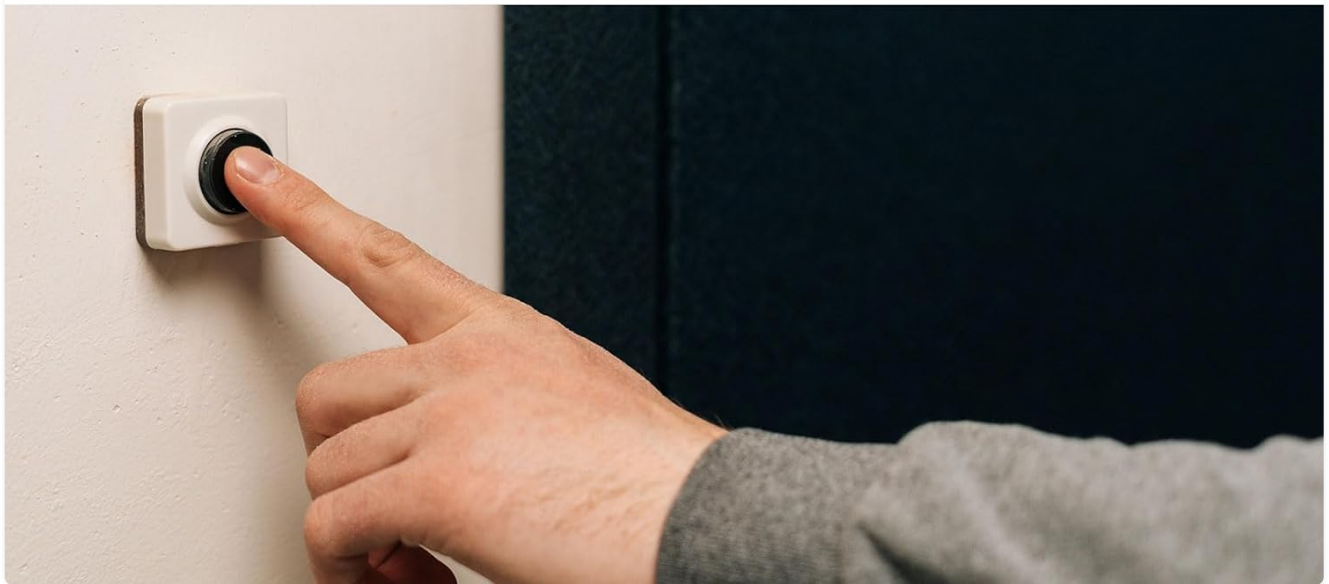
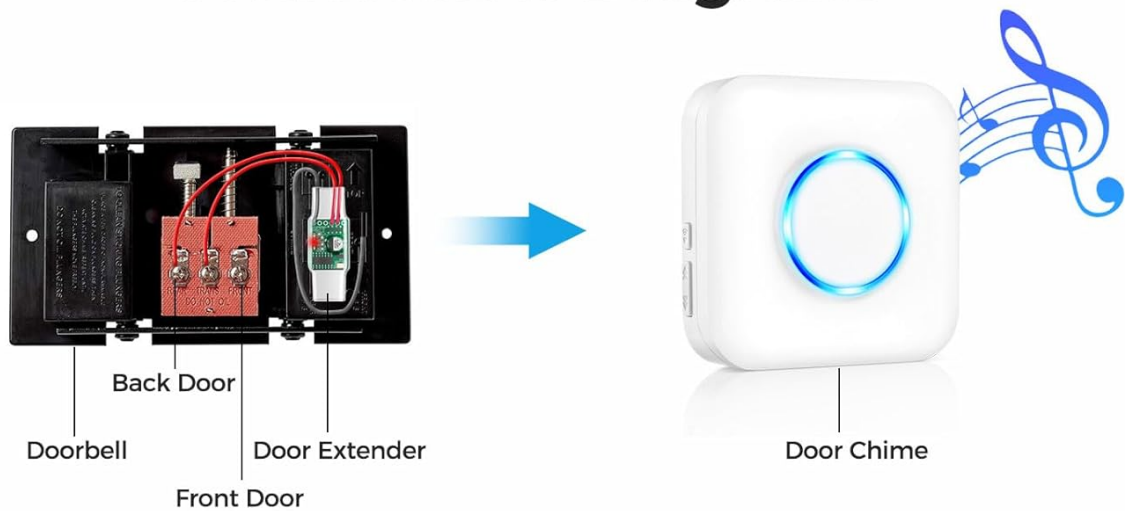

Image 5.2: This diagram illustrates the connection process of the doorbell expander (transmitter) to an existing wired doorbell system, showing how it converts the signal for transmission to a wireless door chime (receiver).

5.2 Receiver Installation

The wireless receivers are plug-and-play devices:

- Simply plug each receiver into a standard AC power outlet (AC100V-240V) in your desired location.
- Ensure the outlet is easily accessible and not obstructed.
- The receivers will automatically pair with the transmitter once the transmitter is activated.

6. OPERATING INSTRUCTIONS

6.1 Chime Selection

Your Satisure Wireless Doorbell Extender System offers 58 different chimes to suit your preferences. To change the chime:

- Locate the 'Music' or 'Chime' button on the side of the receiver.
- Press this button repeatedly to cycle through the available melodies.

- Once you hear a chime you like, stop pressing the button. The receiver will automatically save your selection.

6.2 Volume Adjustment

The system features 5 adjustable volume levels, ranging from 0dB (silent mode) to 110dB. To adjust the volume:

- Locate the 'Volume' button on the side of the receiver.
- Press this button to cycle through the 5 volume levels.
- Select the desired volume level.



Image 6.1: The wireless doorbell receiver, showcasing its ability to provide 5 selectable volume levels (0-110dB) and a choice of 58 different ringtones, ensuring you never miss a visitor.

6.3 LED Night Light Feature

The plug-in receivers are equipped with a blue LED light that serves as a visual indicator. This light can alert you to a visitor even when the receiver is in silent mode or during nighttime hours, providing an additional layer of notification.

Plug-in Receiver With Blue LED Night Light



Image 6.2: This image demonstrates the plug-in receiver's blue LED night light feature, which illuminates to indicate a visitor, even when the chime is muted or in low-light conditions.

7. MAINTENANCE

To ensure the longevity and optimal performance of your Satisure Wireless Doorbell Extender System, follow these simple maintenance tips:

- **Cleaning:** Wipe the exterior of the receivers and transmitters with a soft, dry cloth. Do not use abrasive cleaners, solvents, or harsh chemicals.
- **Avoid Water:** Do not immerse any part of the product in water or expose it to excessive moisture.
- **Environmental Conditions:** Store and operate the devices in a dry environment, away from extreme temperatures and direct sunlight.
- **Check Connections:** Periodically check the wiring connections of the transmitter to ensure they remain secure.

8. TROUBLESHOOTING

If you encounter any issues with your doorbell extender system, please refer to the following troubleshooting guide:

Problem	Possible Cause	Solution
Receiver does not chime when doorbell is pressed.	<ul style="list-style-type: none">• Receiver is unplugged or not powered.• Volume is set to 0 (silent mode).• Transmitter wires are loose or incorrectly connected.• Transmitter is out of range or signal interference.	<ul style="list-style-type: none">• Ensure receiver is securely plugged into a live outlet.• Increase the volume level on the receiver.• Check transmitter wiring connections at the wired doorbell.• Relocate receiver closer to the transmitter or away from interference sources.
Short range or intermittent signal.	<ul style="list-style-type: none">• Obstructions (thick walls, metal objects).• Interference from other wireless devices.• Low power to the wired doorbell (for transmitter).	<ul style="list-style-type: none">• Relocate receivers to a more open area.• Move receivers away from other electronics.• Ensure your wired doorbell system provides adequate voltage (3-24V AC/DC) to the transmitter.
LED on transmitter does not light up.	<ul style="list-style-type: none">• No power from the wired doorbell.• Incorrect wiring.• Faulty transmitter.	<ul style="list-style-type: none">• Verify your wired doorbell system is functional.• Recheck transmitter wiring connections.• Contact customer support if the issue persists.

9. WARRANTY AND SUPPORT

Satisure offers a 30-day refund guarantee for this product. We are committed to providing excellent service and have a dedicated after-sales service team to assist you.

If you have any questions, concerns, or require technical assistance, please do not hesitate to reach out to our customer support team. You can typically find contact information on the product packaging or through the retailer where you purchased the item.

