

## NEEWER CA004B

# NEEWER CA004B Camera Baseplate Instruction Manual

For Sony Alpha A7 IV, A7R IV, A7R V, A7S III Cameras

## 1. INTRODUCTION

Thank you for choosing the NEEWER CA004B Camera Baseplate. This baseplate is designed to enhance the stability and expand the accessory mounting options for your Sony Alpha A7 IV, A7R IV, A7R V, and A7S III mirrorless cameras. Crafted from durable aluminum alloy, it offers a secure and versatile platform for various shooting scenarios, including handheld, tripod, and gimbal setups.

This manual provides detailed instructions for the proper installation, operation, and maintenance of your NEEWER CA004B Camera Baseplate. Please read it thoroughly before use to ensure optimal performance and longevity of the product.

## 2. PRODUCT DETAILS

The NEEWER CA004B Camera Baseplate features a robust design with multiple functionalities. Key components include:

- **1/4" and 3/8" Threaded Holes:** For attaching to tripods, monopods, and other accessories.
- **Cold Shoe Mount:** For microphones, LED lights, or other cold shoe compatible accessories.
- **Arca-Type Quick Release Plate:** Enables quick transitions between compatible Arca-Swiss systems, including DJI RS 2, RSC 2, RS 3, and RS 3 Pro gimbals.
- **Anti-Twist Pin and Raised Edge:** Ensures secure camera attachment and prevents rotation.
- **Magnetic Screwdriver:** Conveniently stored on the baseplate for easy adjustments.
- **Non-slip Soft Rubber Pad:** Protects the camera from scratches and provides a firm grip.

# PRODUCT DETAILS

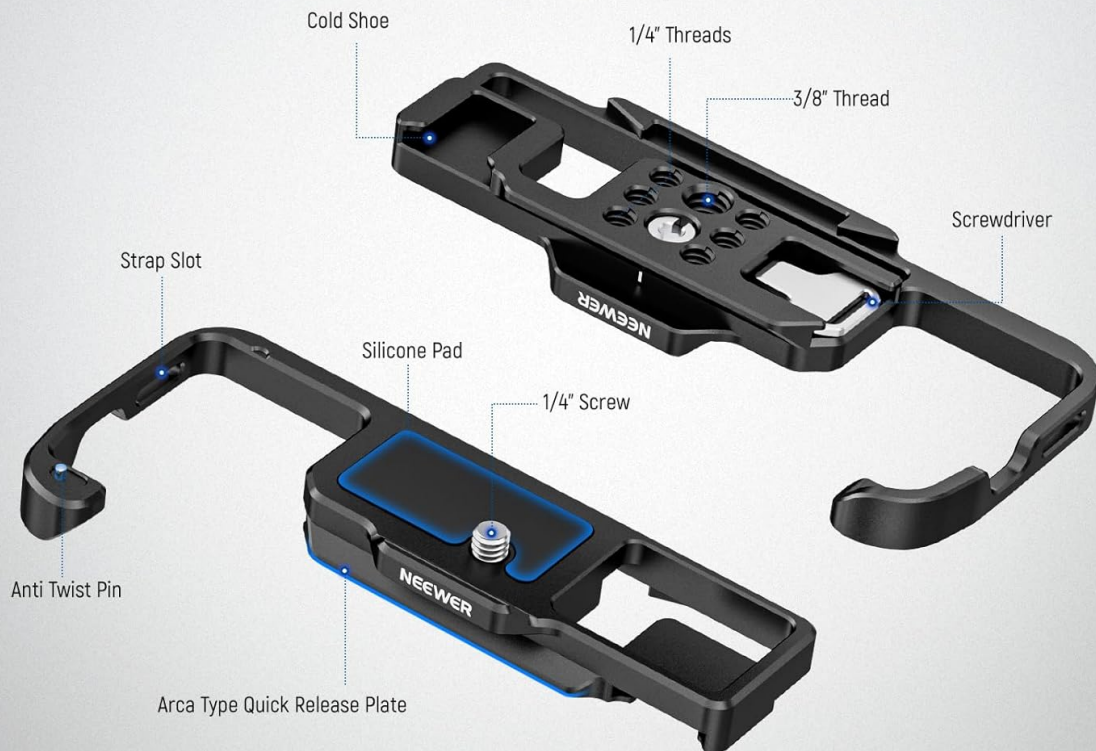

Figure 1: Detailed view of the NEEWER CA004B Camera Baseplate components.

## 3. SETUP

### 3.1 Attaching the Baseplate to Your Camera

1. Align the 1/4" screw on the baseplate with the tripod socket on the bottom of your Sony A7 IV, A7R IV, A7R V, or A7S III camera. Ensure the anti-twist pin engages with the corresponding hole on your camera body to prevent rotation.
2. Use the integrated magnetic screwdriver, located on the bottom of the baseplate, to tighten the 1/4" screw securely. Ensure the camera is firmly attached without excessive force.
3. Verify that the baseplate does not obstruct access to the camera's battery compartment or other essential ports. The design allows for full access to the battery door for convenient battery changes.

# EASY INSTALLATION

Secured by the 1/4" screw and raised edge for great stability.



Figure 2: Easy installation of the baseplate to the camera, secured by a 1/4" screw and anti-twist pin.

# ENJOY FULL ACCESS

Precisely crafted to keep the battery compartment fully accessible.



*Note: Only the baseplate is included.*

Figure 3: The baseplate design ensures full access to the camera's battery compartment.

## 3.2 Camera Compatibility

This baseplate is specifically designed for the following Sony Alpha mirrorless camera models:

- Sony A7 IV
- Sony A7R IV
- Sony A7R V
- Sony A7S III



# EXCELLENT COMPATIBILITY

Compatible with Sony a7 IV a7R IV a7R V a7S III cameras.



Note: Cameras are not included.

Figure 4: The baseplate offers excellent compatibility with specified Sony Alpha cameras.

## 4. OPERATING INSTRUCTIONS

### 4.1 Using Multiple Accessory Mounting Points

The baseplate is equipped with various 1/4" and 3/8" threaded holes, as well as a cold shoe mount, allowing for the attachment of a wide range of accessories:

- **Tripods and Monopods:** Use the 1/4" or 3/8" threads to mount your camera onto a tripod or monopod for stable shots.
- **Hand Grips:** Attach a hand grip to the side threads for improved ergonomics during handheld shooting.
- **Microphones:** Mount mini microphones (e.g., CM14 Pro) or wireless lavalier microphones (e.g., CM22/CM28) onto the cold shoe for enhanced audio recording.
- **LED Video Lights:** Attach compact LED video lights (e.g., PL81/RGB61/RGB62) to the cold shoe for improved illumination.

### 4.2 Arca-Type Quick Release Switching

The integrated Arca-type quick release plate facilitates rapid transitions between different camera support systems. It is compatible with DJI RS 2, RSC 2, RS 3, and RS 3 Pro gimbals, as well as other Arca-Swiss standard tripod heads.

1. To mount the camera onto a compatible gimbal or tripod, slide the baseplate into the Arca-Swiss clamp until it locks securely.

2. To remove, disengage the clamp's locking mechanism and slide the camera off. This allows for seamless switching between handheld, tripod, and gimbal shooting modes.

## SEAMLESS DEVICE SWITCHING

Arca type quick release plate enables seamless switching between tripod heads and RS 2/RSC 2/RS 3/RS 3 Pro gimbals.



Figure 5: Seamless device switching using the Arca-type quick release plate.

# DIFFERENT SHOOTING SCENARIOS

*Note: Only the baseplate is included.*

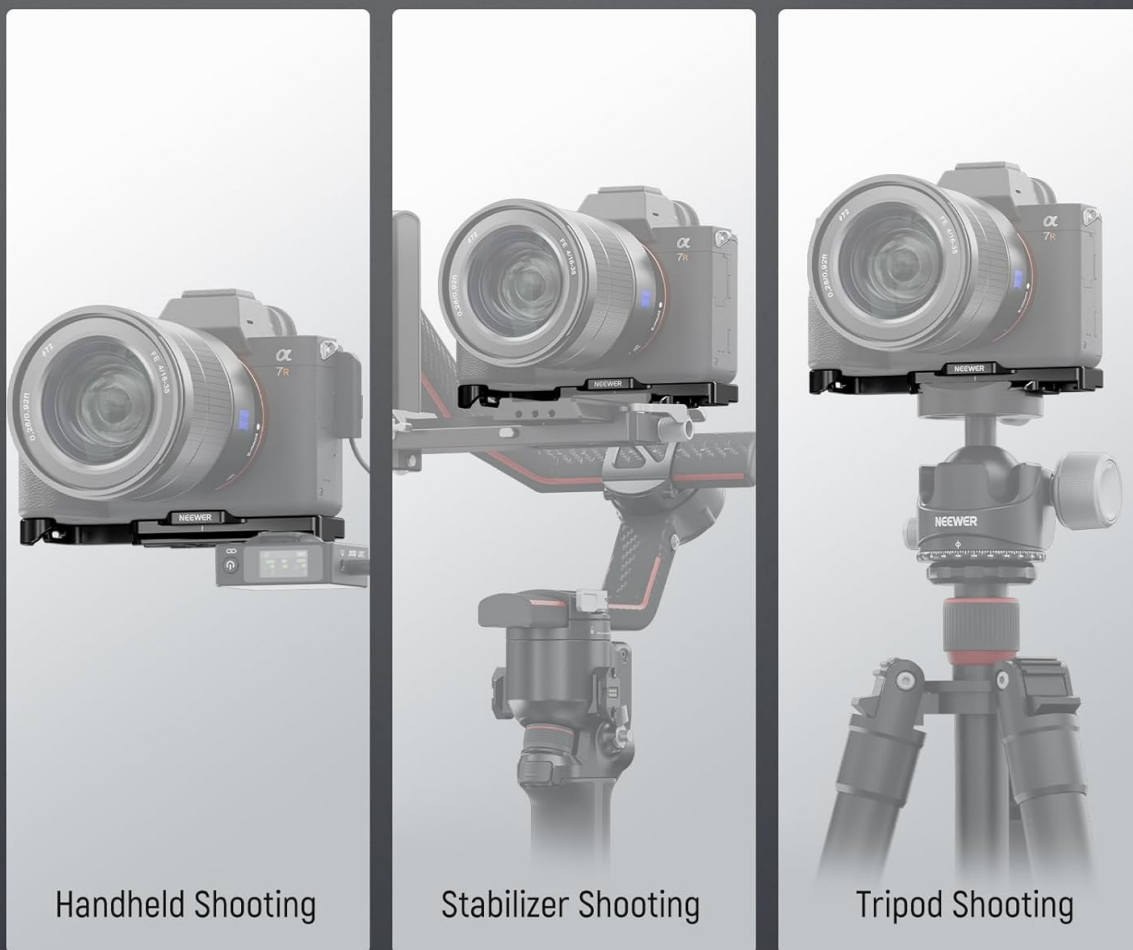

Figure 6: The baseplate supports various shooting scenarios: handheld, stabilizer, and tripod.

Your browser does not support the video tag.

Video 1: Demonstration of the NEEWER Camera Baseplate's features, including installation, battery access, and quick release functionality with gimbals and tripods.

## 5. MAINTENANCE

To ensure the longevity and optimal performance of your NEEWER CA004B Camera Baseplate, follow these maintenance guidelines:

- **Cleaning:** Wipe the baseplate with a soft, dry cloth to remove dust and debris. For stubborn dirt, use a slightly damp cloth and mild soap, then dry thoroughly. Avoid abrasive cleaners or solvents.
- **Storage:** Store the baseplate in a clean, dry environment when not in use.
- **Inspection:** Periodically check all screws and connections to ensure they are tight. Re-tighten if necessary using the magnetic screwdriver.
- **Avoid Impact:** While durable, avoid dropping or subjecting the baseplate to strong impacts, as this can cause damage to the unit or attached camera.

## 6. TROUBLESHOOTING

If you encounter any issues with your NEEWER CA004B Camera Baseplate, refer to the following common solutions:

- **Camera feels loose on the baseplate:** Ensure the 1/4" screw is fully tightened using the magnetic screwdriver. Check that the anti-twist pin is correctly engaged with the camera body.
- **Baseplate not fitting on gimbal/tripod:** Confirm that your gimbal or tripod head uses an Arca-Swiss standard quick release system. Ensure the clamp on your support system is fully open before attempting to slide the baseplate in.
- **Accessories not attaching to threads/cold shoe:** Verify that the accessory uses a standard 1/4"-20 or 3/8"-16 thread, or is cold shoe compatible. Do not force accessories if they do not fit smoothly.

If the problem persists, please contact NEEWER customer support for further assistance.

## 7. SPECIFICATIONS

Model	CA004B
Compatibility	Sony A7 IV, A7R IV, A7R V, A7S III
Mounting Points	1/4"-20 threads, 3/8"-16 threads, Cold Shoe, Arca-Type Quick Release
Main Material	Aluminum Alloy
Dimensions	5.2" x 2.6" x 0.6" (132 x 67 x 14mm)
Item Weight	3 ounces (73g)
Color	Black

### 7.1 Package Contents

- 1 x NEEWER CA004B Camera Baseplate



## PACKAGE CONTENTS

1 x Camera Baseplate for Sony A7 IV A7R IV A7R V A7S III



## SPECIFICATIONS

Model: CA004B

Compatibility: For A7 IV/A7R IV/A7R V/A7S III

Mounting Points: 1/4" & 3/8" threads, cold shoe

Main Material: Aluminum Alloy

Dimensions: 5.2"x2.6"x0.6"/132x67x14mm

Weight: 2.6oz/73g

Figure 7: Package contents and detailed specifications of the baseplate.

## 8. WARRANTY AND SUPPORT

NEEWER products come with a standard manufacturer's warranty. For specific warranty terms and conditions, please refer to the warranty card included with your product or visit the official NEEWER website. If you require technical support, have questions about product usage, or need to report an issue, please contact NEEWER customer service through their official channels.