

M21

Generic M21 Bluetooth Earbuds User Manual

Model: M21

INTRODUCTION

Thank you for choosing the Generic M21 Bluetooth Earbuds. This manual provides detailed instructions for setting up, operating, and maintaining your new wireless earphones. Please read this manual carefully before use to ensure optimal performance and longevity of your device.

PRODUCT OVERVIEW

The Generic M21 Bluetooth Earbuds offer a high-fidelity audio experience with wireless convenience. They feature seamless Bluetooth 5.2 connectivity, a comfortable in-ear design, and extended battery life for all-day use. The built-in microphone allows for clear hands-free calling.

Key Features:

- Bluetooth 5.2 for stable and efficient wireless connection.
- High-quality audio with active noise cancellation.
- Extended playtime up to 48 hours with the charging case.
- Built-in microphone for hands-free calls.
- Intuitive touch controls for music and call management.
- Fast charging capability.

Package Contents:

- Generic M21 Bluetooth Earbuds (Left and Right)
- Charging Case
- Protective Case
- User Manual (this document)
- (Note: USB charging cable may be included but not explicitly listed in product details.)*



Image: Generic M21 Bluetooth Earbuds securely placed within their charging case, displaying their compact design and readiness for use.

SETUP

1. Charging the Earbuds and Case:

Before first use, fully charge the earbuds and the charging case. Place the earbuds into the charging case. Connect the charging case to a USB power source using a compatible USB cable (not explicitly listed as included, but standard for such devices). The indicator lights on the case will show the charging status. Once fully charged, the indicator lights will change or turn off.

2. Initial Pairing with a Device:

1. Ensure the earbuds are charged and inside the charging case.
2. Open the charging case. The earbuds will automatically enter pairing mode.
3. On your device (smartphone, tablet, laptop), go to the Bluetooth settings.

4. Search for available Bluetooth devices. You should see "M21" or a similar name appear in the list.
5. Select "M21" to connect. Once connected, a voice prompt will confirm successful pairing.

Note: For the first connection, manual pairing is required. After the initial pairing, the earbuds will automatically connect to the last paired device when removed from the charging case, provided Bluetooth is enabled on the device.

Grade 7 waterproof, no fear of rain

Multi-process design of the headphone body,
Reach life-level waterproof,
no fear of rain and sweat soaking,
Sweat profusely, not afraid of wind and rain

=



Image: A smartphone screen displaying Bluetooth settings, with the "M21" earbuds listed as an available device for connection, illustrating

the pairing process.

3. Automatic Reconnection:

Once successfully paired, the earbuds will automatically connect to your device when taken out of the charging case. Ensure Bluetooth is active on your device.

OPERATING THE EARBUDS

The M21 earbuds feature intuitive touch controls on each earbud for managing music playback and calls.

Touch Control Functions:

Action	Function
Double click left earbud	Previous track
Double click right earbud	Next track
One tap on either earbud	Play/Pause music
One tap on either earbud (incoming call)	Answer/Hang up call
Press and hold either earbud for 1 second (incoming call)	Reject call
Press and hold either earbud for 2 seconds	Activate voice assistant (e.g., Siri, Google Assistant)

Ai Smart Fingerprint Touch

The headset has a built-in
high-sensitivity touch panel,
Gently touch to intelligently recognize
your intentions,
Complete multiple operations quickly



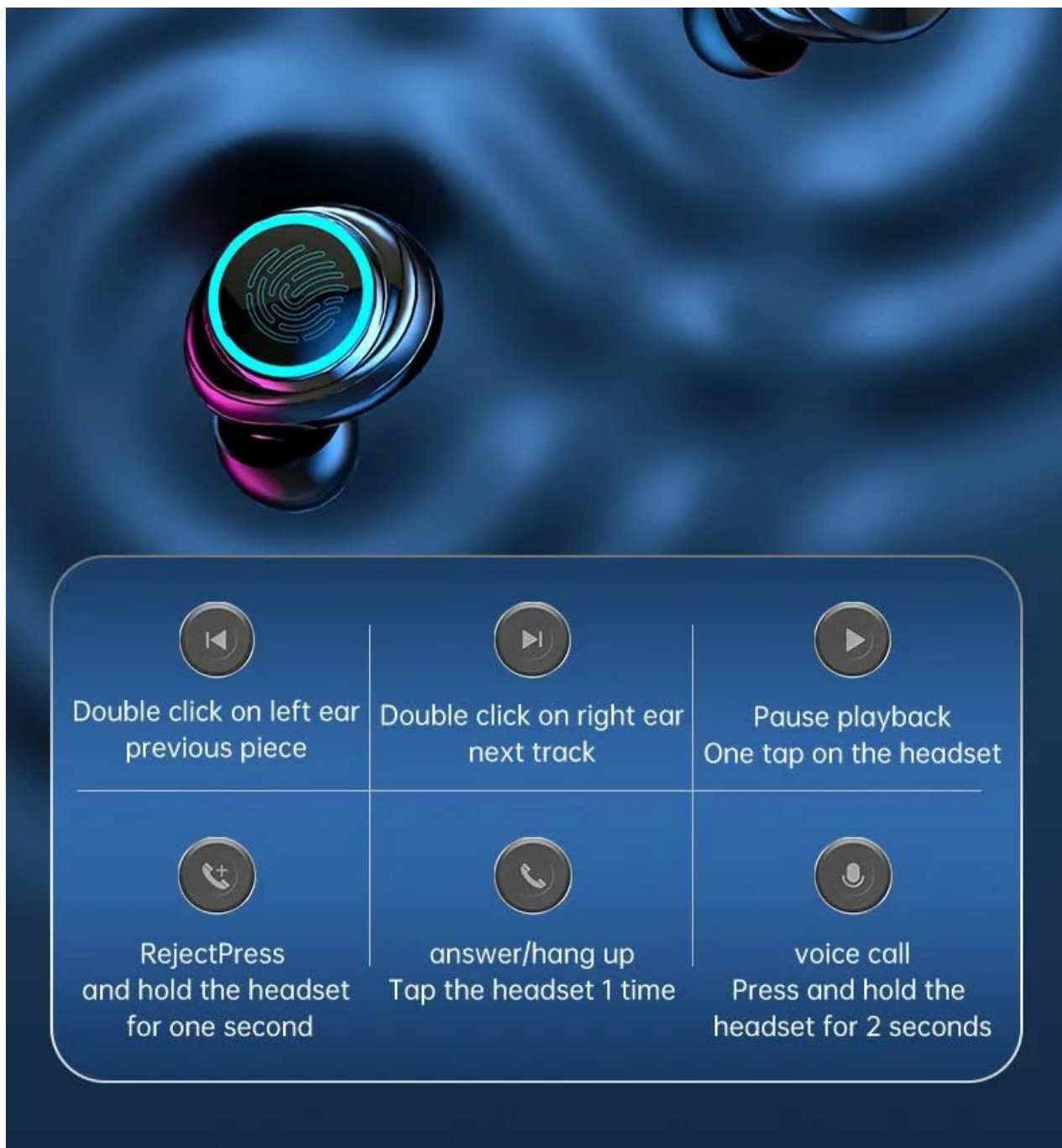

Image: A visual guide detailing the touch-sensitive areas on the earbuds and their corresponding functions for music and call management.

MAINTENANCE

Cleaning:

- Gently wipe the earbuds and charging case with a soft, dry, lint-free cloth.
- Do not use harsh chemicals, cleaning solvents, or strong detergents.
- Avoid getting moisture in any openings.

Storage:

- When not in use, store the earbuds in their charging case to protect them and keep them charged.
- Store in a cool, dry place, away from extreme temperatures and direct sunlight.

Water Resistance:

The M21 earbuds are **not water resistant**. Avoid exposure to water, rain, sweat, or any liquids to prevent damage. While some marketing materials may suggest water resistance, the product specifications indicate otherwise. Exercise caution.

TROUBLESHOOTING

Earbuds not pairing or connecting:

- Ensure both earbuds are charged.
- Make sure Bluetooth is enabled on your device.
- Place the earbuds back into the charging case, close the lid, wait a few seconds, then open the lid and try pairing again.
- If previously paired, try "forgetting" or "unpairing" the earbuds from your device's Bluetooth settings and then re-pair them.
- Ensure the earbuds are within the effective Bluetooth range (typically 10 meters or 33 feet) of your device.

Only one earbud working:

- Place both earbuds back into the charging case and close the lid.
- Open the lid and take both earbuds out simultaneously. They should automatically connect to each other.
- If the issue persists, try resetting the earbuds (refer to manufacturer's specific reset instructions if available, otherwise, try forgetting the device and re-pairing).

Poor sound quality or disconnections:

- Ensure the earbuds are fully charged.
- Move closer to your connected device to avoid interference.
- Avoid physical obstructions between the earbuds and your device.
- Clean the earbuds, especially the speaker mesh, to remove any debris.

SPECIFICATIONS

Feature	Detail
Model Name	M21
Brand	Generic
Connectivity Technology	Wireless (Bluetooth 5.2)
Wireless Communication	Bluetooth
Ear Placement	In Ear
Control Type	Touch Control
Microphone Format	Built-In
Special Features	Fast Charging, Active Noise Cancellation
Material	Plastic

Feature	Detail
Compatible Devices	Cellphones, Laptops, Tablets, Smart Speakers
Water Resistance Level	Not Water Resistant
Included Components	Protective Case

WARRANTY AND SUPPORT

Information regarding warranty coverage and customer support for the Generic M21 Bluetooth Earbuds is not available in the provided product details. Please refer to the product packaging or contact your retailer for specific warranty terms and support options.

