

EYYA 135

EYYA Handheld Car Vacuum Cleaner User Manual

Model: 135

Brand: EYYA

1. INTRODUCTION

Thank you for choosing the EYYA Handheld Car Vacuum Cleaner. This versatile 4-in-1 device is designed to provide powerful cleaning, blowing, inflation, and vacuum compression capabilities for your car, home, and office. Its compact and cordless design ensures convenience and efficiency for all your cleaning needs.

Key Features:

- **4-in-1 Functionality:** Offers modes for suction, blowing, inflation, and vacuum compression.
- **Powerful Suction:** Equipped with an 86,000 RPM motor providing up to 15000PA suction power.
- **Dual Filtration System:** Features a steel filter for large particles and a washable HEPA filter for fine dust.
- **Cordless & Portable:** Lightweight (0.88LB) and compact for easy storage and use anywhere.
- **Type-C Fast Charging:** Built-in 4000mAh battery with 2.5-hour charging time and 25-minute runtime.
- **Integrated LED Light:** Illuminates dark areas for thorough cleaning.



The EYYA Handheld Car Vacuum Cleaner, showcasing its compact design and multiple attachments for various functions.

2. WHAT'S INCLUDED

Please check the package contents to ensure all items are present:

- Vacuum Cleaner Unit
- Inflatable & Bleed Nozzle (2 Sizes)
- Suction & Blow Nozzles Accessory Kit (includes floor brush, nozzle brush, crevice tool)
- User Manual
- Type-C Charging Cable



All components included with the EYYA Handheld Car Vacuum Cleaner.

3. SETUP

3.1 Initial Charging

Before first use, fully charge the vacuum cleaner. The built-in 4000mAh battery requires approximately 2.5 hours for a full charge.

- Connect the provided Type-C charging cable to the vacuum cleaner's charging port.
- Connect the other end of the cable to a USB power source (e.g., computer USB port, mobile power bank, car charger, or a 5V/2A adapter).
- The indicator light will be **red** during charging and turn **green** when fully charged.
- **Important:** Do not use a high power adapter (e.g., fast charging adapters for phones) to avoid damaging the vacuum cleaner motor. Use a standard 5V/2A adapter.

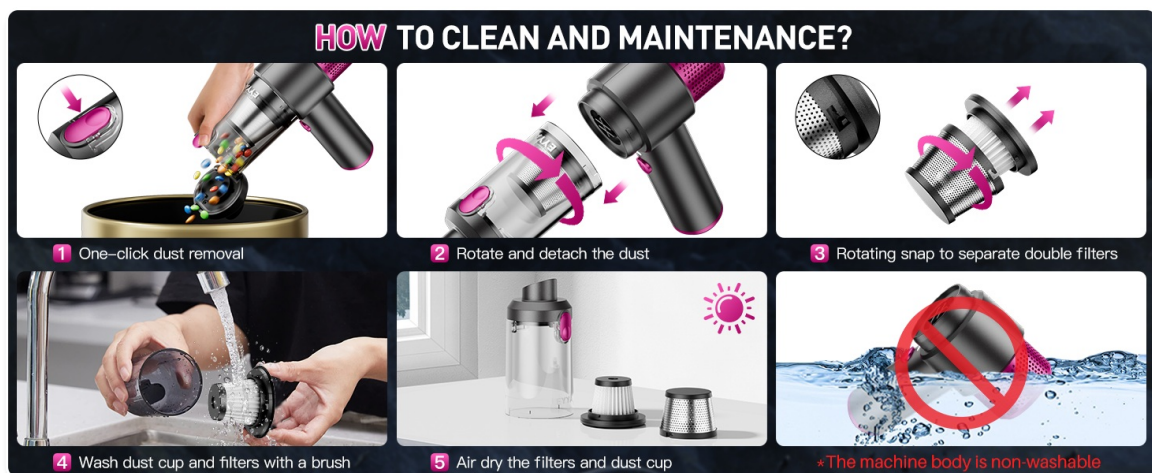

Charging the EYYA Handheld Car Vacuum Cleaner with a Type-C cable.

3.2 Attaching Accessories

Select the appropriate nozzle or brush for your desired task and firmly attach it to the vacuum's intake or exhaust port, depending on the mode.

4. OPERATING MODES

The EYYA Handheld Car Vacuum Cleaner offers four distinct modes for various applications:

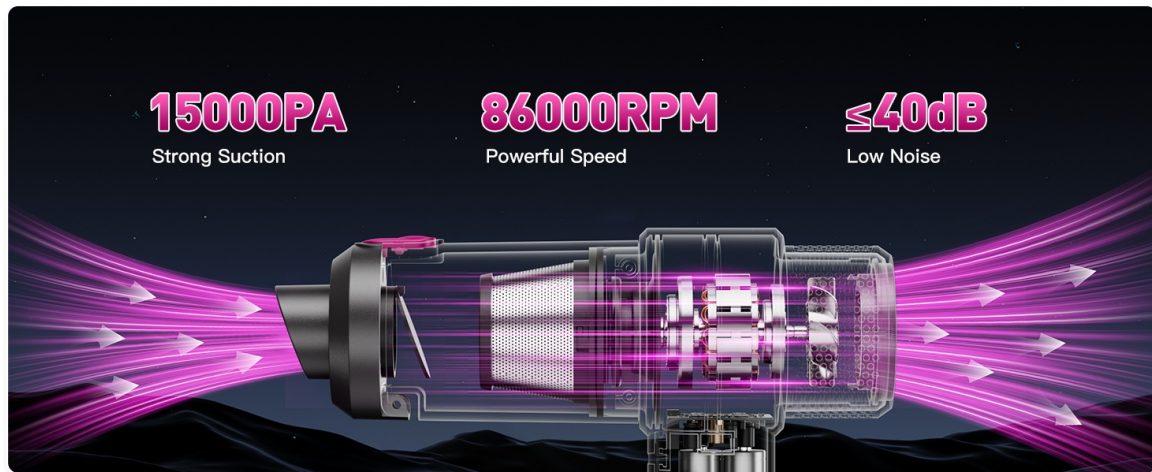

Overview of the 4-in-1 multi-purpose vacuum cleaner modes.

4.1 Vacuum Cleaner Mode (Suction)

This mode is used for traditional vacuuming to pick up dust, crumbs, pet hair, and other debris. Attach the desired suction nozzle (e.g., crevice tool, floor brush, or nozzle brush) to the intake port.

- Press the power button to turn on the vacuum.
- Guide the nozzle over the surface to be cleaned. The integrated LED light will illuminate dark areas.
- Ideal for car interiors, upholstery, carpets, and hard-to-reach spots.



Using the vacuum cleaner for various suction tasks.

4.2 Air Duster Mode (Blowing)

Transform your vacuum into a powerful air duster to blow away dust from keyboards, electronics, and narrow crevices. Attach a blow nozzle to the exhaust port.

- Attach the appropriate blow nozzle to the rear exhaust port of the vacuum.
- Press the power button to activate the blowing function.
- Direct the airflow to dislodge dust and debris from hard-to-reach areas.



Utilizing the air duster and blow nozzle functions.

4.3 Air Inflation Mode

Use this mode to quickly inflate small items like swimming rings, air mattresses, or balloons. Attach an inflatable nozzle to the exhaust port.

- Attach one of the inflatable nozzles to the rear exhaust port.
- Insert the nozzle into the inflation valve of the item.
- Press the power button to begin inflation.

4.4 Vacuum Compression Mode

This mode is ideal for vacuum-sealing storage bags to save space. Attach a bleed nozzle to the exhaust port.

- Attach one of the bleed nozzles to the rear exhaust port.
- Place the nozzle over the air valve of a vacuum compression bag.
- Press the power button to remove air from the bag.



Using the inflatable and bleed nozzles for various tasks.

5. MAINTENANCE

Regular maintenance ensures optimal performance and extends the lifespan of your EYYA Handheld

Car Vacuum Cleaner.

5.1 One-Click Dust Removal

To empty the dust cup:

- Ensure the vacuum is turned off.
- Press the one-click dusting button to release the dust cup contents into a trash bin.

5.2 Dual Filtration System Cleaning

The vacuum features a dual filtration system with a steel filter and a washable HEPA filter. Clean them regularly to prevent suction loss and clogging.

- Rotate and detach the dust cup from the main unit.
- Rotate the snap to separate the double filters (steel filter and HEPA filter).
- Wash the dust cup and both filters with water and a brush.
- Allow the filters and dust cup to air dry completely before reassembling. Do not expose to direct sunlight for prolonged periods.
- **Note:** The main machine body is non-washable. Do not immerse it in water.

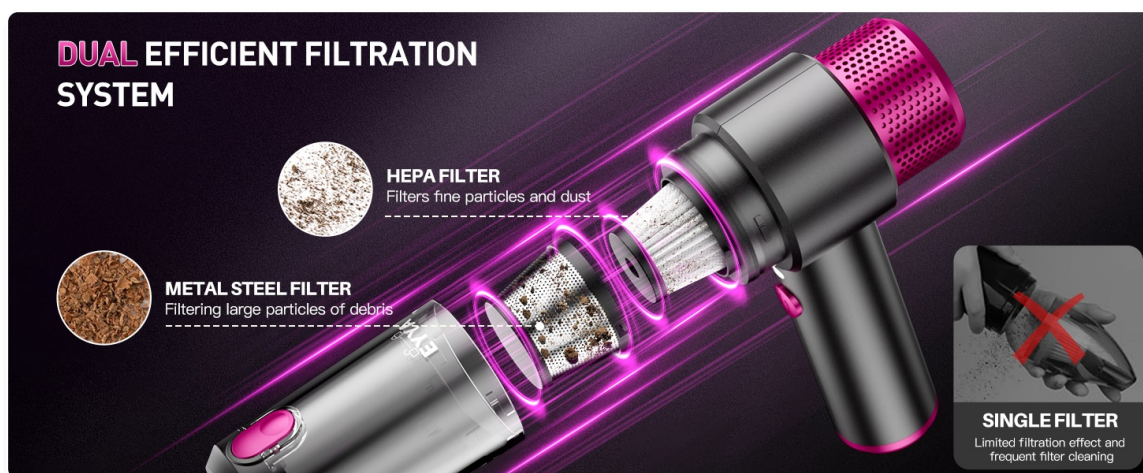

Step-by-step guide for cleaning and maintaining your vacuum cleaner.

6. TROUBLESHOOTING

If you encounter any issues with your EYYA Handheld Car Vacuum Cleaner, please refer to the following common problems and solutions:

Problem	Possible Cause	Solution
Reduced Suction Power	Clogged filters or full dust cup.	Empty the dust cup and clean both the steel and HEPA filters. Ensure they are completely dry before reassembly.
Vacuum Not Turning On	Battery is low or depleted.	Charge the vacuum cleaner fully using the provided Type-C cable and a 5V/2A adapter.

Problem	Possible Cause	Solution
Short Battery Life	Battery not fully charged or aging battery.	Ensure the vacuum is fully charged (green indicator light). If the issue persists after multiple full charges, the battery may be degrading.
Unusual Noise During Operation	Obstruction in the nozzle or motor.	Turn off the vacuum and check for any blockages in the nozzle or dust cup area. Remove any foreign objects carefully.

If the problem persists after trying these solutions, please contact EYYA customer support for further assistance.

7. SPECIFICATIONS

Feature	Detail
Brand	EYYA
Model Name	135
Special Feature	Portable, LED Light, Cordless, 15000PA Strong Suction, Dual Filtration System
Filter Type	Steel Filter, HEPA Filter
Is Cordless?	Yes
Capacity	100 Milliliters
Wattage	120 watts
Runtime	25 minutes
Charging Time	2.5 Hours
Battery Description	4000mAh Lithium Ion
Noise Level	40 dB
Product Dimensions	7.99"L x 2.76"W x 8.35"H
Item Weight	14.1 ounces
Connectivity Technology	USB Type-C

8. WARRANTY AND SUPPORT

For warranty information and customer support, please contact EYYA Direct, the seller of this product. Keep your purchase receipt as proof of purchase.

Seller: EYYA Direct

For any inquiries or technical assistance, please refer to the contact information provided with your purchase or visit the official EYYA brand store online.