

## AEROPRO A610

# AEROPRO A610 LVLP Spray Gun Kit Instruction Manual

Model: A610

## 1. INTRODUCTION

---

This manual provides instructions for the safe and effective use of the AEROPRO A610 LVLP Spray Gun Kit. This kit includes an A610 LVLP spray gun, a water oil separator, and 100 paint strainers. Please read this manual thoroughly before operation and retain it for future reference.

## 2. SAFETY INFORMATION

---

Always prioritize safety when operating painting equipment. Failure to follow safety guidelines can result in injury or damage to property.

- Always wear appropriate personal protective equipment, including protective clothing, gloves, and eye/face protection.
- Avoid direct contact with skin and eyes.
- Do not ingest or inhale paint or cleaning solvents.
- Use the spray gun in a well-ventilated area to prevent accumulation of hazardous fumes.
- Before each use, inspect the spray gun and all components for any damage or leaks. Do not operate if damage is present.
- Dispose of paint, solvents, and used containers in accordance with local environmental regulations.

## 3. PACKAGE CONTENTS

---

Verify that all items are present in your kit:

- 1 x AEROPRO A610 Air Spray Gun
- 1 x 1.3mm Air Cap, Nozzle, and Needle Set
- 1 x 1.5mm Air Cap, Nozzle, and Needle Set
- 1 x 1.7mm Air Cap, Nozzle, and Needle Set

- 1 x Pressure Regulator
- 1 x Water Oil Separator
- 100 x 190 Micron Paint Strainers
- Cleaning and Disassembly Tools

## 4. PRODUCT SPECIFICATIONS

---

### AEROPRO A610 LVLP Spray Gun

Specification	Value
Nozzle Size Range	1.3mm, 1.5mm, 1.7mm
Operating Pressure	2.0 - 3.5 bar (29 - 50 PSI)
Pattern Width	180 - 280 mm
Air Consumption	3.0 - 3.9 CFM
Paint Capacity (Cup)	600 cc
Gun Body Surface	Teflon (wear-resistant, easy to clean)
Nozzle & Needle Material	Stainless Steel
Transfer Efficiency	65% (High Transfer Efficiency)

### Water Oil Separator

Specification	Value
Inlet Connection	1/4" NPT Male
Outlet Connection	1/4" NPT Female
Drain Valve Type	Thimble Type

## 5. SETUP

---

Follow these steps to prepare your spray gun kit for use:

1. **Assemble the Spray Gun:** Select the desired nozzle size (1.3mm, 1.5mm, or 1.7mm) and ensure the corresponding air cap, nozzle, and needle are correctly installed on the spray gun.
2. **Attach Water Oil Separator:** Connect the 1/4" NPT Male inlet of the water oil separator to your air compressor hose. Connect the 1/4" NPT Female outlet to the air inlet of the spray gun. Ensure all connections are tight to prevent air leaks.

Fit for all industrial work: Spray Paint Tool, Airline Automotive Refinishing.....



The water oil separator attached to a spray gun, demonstrating its integration into the air line with a pressure gauge.



Inlet :1/4" NPT Male

Outlet :1/4" NPT Female

Close-up of the water oil separator showing its 1/4" NPT Male inlet and 1/4" NPT Female outlet connections.

3. **Install Pressure Regulator:** If not already integrated, attach the pressure regulator between the air

hose and the spray gun or after the water oil separator.

4. **Prepare Paint:** Strain your paint using the provided 190 micron paint strainers to remove any impurities that could clog the spray gun. Pour the strained paint into the spray gun's cup.



**1.3/1.5/1.7MM  
STANDARD NOZZLE**

- 360° Adjustable Precise Machined Air Cap Set
- Stainless steel nozzle and needle



AEROPRO A610 Spray Gun with 1.3/1.5/1.7mm standard nozzle options. Features a 360° adjustable precise machined air cap set and stainless steel nozzle and needle.

## 6. OPERATING INSTRUCTIONS

Achieve optimal results by following these operating guidelines:

1. **Connect Air Supply:** Connect your air compressor to the water oil separator. Set the compressor pressure to the recommended operating pressure of 2.0-3.5 bar (29-50 PSI) using the pressure regulator.
2. **Adjust Spray Pattern:** The AEROPRO A610 features three adjustable valve knobs.
  - **Control the Spray Width:** Adjust the top knob to change the width of the spray pattern (180-280mm).
  - **Control the Paint Flow:** Adjust the middle knob to regulate the amount of paint being sprayed.
  - **Control the Air Volume:** Adjust the bottom knob to fine-tune the air volume for optimal atomization.

# 3 ADJUSTABLE VALVE KNOBS

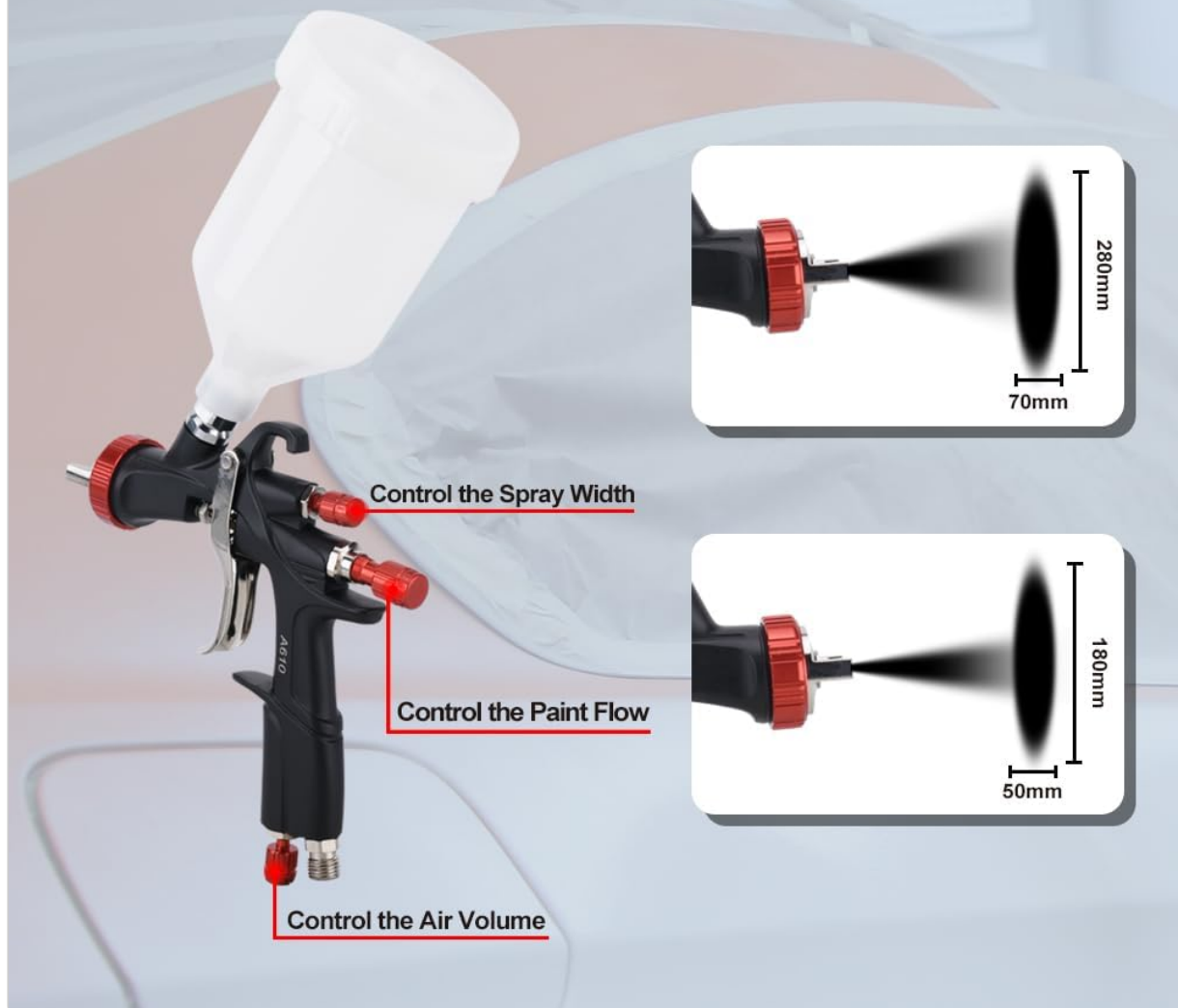

Illustration of the AEROPRO A610 Spray Gun's three adjustable valve knobs for controlling spray width, paint flow, and air volume.

- 3. Test Spray:** Before painting your actual workpiece, perform a test spray on a scrap piece of material to check the spray pattern, atomization, and paint flow. Adjust the knobs as needed.
- 4. Apply Paint:** Hold the spray gun perpendicular to the surface, maintaining a consistent distance. Use smooth, overlapping passes to ensure even coverage. The LVLP technology provides high transfer efficiency for a smooth finish with less paint.

# LVLP Spary Gun

- LOW VOLUME LOW PRESSURE
- 65% HIGH TRANSFER EFFCIENCY
  - 2X Higher Than Traditional Air Spray Gun
  - Get a Smooth Finish with Less Paint



AEROPRO A610 LVLP Spray Gun in operation, demonstrating low volume low pressure technology for high transfer efficiency and a smooth finish.



**Teflon Gun Body Surface  
Wear-resistant and Easy to Clean**

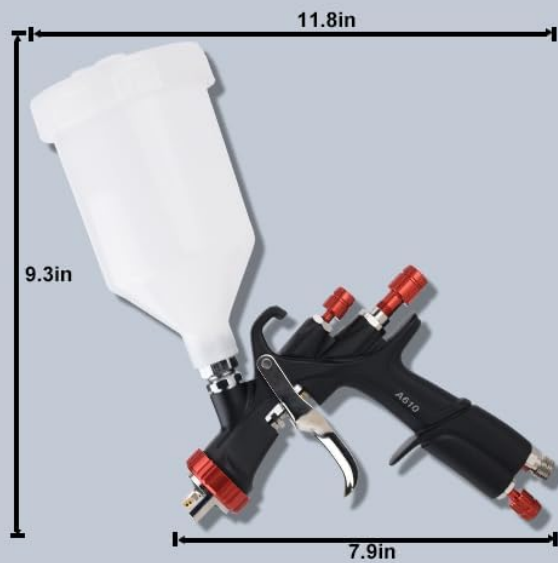

Close-up view of the spray gun demonstrating fine atomization for a smooth finish.

## 7. MAINTENANCE

---

Proper maintenance ensures the longevity and performance of your spray gun kit.

1. **Cleaning the Spray Gun:** Immediately after each use, empty any remaining paint from the cup. Fill the cup with an appropriate cleaning solvent (e.g., paint thinner for oil-based paints, water for water-based paints) and spray it through the gun until clear solvent emerges. Disassemble the air cap, nozzle, and needle for thorough cleaning with the provided tools. Clean the paint cup.
2. **Cleaning the Water Oil Separator:** Regularly check the water oil separator for accumulated moisture and oil. Use the thimble-type drain valve to eject built-up waste. Press the thimble to release the collected liquid.

## Thimble type drain valve, quick to eject built-up waster



Detailed view of the thimble-type drain valve on the water oil separator, designed for quick ejection of built-up waste.

3. **Paint Strainers:** Dispose of used paint strainers after each use. Do not reuse them as they are designed for single use to ensure optimal paint filtration.
4. **Storage:** Store the clean and dry spray gun kit in a safe, dry place away from extreme temperatures and direct sunlight.

## 8. TROUBLESHOOTING

Refer to this section for common issues and their solutions:

Problem	Possible Cause	Solution
Uneven spray pattern or spitting	Clogged nozzle or air cap; incorrect air pressure; paint too thick.	Clean nozzle and air cap thoroughly. Adjust air pressure to recommended range. Thin paint according to manufacturer's instructions.
No paint flow	Clogged fluid passage; needle not retracting; empty paint cup.	Clean fluid passage. Check needle movement. Refill paint cup.

<b>Problem</b>	<b>Possible Cause</b>	<b>Solution</b>
Excessive overspray	Too much air pressure; gun held too far from surface.	Reduce air pressure. Hold gun closer to the surface (maintain consistent distance).
Paint runs or sags	Too much paint flow; gun held too close to surface; paint too thin.	Reduce paint flow. Hold gun further from the surface. Thicken paint if necessary.
Water in paint finish	Water oil separator is full or not functioning.	Drain the water oil separator. Ensure it is properly installed and functioning.

## **9. WARRANTY AND SUPPORT**

---

For warranty information or technical support, please refer to the product packaging or contact AEROPRO customer service directly. Keep your purchase receipt as proof of purchase.