

USonline911 M2 Plus

USonline911 M2 Plus 4K WiFi HDMI Wireless Display Dongle Adapter User Manual

Model: M2 Plus

1. INTRODUCTION

The USonline911 M2 Plus is a wireless display dongle designed to cast content from your smartphone or tablet to a larger screen, such as an HDTV, monitor, or projector, via an HDMI connection. It supports various wireless display protocols including Miracast, DLNA, and AirPlay, enabling seamless streaming of videos, audio, photos, office files, and web content.

This device features a compact design for portability and operates without the need for additional apps or drivers, simplifying the setup process.

2. PACKAGE CONTENTS

Verify that all items are present in the package:

- 1 x Wireless WiFi Display Dongle (M2 Plus)
- 1 x USB Power Cable with WiFi Module



Image: The USonline911 M2 Plus wireless display dongle and its accompanying USB power cable with integrated WiFi module.

3. PRODUCT OVERVIEW

The M2 Plus dongle consists of a main unit with an HDMI connector and a separate USB power cable that integrates the WiFi module. The HDMI connector plugs directly into your display device, while the USB cable provides power and handles wireless communication.



Image: Close-up view of the M2 Plus dongle, highlighting the HDMI plug and the USB power cable with its WiFi component.

4. SPECIFICATIONS

Feature	Description
Model	M2 Plus
Color	Black
Material	ABS + PC
Power Supply	5V / 1A (via Micro USB 2.0)
Audio/Video Outputs	HDMI 1.2 (supports 1080P video output and high-quality sound)
Resolution Support	Up to 4K (output is 1080p)
Wireless Connectivity	Built-in 2.4GHz WiFi module (8188ETV)
Wireless Display Protocols	Miracast, DLNA, AirPlay

Supported Media Formats	Video: AVI, DIVX, MKV, TS, DAT, MPG, MPRG, MOV, MP4, RM, RMVB, WMV Audio: MP1, MP2, MP3, WMA, OGG, ADPCM-WAV, PCM-WAV, AAC Image: Photo Document: Office file, Website
Storage Capacity	128 MB (Internal Flash SLC)
Item Weight	2.08 ounces
Package Dimensions	6.5 x 6.22 x 1.3 inches

5. SETUP GUIDE

Follow these steps for initial setup:

1. **Connect the Dongle:** Plug the M2 Plus dongle's HDMI connector into an available HDMI port on your TV, monitor, or projector.
2. **Provide Power:** Connect the USB power cable to the Micro USB port on the dongle. Plug the other end of the USB cable into a 5V/1A USB power source (e.g., a USB port on your TV or a USB wall adapter). Ensure the power source provides sufficient power for stable operation.
3. **Select HDMI Input:** Turn on your display device and use its remote control to select the correct HDMI input source that the dongle is connected to.
4. **Dongle Interface:** Once powered on, the dongle will display its main interface on your screen, showing connection instructions and the WiFi network name (SSID) and password.

Wireless display

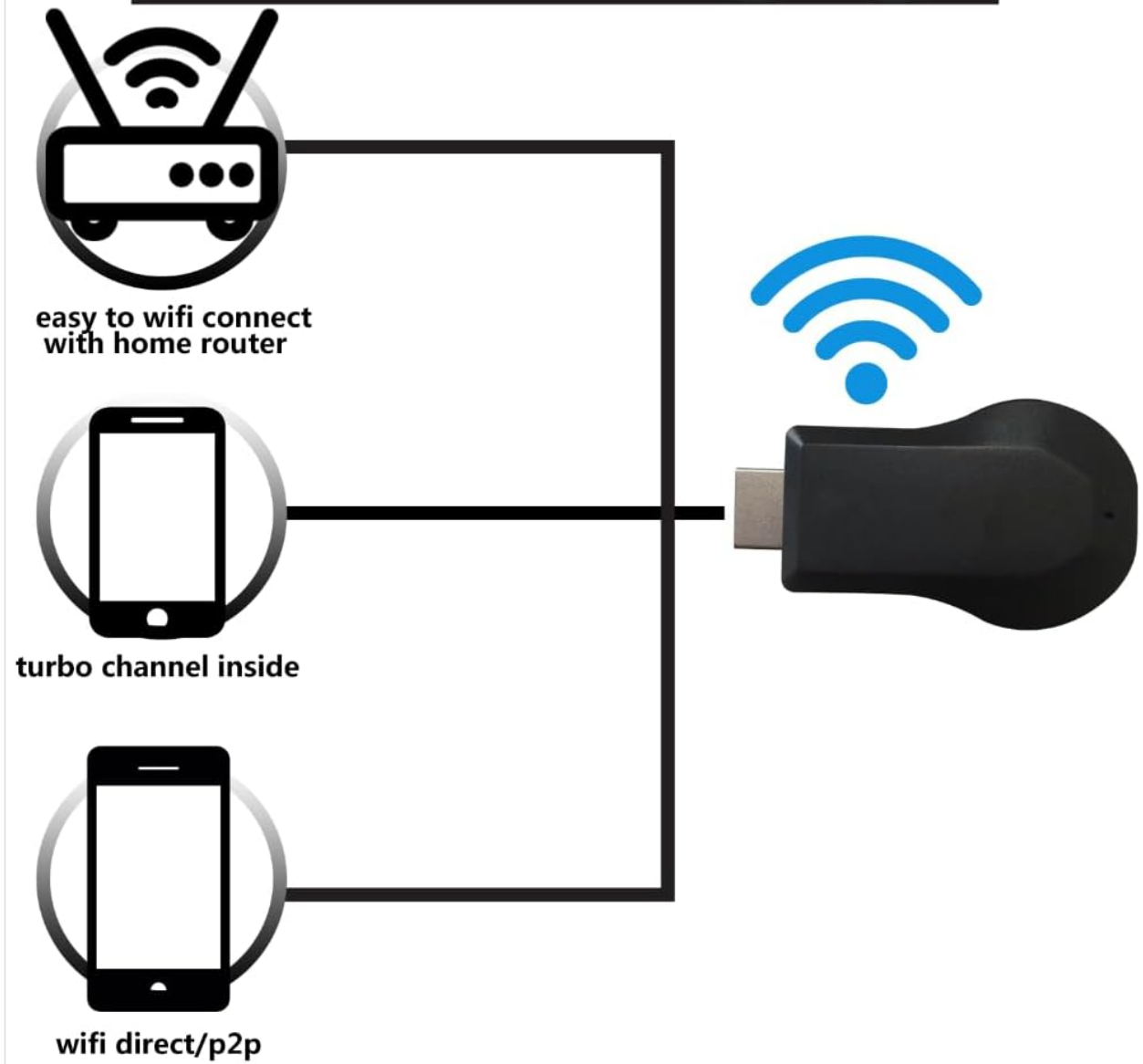

Image: A diagram showing the connection flow from a home router to a smartphone, then wirelessly to the dongle, which is connected to a TV.

6. OPERATING INSTRUCTIONS

The M2 Plus supports Miracast, AirPlay, and DLNA protocols. The specific connection method depends on your source device (smartphone, tablet, or PC).

6.1. Connecting via WiFi (for AirPlay/DLNA)

1. On your smartphone or tablet, go to WiFi settings.
2. Find and connect to the WiFi network (SSID) displayed on the dongle's screen. The password will also be shown on the screen.
3. Once connected, open a web browser on your device and enter the IP address displayed on the dongle's screen (e.g., 192.168.49.1) to access the dongle's settings page.
4. On the settings page, select "Internet" or "WiFi Setup" to connect the dongle to your home WiFi router. This allows the dongle to access the internet for streaming content.
5. After the dongle is connected to your home WiFi, your device can now use AirPlay (iOS) or DLNA

(Android/Windows) to cast content.

6.2. Connecting via Miracast (for Android/Windows)

For Android devices and Windows PCs that support Miracast (also known as Wireless Display, Screen Mirroring, Smart View, etc.):

1. Ensure the dongle is powered on and displaying its main interface.
2. On your Android device, navigate to the screen mirroring function (e.g., "Smart View," "Screen Cast," "Wireless Display," "MirrorShare"). The exact name varies by device manufacturer.
3. Select the M2 Plus dongle from the list of available devices.
4. Your device's screen should now be mirrored on the connected display.

6.3. Connecting via AirPlay (for iOS/macOS)

For Apple iOS devices (iPhone, iPad) and macOS computers:

1. Ensure the dongle is powered on and displaying its main interface.
2. Connect your iOS device to the dongle's WiFi network (SSID) as described in section 6.1, or ensure both the dongle and your iOS device are connected to the same home WiFi network.
3. On your iOS device, open the Control Center (swipe down from the top-right corner on newer iPhones, or swipe up from the bottom on older models).
4. Tap "Screen Mirroring" or "AirPlay Mirroring."
5. Select the M2 Plus dongle from the list of available devices.
6. Your iOS device's screen should now be mirrored on the connected display.



Image: The wireless display dongle connected to a television, displaying content, with icons representing a monitor, WiFi, and cloud services.

7. MAINTENANCE

- Keep the device in a dry environment and away from direct sunlight.
- Avoid exposing the device to extreme temperatures or humidity.
- Do not disassemble the device. Unauthorized repairs will void any potential warranty.
- Clean the device with a soft, dry cloth. Do not use liquid cleaners or aerosols.
- Ensure proper ventilation around the dongle when in use to prevent overheating.

8. TROUBLESHOOTING

- **No Display on TV:**
 - Ensure the dongle is securely plugged into the HDMI port.
 - Verify that the USB power cable is connected to a stable 5V/1A power source.
 - Check that your TV is set to the correct HDMI input source.
 - Try a different HDMI port on your TV.

- **Cannot Connect to Dongle's WiFi:**

- Ensure the dongle is powered on and its main interface is visible on the TV.
- Double-check the SSID and password displayed on the TV screen.
- Restart both your source device and the dongle (by unplugging and replugging the USB power).

- **Screen Mirroring is Laggy or Disconnects:**

- Ensure the dongle is not too far from your source device or WiFi router. Obstructions can affect signal quality.
- Reduce interference from other 2.4GHz devices.
- If streaming online content, ensure your home WiFi network has a strong and stable internet connection.
- Some content (e.g., DRM-protected videos) may not be supported for mirroring.

- **No Audio:**

- Check the volume settings on both your source device and the TV.
- Ensure the HDMI cable connection is secure.

9. WARRANTY AND SUPPORT

For warranty information or technical support, please refer to the documentation provided at the time of purchase or contact USonline911 customer service. Keep your purchase receipt as proof of purchase.