

## Prechen HD-24

# Prechen 24 Inch Touchscreen Monitor User Manual

Brand: Prechen | Model: HD-24

## 1. INTRODUCTION

Thank you for choosing the Prechen 24 Inch Touchscreen Monitor. This monitor is designed to provide a high-quality visual and interactive experience for various applications, including gaming, business, and multimedia. Featuring a Full HD 1080P IPS display with a 75Hz refresh rate, responsive multi-touch capabilities, and versatile connectivity options, this monitor is built for performance and convenience.



Figure 1: Prechen 24 Inch Touchscreen Monitor

## 2. WHAT'S IN THE BOX

---

Please check the contents of your package to ensure all items are present:

- Prechen 24 Inch Touchscreen Monitor
- Adjustable Monitor Stand
- HDMI Cable
- USB Cable (for Touch Functionality)
- Power Adapter
- Screws and Spacers (for stand assembly)
- User Manual (this document)



Figure 2: Included accessories and monitor

## 3. SETUP

### 3.1 Physical Assembly

1. Carefully remove the monitor and stand components from the packaging.
2. Attach the monitor arm to the back of the monitor using the provided screws. Ensure it is securely fastened.
3. Connect the base of the stand to the monitor arm. The stand is designed for stability and adjustability.
4. Place the assembled monitor on a stable, flat surface.

# VESA 75X75MM



Figure 3: VESA Mount and Tilt Adjustment

## 3.2 Connections

The monitor offers multiple connectivity options:

- **HDMI Port:** Connect the provided HDMI cable from your computer's HDMI output to the monitor's HDMI input for video and audio.
- **VGA Port:** Connect a VGA cable from your computer's VGA output to the monitor's VGA input for video.
- **USB Port:** For touchscreen functionality, connect the provided USB cable from your computer's USB port to the monitor's USB input. This is essential for touch input to work.
- **DC Power Port:** Connect the power adapter to this port and then to a power outlet.
- **Audio Port:** An audio input port is available for connecting external audio sources if needed, though the monitor has built-in speakers.



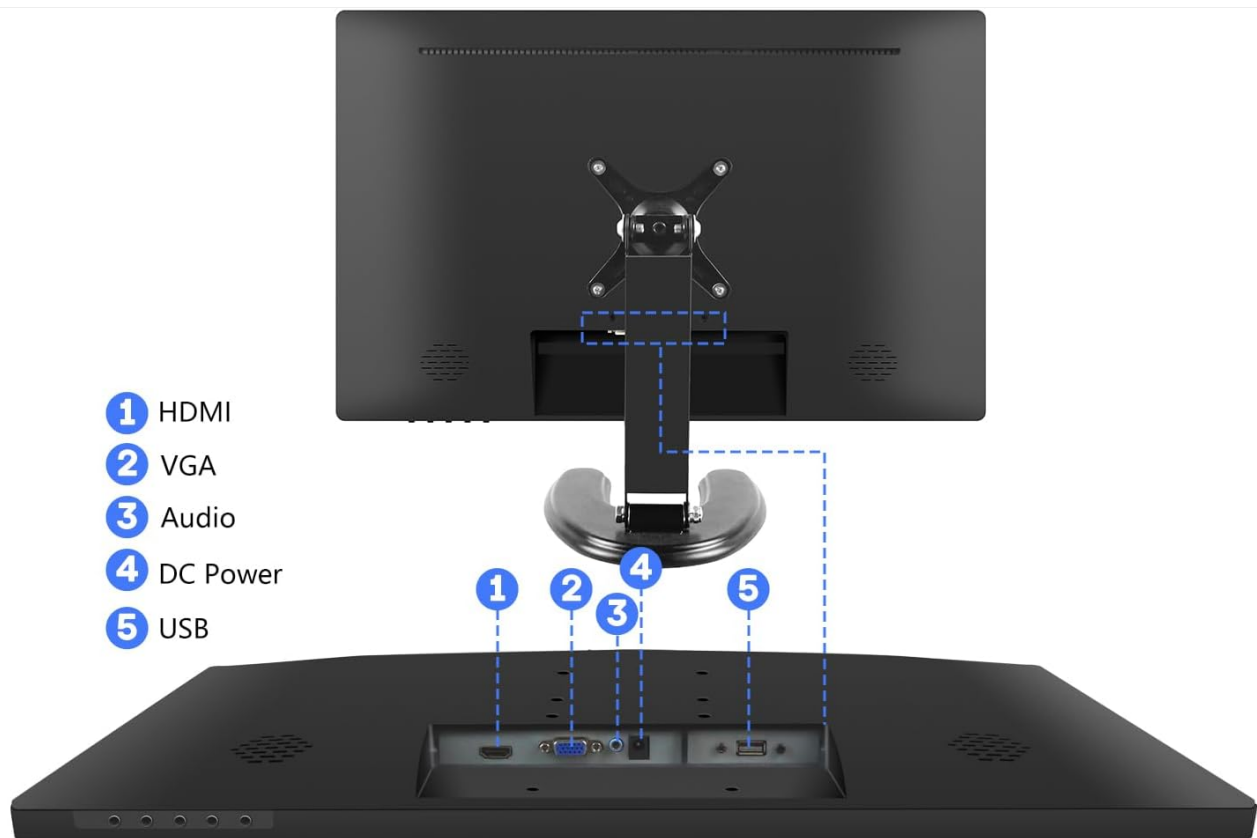

## FLEXIBLE CONNECTION



Notebook



PS4/5



PC



XBOX



CCTV



Camera

Figure 4: Monitor Connectivity Ports

### 3.3 Power On

Once all necessary cables are connected, press the power button located on the side or bottom of the monitor to turn it on. The monitor will automatically detect the input signal.

## 4. OPERATING

### 4.1 Display Features

- **Full HD 1080P Resolution:** Enjoy crisp, clear visuals with 1920x1080 resolution.
- **IPS Panel:** Provides a 178° ultra-wide viewing angle, ensuring consistent color and image quality from almost any perspective.
- **75Hz Refresh Rate:** Delivers smooth visuals, reducing motion blur for an enhanced viewing and gaming experience.
- **Eye Protection:** Features low-blue light and flicker-free technology to reduce eye strain during prolonged use.

# ULTRA WIDE VIEW ANGLE

**1080P**

Full HD  
1920x1080P

**IPS**

IPS Panel



1000:1  
Contrast Ratio



Figure 5: Ultra Wide View Angle

# PROTECT YOUR EYES

The low blue light and flicker-free technology effectivity reduce harmful blue light and irritating screen flicker



Low-blue Light



Flicker-free



Figure 6: Eye Protection Features

## 4.2 Touchscreen Functionality

The 10-point multi-touch screen allows for intuitive interaction with your content. Ensure the USB cable is connected to enable touch functionality. The touchscreen supports various gestures for navigation and control.





Figure 7: 10-Point Multi-Touch Interaction

### 4.3 Adjustable Stand

The monitor's stand allows for flexible positioning. You can tilt the screen from  $-5^{\circ}$  to  $180^{\circ}$  to find your optimal viewing angle. The VESA mount compatibility (75x75mm) also provides options for wall mounting or alternative desk stands.



# VESA 75X75MM



Figure 8: Stand Adjustments and VESA Compatibility

## 4.4 On-Screen Display (OSD) Menu

Access the OSD menu using the buttons located on the monitor (Power, Menu, Plus, Minus, Auto). This menu allows you to adjust various display settings:

- **Brightness & Contrast:** Adjust the overall luminance and contrast levels.
- **Color Settings:** Fine-tune color temperature, saturation, and hue.
- **Input Select:** Manually switch between HDMI and VGA inputs.
- **Volume:** Control the audio output level of the built-in speakers.
- **HDR:** Enable or disable High Dynamic Range for enhanced visual fidelity.

For a visual demonstration of the monitor's features, including OSD menu navigation, please refer to the video below:

Your browser does not support the video tag.

*Video 1: Prechen 23.8 Inch Touchscreen Monitor Overview (Seller)*

This video provides a brief overview of the Prechen 23.8 Inch Touchscreen Monitor, showcasing its design and basic functionality.

## 4.5 Audio

The monitor includes dual built-in speakers, providing convenient audio output without the need for external speakers. Adjust the volume through the OSD menu or your connected device.

# 3D VIVID SURROUND SOUND



Figure 9: Built-in Speakers for Vivid Surround Sound

## 5. MAINTENANCE

---

- **Cleaning the Screen:** Use a soft, lint-free cloth slightly dampened with water or a non-abrasive screen cleaner. Avoid using alcohol, ammonia, or abrasive cleaners.
- **Cleaning the Casing:** Wipe the monitor casing with a soft, dry cloth.
- **Storage:** If storing the monitor for an extended period, disconnect all cables and store it in a cool, dry place, preferably in its original packaging.
- **Avoid Direct Sunlight:** Do not expose the monitor to direct sunlight or excessive heat, as this can damage the display.

## 6. TROUBLESHOOTING

If you encounter issues with your Prechen monitor, please refer to the following common troubleshooting steps:

Problem	Possible Cause	Solution
No image on screen	Power cable disconnected; Video cable disconnected; Incorrect input selected.	Ensure power cable is securely connected and power outlet is active. Check HDMI/VGA cable connection. Use OSD menu to select correct input source.
Touchscreen not responding	USB cable for touch functionality is disconnected or faulty.	Ensure the USB cable is securely connected from the monitor to your computer. Try a different USB port on your computer.
No audio from speakers	Volume too low; Muted; Incorrect audio output selected on computer.	Increase volume via OSD menu or computer's sound settings. Ensure monitor is not muted. Select the monitor as the default audio output device on your computer.
Image is blurry or distorted	Incorrect resolution; Loose video cable.	Set your computer's display resolution to 1920x1080. Ensure video cables are tightly connected.

## 7. SPECIFICATIONS

Feature	Detail
Screen Size	23.8 inches (24 inch class)
Resolution	1920 x 1080 (Full HD 1080p)
Panel Type	IPS
Refresh Rate	75Hz
Touchscreen	10-Point Multi-Touch
Viewing Angle	178° (Horizontal/Vertical)
Connectivity	HDMI, VGA, USB (for touch), DC Power, Audio
VESA Compatibility	75x75mm
Built-in Speakers	Yes
Product Dimensions	1.18 x 13.77 x 21.65 inches
Item Weight	11.62 pounds
Model Number	HD-24



# PRODUCT SIZE



Figure 10: Product Dimensions

## 8. WARRANTY AND SUPPORT

For detailed warranty information and customer support, please refer to the product's official Amazon listing page or contact Prechen customer service directly. Keep your purchase receipt for warranty claims. You can also find the official User Manual PDF [here](#).

### Related Documents - HD-24

	<p><a href="#">Prechen 24 Inch Touchscreen Monitor User Manual   HD-24</a></p> <p>Comprehensive user manual for the Prechen 24 Inch Touchscreen Monitor (HD-24), covering setup, connections, features, troubleshooting, and product guarantee.</p>
---	---



Detailed instructions for installing and removing the VESA holder on KOORUI monitors, including important safety precautions and mounting specifications.

•

Comprehensive user manual for the Skyworth 27B1H LED monitor, covering safety instructions, installation, operation, troubleshooting, cleaning, specifications, and FCC compliance.

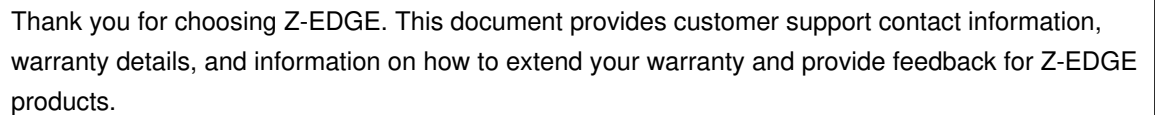

KOORUI E2411H Monitor User Manual: A comprehensive guide to setting up, operating, and troubleshooting your KOORUI 24-inch Full HD IPS monitor (model E2411H). Learn about product specifications, safety, installation, OSD functions, and common issues. Features 120Hz refresh rate and 99% sRGB color gamut.