



[Manuals.plus](#) /

> [AppLoki](#) /

> AppLoki Fingerprint Smart Lock User Manual

## AppLoki S350BBL-F-2

# AppLoki Fingerprint Smart Lock User Manual

Model: S350BBL-F-2

## 1. INTRODUCTION

---

Thank you for choosing the AppLoki Fingerprint Smart Lock. This manual provides detailed instructions for the installation, operation, and maintenance of your new smart lock. Please read this manual thoroughly before installation and keep it for future reference.



Image: The AppLoki Fingerprint Smart Lock, featuring both the sleek black exterior unit with a keypad and fingerprint sensor, and the interior unit with a thumb turn. Two Mifare 1 fobs are also visible, indicating multiple access options.

## 2. PRODUCT FEATURES

---

- **Multiple Unlocking Methods:** Supports unlocking via Smartphone APP, Fingerprint, IC Card (Fob), Passcode, and Mechanical Key.

- **Enhanced Security:** Features anti-peeping password protection and an auto-lock function (customizable from 5-900 seconds).
- **Double Alarm System:** Alerts for 5 failed password attempts and low battery status.
- **Durability:** Weatherproof design ensures reliable operation in various conditions.
- **Emergency Power:** Equipped with an emergency power supply port for convenience.
- **Long Battery Life:** Designed for approximately 365 days of battery life.
- **Capacity:** Supports over 150 passwords and unlimited eKey users.
- **Voice Control:** Voice control capability (requires a separate gateway).



Image: An illustration highlighting the keyless convenience features of the AppLoki Smart Lock, such as 365 days battery life, 150+ passwords, unlimited eKey users, weatherproof design, double alarm, auto-lock, anti-peep keypad, voice & remote control (with gateway), and emergency power supply via USB-C.

### 3. SPECIFICATIONS

Attribute	Detail
Manufacturer	AppLoki
Model Number	S350BBL-F-2
Product Dimensions	15.49 x 2.54 x 2.54 cm (Lock body)
Color	Black
Style	Handle Pull
Material	Metal
Lock Type	Keypad
Control Method	App, Voice (with gateway)
Recommended Use	Home Doors
Batteries Included?	No

Note: Dimensions for the lock body are provided. Please refer to the installation section for detailed door compatibility measurements.

## 4. SETUP AND INSTALLATION

---

### 4.1 Door Compatibility

The AppLoki Smart Lock is suitable for most standard residential wooden doors. Ensure your door meets the following specifications:

- **Door Thickness:** 1.5" - 1.89" (38mm - 48mm).
- **Door Hole Diameter:** 2.12" (54mm).
- **Distance from Center of Door Hole to Door Edge:** 2.36" (60mm) or 2.76" (70mm). If 60mm, adjust latch length to 60mm. If 70mm, adjust latch length to 70mm.

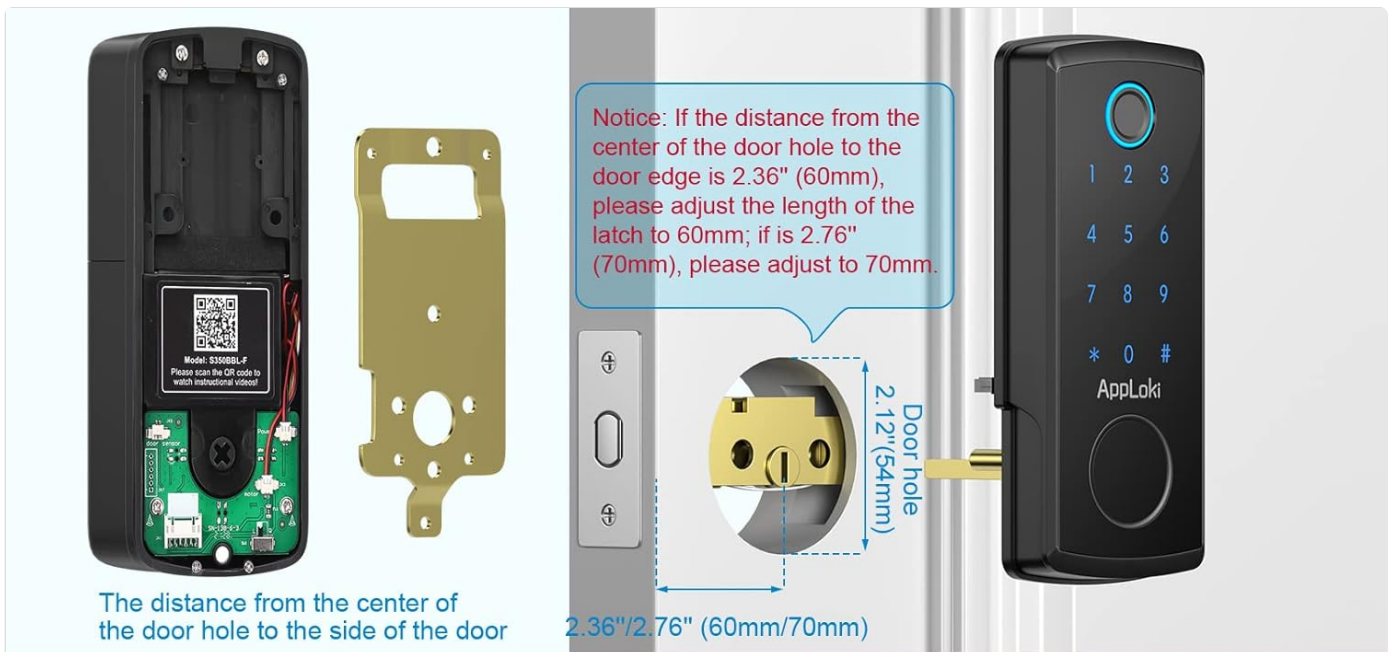

## Suitable for most Standard Residential Wooden Doors



Image: A detailed diagram illustrating the required door dimensions for installation, including door thickness (38-48mm), door hole diameter (54mm), and the adjustable distance from the center of the door hole to the door edge (60mm or 70mm). It also shows the dimensions of the front and back panels of the lock.

### 4.2 Handing Adjustment (Left/Right Handed Doors)

The AppLoki Smart Lock is designed to fit both left and right-handed doors. Before installation, you must adjust the switch on the interior unit according to your door's handing.

1. Identify if your door is left-handed or right-handed.
2. For left-handed doors, turn the switch (labeled SH1) on the back of the interior lock body to 'L'.
3. For right-handed doors, turn the switch (labeled SH1) on the back of the interior lock body to 'R'.

# Fits Left & Right Handed Doors



Image: A visual guide demonstrating how to configure the smart lock for either left-handed or right-handed doors. It shows the interior lock unit and highlights the SH1 switch, instructing users to turn it to 'L' for left-handed doors and 'R' for right-handed doors.

## 4.3 Package Contents

Verify that all components are present in your package:

- Outdoor lock body \* 1
- Indoor lock body \* 1
- (Other components like latch, strike plate, screws, keys, IC cards/fobs, and manual are typically included but not explicitly listed in the provided data.)

For detailed installation steps, please refer to the full installation guide provided in the product packaging or contact customer support.

## 5. OPERATING INSTRUCTIONS

## 5.1 Unlocking Methods

The AppLoki Smart Lock offers multiple convenient ways to unlock your door:

1. **Smartphone APP:** Unlock your door remotely or up close using the dedicated AppLoki smartphone application. Response time: 0.2 seconds.
2. **Fingerprint:** Place your registered fingerprint on the sensor for quick access. Response time: 0.5 seconds.
3. **IC Card (Fob):** Tap the provided IC card (fob) on the designated area of the lock. Response time: 0.3 seconds.
4. **Passcode:** Enter your programmed numerical passcode on the keypad.
5. **Mechanical Key:** Use the physical mechanical key as a traditional backup unlocking method.

## Multiple Ways to Unlock-Faster & Smarter

Offers you more intelligent options to unlock,  
you no longer have to worry about being locked out of your house



1: Smartphone APP

0.2s



2: Fingerprint

0.5s

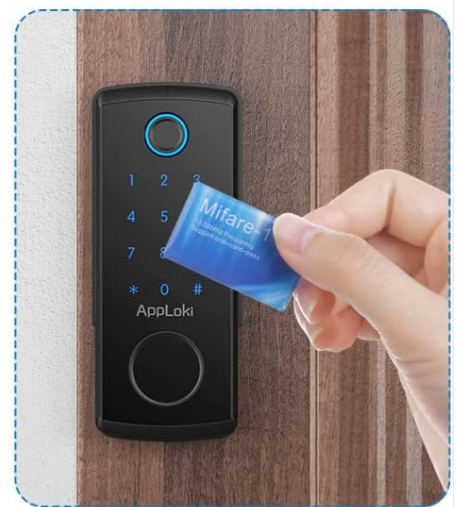

3: IC Card

0.3s

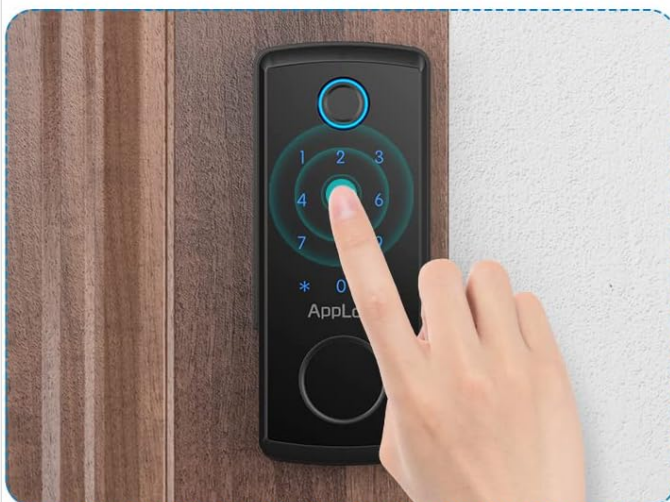

3: Passcode

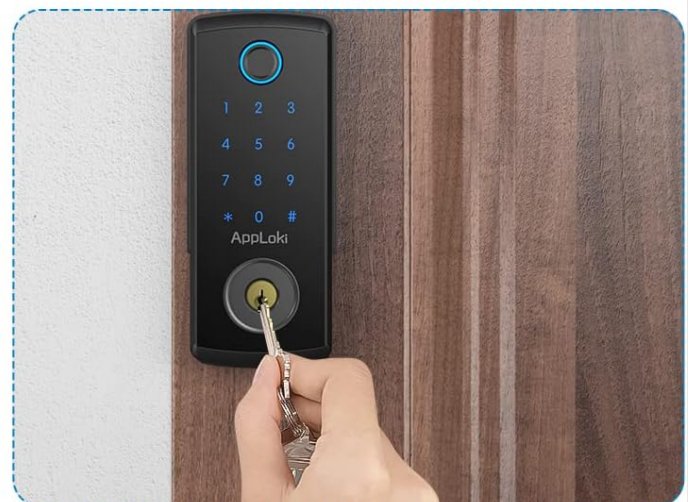

4: Mechanical Key

Image: A visual representation of the five different unlocking methods available for the AppLoki Smart Lock: via smartphone app, fingerprint scan, IC card tap, keypad passcode entry, and traditional mechanical key.

## 5.2 Anti-Peeping Password

To enhance security, the lock supports anti-peeping passwords. You can enter random digits before or after your actual passcode to prevent others from guessing your code.

Example: If your passcode is 123456, you can enter 78241**23456**94512. The lock will recognize the correct sequence within the longer string of numbers.



Image: An illustration demonstrating the anti-peeping password feature. It shows a user entering a sequence of numbers on the keypad, where the actual correct passcode is embedded within a longer string of random digits, enhancing security against shoulder surfing.

### 5.3 Auto-Lock Function

The lock can be configured to automatically lock after a set period. This feature is customizable, allowing you to set the auto-lock delay from 5 to 900 seconds.

Refer to the AppLoki app or the full manual for instructions on how to enable and customize the auto-lock timer.

## 6. MAINTENANCE

---

## 6.1 Battery Replacement

The AppLoki Smart Lock is designed for approximately 365 days of battery life. When the battery level is low, the lock will provide a warning. Replace batteries promptly to ensure continuous operation.

Use 4 x AAA batteries (not included). Refer to the full manual for detailed battery replacement instructions.

## 6.2 Emergency Power Supply

In case of complete battery depletion, the lock can be temporarily powered via an external USB-C power bank connected to the emergency power supply port located at the bottom of the exterior unit. This allows you to unlock the door and replace the batteries.

## 6.3 Cleaning

Clean the lock's surface with a soft, damp cloth. Avoid using abrasive cleaners or solvents that could damage the finish or electronic components.

# 7. TROUBLESHOOTING

---

## 7.1 Double Alarm System

The lock is equipped with a double alarm system to alert you to potential issues:

- **Multiple Failed Password Attempts:** If 5 incorrect password attempts are made, the lock will trigger an alarm. This is a security feature to deter unauthorized access.
- **Low Battery Warning:** The lock will emit an alarm or visual indicator when the battery power drops to 10% or below, signaling that batteries need to be replaced soon.

## Double Alarm



After 5 failed password attempts



The power of the battery is low



Image: A graphic illustrating the two primary alarm conditions for the AppLoki Smart Lock: an alarm triggered after 5 failed password attempts, and a low battery warning when power drops to 10%.

### 7.2 General Troubleshooting Tips

- **Lock not responding:** Check battery level. Use emergency power if needed.
- **Fingerprint not recognized:** Ensure your finger is clean and dry. Re-register fingerprint if issues persist.
- **Passcode not working:** Verify the correct passcode. Try the anti-peeping method.
- **App connectivity issues:** Ensure Bluetooth is enabled on your phone. Restart the app and/or your phone.

For more complex issues, please refer to the comprehensive troubleshooting section in the full product manual or contact AppLoki customer support.

## 8. WARRANTY AND SUPPORT

AppLoki provides 24-hour after-sales service. For warranty information, technical support, or service inquiries, please

contact AppLoki customer support through the details provided in your product packaging or on the official AppLoki website.

Please retain your proof of purchase for warranty claims.