

[Manuals.plus](#) /

› [AVID POWER](#) /

› AVID POWER Cordless Electric Ratchet Wrench (ACRW309-3/8) User Manual

AVID POWER ACRW309-3/8

AVID POWER Cordless Electric Ratchet Wrench (ACRW309-3/8) User Manual

Model: ACRW309-3/8

1. PRODUCT OVERVIEW

The AVID POWER Cordless Electric Ratchet Wrench is a versatile tool designed for various fastening and loosening tasks. This manual provides essential information for safe and efficient operation.



Figure 1: AVID POWER Cordless Electric Ratchet Wrench Kit (Model ACRW309-3/8)

2. PACKAGE CONTENTS

Verify that all items listed below are included in your package:

- 1 x Cordless Ratchet Wrench
- 2 x 2.0Ah Lithium-ion Batteries (one pre-installed)
- 1 x 60-minute Fast Charger
- 1 x AVID POWER BMC Case
- 9 x Sockets (11/16", 5/8", 15/32", 1/2", 7/16", 3/8", 11/32", 5/16", 1/4")
- 1 x 3/8-Inch to 1/4-Inch Drive Adapter
- 1 x User Manual

Avid Power Ratchet Wrench Kit

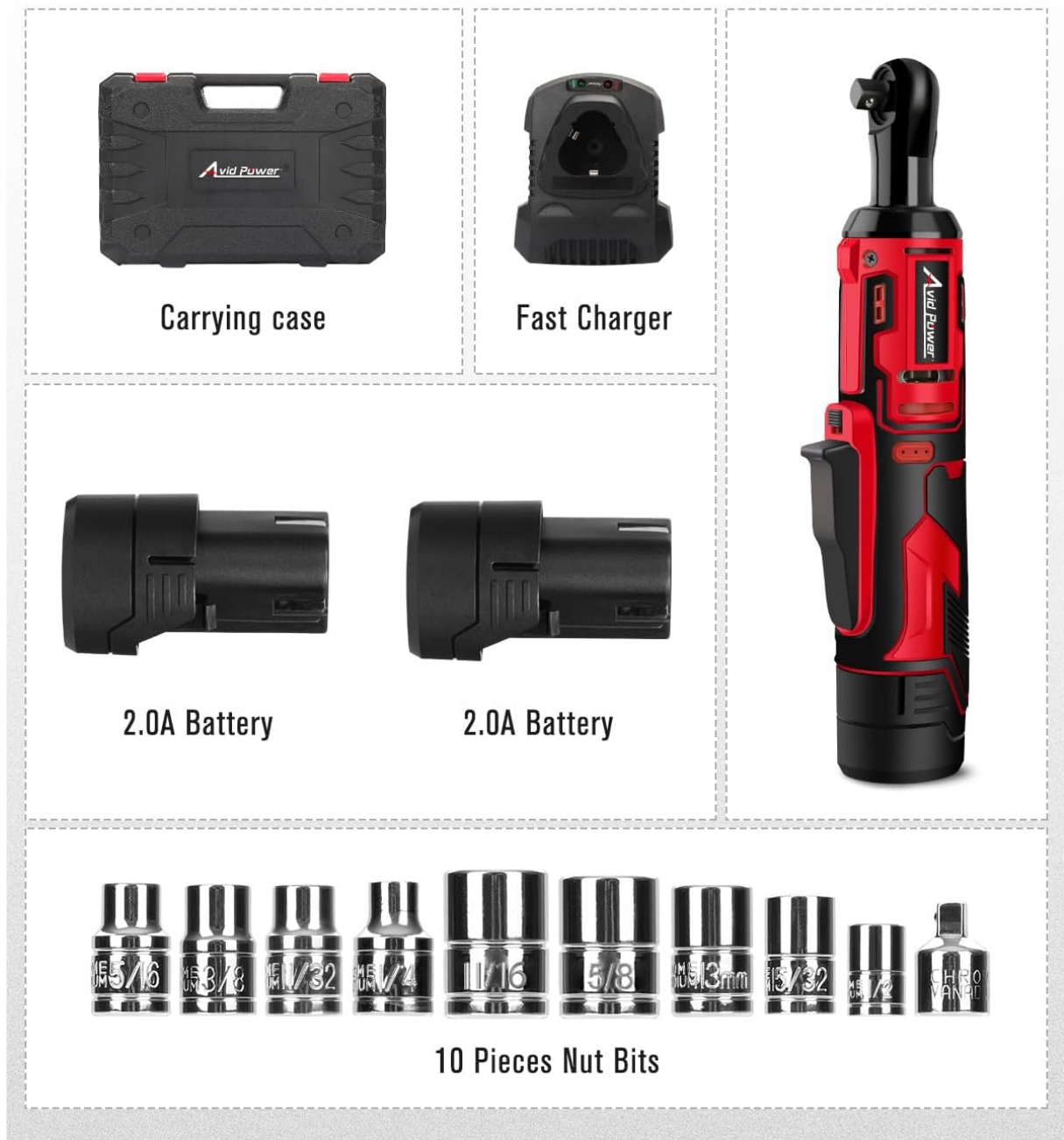

Figure 2: All components included in the AVID POWER Cordless Electric Ratchet Wrench Kit.

3. SETUP

3.1 Battery Charging and Installation

1. Ensure the battery is fully charged before first use. The included 60-minute fast charger is designed to prevent overheating and overcharging.
2. To install the battery, align the battery pack with the base of the ratchet wrench and slide it in until it clicks securely into place.
3. To remove, press the release button on the battery and slide it out.

2.0A Battery and 1 Hour Fast Charger



Figure 3: The 2.0Ah Lithium-ion Battery and 1-Hour Fast Charger.

3.2 Socket Installation

1. Select the appropriate socket size for your task. The kit includes 9 sockets and a 3/8-inch to 1/4-inch drive adapter.
2. Push the chosen socket firmly onto the 3/8-inch drive anvil of the ratchet wrench until it locks into place.
3. To remove, pull the socket off the anvil.



Figure 4: Proper method for attaching a socket to the ratchet wrench.

4. OPERATING INSTRUCTIONS

4.1 Power On/Off and Variable Speed

The ratchet wrench features a variable speed trigger. Press the trigger to activate the tool. The harder you press, the faster the wrench will operate, allowing for precise control over torque and speed.

4.2 Forward/Reverse Switch

Located on the head of the wrench, the forward/reverse switch allows you to quickly change the direction of rotation. Push the switch to the left for forward (tightening) and to the right for reverse (loosening).

Forward & Reverse Switch

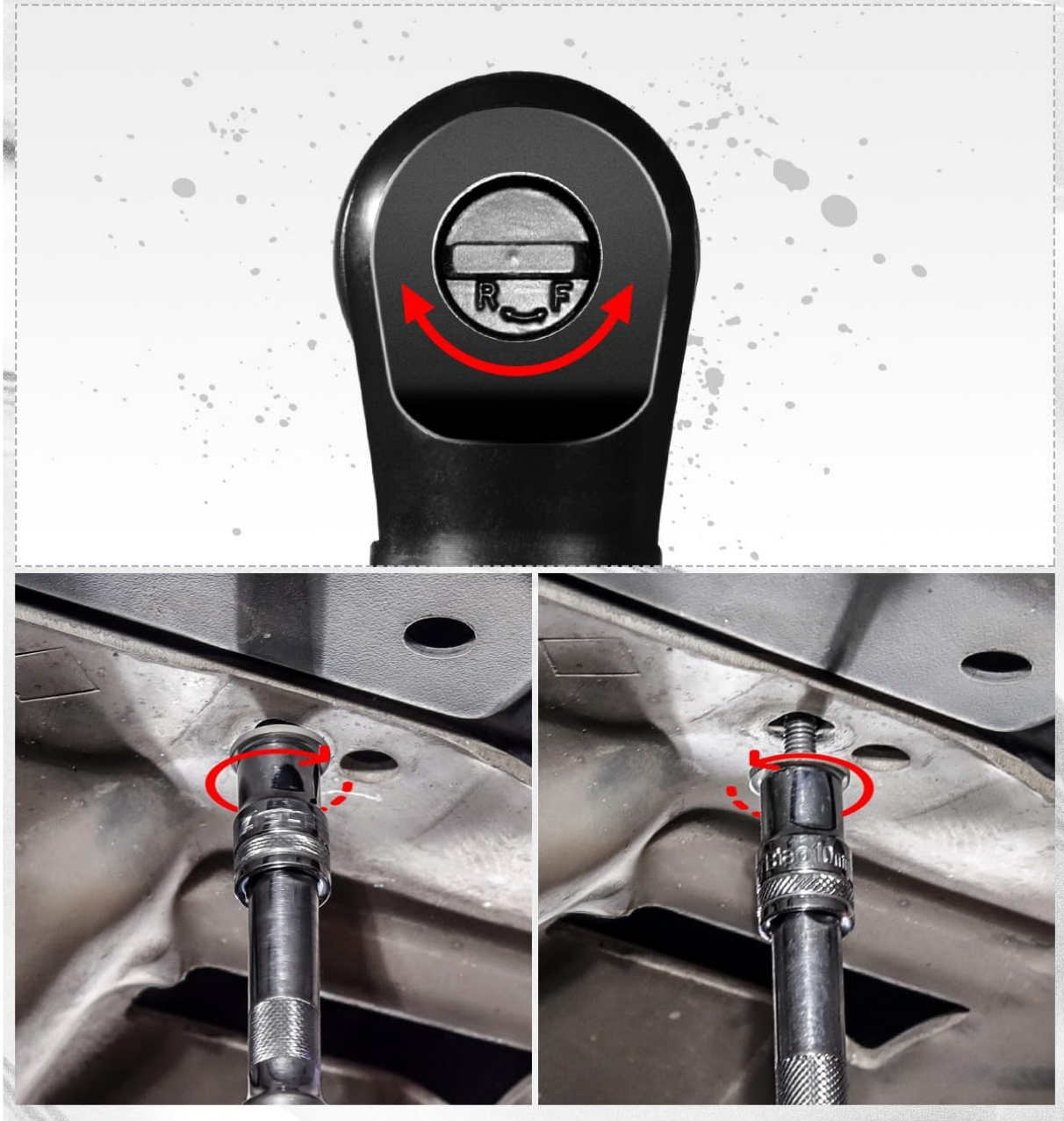

Figure 5: The forward and reverse switch for changing rotation direction.

4.3 Built-in LED Light

A built-in LED light illuminates the work area, improving visibility in dark or confined spaces.

Built-in LED Light

Illuminate Dark Working Environment

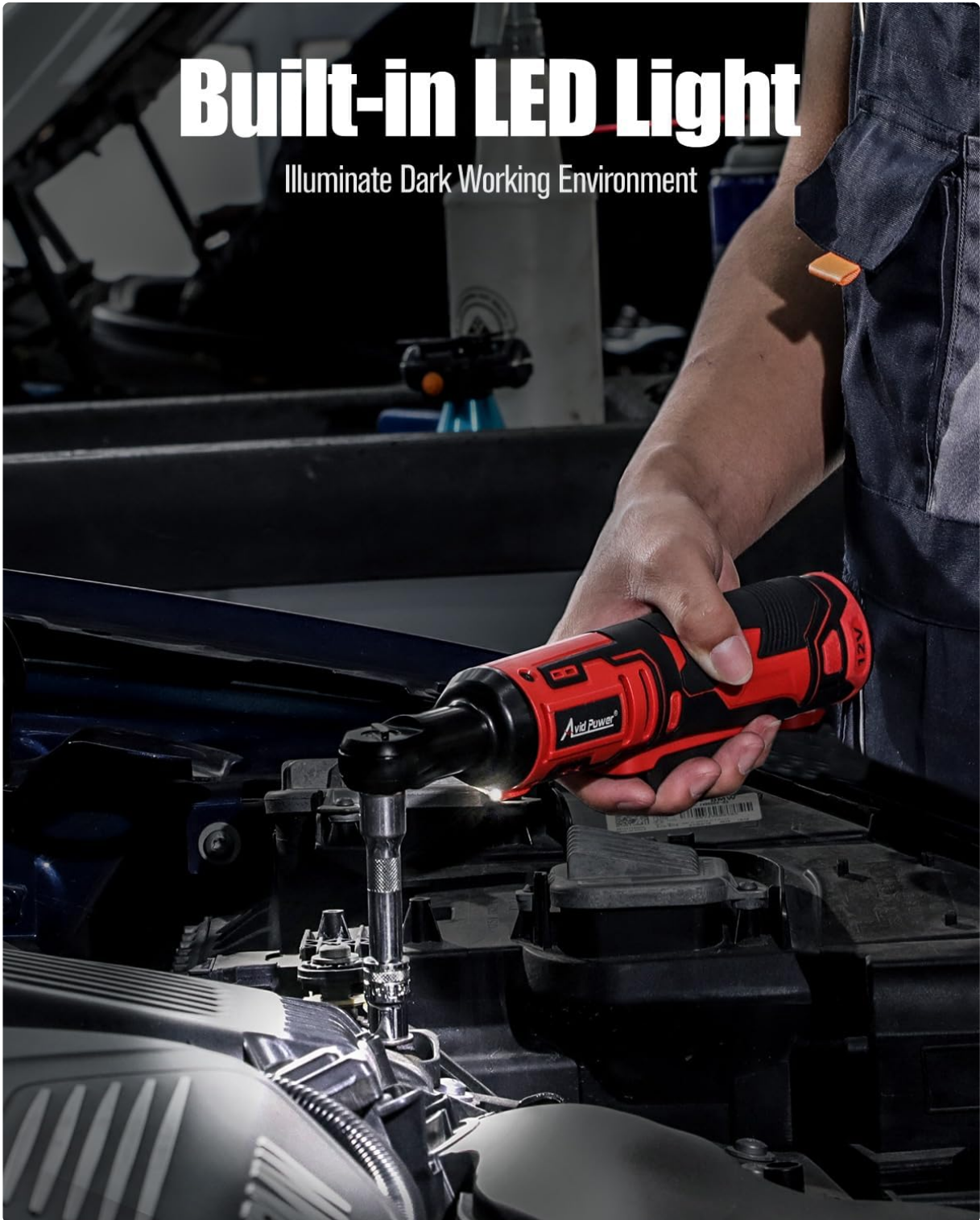

Figure 6: The built-in LED light provides illumination for working in dark environments.

4.4 Power Indicator

The on-board fuel gauge (power indicator) displays the remaining battery charge, allowing you to monitor usage and plan for recharging.

- Green: 80% - 100% charge
- Yellow: 50% - 80% charge
- Red: Below 50% charge

Power Indicator



Figure 7: The power indicator lights display the current battery level.

4.5 General Usage Tips

- For extremely tight or rusted fasteners, manually break them loose with a standard wrench before using the electric ratchet to prevent damage to the tool or fastener.
- Always ensure the socket is fully engaged on the fastener to avoid stripping.
- The tool delivers a maximum torque of 60 N.m (44.2 Ft-lbs) at 300 RPM.



Figure 8: The ratchet wrench in action, demonstrating its 44.2 Ft-lbs torque for automotive tasks.

4.6 Product Videos

Video 1: Demonstration of the 2865 Electric Wrench in various applications. (Source: JENABOM CA)

Video 2: Overview of the 12V 3/8" Cordless Electric Ratchet Wrench features. (Source: Adedad)

Video 3: Usage demonstration of a 3/8" Cordless Ratchet Wrench. (Source: ACRO POWER)

5. MAINTENANCE

5.1 General Care

- Keep the tool clean and free from dirt, dust, and debris. Use a soft, dry cloth for cleaning.

- Store the tool and accessories in the provided BMC case in a dry, secure location away from direct sunlight and extreme temperatures.

5.2 Battery Care

- Always use the original AVID POWER charger to charge the batteries.
- Avoid fully discharging the battery before recharging to prolong its lifespan.
- Do not expose batteries to water or extreme heat.

6. TROUBLESHOOTING

6.1 Tool Not Operating

- Check battery charge: Ensure the battery is fully charged and properly installed. Refer to the power indicator.
- Check the forward/reverse switch: Make sure it is set to either forward or reverse, not in the neutral (locked) position.

6.2 Reduced Performance

- Battery level: A low battery charge can result in reduced torque and speed. Recharge the battery.
- Overload: Avoid excessive force or attempting to loosen fasteners beyond the tool's rated torque. This can trigger overload protection.

7. SPECIFICATIONS

Feature	Specification
Brand	AVID POWER
Model Number	ACRW309-3/8
Voltage	12 Volts
Max Torque	60 N.m (44.2 Ft-lbs)
No-Load Speed	300 RPM
Drive Size	3/8 Inch
Battery Capacity	2.0Ah Lithium-ion
Item Weight	0.95 Kilograms (1.88 lbs)
Item Length	11 Inches
Material	Plastic, Rubber

8. WARRANTY AND SUPPORT

For warranty information and customer support, please refer to the documentation included with your product or visit the official AVID POWER website. Contact details for the manufacturer are typically provided in the product packaging or on their website.

Manufacturer: AVID POWER

