

## NATFIRE NE3

# NATFIRE NE3 Wireless Otoscope Smart Ear Cleaning Kit User Manual

Model: NE3

## 1. PRODUCT OVERVIEW

The NATFIRE NE3 Wireless Otoscope Smart Ear Cleaning Kit is designed for precise ear inspection and wax removal. It features a high-definition camera, LED illumination, and wireless connectivity to provide a clear view of the ear canal on your smartphone or tablet.

### Key Features:

- Integrated 6 LED Lights for clear illumination.
- Dust and Fog Proof lens for consistent image quality.
- Easy Wi-Fi Connection for seamless device pairing.
- 3.6 mm Lens Inner Diameter for safe and effective use.
- 1296P Pixels Professional Otoscope for high-resolution imaging.
- 3-Axis Smart Gyroscope for stable viewing.

### Package Contents:

Please verify that all items are present in your package.



Image: The NATFIRE NE3 Wireless Otoscope kit, including the device, charging cable, ear spoon heads, and user manual, displayed alongside its retail packaging.

- NATFIRE NE3 Wireless Otoscope
- USB Charging Cable
- Replaceable Ear Spoon Heads
- User Manual

## 2. SAFETY INFORMATION

---

Read all safety instructions before using this product. Failure to follow these instructions may result in injury or damage to the device.

- **Consult a Medical Professional:** If you experience ear pain, discomfort, or have a history of ear conditions, consult a doctor before using this device.
- **Gentle Use:** Always insert the ear spoon head gently into the ear canal. Avoid pushing too deep or using excessive force, which can cause injury to the eardrum or ear canal.
- **Children:** This device is not a toy. Keep out of reach of children. Adult supervision is required if used on children.
- **Cleanliness:** Always clean the ear spoon heads before and after each use to prevent cross-infection.
- **Damage:** Do not use the device if the ear spoon head is damaged or detached.

- **Legal Disclaimer:** Statements regarding dietary supplements have not been evaluated by the FDA and are not intended to diagnose, treat, cure, or prevent any disease or health condition. This device is for personal hygiene and inspection purposes.

### 3. SETUP INSTRUCTIONS

---

Follow these steps to set up your NATFIRE NE3 Wireless Oscope and connect it to your mobile device.

1. **Download the App:** Scan the QR code provided in the manual or on the product packaging to download the 'SL YLZ' application from your device's app store (compatible with Android and iOS).
2. **Power On the Oscope:** Press and hold the power button on the device for 2 seconds until the blue indicator light flashes. This indicates the device is ready for connection.
3. **Connect to Wi-Fi:**
  - Open your phone's Wi-Fi settings.
  - Find the Wi-Fi network named 'HNDEC-XXXXXX' (where XXXXXX is a unique identifier).
  - Connect to this network. No password is required.
4. **Launch the App:** Return to the 'SL YLZ' app. The power key indicator on the device will turn solid blue, signifying a successful connection.
5. **Begin Use:** You can now view the live feed from the otoscope camera within the app.

# USING STEPS



Holding down the power key for 2 seconds till the blue light flashes. It means ready to connect with APP

Open the APP, the following Click the button to search WIFI interface appears



Find WIFI: HNDEC-XXXXXX and click

Return to the APP. The powerkey turning to blue means connectsuccessfully

Enter into normal use, as shown below

Image: A visual guide demonstrating the six steps to connect the NATFIRE NE3 otoscope to a smartphone via Wi-Fi, from powering on to viewing the live feed in the app.

## 4. OPERATING INSTRUCTIONS

Once connected, you can begin using your NATFIRE NE3 for ear inspection and cleaning.

1. **Attach Ear Spoon:** Securely attach one of the provided ear spoon heads to the tip of the otoscope. Ensure it is firmly in place to prevent accidental detachment during use.

2. **Positioning:** Gently insert the otoscope into the ear canal. Use the live view on your connected device to guide the tip. The 3-axis smart gyroscope helps maintain a stable image.
3. **Inspection:** Observe the ear canal and eardrum through the app. The 6 LED lights provide ample illumination, and the 1296P camera offers a clear, detailed view.
4. **Ear Wax Removal:** If necessary, carefully use the ear spoon head to gently scoop out visible ear wax. Always move slowly and deliberately. If you encounter resistance or pain, stop immediately.
5. **Capture Images/Video:** The app typically includes options to capture still images or record video of your ear canal for later review or to share with a medical professional.
6. **Completion:** Once finished, gently remove the otoscope from the ear.



Image: A person using the NATFIRE NE3 wireless otoscope to inspect their ear, with the live camera feed displayed on a smartphone screen, showing the inside of the ear canal.

## 5. MAINTENANCE

---

Proper maintenance ensures the longevity and hygienic operation of your device.

- **Cleaning Ear Spoon Heads:** After each use, remove the ear spoon head and clean it thoroughly with rubbing alcohol or an antiseptic wipe. Allow it to dry completely before storage or next use.
- **Replacing Ear Spoon Heads:** The ear spoon heads are replaceable to prevent cross-infection and ensure optimal hygiene. Gently twist to remove and attach new ones.

# Replaceable ear spoon head

## Take it off Avoid cross infection

Good ear spoon design is round full comfortable  
safe and firm



Anti-dropping



Safety material



Image: A close-up view illustrating the design of the replaceable ear spoon heads, highlighting their anti-dropping feature and safety material, with an arrow indicating the twisting motion for attachment and removal.

- **Cleaning the Lens:** The otoscope features a waterproof, dust-proof, and fog-proof lens (IPX5 rated). If the lens becomes dirty, gently wipe it with a soft, dry, lint-free cloth. Avoid abrasive materials.



# Water-proof, dust-proof and fog-proof lens

**IPX5**  
waterproof  
be dust-proof

**100 °C steam**  
Antifog



Image: The NATFIRE NE3 otoscope being held under running water, demonstrating its IPX5 waterproof rating and highlighting its dust-proof and fog-proof lens capabilities.

- **Charging:** Recharge the device using the provided USB cable when the battery is low.
- **Storage:** Store the device in a clean, dry place away from direct sunlight and extreme temperatures.

## 6. TROUBLESHOOTING

---

If you encounter issues with your NATFIRE NE3, refer to the following common problems and solutions.

- **Device Not Turning On:**
  - Ensure the device is fully charged. Connect it to a power source using the USB cable.

- Press and hold the power button for at least 2 seconds.
- **Unable to Connect to Wi-Fi:**
  - Make sure the otoscope is powered on and its blue indicator light is flashing.
  - Check your phone's Wi-Fi settings to ensure you are selecting the correct 'HNDEC-XXXXXX' network.
  - Restart both the otoscope and your mobile device, then try connecting again.
  - Ensure the 'SL YLZ' app has the necessary permissions (e.g., Wi-Fi, camera) on your mobile device.
- **No Image in App / Poor Image Quality:**
  - Verify that the device is successfully connected to the app (solid blue indicator light).
  - Clean the otoscope lens with a soft, dry cloth.
  - Ensure there is sufficient light in the ear canal; the built-in LEDs should provide this.
  - Check the app for any settings related to image resolution or brightness.
- **Ear Spoon Head Detaches:**
  - Ensure the ear spoon head is securely twisted onto the device before use.
  - Replace worn or damaged ear spoon heads.

## 7. SPECIFICATIONS

Feature	Specification
Model	NE3
Lens Inner Diameter	3.6 mm
Camera Resolution	1296P Pixels
LED Lights	6
Viewing Angle	100 degrees
Focal Length	15-20 mm
Waterproof Rating	IPX5 (Waterproof, Dust-proof, Fog-proof)
Connectivity	Wi-Fi
Gyroscope	3-Axis Smart Gyroscope
Product Dimensions	0.5 x 0.5 x 5 inches
Weight	1.5 ounces





1296p Pixels  
professional otoscope



Real Picture

## 1296P PIXELS Professional Otoscope

3.6mm lens length | Anti-dust and anti-fog



6 LED Lights



1296p Pixels



Dust-proof



Fog-proof



Blue-ray  
proof lens



3.6mm Lens  
Diameter



Image: An illustration detailing the specifications of the NATFIRE NE3's professional otoscope lens, including 1296P pixels, 6 LED lights, dust-proof, fog-proof, blue-ray proof lens, and 3.6mm lens diameter.

## Equipped with a super-fast WiFi chip, the has a very smooth transmission

It provides the highest speed for the app to function the camera display, making it easy and smooth to set up and auto-connect the product to your phone

**100°**  
Viewing angle

**15-20<sub>mm</sub>**  
Focal length

**3.6<sub>mm</sub>**  
Lens inner diameter

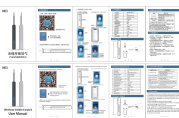

Image: A diagram showcasing the internal components of the NATFIRE NE3, emphasizing its super-fast WiFi chip and lens specifications such as 100-degree viewing angle, 15-20mm focal length, and 3.6mm lens inner diameter.

### 8. WARRANTY AND SUPPORT

---

For warranty information or technical support, please refer to the contact details provided with your purchase documentation or visit the official NATFIRE website. Keep your purchase receipt as proof of purchase.

	<p><a href="#">NE3 Wireless Visible Earpick User Manual: Visual Ear Cleaning Guide</a></p> <p>Comprehensive user manual for the NE3 Wireless Visible Earpick. Learn how to use, troubleshoot, and maintain your digital ear cleaner for safe and effective ear wax removal.</p>
	<p><a href="#">NE3 Wireless Visible Earpick User Manual   Setup, Use, and Troubleshooting</a></p> <p>Comprehensive user manual for the NE3 Wireless Visible Earpick. Learn how to connect, use, and troubleshoot this visual ear cleaning device with detailed instructions, product parameters, and safety precautions.</p>
	<p><a href="#">NE3 Wireless Visible Earpick User Manual - Setup, Features, and Troubleshooting</a></p> <p>Comprehensive user manual for the NE3 Wireless Visible Earpick. Learn how to connect, use, and troubleshoot this digital otoscope. Includes product specifications and safety precautions.</p>
	<p><a href="#">NE3 Wireless Visible Earpick User Manual</a></p> <p>User manual for the NE3 Wireless Visible Earpick, detailing setup, usage, product parameters, troubleshooting, and cautions. Includes instructions for downloading the app, connecting to Wi-Fi, and operating the device.</p>
<p>164*125mm</p> 	<p><a href="#">Wireless Visual Earpick User Manual - NATFIRE</a></p> <p>Comprehensive user manual for the NATFIRE Wireless Visual Earpick. Learn how to download the app, connect via Wi-Fi (iOS/Android), understand product specifications, charging, and troubleshoot common issues.</p>
	<p><a href="#">NE3 Wireless Visible Earpick User Manual: Visual Ear Cleaning Guide</a></p> <p>Comprehensive user manual for the NE3 Wireless Visible Earpick. Learn how to use, troubleshoot, and maintain your digital ear cleaner for safe and effective ear wax removal.</p>

164\*125mm

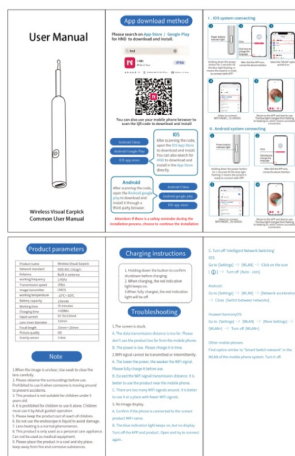

## [Wireless Visual Earpick User Manual - NATFIRE](#)

Comprehensive user manual for the NATFIRE Wireless Visual Earpick. Learn how to download the app, connect via Wi-Fi (iOS/Android), understand product specifications, charging, and troubleshoot common issues.

lang: **score:17** filesize: 4.25 M page\_count: 1 document date: 2025-06-30