

Tomofree T1Pro

Tomofree Folding Electric Bike T1Pro User Manual

Model: T1Pro

1. SAFETY INFORMATION

Before operating your Tomofree T1Pro Folding Electric Bike, please read and understand all safety instructions. Failure to follow these instructions may result in serious injury or property damage.

- Always wear a helmet and appropriate safety gear when riding.
- Familiarize yourself with local laws and regulations regarding electric bicycles.
- Perform a pre-ride inspection before each use, checking brakes, tires, battery, and lights.
- Do not ride under the influence of alcohol or drugs.
- Avoid riding in adverse weather conditions or on slippery surfaces.
- Ensure all quick-release levers and folding mechanisms are securely locked before riding.
- Maintain a safe speed and distance from other vehicles and pedestrians.

2. PACKAGE CONTENTS

Your Tomofree T1Pro Electric Bike package includes the following items:

- Tomofree T1Pro Folding Electric Bike (95% assembled)
- Battery Charger
- Keys (for battery lock and ignition)
- Remote Control (for anti-theft alarm)
- Tool Kit
- User Manual (this document)

- Pedals
- Mobile Phone Holder



Image: All components included with the Tomofree T1Pro electric bike, including the charger, lock, tool kit, keys, remote, pedals, and phone holder.

3. SETUP AND ASSEMBLY

Your Tomofree T1Pro electric bike arrives 95% assembled. Follow these steps to complete the assembly:

1. **Unfolding the Frame:** Carefully unfold the main frame until it locks into place. Secure the frame hinge with the quick-release lever.
2. **Handlebar Installation:** Insert the handlebar stem into the frame and secure it with the quick-release clamp. Adjust the height to your preference.
3. **Seat Post Installation:** Insert the seat post into the frame and secure it with the quick-release clamp. Adjust the height for comfortable riding.
4. **Pedal Attachment:** Identify the left (L) and right (R) pedals. Screw the pedals into the corresponding crank arms. The left pedal tightens counter-clockwise, and the right pedal tightens clockwise. Use a wrench to ensure they are securely fastened.
5. **Battery Connection:** Ensure the battery is securely seated and locked into its compartment. Connect any visible battery cables if they are not already connected.

Video: This video demonstrates the quick assembly process for the Tomofree T1Pro electric bike, including unfolding the frame, attaching handlebars, seat, and pedals, and connecting the battery.



Image: The Tomofree T1Pro Folding Electric Bike in its fully assembled state, showcasing its compact design and key features.

4. OPERATING INSTRUCTIONS

4.1 Power On/Off

- To power on the bike, insert the key into the ignition and turn it to the 'ON' position. The LCD display will illuminate.
- To power off, turn the key to the 'OFF' position and remove it.

4.2 LCD Display and Controls

The LCD display provides essential riding information. Use the 'M' button to cycle through different display modes.

- **Speed Display:** Shows current speed in MPH.
- **Battery Life:** Indicates remaining battery charge.
- **Odometer:** Tracks total distance traveled.
- **Trip Meter:** Tracks distance for the current ride.
- **Battery Voltage:** Displays current battery voltage.
- **Error Codes:** Alerts to any system malfunctions.



Image: The convenient control panel of the Tomofree T1Pro, featuring the LCD display, PAS button, USB mobile phone holder, and light/gear controls.

4.3 Pedal Assist System (PAS)

The T1Pro is equipped with a dedicated PAS switch to control pedal assistance levels.

- Press the 'M' button next to the LCD display to adjust between 3 speed gears (PAS levels).
- Higher PAS levels provide more motor assistance, reducing pedaling effort.
- You can also ride without pedal assist for a traditional cycling experience.

4.4 Lighting System

The bike features a comprehensive lighting system for enhanced visibility and safety.

- **Headlight:** Turn on/off using the switch on the left handlebar.
- **Tail Light:** Automatically activates with the headlight.
- **Brake Light:** Illuminates when brakes are applied.
- **Turn Signals:** Use the left/right buttons on the handlebar to activate.



Image: Illustration of the Tomofree T1Pro's lighting system, including the powerful headlight, brake light, and pedal reflectors for night riding safety.

4.5 Anti-Theft System

The T1Pro includes an anti-theft alarm system for added security.

- **One-Click Locking:** Press the lock button on the remote to arm the alarm.
- **One-Click Unlocking:** Press the unlock button on the remote to disarm the alarm.
- **Anti-Theft Alarms:** The alarm will sound if the bike is tampered with while armed.
- **Find E-bike:** Use the remote to locate your bike by activating a sound signal.

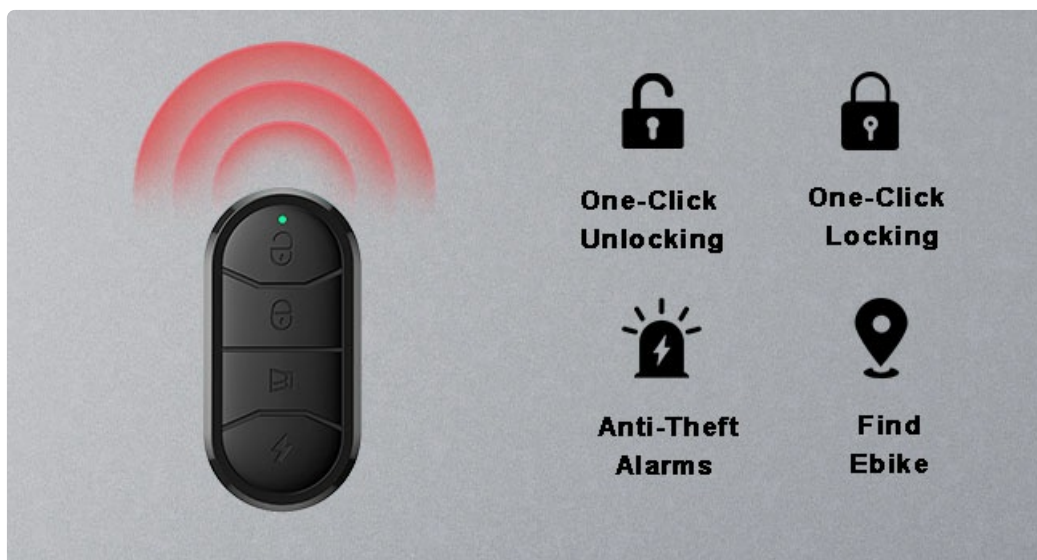

Image: The remote control for the Tomofree T1Pro's anti-theft system, showing buttons for one-click unlocking, locking, anti-theft alarms, and finding the e-bike.

4.6 Folding Mechanism

The T1Pro features a 3-step folding system for convenient storage and transport.

- Ensure the bike is powered off before folding.

- Release the handlebar stem clamp and fold the handlebars down.
- Release the main frame hinge clamp and fold the bike in half.
- Lower the seat post completely.



Image: The Tomofree T1Pro electric bike folded and stored in a car trunk next to a suitcase, demonstrating its compact size for easy transport.

5. BATTERY INFORMATION

The Tomofree T1Pro is equipped with a high-capacity removable lithium battery.

- **Battery Type:** 48V 20Ah Lithium Battery (960 Watt Hours)
- **Max Range:** Up to 40 miles per charge (actual range may vary based on terrain, rider weight, and assist level).
- **Charging Time:** Approximately 6-8 hours for a full charge using the included 2A fast charger.

- **Charging:** Connect the charger to the charging port on the battery or directly to the battery if removed from the bike. Plug the charger into a standard wall outlet. The charger indicator light will change when fully charged.
- **Battery Care:** Store the battery in a cool, dry place. Avoid extreme temperatures. Charge regularly, even if not in use, to maintain battery health.

Easy Disassembly & Safety

48V 20AH Lithium Battery

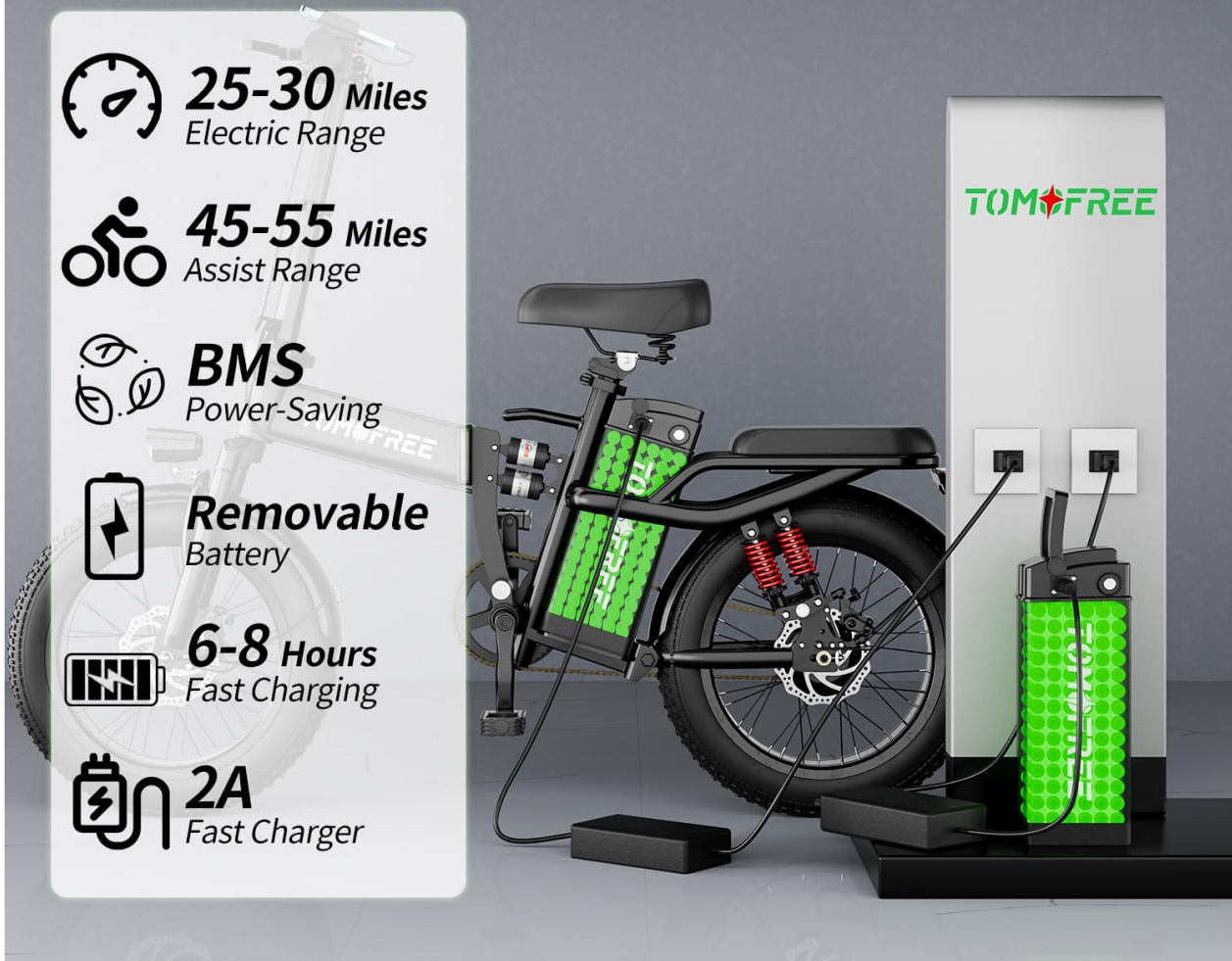

Image: Detailed view of the Tomofree T1Pro's removable 48V 20Ah lithium battery, highlighting its capacity, range, and charging features.

6. FEATURES OVERVIEW

- **Motor:** Powerful 1500W brushless motor, capable of reaching speeds up to 30 MPH and conquering 30-degree slopes.
- **Tires:** 16"x3.0" rugged fat tires for all-terrain use, offering super grip and wear resistance.
- **Suspension:** Full suspension system with 10 spring shock absorbers, including mid-mounted double

shock absorbers, hydraulic shock absorbers, seat pack double spring shock, and rear brace four shock absorbers, for a comfortable ride on various terrains.

- **Frame:** High-carbon steel material for durability and strong shock absorption.
- **Seating:** High-density sponge material seat for enhanced comfort during long rides.
- **Portability:** Foldable design for easy storage and transport.



1500W (Peak)
Brushless Motor

33MPH
Top Speed

1500W
Motor

30°
Climbing

Image: A rider on the Tomofree T1Pro electric bike, highlighting the powerful 1500W brushless motor, 33 MPH top speed, and 30-degree climbing capability.

10 Spring Shock Absorbers

Full Suspension System



**16"*3"
Fat Tire**



**Hydraulically
Fork Suspension**



**Full
Suspension**

Image: An exploded view of the Tomofree T1Pro's full suspension system, illustrating the 10 spring shock absorbers and hydraulically suspended fork for enhanced comfort.

16''x3'' FAT TIRE

Folding Electric Bike



PAS Mode
Button



48V 20Ah
Removable Battery



27-50 Miles
Ridding Range



Conquer 30°
Slope



330 lbs
Max Load



Image: A rider on the Tomofree T1Pro in a snowy environment, emphasizing the 16"x3" fat tires, PAS mode, 48V 20Ah removable battery, 27-50 miles riding range, and 330 lbs max load capacity.

7. SPECIFICATIONS

Feature	Specification
Bike Type	Electric Bike
Motor	1500W
Battery	48V 20Ah Lithium (960 Wh)
Max Speed	30 MPH
Max Range	Up to 40 Miles

Feature	Specification
Wheel Size	16 Inches
Tire Width	3 Inches (Fat Tire)
Frame Material	Stainless Steel (High-Carbon Steel)
Suspension Type	Dual (10 Shock Absorbers)
Brake Style	Disc
Number of Speeds	3 (PAS levels)
Max Weight Recommendation	330 Pounds
Minimum User Height	60 Inches (5 feet)
Folded Dimensions	33.1 x 15.7 x 24.4 inches
Bike Weight	70.11 Pounds (approx. 68 lbs)



Image: Visual representation of the Tomofree T1Pro electric bike's dimensions, weight (68 lbs), and maximum load capacity (330 lbs), along with recommended user height (5'-6'3").

8. MAINTENANCE

Regular maintenance ensures the longevity and safe operation of your electric bike.

- **Tires:** Check tire pressure before each ride. Maintain recommended pressure for optimal performance and safety. Inspect for wear and damage.
- **Brakes:** Regularly check brake pads for wear and ensure brake levers provide firm and responsive stopping power. Adjust or replace as needed.
- **Chain:** Keep the chain clean and lubricated to prevent rust and ensure smooth operation.
- **Fasteners:** Periodically check all bolts, nuts, and quick-release levers to ensure they are tight and secure.
- **Battery:** Follow battery care guidelines (Section 5). Avoid fully discharging the battery frequently.
- **Cleaning:** Clean the bike with a damp cloth. Avoid using high-pressure water jets directly on electrical components.

9. TROUBLESHOOTING

If you encounter issues with your Tomofree T1Pro, refer to the following common troubleshooting tips:

- **Bike not powering on:** Check if the battery is fully charged and securely connected. Ensure the key is in the 'ON' position.
- **Motor not assisting:** Verify that the PAS level is set above 0. Check for any error codes on the LCD display.
- **Brakes feel weak:** Inspect brake pads for wear. Adjust brake cable tension or replace pads if necessary.
- **Unusual noises:** Check for loose components, chain issues, or debris caught in moving parts.
- **Reduced range:** Ensure the battery is fully charged. Riding conditions (hills, heavy loads, high speeds) can affect range.

For persistent issues or problems not listed here, please contact customer support.

10. WARRANTY AND SUPPORT

Tomofree offers a 1-year limited warranty with free replacement parts for your T1Pro Electric Bike.

- **Warranty Period:** 1 Year from the date of purchase.
- **Coverage:** Covers manufacturing defects and component failures under normal use.
- **Exclusions:** Does not cover damage from misuse, accidents, unauthorized modifications, or normal wear and tear.

Customer Support:







For any questions, technical assistance, or warranty claims, please contact our dedicated support team:

- **Email:** help@tomofree.com
- **Phone (Text Only):** +1-518-614-6355



Image: Tomofree customer support contact details, including email and text-only phone number, emphasizing dedicated manufacturer support and a 12-month warranty.

Related Documents - T1Pro

	Tomofree T1PRO Electric Bike User Manual and Safety Guide Comprehensive user manual and safety guide for the Tomofree T1PRO Electric Bike, covering specifications, assembly, operation, maintenance, troubleshooting, and warranty information. Learn how to safely operate and maintain your e-bike.
	TOMOFREE T1 16-inch Electric Bicycle User Manual Comprehensive user manual for the TOMOFREE T1 16-inch electric bicycle, covering specifications, operation, battery care, maintenance, troubleshooting, and warranty information.
	Tomofree Model T1 Foldable Electric Bike User Manual - Specifications, Installation, and Maintenance This comprehensive manual provides detailed information for the Tomofree Model T1 foldable electric bike, including specifications, package contents, overview, installation steps, dashboard and remote functions, battery care, maintenance guidelines, and warranty details.
	Tomofree Model BEE Electric Scooter Manual Specifications, Features, and Maintenance Comprehensive user manual for the Tomofree Model BEE electric scooter. Includes specifications, package contents, overview, installation, dashboard guide, battery care, maintenance, troubleshooting, and warranty information.
	Tomofree XT200 Electric Bike User Manual and Specifications Comprehensive user manual for the Tomofree XT200 Electric Bike, covering specifications, assembly, operation, safety, maintenance, troubleshooting, and warranty information.
	TOMOFREE S1PRO Electric Bike User Manual Comprehensive user manual for the TOMOFREE S1PRO electric bicycle, covering specifications, package contents, installation, operation, battery care, maintenance, troubleshooting, and warranty information.

Documents - Tomofree – T1Pro



[Tomofree T1PRO Electric Bike User Manual and Safety Guide](#)
Comprehensive user manual and safety guide for the Tomofree T1PRO Electric Bike, covering specifications, assembly, operation, maintenance, troubleshooting, and warranty information. Learn how to safely operate and maintain your e-bike.
lang:en score:55 filesize: 1.25 M page_count: 16 document date: 2025-07-11