

Yaheetech MM-00132644-001

Yaheetech 4ft6 Double Bed Frame Instruction Manual

Model: MM-00132644-001

1. PRODUCT OVERVIEW

This Yaheetech metal platform bed frame features an arched headboard with a crown-inspired design, offering a blend of vintage and modern aesthetics. Constructed from durable metal, it provides stable support for various mattress types without requiring a box spring. The design includes ample under-bed storage space and features to enhance mattress stability.



Image 1.1: The Yaheetech 4ft6 Double Bed Frame, showcasing its crown-inspired headboard and under-bed storage capability.

Key Features:

- **Simplistic yet Classy Design:** Features an arched silhouette with spindle detailing, suitable for various bedroom decors.
- **Durable Metal Construction:** Made from solid metal with a powder-coated finish for longevity and stability.
- **High Headboard & Footboard:** Provides comfortable back support and accommodates mattresses of varying thicknesses.
- **Spacious Under-bed Clearance:** Offers 32 cm of space for storage, helping to keep your bedroom organized.
- **Mattress Stability:** Fixed slats and anti-slip baffles prevent mattress movement and reduce noise.

2. SAFETY INFORMATION

Please read and understand all safety instructions before assembly and use to prevent injury or damage.

- **Assembly Personnel:** It is recommended that 2 or more people assemble this bed frame.
- **Protective Gear:** Wear protective gloves during assembly to avoid injury from sharp edges.
- **Child Safety:** This product is not intended for use by children. Keep children away from the assembly area.
- **Heat Sources:** Keep the bed frame away from fire and other heat sources.
- **Assembly Surface:** Use a pad or soft surface during assembly to prevent damage to the product and your floor.
- **Foot Caps:** Ensure all non-slip foot caps are securely attached to prevent slipping and protect flooring.
- **Sharp Edges:** Be cautious of sharp edges during handling and assembly.

IMPORTANT/WICHTIG/ATENCIÓN IMPORTANT/IMPORTANTE

	<p>EN - We recommend 2 or more people to install.</p> <p>DE - Wir empfehlen, dass die Montage von 2 oder mehreren Personen durchgeführt werden sollte.</p> <p>ES - Recomendamos realizar el ensamble con 2 o más personas.</p> <p>FR - Il est recommandé d'effectuer le montage à 2 personne(s) ou plus.</p> <p>IT - È necessaria la presenza di 2 o più persone per il montaggio di questo prodotto.</p> <p>PL - Zalecamy montaż przez co najmniej 2 osoby.</p> <p>NL - We raden installatie door 2 of meer personen aan.</p> <p>SE - Vi rekommenderar 2 eller flera personer är med och installera.</p>
	<p>EN - The expected assembly time is 1 h.</p> <p>DE - Die Montagezeit beträgt durchschnittlich 1 h.</p> <p>ES - El tiempo aproximado de ensamble es de 1 h.</p> <p>FR - Le temps nécessaire est estimé à 1 h.</p> <p>IT - Il tempo previsto per il corretto assemblaggio è di 1 h.</p> <p>PL - Przewidywany czas montażu wynosi 1 h.</p> <p>NL - De verwachte montagetijd is 1 u.</p> <p>SE - Den förväntade monterings tiden är 1 timme.</p>
	<p>EN - Not intended for use by children.</p> <p>DE - Nicht geeignet für Kinder.</p> <p>ES - Producto no apto para niños.</p> <p>FR - Produit non destiné à être utilisé par des enfants.</p> <p>IT - Questo prodotto non è destinato all'uso da parte dei bambini.</p> <p>PL - Produkt nie jest przeznaczony do użytku przez dzieci.</p> <p>NL - Niet bedoeld voor gebruik door kinderen.</p> <p>SE - Inte avsedd att användas av barn.</p>
	<p>EN - Keep away from fire or other heat sources.</p> <p>DE - Bitte von Feuer und Hitzequellen fernhalten.</p> <p>ES - Manténgase alejado de las llamas y otras fuentes de calor.</p> <p>FR - Tenir à distance des flammes et autres sources de chaleur.</p> <p>IT - Tenere lontano dal fuoco o da altre fonti di calore.</p> <p>PL - Przechowywać z dala od ognia lub innych źródeł ciepła.</p> <p>NL - Uit de buurt van vuur en andere warmtebronnen houden.</p> <p>SE - Håll borta från eld eller andra värmekällor.</p>
	<p>EN - We recommend wearing protective gloves.</p> <p>DE - Wir empfehlen das Tragen von Schutzhandschuhen.</p> <p>ES - Recomendamos el uso de guantes de seguridad.</p> <p>FR - Il est recommandé de porter des gants de protection.</p> <p>IT - Per il processo di assemblaggio, consigliamo fortemente l'utilizzo di guanti protettivi.</p> <p>PL - Zalecamy noszenie rękawic ochronnych.</p> <p>NL - We raden aan om beschermende handschoenen te dragen.</p> <p>SE - Vi rekommenderar att man använder skyddshandskar.</p>

Image 2.1: Visual guide for important safety and assembly recommendations, including team assembly, estimated time, child safety, heat warnings, and glove use.

3. SETUP AND ASSEMBLY

The Yaheetech Double Bed Frame is designed for straightforward assembly. All necessary tools and

numbered parts are included. The estimated assembly time is approximately 1 hour with two people.

Before You Begin:

1. Unpack all components and verify against the parts list in your included instruction manual.
2. Lay out all parts on a clean, soft surface (e.g., a carpet or blanket) to prevent scratches.
3. Ensure you have enough space for assembly.
4. Keep children and pets away from the assembly area.

Assembly Steps:

Follow the detailed, step-by-step instructions provided in the physical manual included with your product. The general process involves:

- Attaching the headboard and footboard components.
- Connecting the side rails to the headboard and footboard.
- Installing the central support beams and legs.
- Securing the metal slats into their designated slots.



Image 3.1: Illustration demonstrating the correct method for aligning and securing metal pipes into notches during assembly.



Image 3.2: Detail showing L-shaped brackets used to reinforce joints, ensuring enhanced stability of the bed frame.

MULTI-POINT SUPPORT



Sturdy and stable construction with a 363 kg weight bearing capacity



Image 3.3: Visual representation of the bed frame's multi-point support system, highlighting its sturdy construction and 363 kg weight bearing capacity.

EN - Please follow the instruction manuals and use a pad to avoid damage during assembly.
DE - Bitte folgen Sie der Anleitung und verwenden Sie eine Unterlage, um Beschädigungen bei der Montage zu vermeiden.
ES - Por favor, siga las instrucciones del manual y utilice una cubierta o lona para proteger el producto y el suelo durante la instalación.
FR - Suivez les instructions de la notice et utilisez une couverture ou une bâche pour protéger le produit et les sols pendant le montage.
IT - Si prega di consultare il manuale illustrativo durante il montaggio e di utilizzare un cuscinetto per evitare possibili danni.
PL - Należy postępować zgodnie z instrukcjami obsługi i używać podkładki, aby uniknąć uszkodzeń podczas montażu.
NL - Volg de gebruiksaanwijzingen en gebruik een kussen om schade te vermijden tijdens montage.
SE - Följ bruksanvisningarna och använd en dyna för att undvika skador under monteringen.

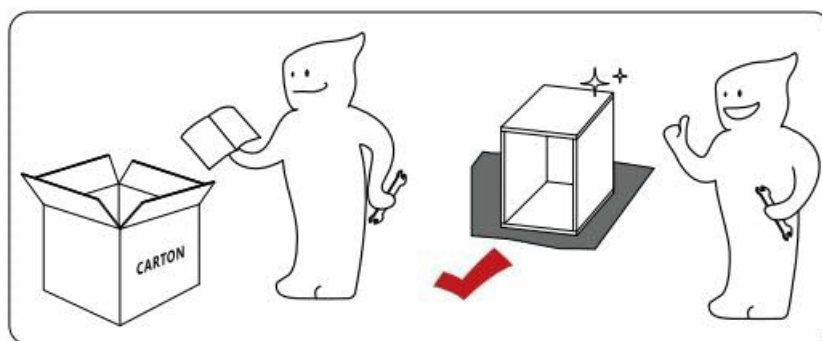
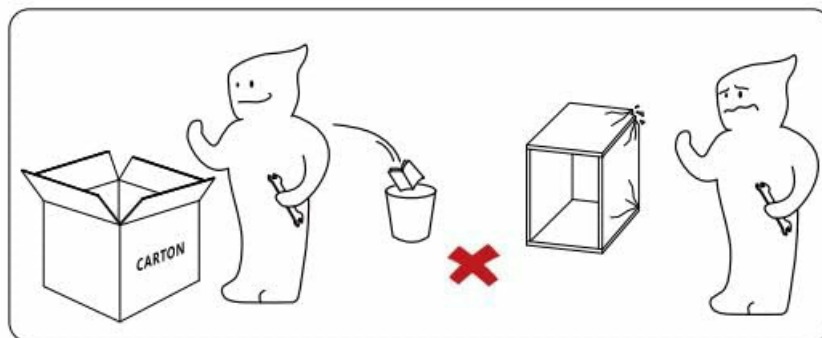

Image 3.4: Guide on proper packaging disposal and a reminder to use a protective pad during assembly to prevent damage.

4. USAGE AND OPERATION

Once assembled, the Yaheetech Double Bed Frame is ready for use. Place your mattress directly onto the metal slats; a box spring is not required.

Key Usage Points:

- **Mattress Placement:** Position your mattress centrally on the slats. The integrated anti-slip baffles are designed to minimize mattress shifting during use.
- **Headboard Functionality:** The high headboard provides a comfortable backrest for reading or relaxing in bed.
- **Under-bed Storage:** Utilize the 32 cm clearance beneath the frame for storing items in bins or baskets, helping to maintain a tidy bedroom environment.



Anti-slip baffles prevent the mattress from moving around

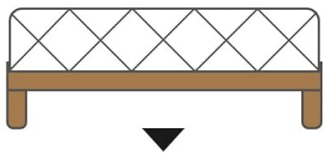

✓ No Significant Sliding

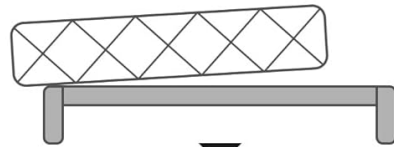

✗ Easy Sliding

Image 4.1: Comparison showing how anti-slip baffles effectively prevent the mattress from sliding, ensuring stability.

Anti-slip baffles prevent the mattress from shifting significantly during use.



Superior metal tubes ensure extended years of use.



Amplified under-bed room maximizes your storage space.



Bottom rubber caps keep your floor away from damage.



Image 4.2: Close-up view of the bed frame's features, highlighting anti-slip baffles, durable metal tubes, ample under-bed storage space (32cm clearance), and protective rubber caps on the feet.

5. MAINTENANCE

To ensure the longevity and appearance of your Yaheetech Double Bed Frame, follow these simple maintenance guidelines:

- **Cleaning:** Wipe the metal frame with a dry, soft cloth. Avoid using harsh chemicals or abrasive cleaners, which can damage the powder-coated finish.
- **Regular Checks:** Periodically check all bolts and screws to ensure they remain tight. Re-tighten if necessary to maintain stability.
- **Foot Caps:** Ensure the rubber foot caps are intact and securely in place to protect your flooring.

6. TROUBLESHOOTING

If you encounter any issues with your bed frame, please refer to the following common solutions:

- **Squeaking Noises:** Squeaking often indicates loose connections. Re-tighten all bolts and screws on the

frame. Ensure slats are properly seated in their holders.

- **Mattress Sliding:** Verify that the anti-slip baffles are correctly installed and positioned. If the mattress still slides, consider using a non-slip mattress pad.
- **Instability/Wobbling:** Check that all frame components are fully engaged and all fasteners are securely tightened. Ensure the bed frame is on a level surface.
- **Missing Parts:** If you find any parts missing upon unboxing, please contact Yaheetech customer support with your purchase details.

7. SPECIFICATIONS

Detailed specifications for the Yaheetech 4ft6 Double Bed Frame:

Feature	Detail
Model Number	MM-00132644-001
Colour	Black
Material	Iron
Finish Type	Powder Coated
Overall Dimensions (L x W x H)	197 cm x 137.5 cm x 106.5 cm
Applicable Mattress Size	4'6 Double (190 cm L x 135 cm W)
Maximum Weight Capacity	363 kg
Slat Spacing	13.5-14.5 cm
Ground Clearance	32 cm
Distance between Headboard and Bedstead	24 cm
Item Weight	19.2 kg
Assembly Required	Yes
Included Components	Headboard, Footboard, Slats, Instruction Manual, Accessory Kit

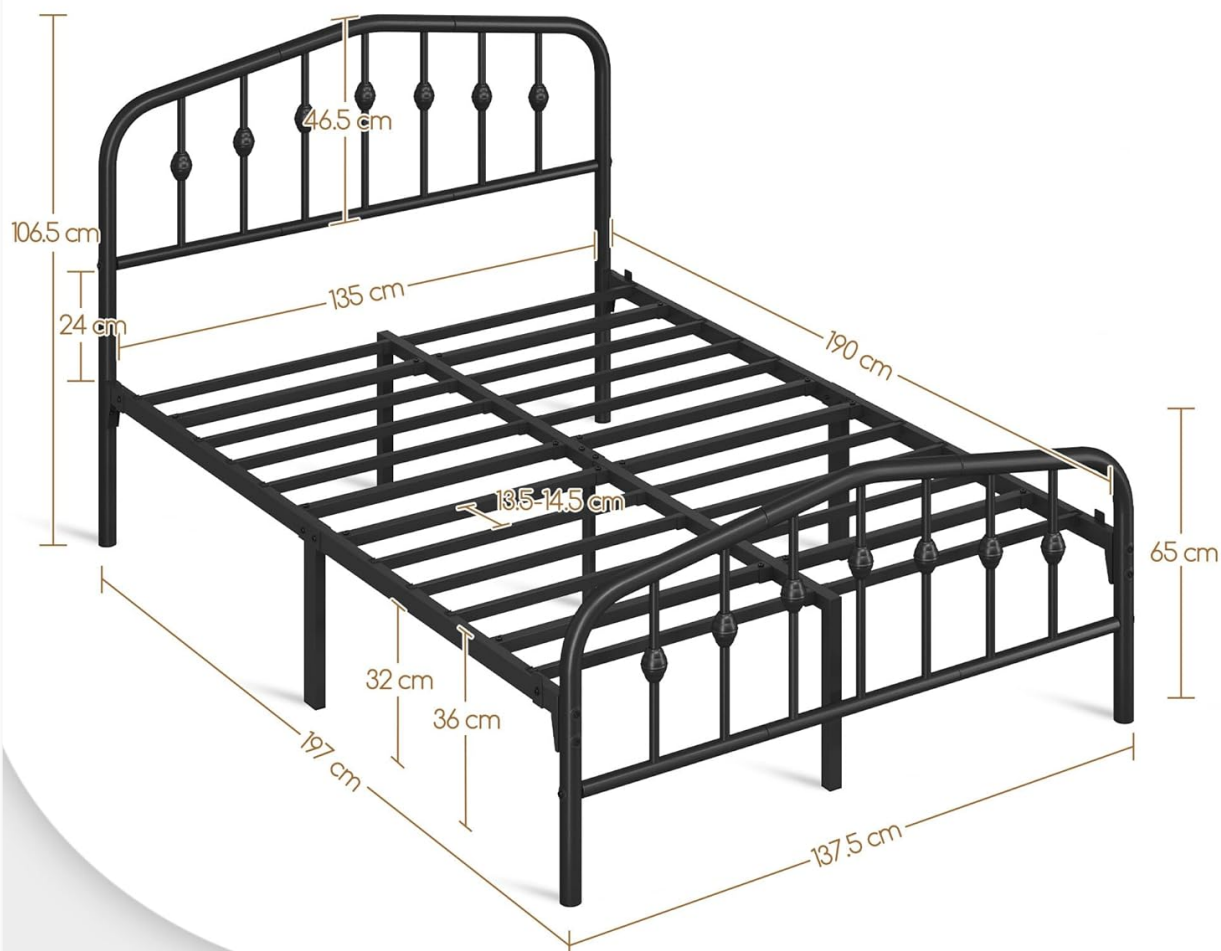

4ft6
Double



Max. Weight
Capacity
363 kg



Applicable
Mattress Size
190cm L × 135cm W

Image 7.1: Detailed dimensions of the bed frame, including overall length, width, height, under-bed clearance, and applicable mattress size.





8. WARRANTY INFORMATION

Specific warranty details for the Yaheetech 4ft6 Double Bed Frame are not provided in the product information. Please refer to your purchase documentation or contact Yaheetech customer support for warranty terms and conditions.

9. CUSTOMER SUPPORT

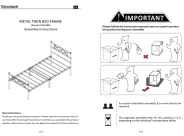
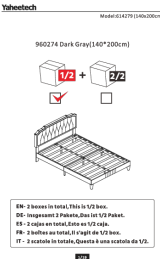
For further assistance, missing parts, or any inquiries regarding your Yaheetech Double Bed Frame, please contact Yaheetech customer service through the retailer where the product was purchased or visit the official Yaheetech website for contact information.

Related Documents - MM-00132644-001

	<p>Yaheetech Metal Twin Bed Frame (Model #591898) Assembly Instructions</p> <p>This document provides assembly instructions for the Yaheetech Metal Twin Bed Frame, Model #591898. It includes a parts list, step-by-step assembly diagrams with textual descriptions, and important safety warnings.</p>
	<p>Yaheetech 614279 Dark Gray 140x200cm Double Bed Frame Assembly Instructions</p> <p>Comprehensive assembly guide for the Yaheetech 614279 (960274) Dark Gray 140x200cm double bed frame. Features a detailed parts list, step-by-step instructions, and important safety precautions.</p>
	<p>Yaheetech Minimalist Metal Platform Bed Assembly Instructions</p> <p>Step-by-step assembly guide for the Yaheetech Minimalist Metal Platform Bed, featuring a detailed parts list, safety warnings, and clear instructions for putting together your bed frame.</p>
	<p>Yaheetech Bed Frame Assembly Instructions</p> <p>Comprehensive assembly guide for the Yaheetech Queen Size Metal Platform Bed with Upholstered Headboard. Includes parts list, step-by-step instructions, and safety information.</p>
	<p>Yaheetech 613629(Full) Bed Frame Assembly Instructions</p> <p>Detailed assembly instructions for the Yaheetech 613629(Full) bed frame, including parts list and step-by-step guidance.</p>

IMPORTANT/WICHTIG/ATENCIÓN
IMPORTANT/IMPORTANTE

- 

1. Read and understand all instructions before assembly.
2. Do not use the bed frame on uneven or soft surfaces.
3. Do not place heavy objects on the bed frame.
- 

4. The bed frame is designed for use on a flat, hard surface.
5. Do not use the bed frame on uneven or soft surfaces.
6. Do not place heavy objects on the bed frame.
- 

7. Do not use the bed frame on uneven or soft surfaces.
8. Do not place heavy objects on the bed frame.
9. Do not use the bed frame on uneven or soft surfaces.
- 

10. Do not use the bed frame on uneven or soft surfaces.
11. Do not place heavy objects on the bed frame.
12. Do not use the bed frame on uneven or soft surfaces.
- 

13. Do not use the bed frame on uneven or soft surfaces.
14. Do not place heavy objects on the bed frame.
15. Do not use the bed frame on uneven or soft surfaces.

100

[Yaheetech Metal Bed Frame Assembly Instructions | Twin Size](#)

Detailed, step-by-step assembly instructions for the Yaheetech metal bed frame. Includes parts list, safety warnings, and assembly guidance.