

Dyson 304619-01

Dyson 360 Vis Nav Robot Vacuum User Manual

Model: 304619-01

1. INTRODUCTION

This manual provides essential information for the safe and efficient operation, maintenance, and troubleshooting of your Dyson 360 Vis Nav Robot Vacuum. Please read these instructions thoroughly before using your device.



Image 1.1: The Dyson 360 Vis Nav Robot Vacuum with its accompanying mobile app interface.

The Dyson 360 Vis Nav is designed for independent cleaning, featuring 360° navigation and powerful suction. It integrates with the MyDyson™ app for comprehensive control and customization of your cleaning experience.

2. SETUP

1. **Unboxing and Placement:** Carefully remove all components from the packaging. Place the docking station against a wall in an open area, ensuring clear space around it for the robot to dock easily.
2. **Charging:** Connect the charger to the docking station and plug it into a power outlet. Place the robot vacuum onto the docking station to charge. Ensure the robot is fully charged before its first use.
3. **MyDyson™ App Connection:**
 - Download the MyDyson™ app from your device's app store.
 - Open the app and follow the on-screen instructions to create an account or log in.

- Select 'Add Machine' and choose your Dyson 360 Vis Nav.
 - Follow the app's prompts to connect your robot to your home Wi-Fi network. Ensure your Wi-Fi password is correct and the robot is within range of your router.
4. **Initial Mapping:** Once connected, the app will guide you through the initial mapping process. This allows the robot to learn your home's layout, identify rooms, and establish cleaning zones.



Image 2.1: The Dyson 360 Vis Nav Robot Vacuum positioned on its docking station for charging.

3. OPERATING INSTRUCTIONS

3.1 Cleaning Modes

The Dyson 360 Vis Nav offers four distinct cleaning modes, selectable via the MyDyson™ app or directly on the robot:

- **Auto Mode:** The robot automatically adjusts suction power based on debris levels detected.
- **Boost Mode:** Provides maximum suction for deep cleaning heavily soiled areas.
- **Quick Mode:** Prioritizes speed for faster cleans, suitable for light debris.
- **Quiet Mode:** Operates at a reduced noise level, ideal for cleaning during quiet hours.

3.2 Navigation and Edge Cleaning

Equipped with 26 sensors and 360° navigation, the robot intelligently maps and navigates your home, avoiding obstacles and reaching under low furniture. An automatic extending side duct ensures thorough cleaning right to the edge of walls, capturing debris that side sweepers might miss.



Avoids obstacles, climbs rugs,
and reaches under low furniture.
All by itself.

Image 3.1: The robot vacuum navigating around furniture, demonstrating its obstacle avoidance capabilities.



Four modes, to clean your way.
Auto, Quick, Boost, and Quiet.

Image 3.2: The robot vacuum cleaning along a wall, showcasing its edge cleaning mechanism.

3.3 MyDyson™ App Features

The MyDyson™ app provides advanced control and customization:

- **Home Mapping:** View and manage detailed maps of your home.
- **Cleaning Zones:** Define specific areas for cleaning and assign different cleaning modes.
- **Scheduling:** Set up automated cleaning schedules for convenience.
- **Avoid Areas:** Designate zones the robot should avoid.
- **Clean Reports:** Access detailed reports on cleaning activity and dust pickup.

Control and customize with the MyDyson™ app

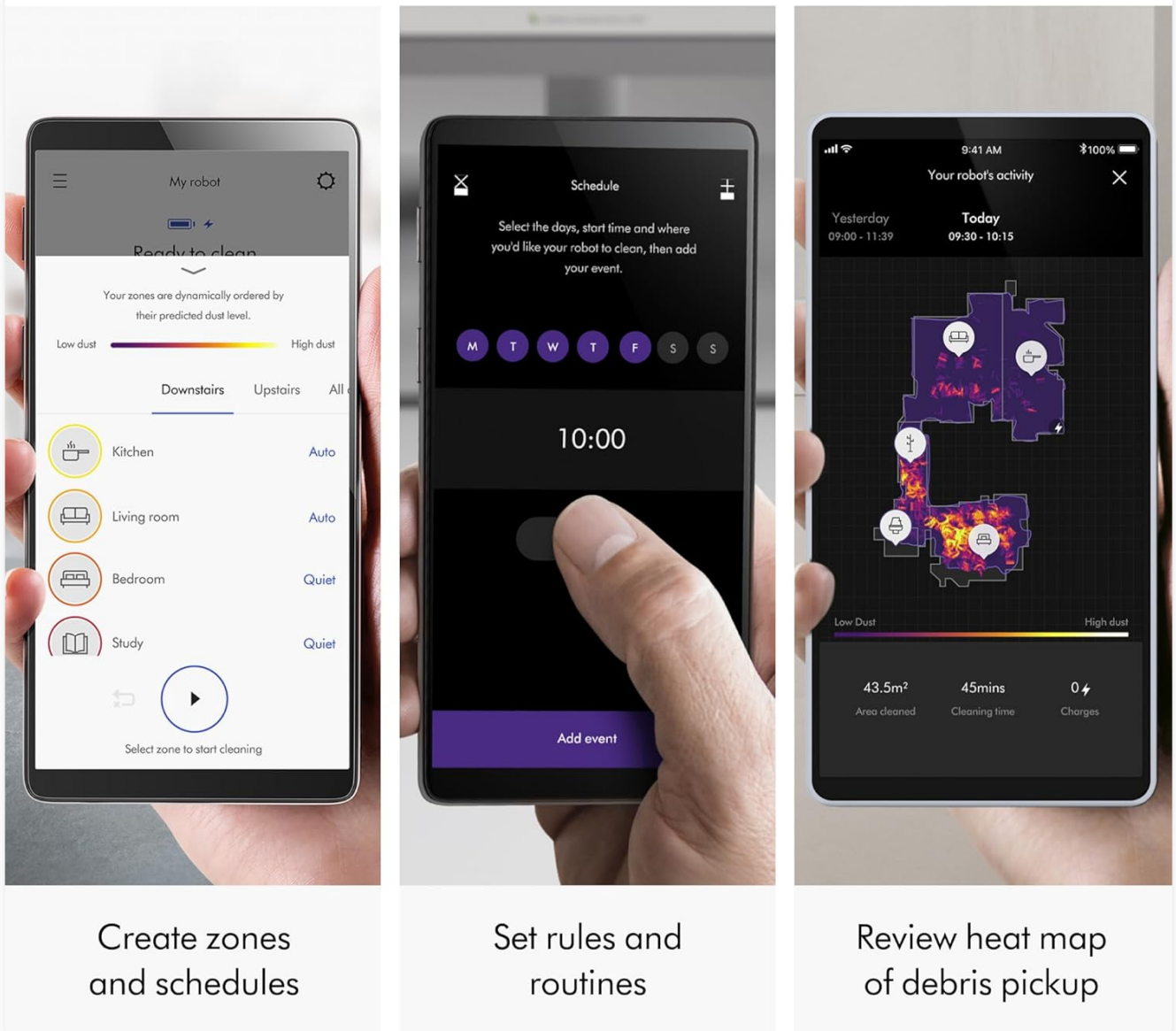

Image 3.3: Screenshots of the MyDyson app showing options for creating zones, setting schedules, and reviewing cleaning activity.

4. MAINTENANCE

Regular maintenance ensures optimal performance of your Dyson 360 Vis Nav Robot Vacuum.

4.1 Emptying the Dust Bin

The dust bin should be emptied regularly, ideally after each cleaning cycle, or when indicated by the robot or app.

1. Press the release button to detach the dust bin from the robot.
2. Open the bin lid and empty the contents into a waste receptacle.
3. Close the lid and reattach the bin to the robot until it clicks into place.

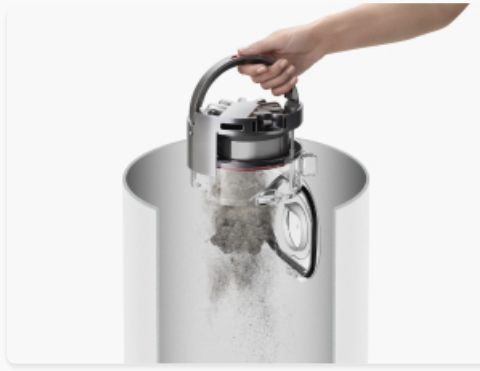

Image 4.1: A hand demonstrating the removal and emptying of the robot vacuum's dust bin.

4.2 Cleaning the Brush Bar

The brush bar should be inspected and cleaned periodically to remove tangled hair and debris.

1. Turn off the robot and place it upside down on a soft surface.
2. Locate the brush bar cover and open it.
3. Remove the brush bar. Use scissors to cut away any tangled hair or threads.
4. Clean the brush bar under running water if necessary, ensuring it is completely dry before reinstallation.
5. Reinsert the brush bar and close the cover securely.



Image 4.2: A hand cleaning the brush bar under running water, illustrating the maintenance process.

4.3 HEPA Filter Maintenance

The whole-machine HEPA filtration system traps 99.99% of particles. The filter is washable and should be cleaned monthly or as indicated by the app.

1. Remove the filter from the dust bin assembly.
2. Tap the filter gently over a bin to remove loose dust.
3. Wash the filter under cold running water until the water runs clear.
4. Allow the filter to air dry completely for at least 24 hours before reinstalling. Do not use a dryer or heat source.

5. TROUBLESHOOTING

If you encounter issues with your Dyson 360 Vis Nav, refer to the following common solutions:

- **Robot Not Connecting to Wi-Fi/App:**
 - Ensure your Wi-Fi network is 2.4GHz (5GHz networks may not be supported by all devices).
 - Verify your Wi-Fi password is correct.
 - Move the robot closer to your Wi-Fi router.

- Restart your Wi-Fi router and the robot vacuum.
- If issues persist, try removing the robot from the MyDyson app and re-adding it.
- **Robot Not Cleaning/Powering Off:**
 - Check if the battery is sufficiently charged. Return the robot to its docking station.
 - Ensure the dust bin is not full and the brush bar is free of obstructions.
 - Check for any error messages on the robot's display or in the MyDyson app.
 - Perform a soft reset by holding down the power button for 10 seconds.
- **Robot Getting Stuck Frequently:**
 - Clear small obstacles, loose cables, or thick rugs from the cleaning path.
 - Use the MyDyson app to define 'avoid areas' for problematic spots.
 - Ensure the robot's sensors are clean and free from dust or debris.

For further assistance, consult the MyDyson app for specific alerts and troubleshooting guides, or contact Dyson customer support.

6. SPECIFICATIONS

Feature	Specification
Brand	Dyson
Model Name	Dyson 360 Vis Nav
Model Number	304619-01
UPC	885609020747
Product Dimensions	13"L x 12.6"W x 3.9"H
Item Weight	16.81 pounds
Filter Type	HEPA Filter
Battery Life	Up to 65 minutes
Voltage	21.6 Volts
Capacity	0.13 Gallons
Power Source	Battery Powered
Special Features	App controlled, Automated, Cordless, High-precision sensors, Programmable
Included Components	Brushbar x1, Docking station, Charger, Dyson VisNav Robot Vacuum

7. WARRANTY AND SUPPORT

Your Dyson 360 Vis Nav Robot Vacuum comes with a **2-year warranty**, covering parts and labor for defects in materials and workmanship from the date of purchase. Dyson also provides lifetime support for your product. For warranty claims, technical assistance, or general inquiries, please:

- Refer to the MyDyson™ app for maintenance alerts and automatic software updates.
- Visit the official Dyson support website for FAQs and contact information.
- Contact Dyson customer service directly.

© 2024 Dyson. All rights reserved.

Related Documents - 304619-01

<div data-bbox="124 656 296 786"> <p>dyson 360 visnav</p> <p>Bedienungsanleitung</p> </div> <div data-bbox="124 848 296 911"> <p>Inhalt</p> <ul style="list-style-type: none"> Eine Seite Herunterladen der MyDyson™ App Anleitung zur ersten Einrichtung Zusätzliche Benutzersachverständnisse Sprachenwechsel Veränderung der Reinigungsschritte Reinigungsplan erstellen Werte für die Zone und andere Zonen in einer Zone festlegen Reinigungspläne planen und überprüfen Planen von Reinigungszeiten Tastaturliste lesen Für weitere Informationen Besondere Hinweise Warnhinweise und Sicherheitshinweise Technische Daten und Abmessungen </div>	<h2>Dyson 360 Vis Nav™ Saugroboter: Bedienungsanleitung</h2> <p>Umfassende Bedienungsanleitung für den Dyson 360 Vis Nav™ Saugroboter. Erfahren Sie, wie Sie das Gerät einrichten, reinigen, warten und Fehler beheben.</p>
<div data-bbox="124 969 296 1099"> <p>dyson 360 visnav</p> <p>User manual</p> </div> <div data-bbox="124 1162 296 1225"> <p>Contents</p> <ul style="list-style-type: none"> Getting started Downloading the MyDyson™ app Connecting to Wi-Fi Defining the large area Repeating the process Setting up zones Mapping your home Creating your home Scheduling and reviewing cleanings Loading after your robot vacuums Emptying your bin Changing your filter Maintaining your brush bar Cleaning your sensors lens and sensor Resetting your robot Restarting and upgrading software </div>	<h2>Dyson 360 Vis Nav Robot Vacuum User Manual</h2> <p>User manual for the Dyson 360 Vis Nav robot vacuum, covering setup, operation, maintenance, and troubleshooting.</p>
<div data-bbox="124 1283 296 1552"> <p>myRobotCENTER</p> <p>The expert for robots in your home</p> <p>With one click to the online shop</p> <p>myRobotcenter</p> </div>	<h2>Dyson 360 Eye Robot Vacuum Cleaner User Manual</h2> <p>Comprehensive user manual for the Dyson 360 Eye robot vacuum cleaner, covering setup, operation, maintenance, troubleshooting, and safety instructions. It is designed for household use and helps users optimize the robot's performance.</p>
<div data-bbox="124 1597 296 1727"> <p>dyson 360 visnav</p> <p>User manual</p> </div> <div data-bbox="124 1789 296 1852"> <p>Contents</p> <ul style="list-style-type: none"> Getting started Downloading the MyDyson™ app Connecting to Wi-Fi Defining the large area Repeating the process Setting up zones Mapping your home Creating your home Scheduling and reviewing cleanings Loading after your robot vacuums Emptying your bin Changing your filter Maintaining your brush bar Cleaning your sensors lens and sensor Resetting your robot Restarting and upgrading software </div>	<h2>Dyson 360 VisNav Robot Vacuum User Manual Setup, Cleaning & Maintenance</h2> <p>Comprehensive user manual for the Dyson 360 VisNav robot vacuum. Learn how to set up, connect to the MyDyson app, clean, maintain, and troubleshoot your robot for optimal performance.</p>

