

## Luqeeq Luqeeqbupzxet1rs

# Luqeeq Digital Door Viewer User Manual

Model: Luqeeqbupzxet1rs

## 1. INTRODUCTION

---

This manual provides detailed instructions for the installation, operation, and maintenance of your Luqeeq Digital Door Viewer. Please read this manual thoroughly before using the product to ensure proper function and safety. Keep this manual for future reference.

## 2. PRODUCT FEATURES

---

- **2.4-inch LCD Display:** Provides a clear and vivid view of visitors at your door.
- **0.3MP Professional Camera:** Captures crisp images for easy identification, even in low light conditions.
- **120° Wide-Angle Lens:** Offers a broad view of your doorstep, minimizing blind spots and enhancing security.
- **Durable Zinc Alloy Construction:** Engineered for superior wear resistance and impact strength, preventing prying and smashing.
- **Dual Power Supply:** Operates using either 3 x 1.5V AAA batteries (not included) or a 5V 1A USB power source for continuous operation.
- **Automatic Display Activation:** The screen automatically displays the outside view when the doorbell is pressed, providing convenience for all users.

## 3. PACKAGE CONTENTS

---

Verify that all items are present in the package:

- 1 x Digital Door Viewer Camera Unit
- 1 x Digital Door Viewer Monitor Unit
- 1 x Accessory Kit (includes 2 x Washers, 8 x Screws)
- 1 x User Manual

Note: AAA batteries and a small memory card are not included and must be purchased separately.

## 4. PRODUCT OVERVIEW

---

Familiarize yourself with the components of your Luqeeq Digital Door Viewer.

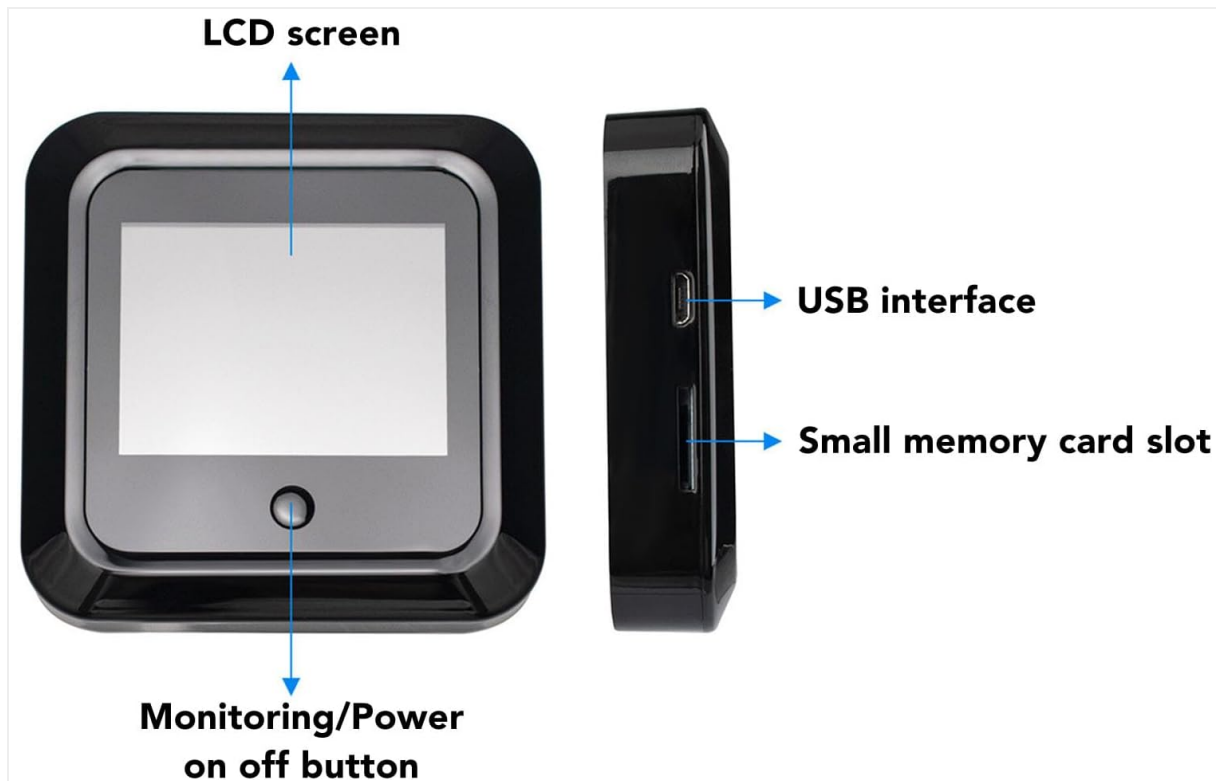

Figure 4.1: Monitor Unit Components

- **LCD Screen:** Displays the live view from the camera.
- **Monitoring/Power On/Off Button:** Press to activate the screen or power the device on/off.
- **USB Interface:** For connecting a 5V 1A USB power source.
- **Small Memory Card Slot:** Insert a memory card (not included) for potential recording features (if supported by firmware).



Figure 4.2: Monitor Unit Rear View (Battery Compartment)

- **Battery Compartment:** Houses 3 x AAA batteries (not included).

## 5. INSTALLATION GUIDE

---

The Luqeeq Digital Door Viewer is designed for simple installation, fitting standard door peephole holes without requiring special tools.

### 5.1 Preparation

- Ensure your door has an existing peephole or a suitable hole for installation.
- Gather necessary components: Camera unit, Monitor unit, washers, and screws.
- Prepare 3 x AAA batteries (not included) or a 5V 1A USB power source.

### 5.2 Installation Steps

Peace of mind for every generation



**Safer for Everyone in Your Home**



**24/7 Customer Support**



**Quality Guaranteed**



**Easy Returns**

**Luqeeq: Bringing smart security to every home**



**Contact/Support**  
Availability info // Info

Figure 5.1: Installation Overview

**1. Step 1: Remove Existing Peephole (if applicable)**

Carefully unscrew and remove any existing traditional peephole from your door.

**2. Step 2: Insert Camera Unit**

From the outside of the door, insert the camera unit through the peephole hole. Ensure the camera is facing outwards and is flush with the door surface.

**3. Step 3: Secure Monitor Unit**

From the inside of the door, connect the cable from the camera unit to the monitor unit. Align the monitor unit with the camera unit and secure it to the door using the provided screws and washers. Ensure the monitor is firmly attached and stable.

### 5.3 Powering the Device

- **Battery Power:** Open the battery compartment on the back of the monitor unit and insert 3 x AAA batteries, observing correct polarity.
- **USB Power:** Connect a 5V 1A USB power adapter (not included) to the USB interface on the side of the monitor unit. This can serve as a backup or primary power source.

## 6. OPERATING INSTRUCTIONS

---

## 6.1 Powering On/Off

- **To Power On:** Press and hold the Monitoring/Power On/Off button located below the LCD screen until the screen illuminates.
- **To Power Off:** Press and hold the Monitoring/Power On/Off button until the screen turns off.

## 6.2 Viewing Visitors

- **Manual View:** Press the Monitoring/Power On/Off button once to activate the screen and view the outside area. The screen will automatically turn off after a short period of inactivity to conserve power.
- **Automatic View:** When someone presses your doorbell (if connected and compatible, or if the device detects motion/sound, depending on model features), the screen will automatically activate and display the outside view.



# Know Who's at Your Door Before Opening

2.4" Digital Viewer • 120° Wide Angle • Zinc Alloy Security

Figure 6.1: Viewing a Visitor

## 6.3 Memory Card Usage (Optional)

If your model supports recording and you have inserted a small memory card into the slot:

- Refer to the on-screen menu or additional documentation for specific instructions on how to initiate recording, view playback, or manage stored footage.

## 7. MAINTENANCE

---

- **Cleaning:** Use a soft, dry cloth to clean the screen and camera lens. Avoid abrasive cleaners or solvents.
- **Battery Replacement:** When the battery indicator shows low power, replace all 3 AAA batteries simultaneously. Do not mix old and new batteries.
- **Environmental Conditions:** Ensure the device is not exposed to extreme temperatures, direct sunlight for prolonged periods, or excessive moisture.

## 8. TROUBLESHOOTING

---

Problem	Possible Cause	Solution
Device does not power on.	Low or dead batteries. Incorrect battery polarity. USB power not connected or faulty.	Replace batteries with new ones, ensuring correct polarity. Check USB cable and power adapter connection.
Screen is blank or blurry.	Camera lens is dirty. Poor connection between camera and monitor. Insufficient lighting outside.	Clean the camera lens with a soft cloth. Ensure the camera and monitor cables are securely connected. The device performs best in adequate lighting.
No image when doorbell is pressed.	Doorbell not connected or incompatible. Device settings.	Verify doorbell connection and compatibility with the digital viewer. Check device settings for automatic activation options.
Image quality is poor compared to expectations.	Environmental factors (e.g., glare, extreme darkness). Camera lens obstruction.	Ensure the camera lens is clean and unobstructed. Image quality may vary based on external lighting conditions.

## 9. SPECIFICATIONS

---

Feature	Detail
Model Number	Luqeeqbupzxet1rs
Display Size	2.4 inches
Camera Resolution	0.3 Megapixels
Viewing Angle	120 degrees
Construction Material	Zinc Alloy
Power Supply	3 x 1.5V AAA Batteries (not included) or 5V 1A USB
Item Weight	8.1 ounces
Package Dimensions	7.87 x 4.72 x 1.97 inches

Feature	Detail
Included Components	1 x Camera, 1 x Monitor, 1 x Accessory Kit (2 x Washers, 8 x Screws), 1 x Manual

## 10. SUPPORT

---

For any questions, technical assistance, or support regarding your Luqeeq Digital Door Viewer, please refer to the contact information provided with your purchase or visit the official Luqeeq website. Our customer support team is available to assist you.