

combier CMA102

Combier CMA102 Bidet Toilet Seat User Manual

Model: CMA102 | Brand: Combier

1. INTRODUCTION AND PRODUCT OVERVIEW

The Combier CMA102 Bidet Toilet Seat is an advanced electronic bidet designed to enhance personal hygiene and comfort. This elongated smart bidet features unlimited warm water, a vortex wash system, electronic heating, a warm air dryer, and dedicated rear and front wash functions. It is equipped with a stainless steel nozzle for optimal hygiene and offers customizable settings for a personalized experience.



Figure 1: Top-down view of the CombiER CMA102 Bidet Toilet Seat.

2. SAFETY INFORMATION

Please read all instructions carefully before installation and use. Failure to follow these instructions may result in property damage or personal injury.

- Always shut off the water supply to the toilet before beginning any installation or maintenance.
- Ensure the electrical outlet is a grounded GFCI outlet and is located within reach of the bidet's power cord.
- Do not immerse the bidet seat or its electrical components in water.
- Do not attempt to repair or modify the unit yourself. Contact qualified service personnel for assistance.

- Keep the bidet seat away from open flames or excessive heat sources.

3. PACKAGE CONTENTS

Upon unboxing your Combier CMA102 Bidet Toilet Seat, please verify that all components are present:

- Combier CMA102 Bidet Toilet Seat Unit
- Mounting Plate
- T-Valve (for water supply connection)
- PE Pipe (bidet water supply hose)
- Screws and Washers for mounting
- Anchoring Rubber / Grommets
- Installation Manual (this document)
- Basic Tools (screwdriver, crescent wrench, cloth - user provided)

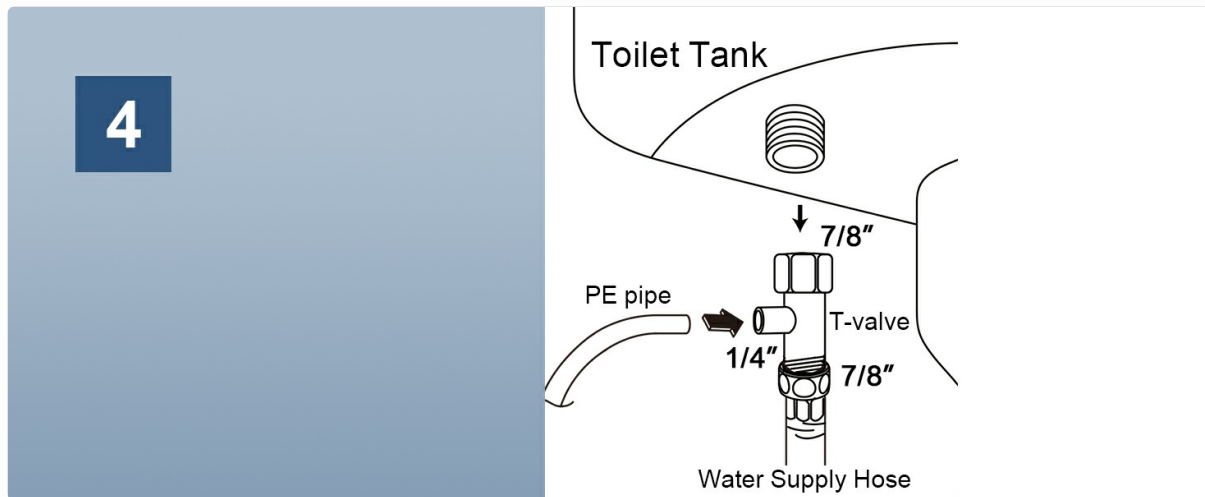

Figure 2: Included components for installation.

4. SPECIFICATIONS

Feature	Description
Model Number	CMA102
Shape	Elongated
Color	White
Material	Acrylonitrile Butadiene Styrene (ABS)
Product Dimensions	20"L x 18.1"W
Item Weight	11 Pounds

Operation Mode	Automatic
Water Heating	Hybrid Heating Technology (Unlimited Warm Water), 3 Temperature Settings
Seat Heating	3 Temperature Settings
Water Pressure	3 Settings
Air Dryer	Warm Air Dryer, 3 Levels
Nozzle Type	Stainless Steel, Self-Cleaning
Wash Functions	Rear Wash, Front Wash, Oscillating Wash, Vortex Wash
Nightlight	Illuminating Blue LED
Energy Saving	Eco-Friendly Mode

BIDET TOILET SEAT FIT CHECK

Our products are suitable for the following sizes, please check carefully before purchase

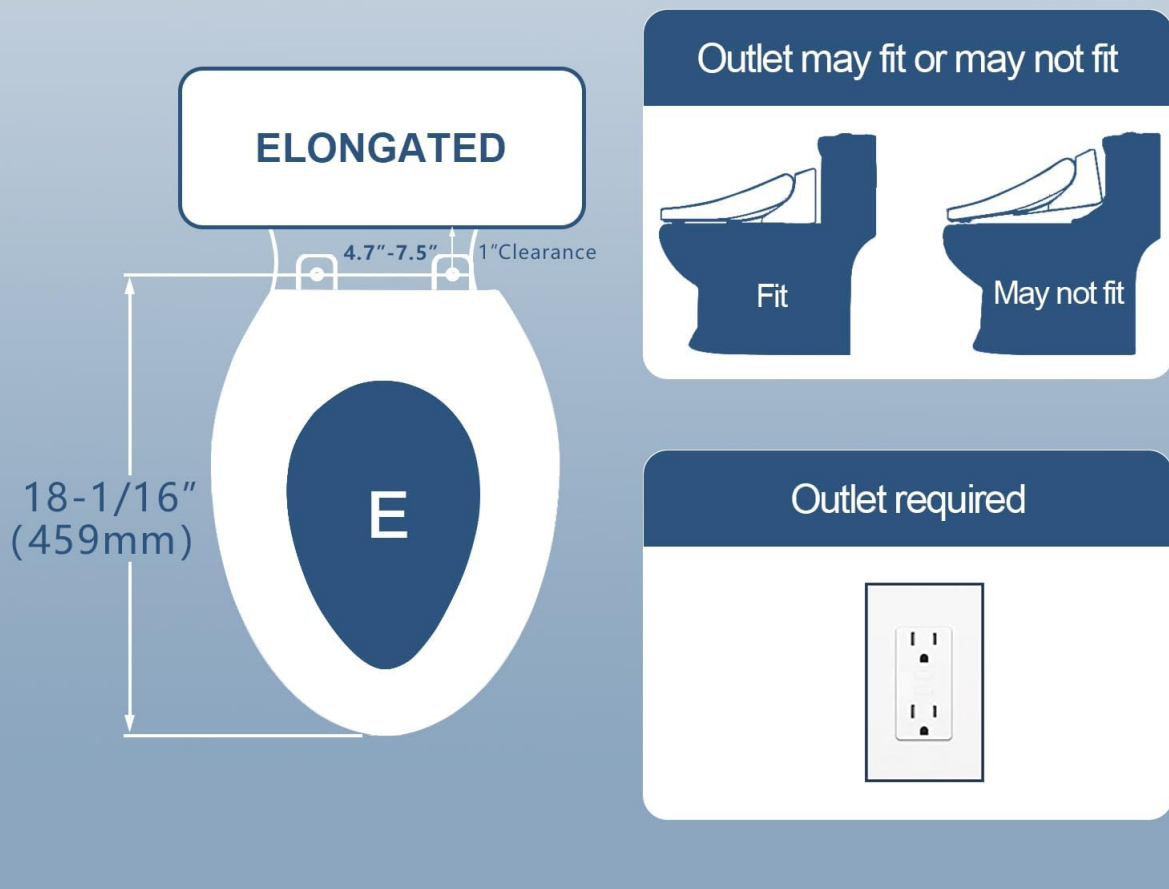

Figure 3: Bidet Toilet Seat Fit Check and electrical outlet requirement.

5. INSTALLATION GUIDE

This section provides step-by-step instructions for installing your Combiert CMA102 Bidet Toilet Seat. For a visual guide, please refer to the installation video below.

Your browser does not support the video tag.

Video 1: Combiert CMA102 Bidet Toilet Seat Installation Guide. This video demonstrates the complete installation process, from unboxing to final setup and testing of basic functions.

Required Tools:

- Cloth (for water spills)
- Crescent Wrench (or appropriately sized wrenches)
- Screwdriver (flathead or Phillips)

Installation Steps:

1. **Prepare the Toilet:** Locate the water supply valve for your toilet and turn it off completely. Flush the toilet to drain most of the water from the tank.
2. **Disconnect Water Supply:** Use a crescent wrench to disconnect the existing water supply hose from the bottom of the toilet tank. Have a cloth ready to catch any residual water.
3. **Install T-Valve:** Thread the provided T-valve onto the bottom of the toilet tank where the original hose was connected. Ensure it is hand-tightened, then use the wrench for a final snug fit.
4. **Reconnect Water Supply Hose:** Attach the original water supply hose to the bottom of the newly installed T-valve. Tighten securely with the wrench.
5. **Prepare Mounting Plate:** Detach the mounting plate from the underside of the bidet toilet seat unit.
6. **Insert Grommets:** Place the provided rubber grommets into the two holes on the toilet bowl where the seat bolts normally go. You may need to wet them slightly to ease insertion.
7. **Position Mounting Plate:** Place the mounting plate over the grommets, aligning the holes. Insert the metal locking pieces into the plate to secure it.
8. **Secure Mounting Plate:** Insert the screws and washers through the mounting plate and into the grommets. Tighten them with a screwdriver to firmly secure the plate to the toilet bowl.
9. **Attach Bidet Seat:** Carefully slide the bidet toilet seat unit onto the secured mounting plate until it clicks into place. Ensure it is properly aligned and stable. If adjustment is needed, press the release button located under the water connector on the bidet and slide the seat to reposition the plate.
10. **Connect Bidet Water Supply:** Connect the white PE pipe (bidet water supply hose) to the side port of the T-valve and to the corresponding inlet on the bidet seat. This is a press-fit connection; ensure it is pushed in all the way to the black mark for a secure seal.
11. **Connect Power:** Plug the bidet's power cord into a grounded electrical outlet.
12. **Restore Water Supply:** Slowly turn the main water supply valve back on. Check for any leaks at all connection points.

6. OPERATING INSTRUCTIONS

The Combiar CMA102 Bidet Toilet Seat features an intuitive side control panel. Many functions require the skin sensor on the seat to be activated (i.e., a user must be seated) for safety and proper operation.

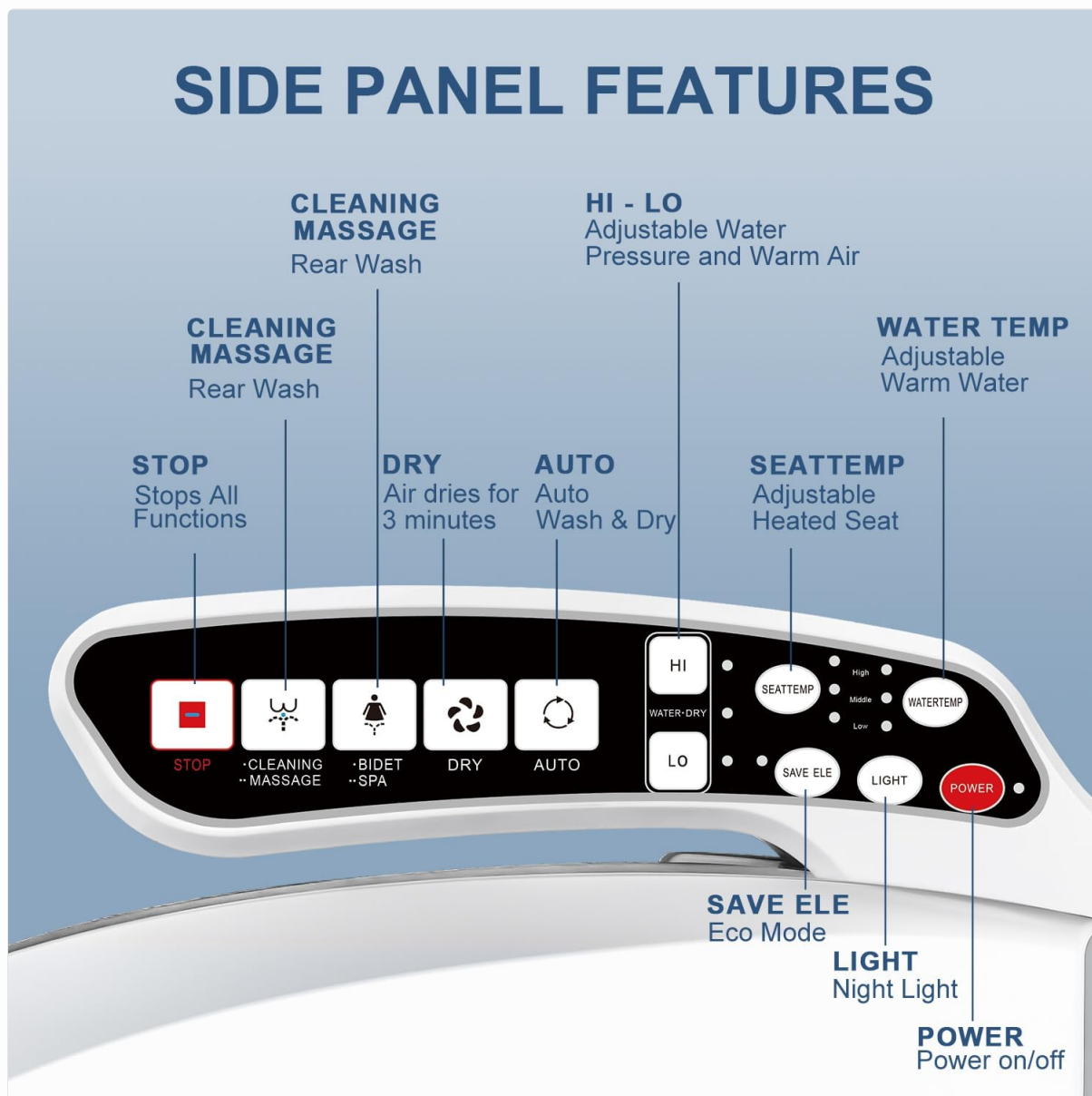

Figure 4: Side Control Panel Features.

Control Panel Functions:

- **POWER**: Turns the unit on or off.
- **LIGHT**: Activates or deactivates the illuminating blue LED nightlight inside the bowl.
- **SAVE ELE (Eco Mode)**: Engages energy-saving mode, which reduces power consumption by adjusting heating elements.
- **WATER TEMP**: Cycles through 3 water temperature settings (Low, Medium, High) or turns heating off for unheated water.
- **SEAT TEMP**: Cycles through 3 heated seat temperature settings (Low, Medium, High) or turns heating off.
- **WATER DRY (HI/LO)**: Adjusts the intensity of the warm air dryer (High, Medium, Low). This function is active when the DRY button is pressed.

- **AUTO:** Initiates an automatic wash and dry cycle.
- **DRY:** Activates the warm air dryer for approximately 3 minutes.
- **BIDET / SPA:** Activates the front (feminine) wash function. Pressing again may engage a spa or oscillating mode. The nozzle performs a self-cleaning cycle before and after use.
- **CLEANING / MASSAGE:** Activates the rear wash function. Pressing again may engage a massage or oscillating mode. The nozzle performs a self-cleaning cycle before and after use.
- **STOP:** Stops all active functions.

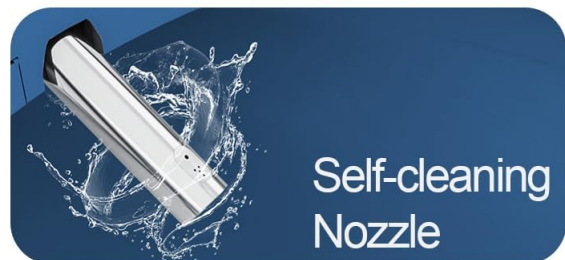
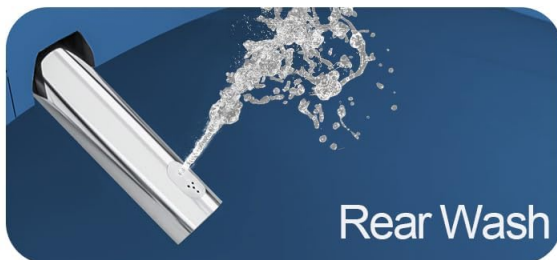

Figure 5: Multiple Nozzle Cleaning Modes.



Figure 6: Adjustable temperature settings for air, seat, and water, along with the night light feature.

7. MAINTENANCE

Regular cleaning and maintenance will ensure the longevity and optimal performance of your bidet toilet seat.

Cleaning the Unit:

- Always unplug the unit and turn off the water supply before cleaning.
- Use a soft, damp cloth and a mild, non-abrasive cleaner to wipe down the exterior surfaces.
- Do not use harsh chemicals, abrasive pads, or solvents, as these can damage the finish.

Nozzle Cleaning:

The stainless steel nozzle features an automatic self-cleaning function before and after each use. For additional cleaning:

- While the unit is powered on, gently pull the nozzle out manually (if accessible) or activate a wash cycle to extend it.

- Carefully wipe the nozzle with a soft cloth or toothbrush and mild soap.
- Do not use excessive force or harsh cleaning agents on the nozzle.

8. TROUBLESHOOTING

If you encounter any issues with your Combier CMA102 Bidet Toilet Seat, please refer to the following common troubleshooting steps:

Problem	Possible Cause	Solution
No power / Unit not turning on	Power cord unplugged, circuit breaker tripped, unit in Eco Mode.	Ensure power cord is securely plugged in. Check and reset circuit breaker if necessary. Press POWER button to exit Eco Mode.
No water spray / Weak spray	Water supply valve closed, nozzle clogged, low water pressure, skin sensor not activated.	Ensure water supply valve is fully open. Clean the nozzle if visibly clogged. Verify adequate household water pressure. Ensure you are properly seated to activate the skin sensor.
Water temperature not warm	Water heating off, unit in Eco Mode.	Adjust WATER TEMP setting to desired level. Disable Eco Mode if necessary.
Heated seat not working	Seat heating off, unit in Eco Mode.	Adjust SEAT TEMP setting to desired level. Disable Eco Mode if necessary.
Air dryer not working	Dryer off, skin sensor not activated.	Press DRY button. Ensure you are properly seated to activate the skin sensor.
Leaks from connections	Loose connections, improper sealing.	Turn off water supply. Tighten all connections (T-valve, hoses). Ensure washers are correctly seated.

If the problem persists after attempting these solutions, please contact Combier customer support for further assistance.

9. WARRANTY AND SUPPORT

The Combier CMA102 Bidet Toilet Seat is covered by the manufacturer's standard warranty. Please refer to the warranty card included with your product for specific terms and conditions, including warranty period and coverage details.

For technical support, troubleshooting beyond this manual, or warranty claims, please contact Combier customer service through the contact information provided on your product packaging or the official Combier website.

Additional resources, including PDF versions of the Installation Manual and Instructions for Use, may be available online:

- [Installation Manual \(PDF\)](#)
- [Instructions for Use \(IFU\) \(PDF\)](#)

© 2024 Combier. All rights reserved.