

## PINKCAT 1136

# PINKCAT Rechargeable Wireless Keyboard and Mouse Combo User Manual

Model: 1136

## 1. INTRODUCTION

This manual provides detailed instructions for the setup, operation, and maintenance of your PINKCAT Rechargeable Wireless Keyboard and Mouse Combo. This 2.4G wireless set offers a compact design, round keys, and silent operation for an enhanced user experience across various devices.



Image 1.1: The PINKCAT wireless keyboard and mouse combo, including the USB receiver.

## 2. PACKAGE CONTENTS

Please verify that all items are present in your package:

- Wireless Keyboard
- Wireless Mouse

- USB Nano Receiver (stored inside the mouse)
- USB Type-C Charging Cable
- User Manual (this document)

### 3. PRODUCT OVERVIEW

The PINKCAT wireless combo features a sleek design with practical functionalities.

#### 3.1 Key Features

- **2.4G Wireless Connection:** Provides a stable connection up to 33 feet (10 meters).
- **Rechargeable Batteries:** Built-in lithium polymer batteries for both keyboard and mouse.
- **Ultra-Thin Design:** Compact and portable for various environments.
- **Round Scissor Keys:** Offers a comfortable and responsive typing experience with reduced noise.
- **Silent Mouse:** Designed for quiet operation.
- **Ergonomic Angle:** Keyboard features an 8-degree tilt for wrist comfort.
- **Auto Power Saving:** Devices enter sleep mode after 8 minutes of inactivity to conserve battery.

#### 3.2 Component Identification

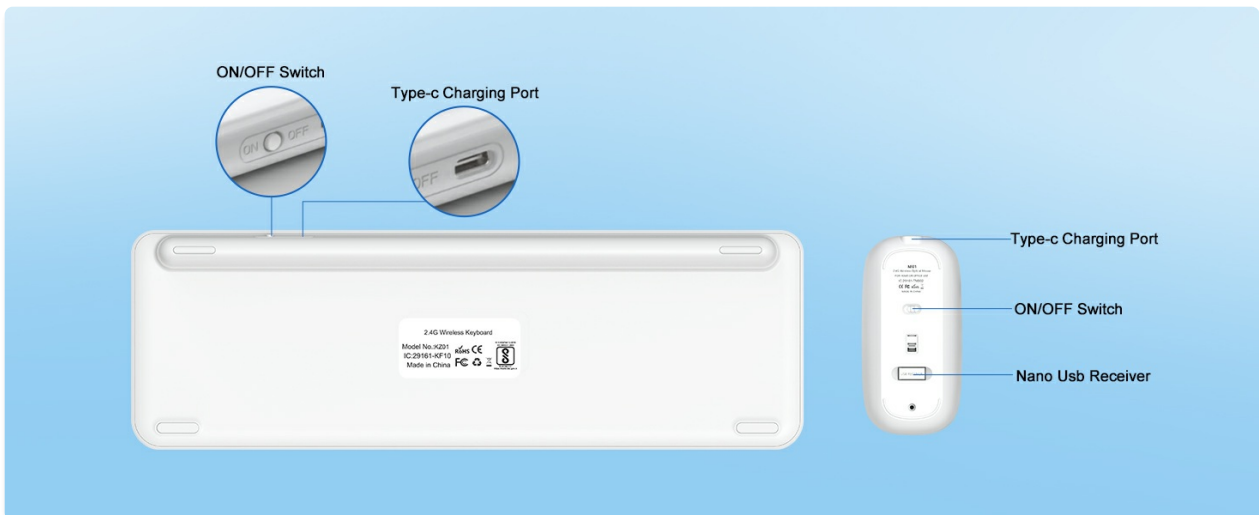

Image 3.1: Keyboard indicators (Number, Caps, Power) and mouse buttons (Advanced Wheel, DPI Adjustment).

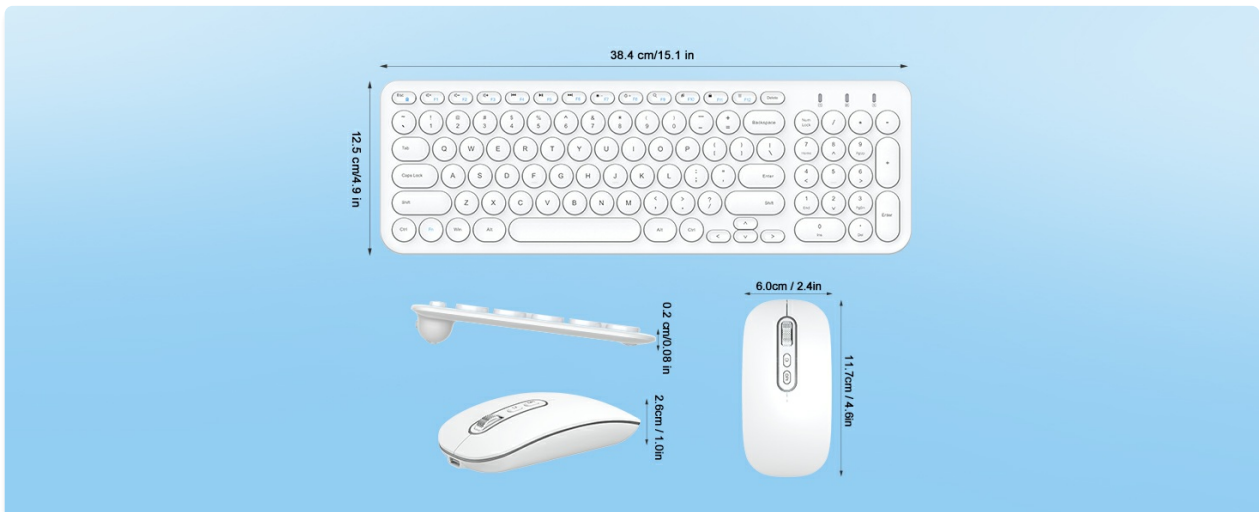

Image 3.2: Location of ON/OFF switches, Type-C charging ports, and USB receiver storage.

## 4. SETUP INSTRUCTIONS

### 4.1 Charging the Devices

Before first use, fully charge both the keyboard and mouse.

1. Connect the provided USB Type-C charging cable to the charging port on the keyboard and mouse.
2. Connect the other end of the cable to a USB power source (e.g., computer USB port, USB wall adapter).
3. The power indicator light will illuminate during charging and turn off when fully charged. A full charge typically takes about 1.5 hours.



Image 4.1: Keyboard and mouse connected for charging via Type-C cables.

### 4.2 Connecting the USB Receiver

1. Locate the USB Nano Receiver, which is stored in a compartment on the underside of the mouse.
2. Plug the USB Nano Receiver into an available USB port on your computer or compatible device.
3. Turn on the keyboard and mouse using their respective ON/OFF switches located on the underside of each device.
4. The devices should connect automatically. No additional drivers are typically required.



Image 4.2: USB Nano Receiver plugged into a laptop's USB port.

## 5. OPERATING INSTRUCTIONS

### 5.1 Keyboard Functions

The keyboard features standard QWERTY layout and multimedia function keys.

- **Function Keys (F1-F12):** These keys have dual functions. Pressing them directly performs their standard F-key action. To access multimedia or special functions (e.g., volume control, media playback), press and hold the **Fn** key simultaneously with the desired F-key.
- **Number Pad:** The integrated number pad allows for efficient data entry. Ensure Num Lock is active if numbers are not registering.
- **Indicators:** The keyboard has LED indicators for Num Lock, Caps Lock, and Power/Battery status.

# Ergonomic Design

8 tilted angle helps release wrist pressure, key structure of scissor keyboard more stable.



Non-slip pad



Image 5.1: Ergonomic design of the keyboard with an 8-degree tilt.

## 5.2 Mouse Functions

- **Left/Right Click:** Standard mouse buttons.
- **Scroll Wheel:** For vertical scrolling.
- **DPI Adjustment Button:** Located near the scroll wheel, this button allows you to cycle through different DPI (Dots Per Inch) settings to adjust cursor sensitivity. Press the button to change the DPI level.

## 6. MAINTENANCE

### 6.1 Cleaning

- Turn off both the keyboard and mouse before cleaning.
- Use a soft, lint-free cloth slightly dampened with water or a mild cleaning solution. Avoid harsh chemicals.
- For the keyboard, use compressed air to remove debris from between the keys.

### 6.2 Battery Care

- Recharge the devices when the battery indicator light flashes or when performance degrades.

- Avoid fully discharging the batteries frequently to prolong their lifespan.
- If storing the devices for an extended period, charge them to about 50% and turn them off. Recharge every few months to prevent deep discharge.

## 7. TROUBLESHOOTING

If you encounter issues, please refer to the following common solutions:

Problem	Possible Solution
Keyboard/Mouse not responding	<ul style="list-style-type: none"> <li>◦ Ensure both devices are turned ON.</li> <li>◦ Check if the USB receiver is securely plugged into a working USB port. Try a different port.</li> <li>◦ Recharge the keyboard and mouse. Low battery can cause connection issues.</li> <li>◦ Move the devices closer to the USB receiver to rule out range issues.</li> <li>◦ Restart your computer.</li> </ul>
Connection frequently drops	<ul style="list-style-type: none"> <li>◦ Ensure there are no large metal objects or other wireless devices (e.g., Wi-Fi routers, other 2.4GHz devices) causing interference between the devices and the receiver.</li> <li>◦ Keep the receiver in a clear line of sight if possible.</li> <li>◦ Check battery levels and recharge if necessary.</li> </ul>
Keys not typing or mouse not moving	<ul style="list-style-type: none"> <li>◦ Verify the device is turned on and charged.</li> <li>◦ For the keyboard, ensure Caps Lock/Num Lock indicators are functioning as expected.</li> <li>◦ For the mouse, ensure the optical sensor on the bottom is clean and unobstructed.</li> </ul>
DPI button not changing sensitivity	<ul style="list-style-type: none"> <li>◦ Ensure the mouse is powered on and connected.</li> <li>◦ Some operating systems allow for additional mouse pointer speed adjustments in system settings. Check your OS settings if the physical button changes are insufficient.</li> </ul>

## 8. SPECIFICATIONS

Detailed technical specifications for the PINKCAT Wireless Keyboard and Mouse Combo:

- **Brand:** PINKCAT
- **Model Number:** 1136
- **Connectivity:** 2.4G Wireless
- **Operating System Compatibility:** Windows XP/Vista/7/8/10, Mac OS, Chrome OS, Linux
- **Compatible Devices:** Laptop, Personal Computer, Desktop, TV, Tablet

- **Special Features:** Rechargeable, Silent Keys, Ergonomic Design, Auto Power Saving
- **Power Source:** Battery Powered (1 Lithium Polymer battery included for each device)
- **Keyboard Layout:** QWERTY
- **Mouse Movement Detection:** Optical
- **Keyboard Dimensions:** 38.4 cm x 12.5 cm (15.1 in x 4.9 in)
- **Mouse Dimensions:** 11.7 cm x 6.0 cm x 2.8 cm (4.6 in x 2.4 in x 1.0 in)
- **Weight (Combo):** Approximately 690 g

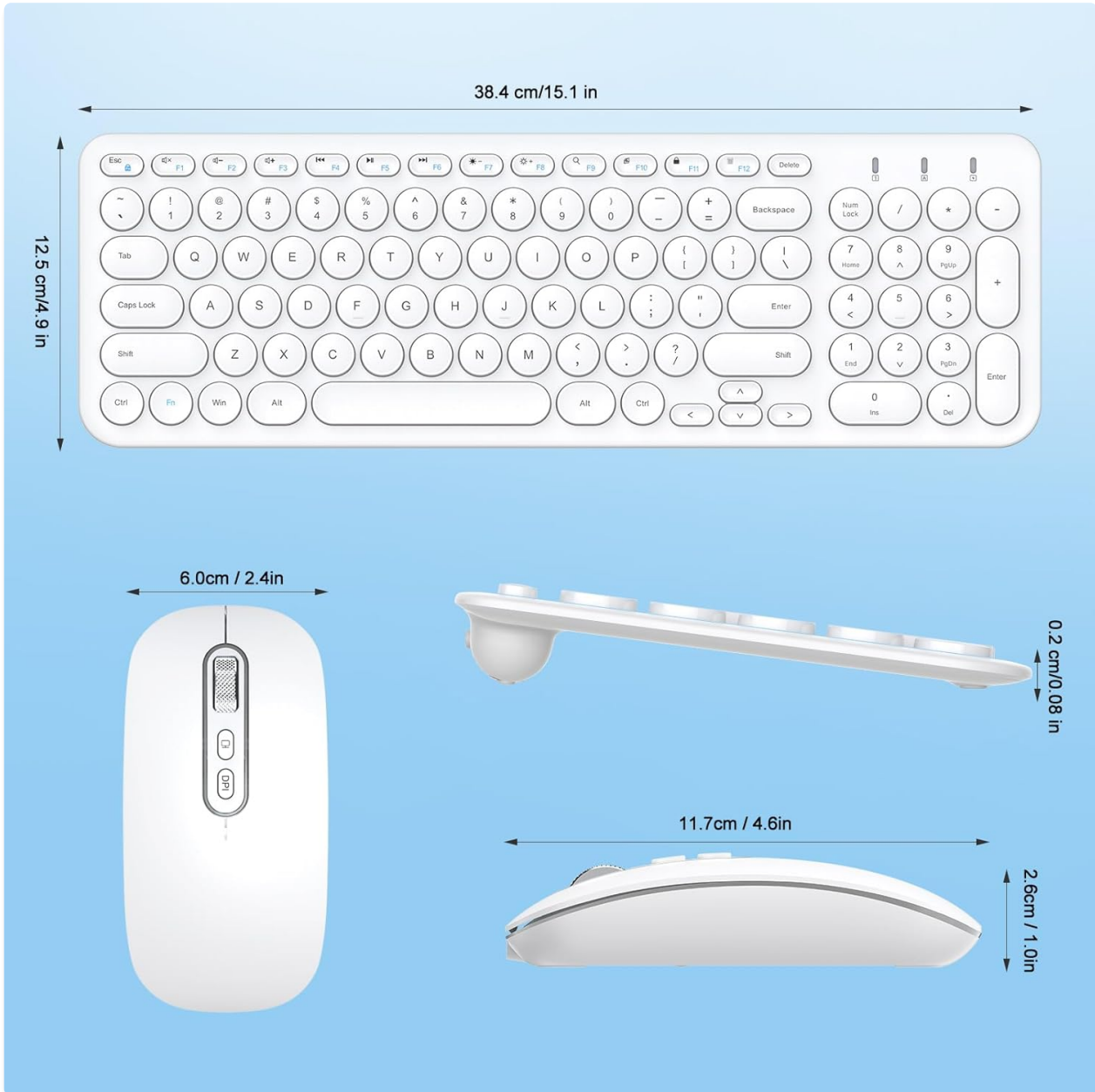

Image 8.1: Detailed dimensions of the keyboard and mouse.

# Wide Compatibility

Compatible with windows XP/Vista/7/8/10, Mac and other operating system



Image 8.2: Visual representation of device compatibility.

## 9. WARRANTY AND SUPPORT

For warranty information or technical support, please refer to the contact details provided with your purchase or visit the official PINKCAT website. Keep your purchase receipt for warranty claims.