

IDEALHOUSE PHO\_0YIO

# IDEALHOUSE 6 Inch Twin Metal Platform Bed Frame Instruction Manual

Model: PHO\_0YIO

## PRODUCT OVERVIEW

This manual provides detailed instructions for the assembly, use, and maintenance of your IDEALHOUSE 6 Inch Twin Metal Platform Bed Frame. Designed for durability and ease of assembly, this low-profile bed frame offers sturdy support for your mattress without the need for a box spring.



Image: Fully assembled IDEALHOUSE 6 Inch Twin Metal Platform Bed Frame with a mattress and bedding.

## IMPORTANT SAFETY INFORMATION

---

Please read and understand all instructions before assembly and use. Failure to follow these instructions may result in injury or product damage.

- **Weight Capacity:** Do not exceed the maximum weight capacity of 700 lbs for this Twin bed frame. Exceeding this limit may result in product failure and potential injury.
- **Proper Assembly:** Ensure all components are correctly assembled and tightened according to the instructions. Improper assembly can lead to instability or collapse.
- **Clearance:** Maintain a minimum 4.5-inch clearance around the bed frame to prevent obstruction and ensure safe use.
- **Children:** Keep small parts away from children during assembly.
- **Tools:** Use only the provided tools or appropriate household tools for assembly. Do not use power tools unless explicitly instructed, as over-tightening can damage components.

## PACKAGE CONTENTS

---

Verify that all parts listed below are present before beginning assembly. If any parts are missing or damaged, please contact customer support.

- Headboard/Footboard Frame Sections (A, B)
- Side Rails (C)
- Center Support Bar (D)
- Steel Slats (E)
- Legs (F)
- Hardware Pack (Bolts, Washers, Nuts, Allen Wrench)
- Instruction Manual

## ASSEMBLY INSTRUCTIONS

---

### Before You Begin

- Clear a spacious area for assembly.
- Lay out all components and hardware on a soft, clean surface to prevent scratches.
- Identify each part by referring to the Package Contents list.
- It is recommended to have two people for assembly.

### Step-by-Step Assembly

1. **Assemble the Headboard and Footboard Sections:** Connect the vertical leg sections (F) to the horizontal frame sections (A and B) using the provided bolts and Allen wrench. Do not fully tighten bolts until all sections are loosely connected.
2. **Attach Side Rails:** Connect the side rails (C) to the assembled headboard and footboard sections. Ensure the connection points align correctly. Secure with bolts, but do not fully tighten yet.
3. **Install Center Support Bar:** Place the center support bar (D) between the headboard and footboard sections, ensuring it aligns with the designated connectors. Secure it with bolts.
4. **Tighten All Bolts:** Once all frame components are loosely assembled, go back and securely tighten all bolts using the Allen wrench. Ensure all connections are firm and stable.
5. **Place Steel Slats:** Lay the steel slats (E) across the bed frame. The slats are designed to fit into specific slots or rest on support ledges. Ensure they are evenly spaced and securely in place.
6. **Final Check:** Verify that the bed frame is stable and all connections are tight. The frame should not wobble.



**Robust Structure**



**Floor protection**

Image: Detail showing the robust structure and floor protection features at a bed frame corner.



Image: Close-up of a corner joint, highlighting the secure screw connections for stability.

## USAGE GUIDELINES

---

- **Mattress Placement:** Carefully place your twin-sized mattress directly onto the steel slats. No box spring is required.
- **Weight Distribution:** Distribute weight evenly across the bed frame to maintain structural integrity.
- **Movement:** Avoid dragging the bed frame when moving it. Lift the frame to reposition to prevent damage to the legs or floor.

## CARE AND MAINTENANCE

---

- **Cleaning:** Wipe the metal frame with a soft, damp cloth. Avoid abrasive cleaners or harsh chemicals that could damage the finish.
- **Regular Inspection:** Periodically check all bolts and connections to ensure they remain tight. Re-tighten if necessary to maintain stability and prevent noise.
- **Noise Prevention:** The frame is designed to be noise-free. If any squeaking occurs, check and tighten all bolts.

## TROUBLESHOOTING

---

Issue	Possible Cause	Solution
Bed frame is wobbly or unstable.	Loose bolts or incorrect assembly.	Ensure all bolts are fully tightened. Review assembly steps to confirm correct installation.
Squeaking noises.	Loose connections or friction between metal parts.	Tighten all bolts. Apply a small amount of lubricant (e.g., silicone spray) to connection points if noise persists.
Mattress slides on the frame.	Smooth mattress bottom or frame surface.	Place a non-slip mat or rug gripper between the mattress and the slats.

PRODUCT SPECIFICATIONS

Feature	Detail
Model Number	PHO_0YIO
Size	Twin
Product Dimensions (L x W x H)	75.2" x 39" x 6"
Material	100% Metal (Steel)
Color	Black
Finish Type	Powder Coated
Weight Capacity	700 lbs
Item Weight	27.1 pounds
Ground to Item Distance	4.5 Inches
Assembly Required	Yes
Box Spring Needed	No

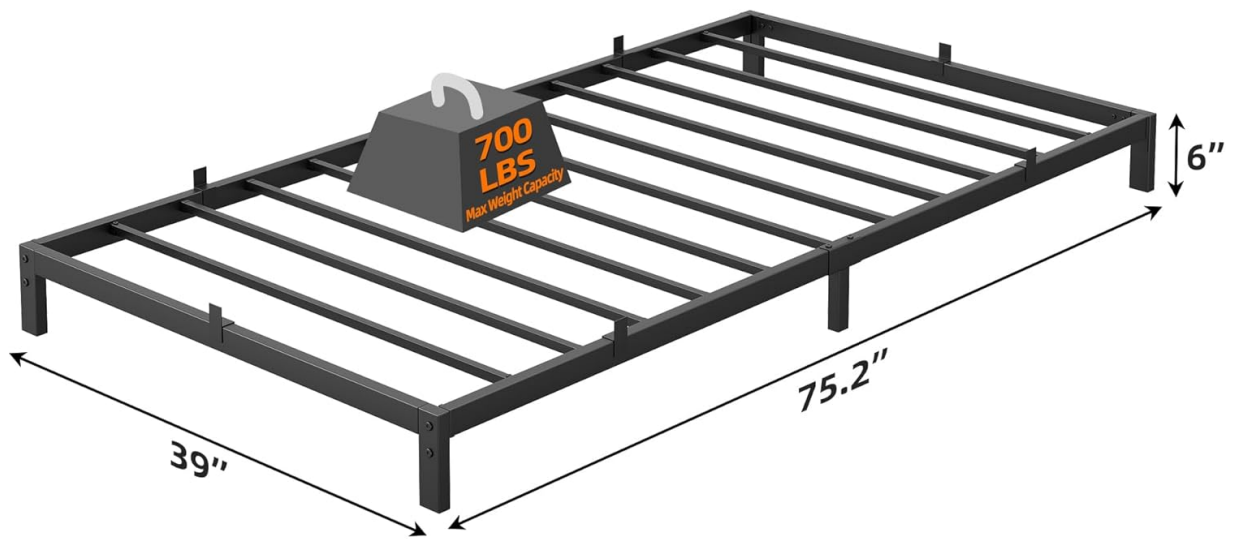

**TWIN**  
**75.2" x 39" x 6"**

Image: Dimensional diagram of the Twin bed frame, indicating 75.2" length, 39" width, 6" height, and a 700 lbs maximum weight capacity.





Image: Visual representation of the 4.5-inch clearance between the bed frame and the floor.

## WARRANTY AND SUPPORT

For warranty information or assistance with your IDEALHOUSE product, please refer to the documentation included with your purchase or contact IDEALHOUSE customer support directly. Ensure you have your model number (PHO\_0YIO) and purchase details available when contacting support.

You can visit the official IDEALHOUSE store for more information: [IDEALHOUSE Store on Amazon](#)



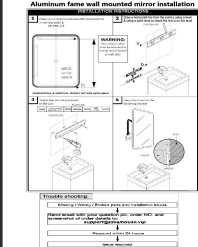

[Aluminum Frame Wall Mounted Mirror Installation Instructions](#)

Step-by-step installation guide for the IDEALHOUSE aluminum frame wall-mounted mirror, including troubleshooting tips.

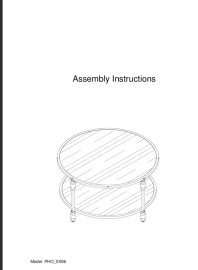

[Idealhouse PHO\\_0X96 Round Coffee Table Assembly Instructions](#)

Detailed assembly instructions for the Idealhouse PHO\_0X96 round coffee table. Includes parts list, hardware, safety information, and step-by-step guidance for easy setup.

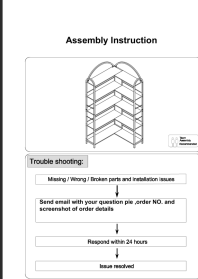

[Idealhouse Corner Bookshelf Assembly Instructions](#)

Step-by-step assembly guide for the Idealhouse Corner Bookshelf, detailing component identification, hardware requirements, and assembly procedures for this L-shaped industrial bookcase.

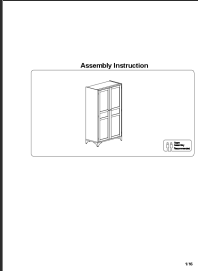

[Idealhouse Tall Storage Cabinet Assembly Instructions](#)

Step-by-step assembly guide for the Idealhouse Tall Storage Cabinet, including parts list, hardware details, safety information, and contact details.

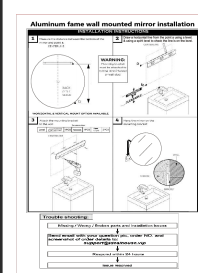

[Aluminum Fame Wall Mounted Mirror Installation Guide](#)

Step-by-step instructions for installing an aluminum fame wall-mounted mirror, including measuring, marking, attaching the bracket, and hanging the mirror. Features troubleshooting tips and contact information for support.



[Furniture Care Guide: Tips for Maintaining Your Furniture](#)

Learn essential furniture care and cleaning tips to keep your home furnishings looking beautiful and extend their lifespan. This guide covers proper placement, cleaning methods, and stain removal for wood furniture.