



[Manuals.plus](#) /

› [Agilestic](#) /

› Agilestic Electric Standing Desk User Manual

## Agilestic d92d90d0-3cee-4d0e-a2d3-989bddf21d7d

# Agilestic Electric Standing Desk User Manual

Model: d92d90d0-3cee-4d0e-a2d3-989bddf21d7d

### IMPORTANT SAFETY INFORMATION

Please read and understand all instructions before assembly and use. Keep this manual for future reference.

- Always follow the assembly instructions carefully.
- Keep the desk away from heat sources and moisture.
- Do not place heavy objects on the desk that could cause it to tip over. The maximum weight capacity is 154 lbs.
- Keep the work area clear of obstacles to prevent tripping hazards during height adjustment.
- Ensure all cables are properly managed to avoid pinching or damage during desk movement.
- The desk is equipped with anti-collision technology. Do not attempt to force movement if an obstruction is detected.

### PRODUCT OVERVIEW

The Agilestic Electric Standing Desk is designed for versatile home and office use, featuring adjustable height and integrated storage. Its robust construction ensures stability and durability.



Figure 1: Agilestic Electric Standing Desk in a typical office setup.

### Key Features:

- **Intelligent Lifting System:** Height adjustment from 28.3" to 45.7" with low noise (under 55 dB). Includes 2 memory keys for customized heights.
- **Classic Wooden Drawer:** Provides spacious storage, complementing various home decor styles.
- **Sturdy Frame and Durable Motor:** Industrial-grade steel frame with T-shaped design supports up to 154 lbs. Motor tested for 50,000 lift cycles.
- **Safety and Ergonomics Design:** Features anti-collision technology and a cable management tray for a safe and tidy workspace.

## SETUP AND ASSEMBLY

Follow these steps carefully to assemble your Agilestic Electric Standing Desk. It is recommended to have two people for assembly.

### Unpacking and Preparation:

- Unpack all components and verify against the parts list provided in the packaging.
- Lay out a soft cloth or cardboard on a clean, flat surface to protect the desktop from scratches during assembly.

### Assembly Steps:

For detailed visual instructions, please refer to the official assembly video provided by Agilestic.

Your browser does not support the video tag.

*Video 1: V2.0 Standing Desk with Drawers Installation instructions. This video provides a comprehensive guide to assembling your desk, including the drawer mechanism.*

Your browser does not support the video tag.

*Video 2: Standing Desk with Drawers Installation instructions. An alternative installation guide for the standing desk with drawers.*

### Key Assembly Points:

- **Leg Installation:** Ensure the two desk legs are consistent in height. If there's a significant difference, press down on the taller leg to equalize.
- **Crossbar Alignment:** The holes in the crossbar should face inward.
- **Motor Alignment:** Adjust the motor's position to align its base holes with the table leg holes before tightening screws.
- **Side Panels:** When installing side panels, ensure both sides face outward.
- **Drawer Assembly:** The drawer slides should be flush with one side of the board after installation.
- **Cable Management:** Arrange the power cord with the provided cable buncher and plug it into the controller.

# Wooden drawer

Classic drawer design simply your work environment with spacious space



Figure 2: Detailed view of the classic wooden drawer, providing ample storage space.

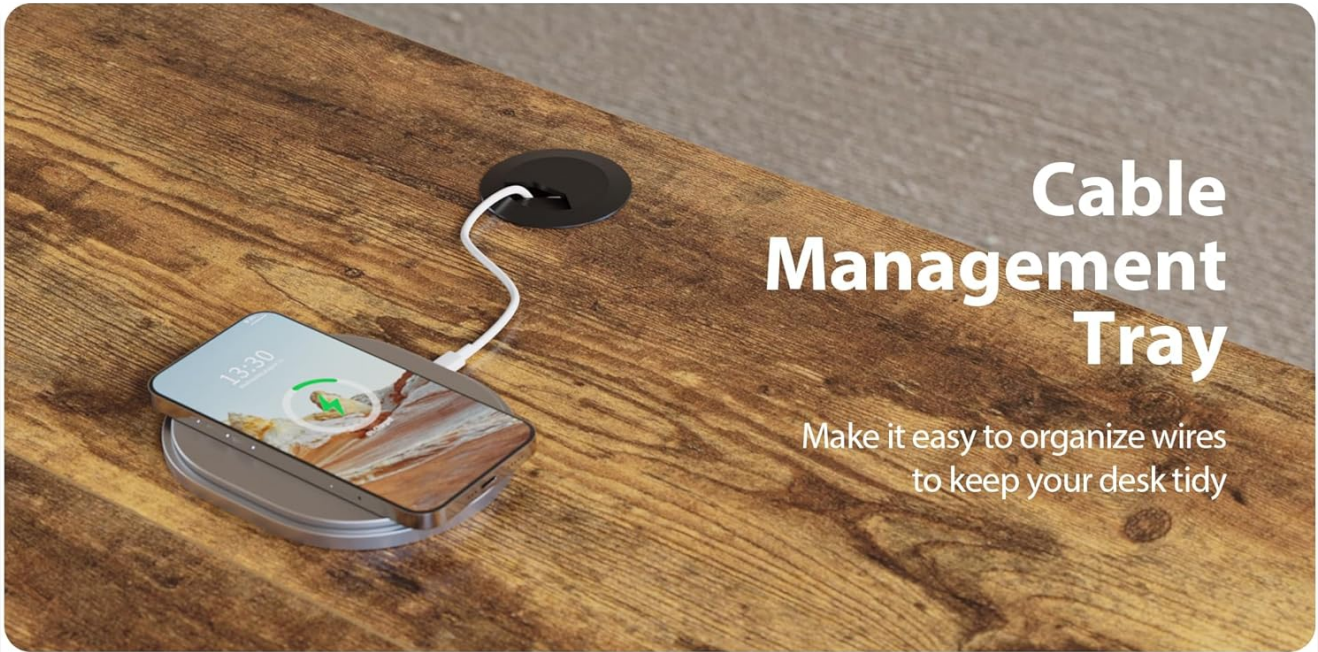

# Cable Management Tray

Make it easy to organize wires to keep your desk tidy



# Desk Hooks (set of 2)

Feel free to hook your headphones and bags on it

Figure 3: Cable management tray and convenient desk hooks for organizing wires and accessories.

## OPERATING INSTRUCTIONS

Your Agilestic Electric Standing Desk features an intuitive control panel for easy height adjustment and memory settings.

### Control Panel Functions:

# Convenient Controller

## Multi-function Intelligent Keypad

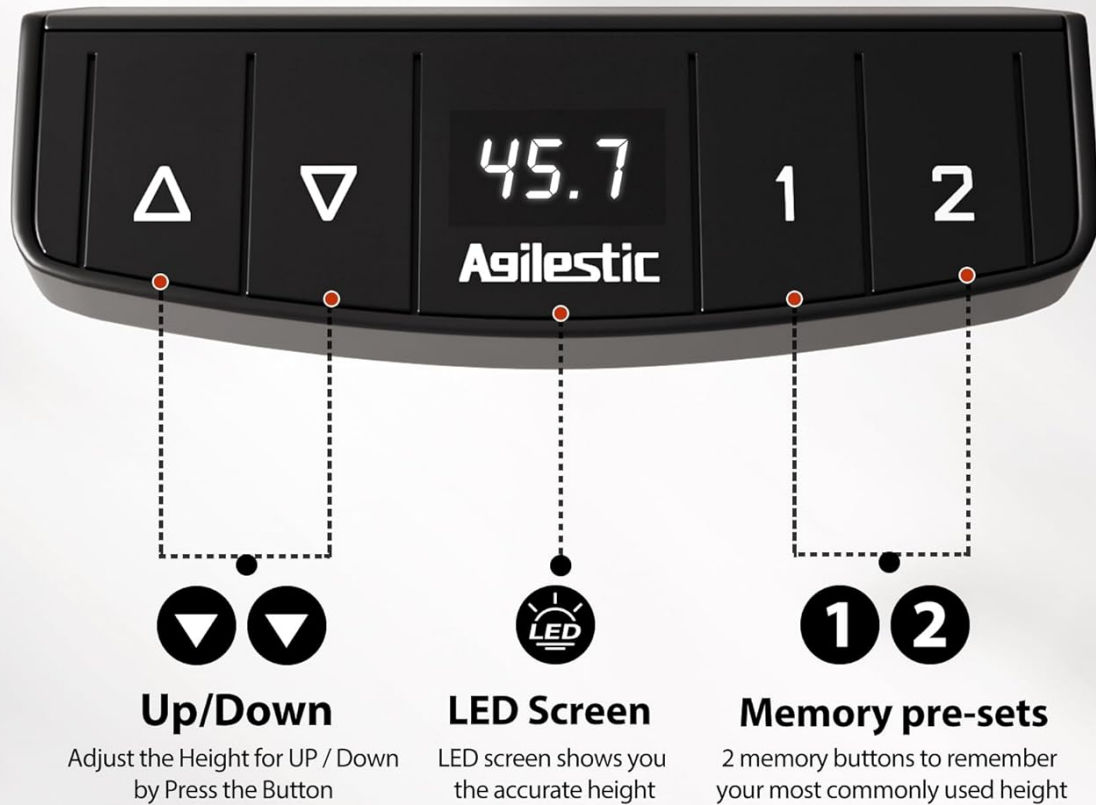

Figure 4: The multi-function intelligent keypad for desk operation.

- **Up/Down Arrows:** Press to adjust the desk height. The desk can be adjusted between 28.3 inches and 45.7 inches.
- **LED Screen:** Displays the current desk height in inches.
- **Memory Presets (1 & 2):** Press and hold a memory button (1 or 2) to save your desired height. Briefly press the saved button to automatically move the desk to that preset height.

### Anti-Collision Feature:

The desk is equipped with an anti-collision system that automatically stops and slightly reverses movement if it encounters an obstacle during adjustment. This protects both the desk and surrounding objects.

# Anti-Collision Technology

Auto-sensing anti-collision system protects your desk



Figure 5: Auto-sensing anti-collision system protects your desk and surroundings.

## MAINTENANCE

Regular maintenance ensures the longevity and optimal performance of your standing desk.

- **Cleaning:** Wipe the desktop and frame with a soft, damp cloth. Avoid harsh chemicals or abrasive cleaners.
- **Cable Management:** Periodically check the cable management tray and ensure all wires are neatly secured and not pinched.
- **Screw Tightness:** Over time, screws may loosen. Periodically check and tighten all assembly screws, especially those on the frame and legs, to maintain stability.
- **Environmental Conditions:** Avoid exposing the desk to extreme temperatures or high humidity, which can affect the wood and electronic components.

## TROUBLESHOOTING

This section addresses common issues you might encounter with your Agilestic Electric Standing Desk. For more detailed solutions, please refer to the troubleshooting video.

Your browser does not support the video tag.

*Video 3: Common installation problem solutions. This video covers solutions for error codes (E10, E20, E02), abnormal noise, instability, integral inability to rise/fall, and single side lift issues.*

### Common Issues and Solutions:

**1. Error Code E10 (Manual Controller Issue):**

If E10 is displayed, hold down the down button for three seconds until "RES" is displayed. The table will run down to its lowest height and bounce slightly. This should resolve the issue. If not, wait 8 minutes for the manual to naturally cool down, then repeat the process.

**2. Error Code E20 (Overload):**

E20 indicates the desk is overloaded (exceeding 154 lbs). Reduce the weight on the desk to below the rated load range. Then, hold down the down button for three seconds until "RES" is displayed. The table will run down to its lowest height and bounce slightly, resolving the issue.

**3. Error Code E02 (Sensitivity Adjustment):**

If E02 is frequently displayed, the sensitivity of the anti-collision system might need adjustment. Press buttons 1 and 2 simultaneously for two seconds. The display will blink and show the current key force gear (L for Light, N for Normal, H for Heavy, OFF). Adjust the sensitivity as needed. To turn off the anti-collision, press 1 and 2 simultaneously for two seconds when the current position is "OFF" gear.

**4. Abnormal Noise:**

Check that the two mounting screws of the motor are tightened. If not, tighten them with the provided tool. Also, ensure the screws on the beam and column are tight.

**5. Instability/Wobbling:**

Check whether the screws on the footing and column are tight. If not, tighten them. Ensure all screws of the whole frame and table are tightened.

**6. Integral Inability to Rise and Fall:**

Check if the hex bar is inverted. The long side with the card slot cannot be installed on the side without the motor. If it's upside down, you need to take the frame apart and turn the hex bar the other way around. Ensure the long side card slot is tightened with the motor.

**7. Single Side Lift (Unilateral Rise and Fall):**

Check that the wires behind the hand controller are properly connected. Reinsert and install if improperly connected. Also, check whether the power supply is properly connected and reinsert it. If the issue persists, hold down the down button for three seconds until "RES" is displayed. The table will run down to its lowest height and bounce slightly, resolving the issue.

## SPECIFICATIONS

Feature	Detail
Brand	Agilestic
Model Number	d92d90d0-3cee-4d0e-a2d3-989bddf21d7d
Product Dimensions	48"D x 24"W x 30"H
Color	Rustic Brown
Style	Country Rustic
Base Material	Metal (Alloy Steel)
Top Material Type	Wood

Special Feature	Cordless, Electric, Anti-collision technology, Cable management tray
Mounting Type	Floor Mount
Number of Drawers	1
Item Weight	20.45 Kilograms
Minimum Height	28.3 Inches
Maximum Height	45.7 Inches
Maximum Weight Recommendation	154 Pounds

## WARRANTY AND SUPPORT

For any questions, technical support, or warranty claims, please contact Agilestic customer service. Refer to your product packaging or the official Agilestic website for contact details.

You can also visit the [Agilestic Store on Amazon](#) for more information and support resources.