

Manuals+

[Q & A](#) | [Deep Search](#) | [Upload](#)

[manuals.plus](#) /

› [ZKCAMSPY](#) /

› [Wireless Carplay with 4K Dash Cam User Manual](#)

ZKCAMSPY S627

Wireless Carplay with 4K Dash Cam User Manual

Model: S627 | Brand: ZKCAMSPY

1. PRODUCT OVERVIEW

The ZKCAMSPY Wireless Carplay with 4K Dash Cam is a versatile in-car entertainment and safety system. It features a 6.25-inch touchscreen, integrated 4K front and 1080P rear dash cameras, and supports wireless Apple CarPlay and Android Auto. This device enhances your driving experience with navigation, media playback, hands-free communication, and comprehensive recording capabilities.



Image: The main unit of the ZKCAMSPY Wireless Carplay with 4K Dash Cam, showing the 6.25-inch touchscreen display with navigation and media interface, along with included accessories like a 64GB MicroSD card, CarPlay/Android Auto icons, a waterproof backup camera, and a dash camera with suction mount.

SMART CHIP

HD IPS + 2.5D Touch Screen

HD
1600x600
HD Resolution

2.5D Curved

IPS
IPS
Screen

Quick Response

- The running speed is smoother
- The performance is more stable

4K

168° View Angle

Image: Close-up of the 6.25-inch HD IPS 2.5D curved touchscreen, highlighting its 1600x600 HD resolution and the smart chip for quick and stable performance.

2. SPECIFICATIONS

Feature	Detail
Model Number	S627

Screen Size	6.25 Inches
Display Type	2.5D IPS Touchscreen (1600x600 HD Resolution)
Front Camera Resolution	4K (2160P)
Rear Camera Resolution	1080P (Waterproof)
Viewing Angle	Front: 168°, Rear: 150°
Frame Rate	24 or 30 FPS
Connectivity	Wireless Apple CarPlay, Android Auto, Mirror Link, Bluetooth, Wi-Fi
Audio Output Modes	Bluetooth, AUX, FM Transmitter, Built-in Speaker
Storage	SD Card (Memory Card included)
Power Input	7-32V (Suitable for various vehicle types)
Mounting Type	Dashboard Mount (Adhesive Sticker Bracket, Suction Cup Bracket)
Item Weight	1.57 pounds
Package Dimensions	7.8 x 5.63 x 3.86 inches

3. WHAT'S IN THE BOX

Your ZKCAMSPY Wireless Carplay with 4K Dash Cam package includes the following components:

- Main Carplay Unit with 6.25" Touchscreen
- 4K Front Dash Camera (integrated)
- 1080P Waterproof Backup Camera
- Memory Card (SD)
- Power Cable (Cigarette Lighter Plug)
- Adhesive Sticker Bracket
- Windshield Suction Mount Bracket
- User Manual (this document)

4. SETUP AND INSTALLATION

4.1 Choosing an Installation Method

The device offers two primary installation methods for the main unit:

1. **Adhesive Sticker Bracket:** For mounting on the center console. Ensures a stable, low-profile installation.
2. **Windshield Suction Mount Bracket:** For mounting on the windshield. Provides flexibility in positioning and easy removal.

Upgrade 4 Ways of Sounding

Newly upgraded bluetooth connect to the car speaker enjoy a ultimate music experience



Image: Illustration showing the two installation options: an adhesive sticker bracket for dashboard mounting and a suction cup bracket for windshield mounting, demonstrating the versatility of placement within a vehicle.

4.2 Main Unit Installation Steps

1. **Choose Location:** Select a suitable location on your dashboard or windshield that does not obstruct your view or interfere with airbags.
2. **Attach Bracket:** Secure the chosen bracket (adhesive or suction cup) to the desired surface. Ensure the surface is clean and dry before applying the adhesive bracket.
3. **Mount Device:** Attach the main Carplay unit to the bracket. The magnetic design allows for easy installation and removal.
4. **Connect Power:** Plug the power cable into the unit and then into your vehicle's cigarette lighter socket.

4K +1080P Dual Recording

Capture more details more clearly



Image: Diagram illustrating the quick and easy installation process, showing the main unit mounted on the dashboard and connected to the car's cigarette lighter for power.

4.3 Backup Camera Installation

The backup camera provides a 1080P rear view and assists with parking. Follow these steps for installation:

1. **Mount Camera:** Install the 1080P waterproof backup camera at the rear of your vehicle, typically above the license plate or near the trunk handle.
2. **Route Cable:** Carefully route the camera cable from the rear of the vehicle to the main Carplay unit.
3. **Connect to Reverse Light:** Connect the red wire of the backup camera cable to your vehicle's reverse light anode. This enables automatic display of the rear view when shifting into reverse.
4. **Connect to Main Unit:** Plug the camera cable into the designated input port on the main Carplay unit.

4K +1080P Dual Recording

Capture more details more clearly



Image: Detailed diagram showing the connection of the backup camera. The red wire from the camera cable is connected to the reverse light anode, ensuring the camera activates when the vehicle is in reverse gear.

5. OPERATING INSTRUCTIONS

5.1 Wireless Apple CarPlay Connection

1. **Open Apple CarPlay:** On the Carplay unit, select the Apple CarPlay icon.
2. **Enable Wi-Fi and Bluetooth:** On your iPhone, go to Settings and ensure both Wi-Fi and Bluetooth are turned on.
3. **Find Device:** On your iPhone's Bluetooth settings, search for and select the device named "T86-XXXXX" (the specific name may vary).
4. **Pairing:** Confirm the pairing code displayed on both your iPhone and the Carplay unit. Once confirmed, the connection will be successful.



Image: Step-by-step visual guide for connecting an iPhone to the Carplay unit via wireless Apple CarPlay, showing the interface on both devices during the pairing process.

5.2 Wireless Android Auto Connection

1. **Open Android Auto:** On the Carplay unit, select the Android Auto icon.
2. **Enable Wi-Fi and Bluetooth:** On your Android phone, go to Settings and ensure both Wi-Fi and Bluetooth are turned on.
3. **Find Device:** On your Android phone's Bluetooth settings, search for and select the device named "T86-XXXXX" (the specific name may vary).
4. **Pairing:** Confirm the pairing code and grant necessary permissions (e.g., access to contacts). Once confirmed, the connection will be successful.

Time-Lapse Recording

12/24H continuous parking surveillance brings you reassurance even when you are away from the car.



G-Sensor



Loop Recording



Parking Monitor



Image: Step-by-step visual guide for connecting an Android phone to the Carplay unit via wireless Android Auto, showing the interface on both devices during the pairing process.

5.3 Audio Output Modes

The device supports four ways to output audio to your car's sound system:

- **Bluetooth:** Connect the Carplay unit to your car's existing Bluetooth system for audio playback.
- **AUX Connect:** Use an AUX cable to connect the Carplay unit's AUX output to your car's AUX input.
- **FM Transmitter:** Transmit audio wirelessly to your car's FM radio by setting both devices to the same FM frequency.
- **Built-in Speaker:** The Carplay unit has its own built-in speaker for direct audio output.

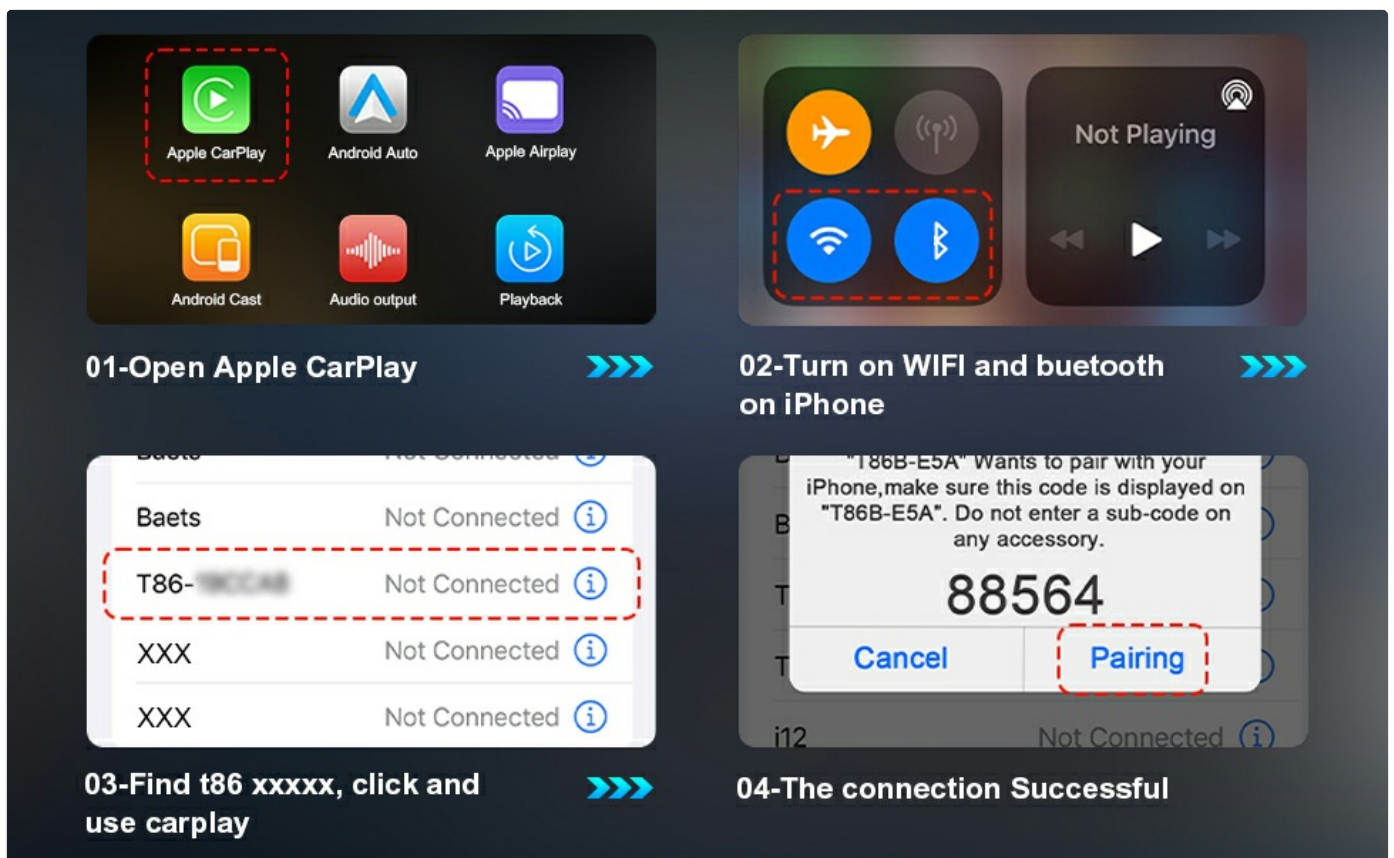

Image: Visual representation of the four audio output methods: Bluetooth, AUX connection, FM transmitter, and the built-in speaker, illustrating how sound can be routed to your car's audio system.

5.4 Dash Cam Features (4K Front + 1080P Rear)

The integrated dash cam system provides comprehensive recording for your journeys:

- **Dual Recording:** Simultaneously records 4K video from the front camera (168° view) and 1080P video from the rear camera (150° view).
- **HDR/WDR:** High Dynamic Range and Wide Dynamic Range technology ensure clear video quality in various lighting conditions.
- **Loop Recording:** Automatically overwrites the oldest footage when the memory card is full, ensuring continuous recording.
- **Night Vision:** Enhanced low-light performance for clear recordings at night.
- **G-Sensor:** Detects sudden impacts or collisions and automatically locks the current video segment to prevent it from being overwritten.
- **Parking Monitor:** When the vehicle is parked, the dash cam can automatically power on and record footage if motion or collision is detected (requires hardware kit, not included).
- **Time-Lapse Recording:** Continuously records at a low frame rate (e.g., 2 frames per second) to provide 24-hour surveillance with reduced file size.

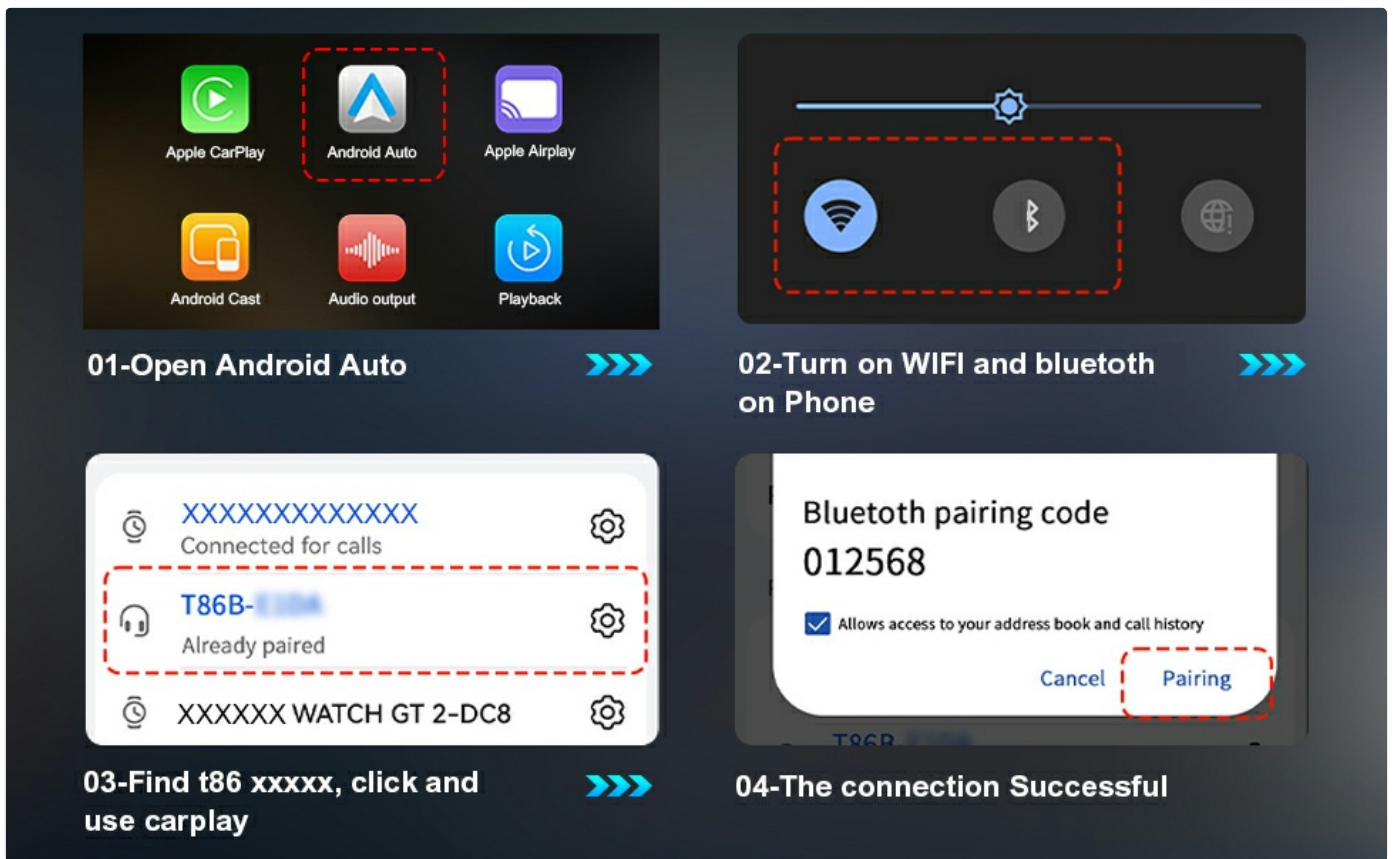

Image: Illustration demonstrating the dual recording capability with 4K front and 1080P rear cameras, highlighting the wide viewing angles for comprehensive coverage.



Image: Depiction of the time-lapse recording feature, showing how it provides 24-hour continuous parking surveillance with G-sensor and loop recording functionalities.

5.5 WiFi Video & APP Control

You can manage and view your dash cam footage directly from your smartphone:

1. **Download App:** Scan the QR code provided on the device or in the manual to download the "Viidure" application.
[Download App Here](#)
2. **Connect Phone:** Connect your smartphone to the Carplay unit's Wi-Fi network.
3. **View & Manage:** Use the app to view live camera feeds, playback recorded videos, and download footage to your phone.



Image: Screenshot showing the mobile application interface for viewing live camera feeds and recordings, along with a QR code for app download and icons for social media sharing.

5.6 Voice Control

Utilize voice commands for hands-free operation through Apple Siri or Android voice control/Google Assistant. This allows you to control navigation, music, calls, and more without taking your hands off the wheel.

Wireless Carplay & Android Auto

Bluetooth wireless connection, seamlessly accessing functions such as music, maps, email, and calls and more, also supports voice control



Image: Depiction of the wireless CarPlay and Android Auto functionality, emphasizing voice control capabilities with examples like "Take me to the park," "Call Mom," "Play music," and "Navi home."

6. MAINTENANCE

- **Cleaning:** Use a soft, dry cloth to clean the touchscreen and device body. Avoid abrasive cleaners or solvents.
- **Camera Lenses:** Gently wipe camera lenses with a microfiber cloth to ensure clear recordings.
- **Firmware Updates:** Periodically check the manufacturer's website or the companion app for firmware updates to

ensure optimal performance and new features.

- **Memory Card:** Format the memory card regularly (e.g., once a month) through the device settings to maintain optimal recording performance and prevent data corruption.

7. TROUBLESHOOTING

Problem	Possible Cause / Solution
Device does not power on.	Ensure the power cable is securely plugged into the cigarette lighter socket and the device. Check if the vehicle's cigarette lighter socket is receiving power.
Cannot connect to Apple CarPlay/Android Auto.	Ensure Wi-Fi and Bluetooth are enabled on your smartphone. Forget the device in your phone's Bluetooth settings and try pairing again. Restart both the Carplay unit and your smartphone. Ensure your phone's operating system is up to date.
Dash cam not recording or footage is corrupted.	Ensure the memory card is properly inserted. Format the memory card through the device settings. Try a different, high-speed memory card (Class 10 or higher recommended). Check if loop recording is enabled.
Rear camera not displaying.	Check the connection of the rear camera cable to the main unit. Verify that the red wire of the camera cable is correctly connected to the reverse light anode. Ensure the camera lens is clean and unobstructed.
Audio quality is poor or no sound.	Check the selected audio output mode (Bluetooth, AUX, FM, Built-in Speaker). If using FM transmitter, ensure the frequency is clear and matches your car radio. Adjust volume levels on both the Carplay unit and your car stereo.

8. WARRANTY AND SUPPORT

For warranty information, technical support, or any inquiries regarding your ZKCAMSPY Wireless Carplay with 4K Dash Cam, please refer to the contact information provided on the product packaging or visit the official ZKCAMSPY website. You can also reach out to the seller directly through the platform where you purchased the product.

We are committed to providing reliable products and services. If you have any questions, please do not hesitate to contact our support team.