

Manuals.plus /

› SIBRILLE /

› SIBRILLE LED Desk Lamp HL10 User Manual

SIBRILLE HL10

SIBRILLE LED Desk Lamp HL10 User Manual

Model: HL10

Brand: SIBRILLE

1. INTRODUCTION

This manual provides instructions for the SIBRILLE HL10 LED Desk Lamp. This lamp features a dual-head design with RGB lighting, adjustable color temperature and brightness, and a flexible gooseneck for optimal positioning. It is designed to provide versatile and eye-friendly illumination for various tasks.

2. WHAT'S IN THE BOX

- SIBRILLE HL10 LED Desk Lamp
- Power Adapter
- Remote Control
- User Manual

3. ASSEMBLY AND INSTALLATION

The SIBRILLE HL10 LED Desk Lamp is designed for easy assembly and installation. It features a clamp-on base for secure attachment to various desk surfaces.

1. **Attach the Clamp:** Secure the lamp's clamp base to the edge of your desk. Ensure the desk thickness is compatible with the clamp (typically up to 2.8 inches or 7 cm). Tighten the screw firmly to prevent movement.
2. **Connect Power:** Plug the power adapter into the lamp and then into a standard electrical outlet.
3. **Adjust Position:** The lamp features a flexible gooseneck and rotatable light bars. Adjust the lamp head and arms to your desired position for optimal lighting coverage. The light bars can rotate up to 270 degrees front and back, and the flexible arm allows for extension up to 180 degrees.

2 Ways to Place



Figure 3.1: Two ways to place the SIBRILLE LED Desk Lamp, demonstrating its versatility with single or dual monitor setups. The clamp securely attaches to desks with a thickness greater than 1.6 inches.

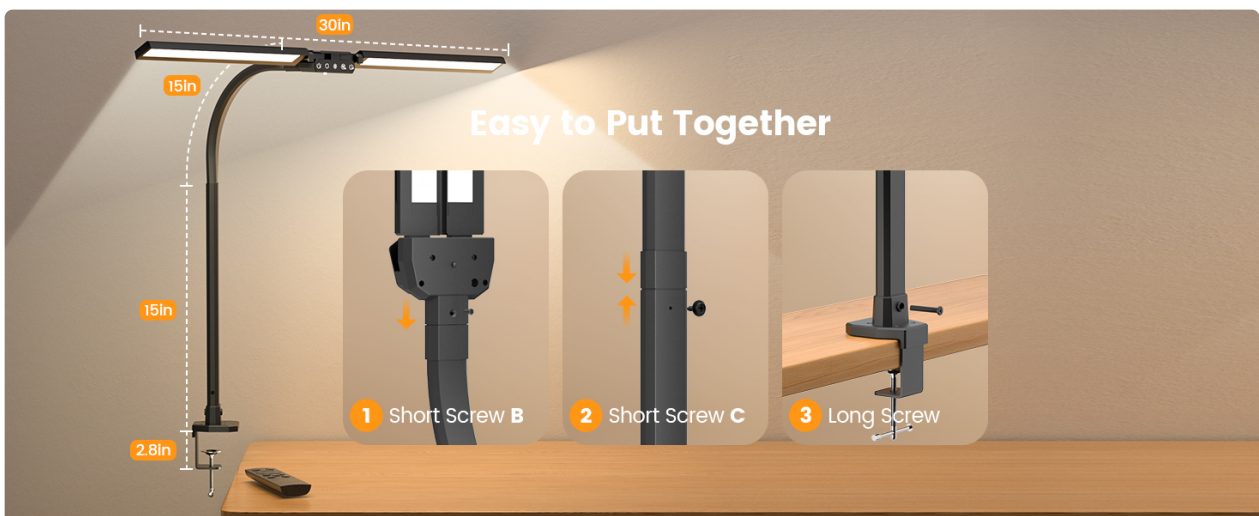

Figure 3.2: Assembly diagram showing the connection points for the lamp head, arm, and clamp.

4. OPERATING INSTRUCTIONS

The SIBRILLE HL10 LED Desk Lamp can be operated using the touch controls on the lamp head or the included wireless remote control.

4.1 Touch Controls

The touch panel on the lamp head provides direct access to essential functions:

- **Power Button:** Turns the lamp on or off.
- **Color Temperature Adjustment:** Cycles through 5 white/warm color temperatures (3000K-6500K).
- **Brightness Adjustment:** Adjusts brightness levels from 10% to 100%.
- **RGB Modes:** Activates and cycles through various RGB lighting effects.
- **RGB On/Off:** Toggles the RGB backlighting on or off independently.

4.2 Remote Control

The wireless remote control offers convenient operation from a distance, replicating most touch panel functions and adding preset modes:

- **Power Button:** Turns the lamp on or off.
- **Color Temperature & Brightness:** Dedicated buttons for adjusting white/warm light color temperature and brightness.
- **RGB Control:** Buttons for single RGB colors and dynamic RGB modes.
- **Preset Modes:** Includes modes for Night, Reading, Working, Gaming, and Relaxing.
- **Timer Function:** Sets the lamp to automatically turn off after 1 hour.
- **Memory Function:** The lamp remembers the last used mode and brightness settings.

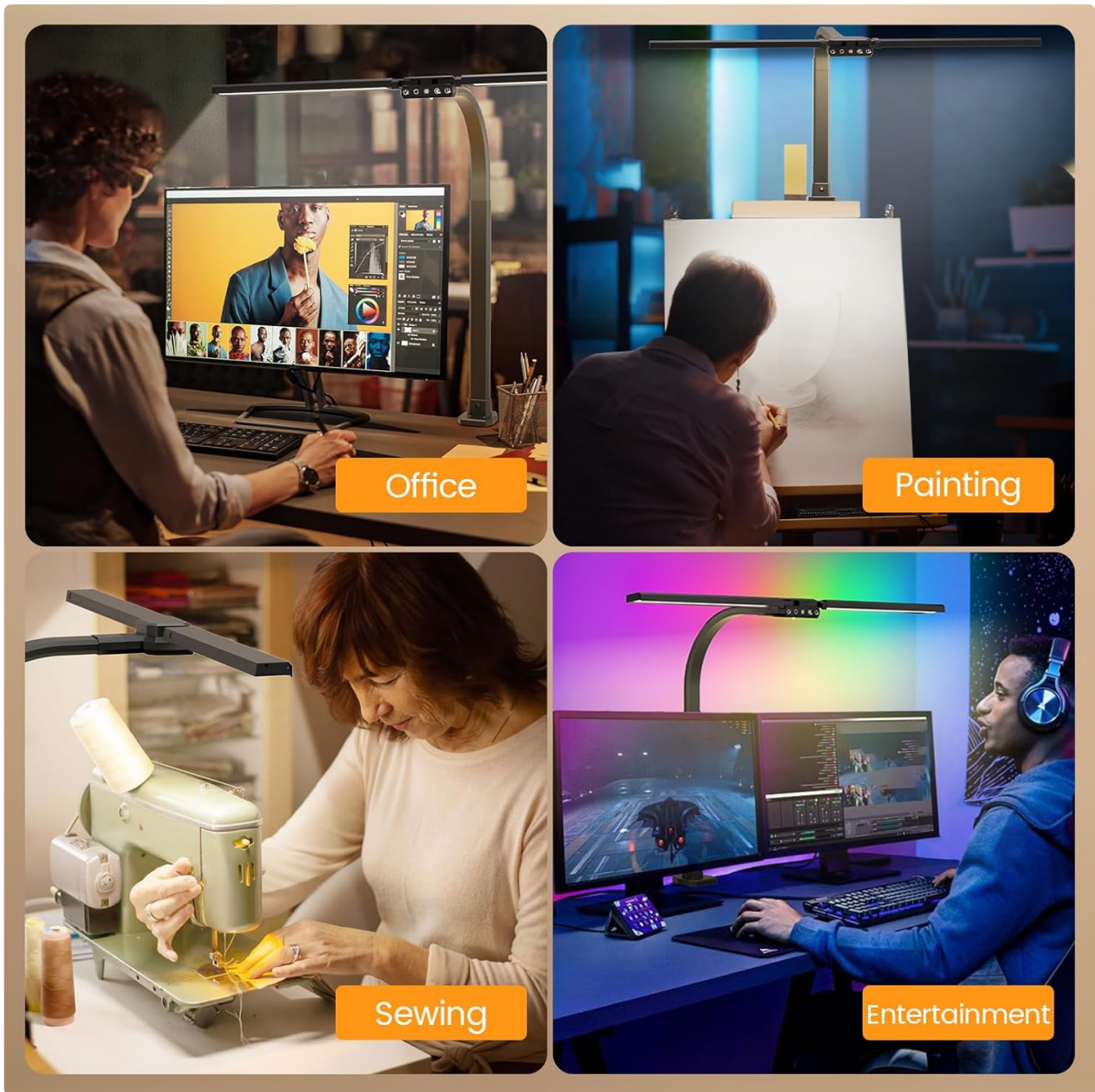

Figure 4.1: Overview of touch controls and remote control functions.



Figure 4.2: Detailed view of the touch control panel.

5. RGB LIGHTING MODES

The SIBRILLE HL10 offers a variety of RGB lighting options to enhance your environment.

- **Single Colors:** Choose from Red, Green, or Blue.
- **Dynamic Effects:** Explore 6-color alternating, gradients, breathing flashing, and 6-color sound rhythm modes.

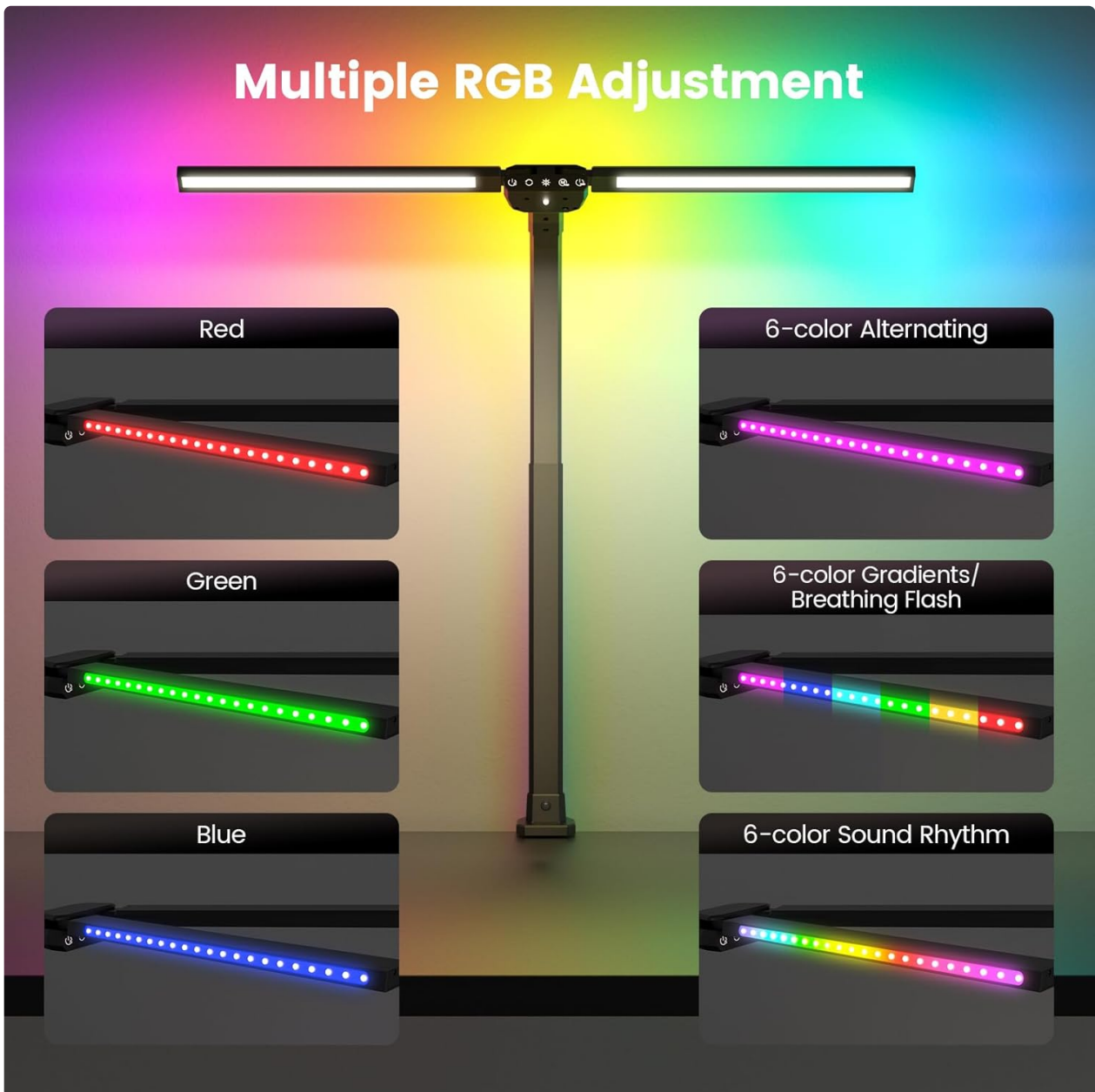

Figure 5.1: Overview of available RGB lighting modes.



Figure 5.2: Examples of RGB lighting in a desk environment.

6. ADJUSTABLE FEATURES

The lamp's design allows for extensive customization of lighting direction and intensity.

- **Rotatable Lamp Head:** The dual lamp heads can be rotated up to 270 degrees front and back, allowing you to direct light precisely where needed.
- **Flexible Gooseneck:** The bendable gooseneck extends up to 180 degrees, providing wide lighting coverage across a desk up to 71 inches wide.
- **Dimmable Brightness:** Adjust the light intensity from 10% to 100% to suit your preference.
- **Adjustable Color Temperature:** Select from 5 color temperatures ranging from 3000K (warm white) to 6500K (cool white).



Rotatable & Dual Head, Bright & Wide Lighting Coverage

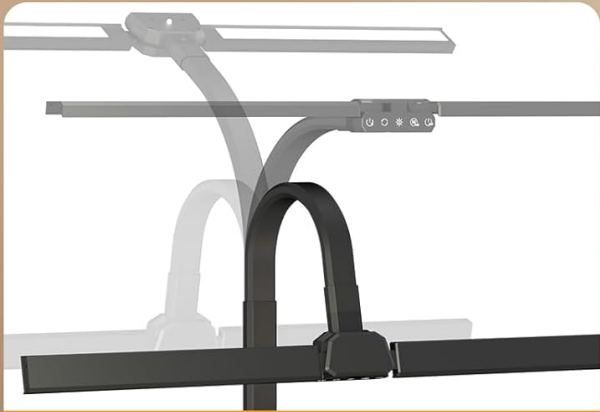

Flexible Gooseneck

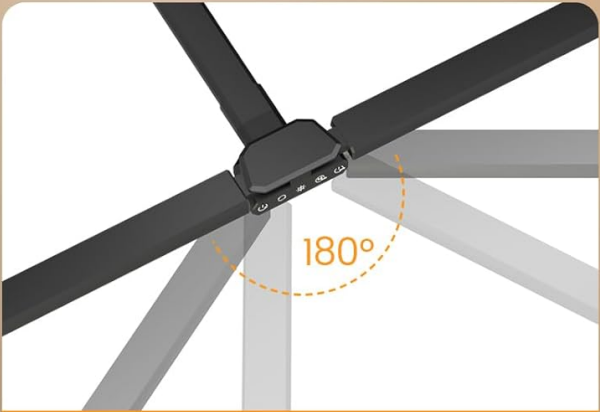

0-180° Extension

Figure 6.1: Rotatable dual heads and flexible gooseneck for extensive adjustment.



Figure 6.2: Dimmable color and brightness settings.

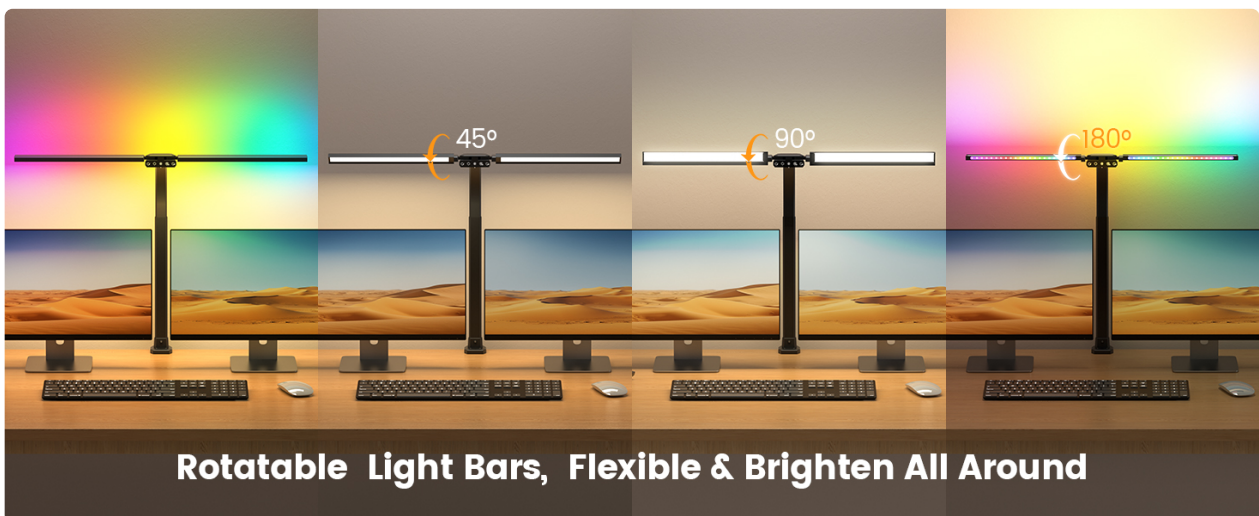

Figure 6.3: Rotatable light bars for flexible illumination.

7. EYE PROTECTION AND ENERGY SAVING

The SIBRILLE HL10 LED Desk Lamp is designed with user comfort and efficiency in mind.

- **Eye-Caring Illumination:** Provides even light distribution with no glare, flicker, or harmful blue light, reducing eye strain during prolonged use.
- **High CRI:** Features a Color Rendering Index (CRI) of 90+, ensuring colors appear natural and vibrant.
- **Energy Efficient:** Utilizes LED technology for 85% energy savings compared to traditional lighting.



Figure 7.1: Eye-caring and energy-saving features.



Figure 7.2: High Color Rendering Index (CRI) for accurate colors.

8. USAGE SCENARIOS

The SIBRILLE HL10 LED Desk Lamp is suitable for a variety of applications:

- **Office:** Ideal for computer work, reading, and general task lighting.
- **Gaming:** Enhance your gaming setup with customizable RGB backlighting.
- **Creative Work:** Provides ample and adjustable light for painting, drafting, and other hobbies.
- **Reading:** Offers comfortable illumination for extended reading sessions.

Eye-caring & Energy-saving

No Glare, No Direct Lighting



850LM



CRI > 90



85% Energy saving



Eye-friendly

Figure 8.1: Versatile use in office, creative, and entertainment settings.

9. SPECIFICATIONS

Feature	Specification
Brand	SIBRILLE
Model Name	HL10
Product Dimensions	16"D x 9"W x 2"H
Item Weight	3.3 pounds (1.5 Kilograms)
Material	Aluminum, Metal, Plastic
Finish Type	Brushed
Light Source Type	LED
Wattage	22 watts
Color Temperature	3000K-6500K (5 levels)
Brightness Levels	10%-100% (5 levels)
RGB Modes	7 modes (single & dynamic)
Control Method	Remote, Touch
Mounting Type	Tabletop (Clamp)
Special Features	Dimmable, Rotatable Head, Flexible Gooseneck, RGB, Memory Function, Timer Function
Indoor/Outdoor Usage	Indoor

10. MAINTENANCE

To ensure the longevity and optimal performance of your SIBRILLE HL10 LED Desk Lamp, follow these maintenance guidelines:

- **Cleaning:** Use a soft, dry cloth to wipe the lamp's surface. Avoid abrasive cleaners or solvents that may damage the finish.
- **Dust Removal:** Regularly dust the LED light bars and control panel to maintain brightness and responsiveness.
- **Cable Care:** Ensure the power cable is not pinched or excessively bent, which could lead to damage.
- **Storage:** If storing the lamp for an extended period, disconnect it from power and store it in a cool, dry place.

11. TROUBLESHOOTING

If you encounter any issues with your SIBRILLE HL10 LED Desk Lamp, refer to the following common troubleshooting steps:

- **Lamp Not Turning On:**
 - Check if the power adapter is securely plugged into both the lamp and the wall outlet.

- Ensure the wall outlet is functional by testing it with another device.
- **Remote Control Not Working:**
 - Verify that the remote control has working batteries.
 - Ensure there are no obstructions between the remote and the lamp's sensor.
- **Inconsistent Brightness/Color:**
 - Reset the lamp by unplugging it for a few minutes and then plugging it back in.
 - Ensure the touch controls or remote buttons are pressed firmly and accurately.

If the issue persists after trying these steps, please contact customer support.

12. WARRANTY AND SUPPORT

The SIBRILLE HL10 LED Desk Lamp comes with a **2-year EU spare part availability duration**. For warranty claims, technical assistance, or any other inquiries, please refer to the contact information provided with your purchase or visit the official SIBRILLE website.

13. PRODUCT VIDEOS

SIBRILLE Remote Control LED Desk Lamp with RGB

This video provides a detailed overview of the SIBRILLE Remote Control LED Desk Lamp with RGB features, demonstrating its various lighting modes and remote functionality.