



[Manuals.plus](#) /

> [POCREATION](#) /

> POCREATION Portable Countertop Dishwasher Model POCREATIONhwx3qfp7k2-11 User Manual

## POCREATION POCREATIONhwx3qfp7k2-11

# POCREATION Portable Countertop Dishwasher User Manual

MODEL: POCREATIONHXW3QFP7K2-11

## 1. Introduction

Thank you for choosing the POCREATION Portable Countertop Dishwasher. This compact and versatile appliance is designed to simplify your daily cleaning tasks, offering efficient washing for dishes, fruits, and vegetables. Its advanced technology and portable design make it ideal for various settings, including kitchens and apartments.

Key features include:

- **Multifunctional Use:** Capable of washing dishes, fruits, and vegetables.
- **Advanced Cleaning:** Utilizes artificial vortex and sound emulsification technology for thorough cleaning.
- **Powerful Suction:** 45KPa suction power and 360-degree coverage for deep cleaning.
- **Automatic Shut-off:** Features an automatic 15-minute shut-off for convenience and safety.
- **Portable Design:** Lightweight and compact, with a strong suction cup for secure placement.

## 2. Safety Instructions

- Read all instructions before using the appliance.
- Do not immerse the main dishwasher unit in water beyond its intended use.
- Ensure the power cable is not damaged and is connected to a suitable power source.
- Keep out of reach of children.
- Use only the provided USB cable for charging.
- Do not attempt to repair or modify the appliance yourself. Contact customer service for assistance.
- Always unplug the appliance before cleaning or when not in use.

## 3. Package Contents

Verify that all items are present in the package:

- 1 x Bucket with Lid

- 1 x Dishwasher Unit
- 1 x USB Cable
- 1 x Instruction Manual (this document)
- 1 x Sucker (suction cup attachment)



Image 3.1: Included components: Bucket with Lid, USB Cable, and Sucker.

## 4. Setup

Before first use, ensure the dishwasher unit is fully charged using the provided USB cable.

1. **Assemble the Unit:** Place the dishwasher unit inside the bucket.
2. **Secure Placement:** The mini dishwasher is designed to be freely adsorbed in a washing tank or other containers. Use the provided sucker (suction cup) to secure the dishwasher unit to the side or bottom of the bucket or your chosen container. This ensures stability during operation.
3. **Add Water and Detergent:** Fill the bucket or container with an appropriate amount of water and a small amount of dishwashing detergent.



Image 4.1: Dishwasher unit placed inside the bucket.



Image 4.2: Close-up of the portable dishwasher unit.

## 5. Operating Instructions

---

The POCREATION Portable Countertop Dishwasher is designed for ease of use with a simple one-button operation.

1. **Load Items:** Place small bowls, dishes, fruits, or vegetables into the bucket with the dishwasher unit. Note that this mini dishwasher is suitable for small items and non-commercial use, typically for a family of three. For larger quantities, wash in batches.
2. **Power On:** Press the power button once to start the machine. The dishwasher will begin its cleaning cycle.
3. **Cleaning Cycle:** The appliance will perform a 15-minute cleaning cycle using artificial water swirl and sonic emulsion technology.
4. **Automatic Shut-off:** The machine will automatically turn off after 15 minutes.
5. **Remove and Rinse:** Once the cycle is complete, remove the cleaned items and rinse them under running water if necessary.

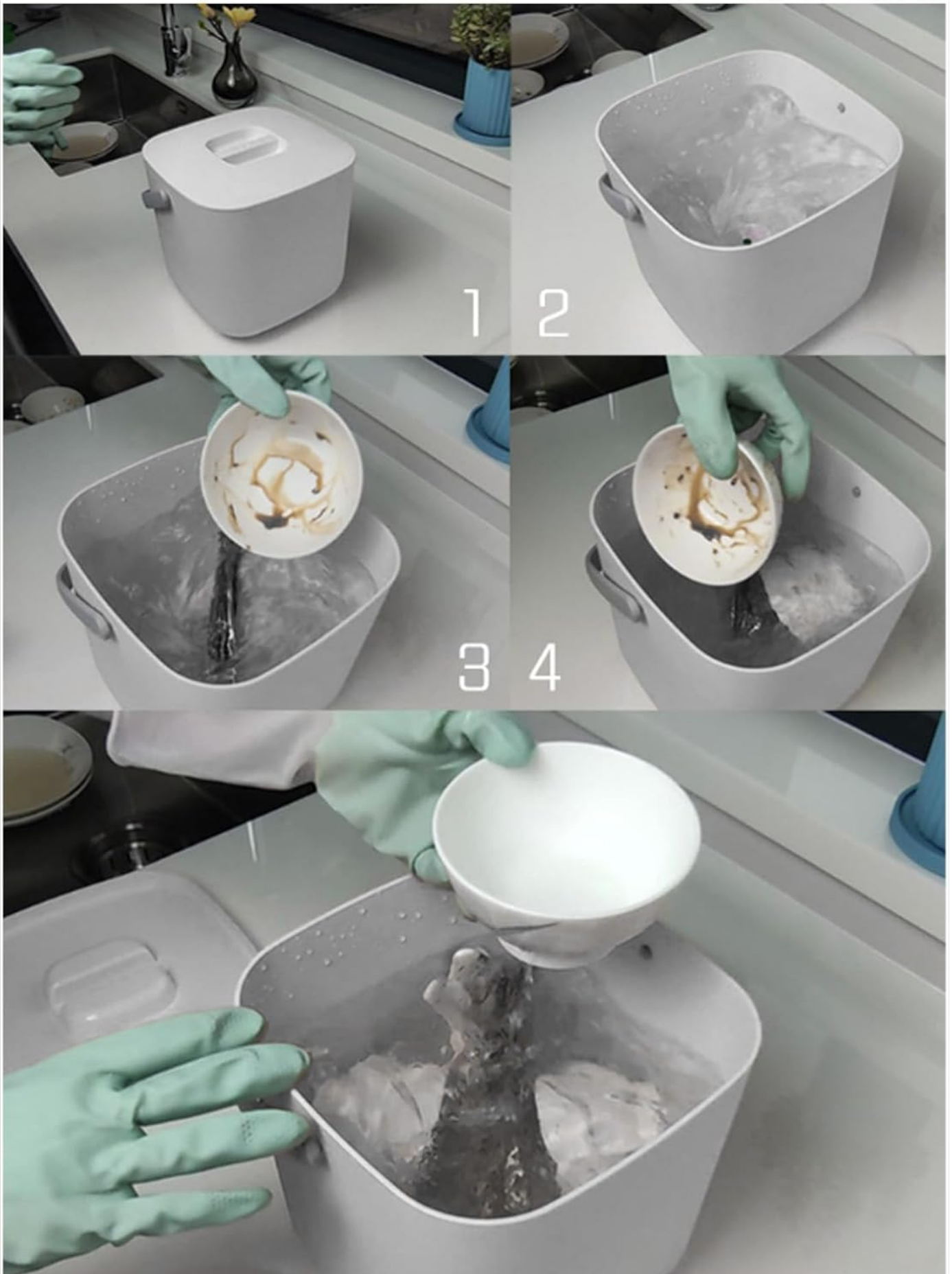

Image 5.1: Step-by-step illustration of the dishwashing process.



wash dishes  
wash the fruit  
wash the vegetable

Image 5.2: The dishwasher unit is suitable for washing dishes, fruits, and vegetables.



Artificial water swirl cleaning  
Sonic emulsion cleaning  
360 degree deep full cleaning  
15 minute timing shut off

Image 5.3: Features of the cleaning process, including automatic shut-off.

## 6. Maintenance

Regular cleaning and maintenance will ensure the longevity and optimal performance of your dishwasher.

- **After Each Use:** Empty any remaining water and food debris from the bucket and the dishwasher unit.
- **Cleaning the Unit:** Wipe the dishwasher unit with a soft, damp cloth. Do not use abrasive cleaners or scrubbers.
- **Cleaning the Bucket:** Wash the bucket and lid with warm, soapy water and rinse thoroughly.
- **Storage:** Store the appliance in a clean, dry place when not in use.

## 7. Troubleshooting

If you encounter any issues with your dishwasher, please refer to the following common solutions:

- **Dishwasher not turning on:** Ensure the unit is fully charged. Check the USB cable connection.
- **Poor cleaning performance:** Ensure sufficient water and detergent are used. Do not overload the dishwasher. Ensure the suction cup is securely attached to prevent movement during operation.

- **Unusual noise during operation:** Check for any obstructions inside the dishwasher unit. Ensure the unit is securely placed and not vibrating against the container.

If the problem persists, please contact customer support.

## 8. Specifications

Feature	Detail
Model Name	POCREATIONhwx3qfp7k2-11
Item Type	Mini Dishwasher
Material	ABS, PC
Product Dimensions	21 x 21 x 20 cm (8.3 x 8.3 x 7.9 inches)
Item Weight	904g (2.01 pounds)
Battery Type	LI-ion 18650, Lithium battery, 2000mAh (built-in)
Power	18W
Input Voltage	8.5V
Input Current	2A
Suction Power	45KPa
Special Features	Smart, Portable, Automatic Shut-Off
Recommended Uses	Everyday dishware and glassware, delicate china, fruits and vegetables
Cycle Options	Normal, Delicate, Fruits & Vegetables, Heavy Duty

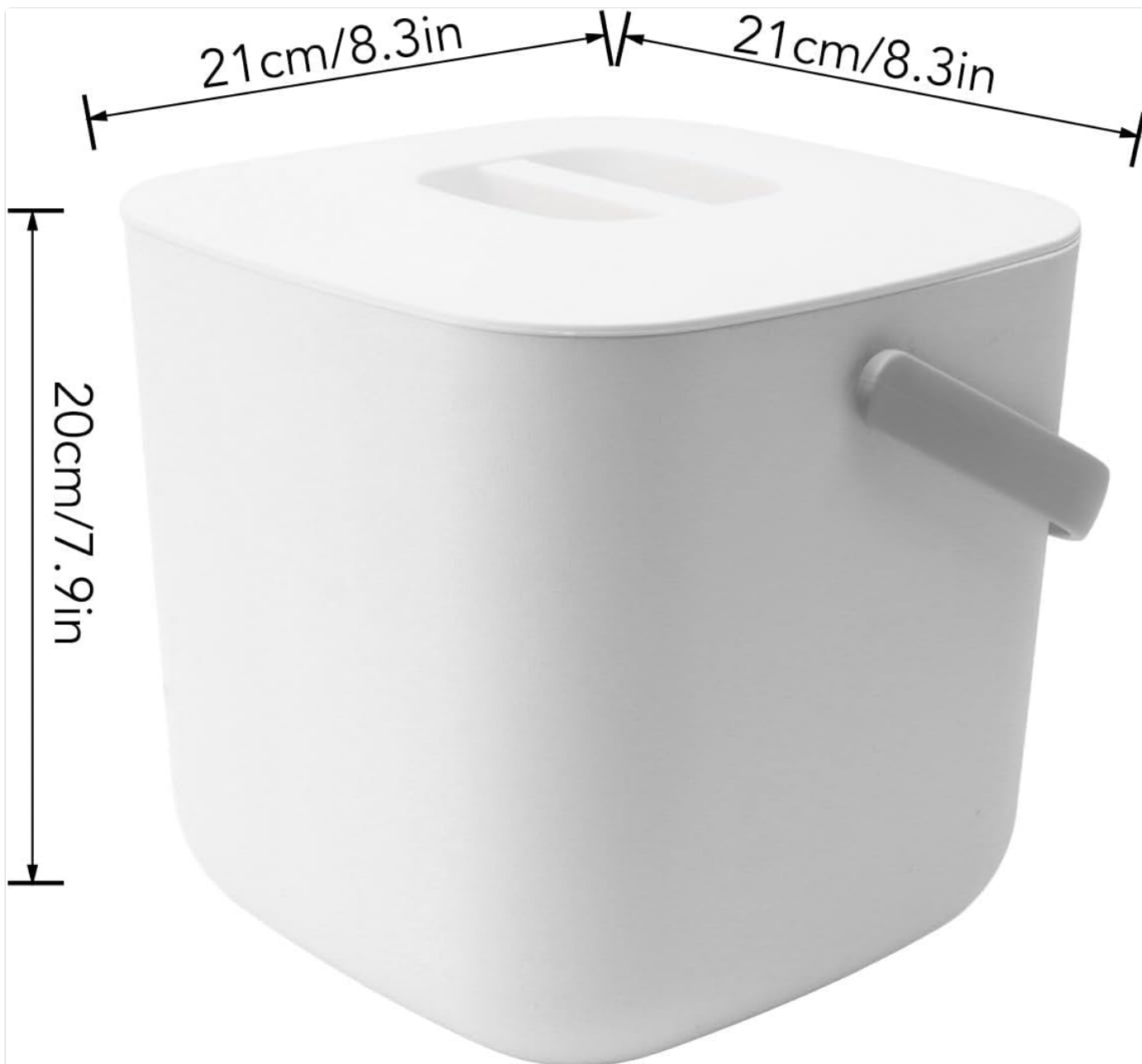

Image 8.1: Product dimensions.

## 9. Warranty and Support

**Warranty Information:** Please refer to your purchase documentation or contact your retailer for specific warranty details regarding this product.

**Customer Support:** For technical assistance, troubleshooting, or any other inquiries, please contact POCREATION customer service through the retailer's platform or the official POCREATION website.