

## Manuals+

[Q & A](#) | [Deep Search](#) | [Upload](#)

Manuals.plus /

- › [We Technology](#) /
- › Smart Glass Door Lock User Manual

## We Technology G05Y

# Smart Glass Door Lock User Manual

Brand: We Technology | Model: G05Y

## 1. INTRODUCTION

This manual provides comprehensive instructions for the installation, setup, operation, and maintenance of your We Technology Smart Glass Door Lock (Model G05Y). This advanced keyless entry system offers multiple unlocking methods and smart home integration for enhanced security and convenience.

Key features include:

- **5-in-1 Keyless Freedom:** Unlock using fingerprint, password, IC card, mechanical key, or remotely via the Tuya smart app.
- **Stable 2.4GHz WiFi Connectivity:** Direct connection to your home network without the need for an additional hub.
- **Sleek Design for Frameless Glass Doors:** Specifically designed for 10–12mm frameless glass doors, offering a minimalist and elegant aesthetic.
- **Built-In Doorbell + Dual-Side Keypad:** Integrated doorbell function and keypads on both sides for convenience.
- **Auto-Lock Function:** Automatically locks the door after closing for immediate security.
- **Weatherproof & Durable:** Constructed from aluminum alloy and ABS, sealed for indoor and outdoor use.
- **Battery-Powered with USB Backup:** Operates on 4 AA batteries with a USB port for emergency power supply.
- **Tool-Free Installation:** Designed for easy installation without drilling or special tools.
- **Tuya App & Alexa Voice Control:** Remote control, access sharing, real-time alerts via Tuya Smart App, and hands-free control with Alexa.
- **Anti-Tamper Alarm:** Built-in sensors trigger an alarm upon forced entry or tampering attempts.

## 2. SAFETY INFORMATION

Please read and understand all safety instructions before installing and operating the lock. Failure to follow these instructions may result in damage to the product, property, or personal injury.

- Ensure the door thickness is between 10mm and 12mm for proper installation.
- Use only 4 AA alkaline batteries. Do not mix old and new batteries or different types of batteries.

- Keep mechanical keys in a secure location outside the property.
- Avoid exposing the lock to extreme temperatures or direct sunlight for prolonged periods.
- Do not attempt to disassemble or repair the lock yourself. Contact qualified personnel for service.
- Regularly check the battery level and replace batteries promptly when low.
- Protect the fingerprint sensor and keypad from sharp objects or excessive force.

### 3. PACKAGE CONTENTS

---

Verify that all items listed below are included in your package:

- 1 x Double-sided Smart Glass Door Lock unit
- 1 x User Manual
- 2 x Mechanical Keys
- 2 x IC Cards
- Mounting Screws and Fixed Rubber Plates

# package List :

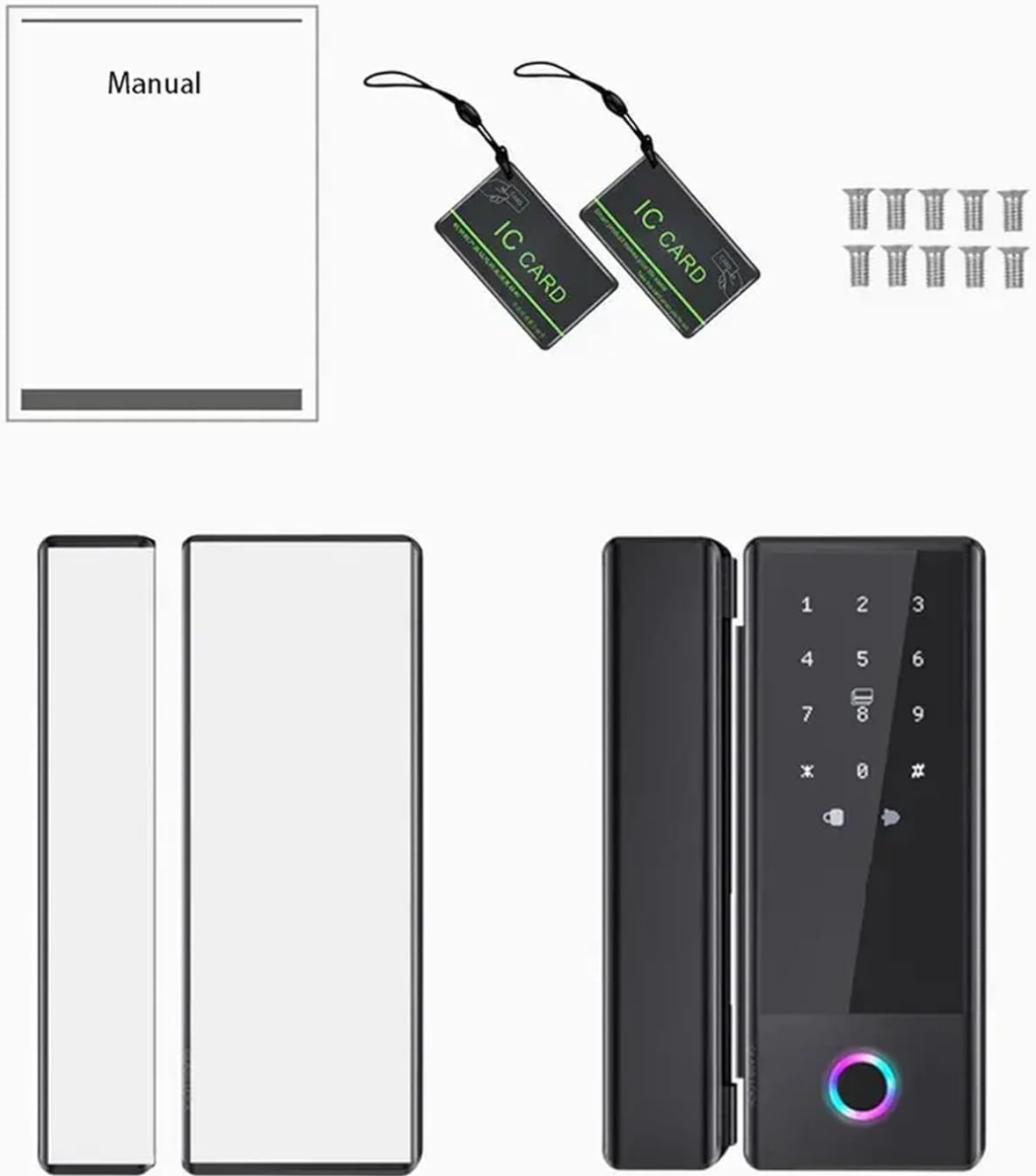

Image: The image displays the contents of the product package, including the smart lock unit, user manual, IC cards, and mounting hardware.

## 4. PRODUCT OVERVIEW AND COMPONENTS

Familiarize yourself with the different parts of your Smart Glass Door Lock:



Image: A detailed view of the smart lock's external and internal components, highlighting the keypad, fingerprint reader, battery compartment, and double bolt mechanism.

- **Touch Keypad:** For entering passwords.
- **Card Reading Area:** For IC card authentication.
- **Doorbell (Confirm Button):** Activates the doorbell function.
- **Lock Button (Return Button):** Used to lock the door and navigate menus.
- **Fingerprint Reader:** For fingerprint authentication.
- **Battery Box:** Houses 4 AA batteries.
- **USB Charging Port:** For emergency power supply.
- **Stainless Steel Double Hook Bolt:** The locking mechanism.
- **Switch Knob:** Manual lock/unlock from the inside.



Image: Another detailed view of the smart lock, showing the front panel with the keypad, fingerprint reader, and the side view revealing the battery cover and lock/unlock mechanism.

## 5. INSTALLATION

The We Technology Smart Glass Door Lock is designed for tool-free installation on frameless glass doors with a thickness of 10-12mm. No drilling is required.

### 5.1 Door Compatibility

Ensure your glass door meets the following dimensions:

- **Glass Thickness:** 10mm - 12mm (0.39 - 0.47 inches)
- **Lock Dimensions:** Approximately 7.3 x 2.75 x 1.57 inches (L x W x H)

## CHECK BEFORE ORDER



Image: This image illustrates the key dimensions of the smart lock and provides guidance on identifying right-handed versus left-handed door configurations for proper installation.

### 5.2 Installation Steps

1. Clean the surface of the glass door where the lock will be installed.
2. Attach the fixed rubber plates to the inner side of the lock units to protect the glass.
3. Align the two halves of the lock (front and back) on either side of the glass door.
4. Secure the units together using the provided mounting screws. Ensure the lock is firmly attached but do not overtighten to avoid damaging the glass.
5. Verify that the lock mechanism aligns correctly with the door frame or the other door if it's a double door.



Image: This image shows the essential components for installation, including the IC cards, screws, and fixed rubber plates, emphasizing the tool-free nature of the setup.

### 5.3 Door Opening Direction

The lock features intelligent induction for automatic recognition of left and right opening directions, simplifying installation and eliminating manual adjustments.



Image: This graphic illustrates how the smart lock automatically detects and adapts to both left-opening and right-opening double glass doors, ensuring versatile compatibility.

## 6. INITIAL SETUP AND APP INTEGRATION

---

To fully utilize the smart features of your lock, integrate it with the Tuya Smart App.

### 6.1 Adding an Administrator

1. On the lock keypad, press \* then # to enter the menu.
2. Follow the voice prompts to add an administrator.
3. Add an administrator fingerprint and/or IC card.

Your browser does not support the video tag.

Video: This video demonstrates the process of linking the Smart Glass Door Lock to the Tuya Smart App, including adding an administrator fingerprint and IC card.

### 6.2 Linking to Tuya Smart App

1. Enter the administrator's fingerprint on the lock to access the menu.
2. Select "System Settings" and then "Wireless Device".
3. Turn on the wireless device option. The lock will enter pairing mode (indicated by a flashing light).
4. Open the Tuya Smart App on your smartphone.
5. Click "Add Device" and follow the on-screen instructions to connect the lock to your 2.4GHz WiFi network.
6. Once successfully added, you can manage the lock remotely via the app.



Image: This image shows the smart lock integrated with the Tuya Smart App on a smartphone, demonstrating remote control capabilities.

## 7. OPERATING THE LOCK

Your We Technology Smart Glass Door Lock offers multiple convenient ways to unlock and manage access.

### 7.1 Unlocking Methods

- **Fingerprint Unlock:** Place your registered finger on the fingerprint reader. The lock will unlock in approximately 0.5 seconds with a 99.9% recognition rate.



Image: This graphic illustrates the rapid and accurate fingerprint recognition feature of the smart lock, highlighting its biometric identification speed and high recognition rate.

- **Password Unlock:** Enter your registered password on the touch keypad. The lock supports anti-peeping passwords, allowing you to enter random digits before or after your actual password for added security.



Image: This graphic demonstrates the password unlocking method, showcasing the anti-peeping feature where random digits can be entered before or after the actual password for enhanced privacy.

- **IC Card Unlock:** Tap your registered IC card on the card reading area.



Image: This graphic illustrates the IC card unlocking method, showing a user tapping an IC card to the lock's sensor for quick and convenient access.

- **Mechanical Key Unlock:** Use the provided mechanical keys as a traditional backup.
- **Tuya App Remote Unlock:** Open the Tuya Smart App and tap the unlock icon. You may need to confirm the

remote opening.



Image: This graphic depicts the Tuya Smart App interface on a smartphone, demonstrating how users can remotely unlock the smart door lock with a simple tap.

- **Voice Control (Alexa/Google Assistant):** Integrate with Amazon Alexa or Google Assistant for hands-free voice commands.

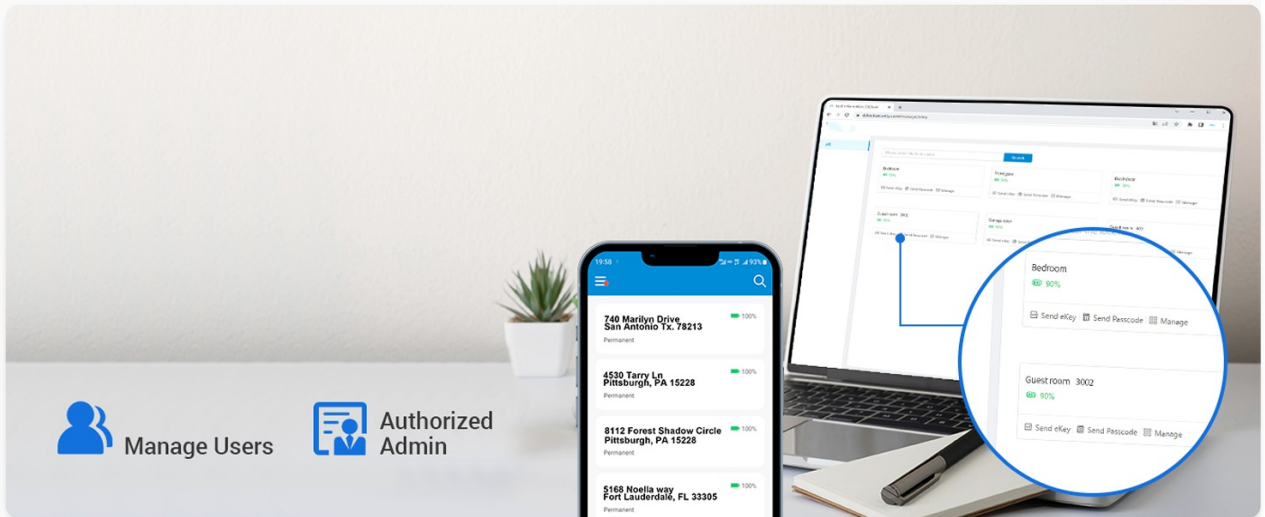

Image: This graphic illustrates the smart lock's compatibility with Amazon Alexa and Google Assistant, showing a user interacting with a smart speaker to unlock the door using voice commands.

## 7.2 Auto-Lock Function

The lock features an auto-lock function that engages automatically after the door closes. The auto-lock delay can typically be configured via the app (default 5-1800 seconds).



Image: This graphic highlights the auto-lock feature of the smart lock, which automatically secures the door after a set period (5-1800 seconds), and also shows a one-touch locking option for immediate security.

### 7.3 Doorbell Function

Press the doorbell icon on the lock's keypad to activate the built-in doorbell. You will receive a notification on your Tuya Smart App, allowing you to open the app and respond.

### 7.4 Temporary Passwords

Generate temporary passwords for guests or service providers through the Tuya Smart App. You can set the effective time and expiration time for these passwords.



Image: This image shows the Tuya Smart App interface for generating temporary passwords, allowing users to create time-limited access codes for visitors.

## 8. MAINTENANCE

Proper maintenance ensures the longevity and optimal performance of your smart lock.

- **Cleaning:** Wipe the lock surface with a soft, dry cloth. Avoid abrasive cleaners or solvents that could damage the finish or electronic components.
- **Battery Replacement:** The lock is powered by 4 AA alkaline batteries. When the battery level is low, the lock will provide a low battery warning. Replace all four batteries simultaneously.



Image: This graphic illustrates the dual power supply system, showing the use of 4 AA batteries for normal operation and a USB port for emergency power supply via a power bank when batteries are depleted.

- **Emergency Power:** If batteries run out, connect a power bank to the Micro USB hole on the lock for temporary power to unlock.
- **Fingerprint Sensor Care:** Keep the fingerprint sensor clean and dry for accurate readings.

## 9. TROUBLESHOOTING

If you encounter issues with your smart lock, refer to the following common problems and solutions:

Problem	Possible Cause	Solution
Lock not responding / No power	Dead batteries.	Replace all 4 AA batteries. Use a power bank via the USB port for emergency power.
Fingerprint not recognized	Fingerprint sensor is dirty or wet; Fingerprint not registered correctly; Fingerprint has changed (e.g., injury).	Clean the sensor. Re-register your fingerprint. Try another unlocking method.
Cannot connect to WiFi / App	Incorrect WiFi password; Router is too far; Not on 2.4GHz network.	Verify WiFi password. Move router closer or install a WiFi extender. Ensure your router is set to 2.4GHz. Re-initiate pairing mode on the lock.
Temporary password invalid	Password expired; Incorrect password entered.	Check the validity period in the app. Generate a new temporary password. Ensure correct entry.
Anti-tamper alarm triggers frequently	Sensitive settings; Physical impact.	Adjust alarm sensitivity in the app settings if available. Ensure the lock is not being accidentally bumped.

## 10. SPECIFICATIONS

<b>Brand</b>	We Technology
--------------	---------------

<b>Model Name</b>	Smart Glass Door Lock (G05Y)
<b>Lock Type</b>	Biometric, Deadbolt
<b>Special Features</b>	Alarm, Anti-Peeping Password, Auto-Lock, One-Touch Lock, Weather Resistant
<b>Item Dimensions (L x W x H)</b>	7.3 x 2.75 x 1.57 inches
<b>Material</b>	Aluminum
<b>Color</b>	Black
<b>Power Source</b>	4 x AA Alkaline Batteries (Included)
<b>Connectivity Protocol</b>	Bluetooth, Wi-Fi (2.4GHz)
<b>Control Method</b>	App, Remote, Touch
<b>Controller Type</b>	Amazon Alexa, Android, Google Assistant, iOS
<b>Included Components</b>	1 x double sided door lock, 1 x manual, 2 x keys, 2 x IC Card
<b>Item Weight</b>	3.08 pounds

## 11. WARRANTY AND SUPPORT

---

We Technology products are designed for reliability and performance. For warranty information and technical support, please refer to the contact details provided in your product packaging or visit the official We Technology website.

For common inquiries, please consult the troubleshooting section of this manual or the FAQ section on our website. If further assistance is needed, our customer support team is available to help.

**Contact Information:** Please refer to the contact details provided in your product packaging or the official We Technology website for the most up-to-date support information.