

Amopatio 5 PCS/5 Seats

Amopatio 5-Piece Wicker Outdoor Sectional Sofa with Swivel Rocker Chairs Instruction Manual

Model: 5 PCS/5 Seats | Brand: Amopatio

1. INTRODUCTION

Thank you for choosing the Amopatio 5-Piece Wicker Outdoor Sectional Sofa with Swivel Rocker Chairs. This manual provides essential information for the safe assembly, operation, and maintenance of your new patio furniture set. Please read these instructions carefully before assembly and retain them for future reference.



Image 1.1: The Amopatio 5-Piece Wicker Outdoor Sectional Sofa Set, featuring a 3-seat sofa, two swivel rocker chairs, a storage coffee table, and a side table, arranged on a patio next to a pool.

2. PRODUCT FEATURES

This Amopatio patio furniture set is designed for comfort and durability in outdoor environments. Key features include:

- **Premium All-Weather Construction:** Hand-woven with high-quality PE rattan, this set is UV-resistant, waterproof, fade-proof, and crack-resistant. The durable structure ensures reliable performance and maintains an elegant appearance for years, suitable for year-round outdoor use.

All-Weather Handwoven Wicker



Image 2.1: A close-up view of the furniture's handwoven PE rattan, highlighting its all-weather, UV-protected, and anti-aging properties.

- **360° Swivel & Gliding Rocker Chairs:** The two included chairs feature a smooth 360° swivel and gentle back-and-forth gliding function, allowing for easy movement and relaxation. This versatile seating enhances comfort and convenience in any outdoor setting.

Swivel 360° Degrees

✓ 200lbs Capacity

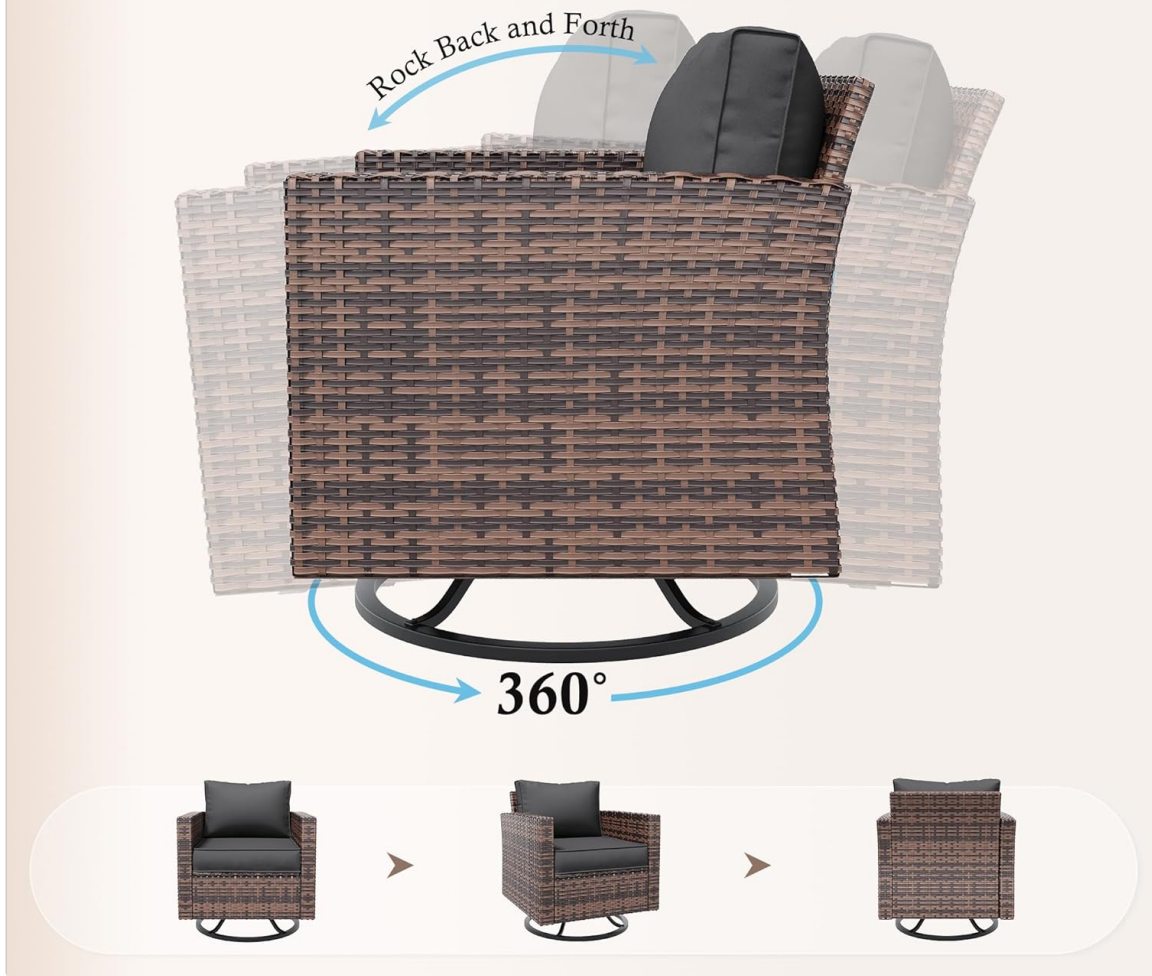

Image 2.2: A diagram illustrating the 360-degree swivel and rocking capabilities of the chairs, with a 200 lbs capacity indicated.

- **Thick Comfortable Cushions:** The set includes thick, high-density foam cushions for soft yet supportive seating. The cushion covers are made of high-grade Olefin fabric, which is water-resistant, fade-resistant, wear-resistant, and easy to remove and clean.



Image 2.3: A close-up of a chair highlighting the fully supported back cushion and the high-performance, water-resistant outdoor fabric.

- **Storage Coffee Table & Waterproof Covers:** The patio set comes with a large-capacity storage coffee table (60-gallon capacity) for organizing cushions, tools, magazines, or other outdoor supplies. Waterproof covers (excluding the side table) are included to protect the furniture against rain, dust, and UV damage, extending its lifespan.

Storage Coffee Table

Chic Coffee Table – Elevate
Your Outdoor Style



Image 2.4: The storage coffee table with its lid open, demonstrating its capacity for storing various outdoor items like toys, pillows, and books.

Product Size Information

Ship in **3 Packages**, May Not Arrive at the Same Time



1 x 3-Seat Sofa



2 x Swivel Rocker Chairs

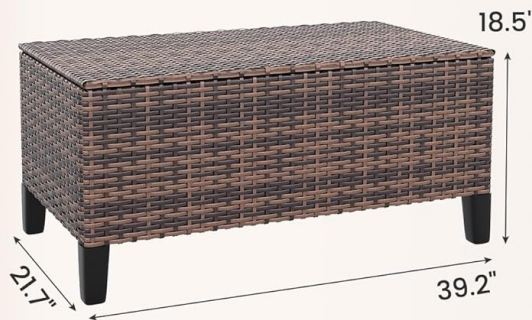

1 x Coffee Table



1 x Side Table

Image 2.5: The patio furniture set protected by all-weather covers during rainy conditions, illustrating protection against UV, rain, snow, and dust.

- **Flexible & Wide Application:** This modular outdoor conversation set can be freely arranged to fit various spaces, from small balconies to large backyards, decks, gardens, porches, and poolside areas. It combines modern style with practical functionality.

3. PACKAGE CONTENTS

The Amopatio 5-Piece Wicker Outdoor Sectional Sofa Set includes the following components. Please verify all parts are present before beginning assembly.

- 1 x 3-Seat Sofa
- 2 x Swivel Rocker Chairs
- 1 x Storage Coffee Table
- 1 x Side Table
- Associated cushions and hardware for assembly.



Image 3.1: Product size information and component breakdown, indicating the set ships in 3 packages.

4. SETUP AND ASSEMBLY

Assembly is required for this patio furniture set. Please follow the detailed instructions provided in the separate assembly guide included with your package. Ensure all hardware is securely fastened, but do not overtighten until all components are aligned. It is recommended to assemble the furniture on a soft, clean surface to prevent scratches.

For visual assistance, please refer to the official product video below, which demonstrates the product's features and potential setup scenarios.

Your browser does not support the video tag.

Video 4.1: Official Amopatio product video showcasing the wicker patio furniture with swivel chairs, demonstrating its features and placement in various outdoor settings. This video is provided by the seller, Amopatio.

5. OPERATING INSTRUCTIONS

5.1 Using the Swivel Rocker Chairs

The swivel rocker chairs are designed for dynamic comfort. Simply sit in the chair and gently push off the ground with your feet to initiate a rocking motion. The chair base allows for a full 360-degree rotation, enabling you to easily change your viewing direction without repositioning the entire chair.

5.2 Accessing the Storage Coffee Table

To access the storage compartment of the coffee table, gently lift the tabletop. The lid is designed to open smoothly, revealing the spacious 60-gallon interior. Close the lid securely after use to protect stored items from the elements.

6. MAINTENANCE

6.1 Rattan Frame Care

The PE rattan is designed for outdoor durability. To clean, wipe with a soft cloth dampened with mild soap and water. Rinse thoroughly with clean water and allow to air dry. Avoid using harsh chemicals or abrasive cleaners, as these can damage the rattan finish.

6.2 Cushion Care

The Olefin fabric cushion covers are water-resistant and removable for cleaning. Unzip the covers and machine wash them on a gentle cycle with cold water and mild detergent. Air dry only; do not tumble dry or iron. For spills, blot immediately with a clean cloth. Ensure cushions are completely dry before storing or replacing covers to prevent mildew.

6.3 Using the Waterproof Covers

Utilize the provided waterproof covers to protect your furniture set (excluding the side table) during inclement weather or extended periods of non-use. Ensure the furniture is clean and dry before covering to prevent moisture buildup and potential damage. Secure the covers to prevent them from blowing away in windy conditions.

7. TROUBLESHOOTING

7.1 Loose Connections

If any part of the furniture feels wobbly or unstable, check all bolts and screws. Tighten them using the appropriate tools, but avoid overtightening to prevent stripping or damage to the frame.

7.2 Cushion Slippage

The cushions are designed with a non-slip dot design on the underside to minimize movement. If cushions still slip, ensure they are properly seated and consider adding additional non-slip pads if necessary.

7.3 Rattan Damage

Minor fraying or damage to the PE rattan can often be repaired with a strong, clear adhesive. For significant damage, please contact Amopatio customer support for assistance.

8. SPECIFICATIONS

Attribute	Detail
Brand	Amopatio
Model	5 PCS/5 Seats
Color	Brown/Grey
Assembly Required	Yes
Material	PE Rattan, Olefin Fabric, High-Density Foam
Coffee Table Storage Capacity	60 Gallons
Swivel Chair Weight Capacity	200 lbs (per chair)

9. WARRANTY AND SUPPORT

For any questions regarding assembly, missing parts, or product performance, please contact Amopatio customer support. Refer to your purchase documentation for specific warranty details and contact information. Our team is dedicated to providing assistance and ensuring your satisfaction. You can often find support contact details on the Amopatio store page or through your original retailer.