

AquilaPro KL02100

AquilaPro KL02100 328ft Laser Measuring Tool Instruction Manual

Model: KL02100

1. INTRODUCTION

This manual provides detailed instructions for the safe and effective operation of your AquilaPro KL02100 Laser Measuring Tool. Please read this manual thoroughly before using the device to ensure proper functionality and to prevent potential hazards. This device is designed for accurate distance measurement in various applications.

2. SAFETY INFORMATION

WARNING: Laser Radiation. Do not stare into beam. Class II Laser Product.

- The AquilaPro KL02100 emits a visible laser beam with a power output of less than 1mW.
- Avoid direct eye exposure to the laser beam. Never point the laser at people or animals.
- Do not disassemble or modify the device. Unauthorized modifications can result in hazardous laser radiation exposure.
- Keep the device out of reach of children.
- Use only as described in this manual.

3. PRODUCT OVERVIEW

The AquilaPro KL02100 is a compact and versatile laser distance meter. Familiarize yourself with its components and display.

3.1 Device Components

The device features a durable aluminium casing, an HD display, and intuitive buttons for various functions.



Image: Front view of the AquilaPro KL02100 Laser Measuring Tool.

3.2 Display and Button Layout

The device's display provides measurement readings and status indicators. The buttons control power, measurement functions, unit switching, and reference point selection.



Image: Detailed view of the AquilaPro KL02100 display and button functions. Labels indicate 'screen', 'Single measurement / Unit switch', 'Addition / subtraction measurement', 'Funtion / Front/rear reference', 'History / Preset value setting', and 'Power / Backlight button'.

4. SETUP

4.1 Charging the Device

The AquilaPro KL02100 features a built-in Lithium-Ion battery and is USB rechargeable. Connect the device to a standard USB power source using the provided cable. The battery indicator on the display will show charging status.

4.2 Power On/Off

- To power on: Press the **Power/Backlight button** () briefly.
- To power off: Press and hold the **Power/Backlight button** for approximately 3 seconds. The device will also automatically power off after a period of inactivity to conserve battery.

5. OPERATING INSTRUCTIONS

5.1 Basic Measurement (Single Measurement)

1. Power on the device.
2. Point the laser beam at the target surface.
3. Press the **Single measurement / Unit switch button** () once. The measurement will be displayed instantly.

5.2 Continuous Measurement

1. Press and hold the **Single measurement / Unit switch button** () for approximately 2 seconds. The device will enter continuous measurement mode, displaying real-time distance updates as you move.
2. Press the **Single measurement / Unit switch button** again to exit continuous measurement.

5.3 Unit Switching

To change the measurement unit (meters, inches, feet), briefly press the **Single measurement / Unit switch button** () while the device is idle (not actively measuring). The unit will cycle through m, in, ft.

5.4 Benchmark Switching (Front/Rear Datum)

The device allows you to select the measurement reference point: either from the front edge of the device or the rear edge. This is crucial for accurate measurements depending on your placement of the tool.

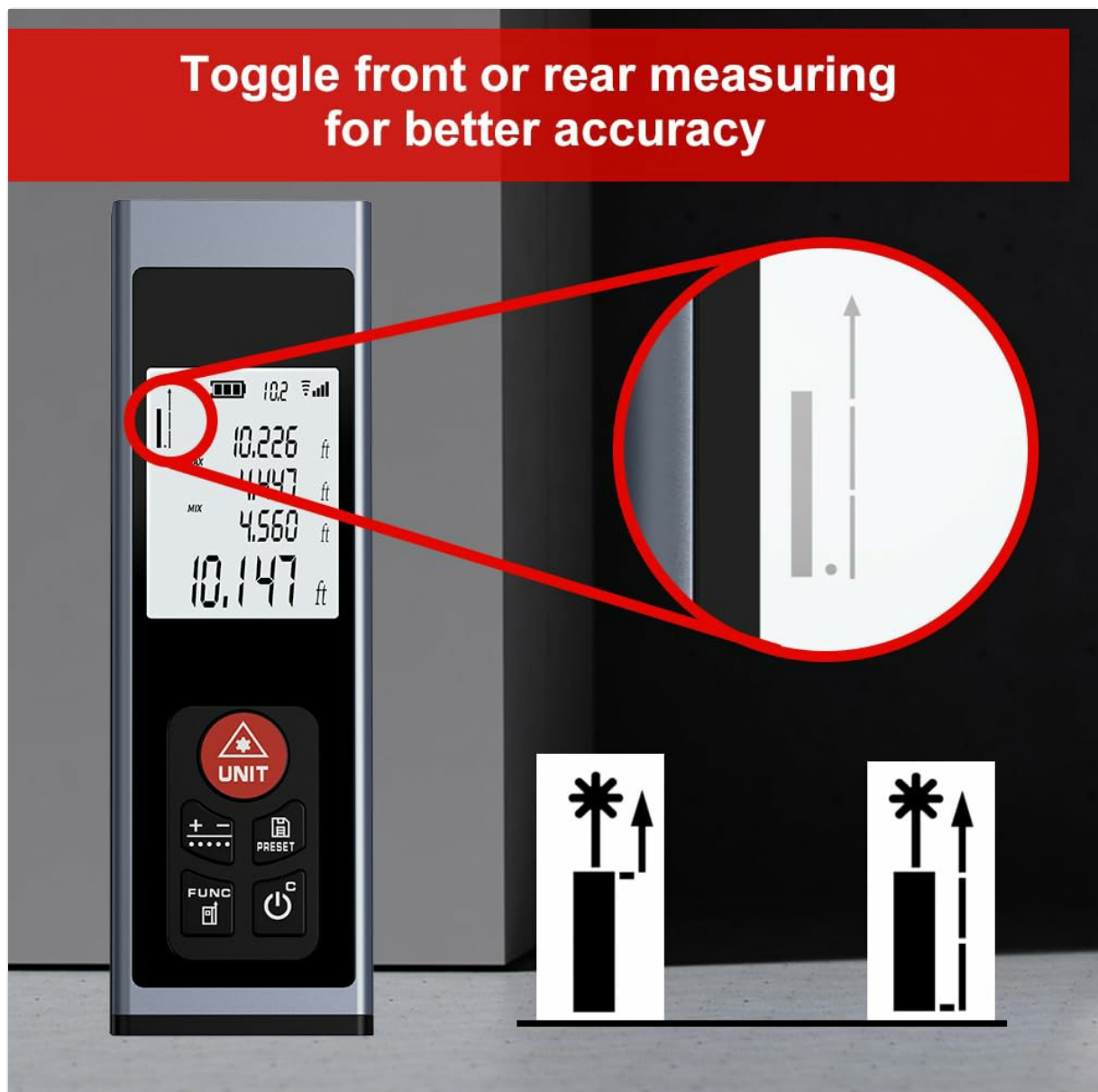

Image: Illustration of front and rear datum points for measurement. The device can measure from its front edge or its rear edge.

To switch the benchmark, press the **Function / Front/rear reference button** () briefly. An icon on the display will indicate the currently selected reference point.

5.5 Multiple Measurement Modes

The AquilaPro KL02100 supports various measurement functions for different applications.

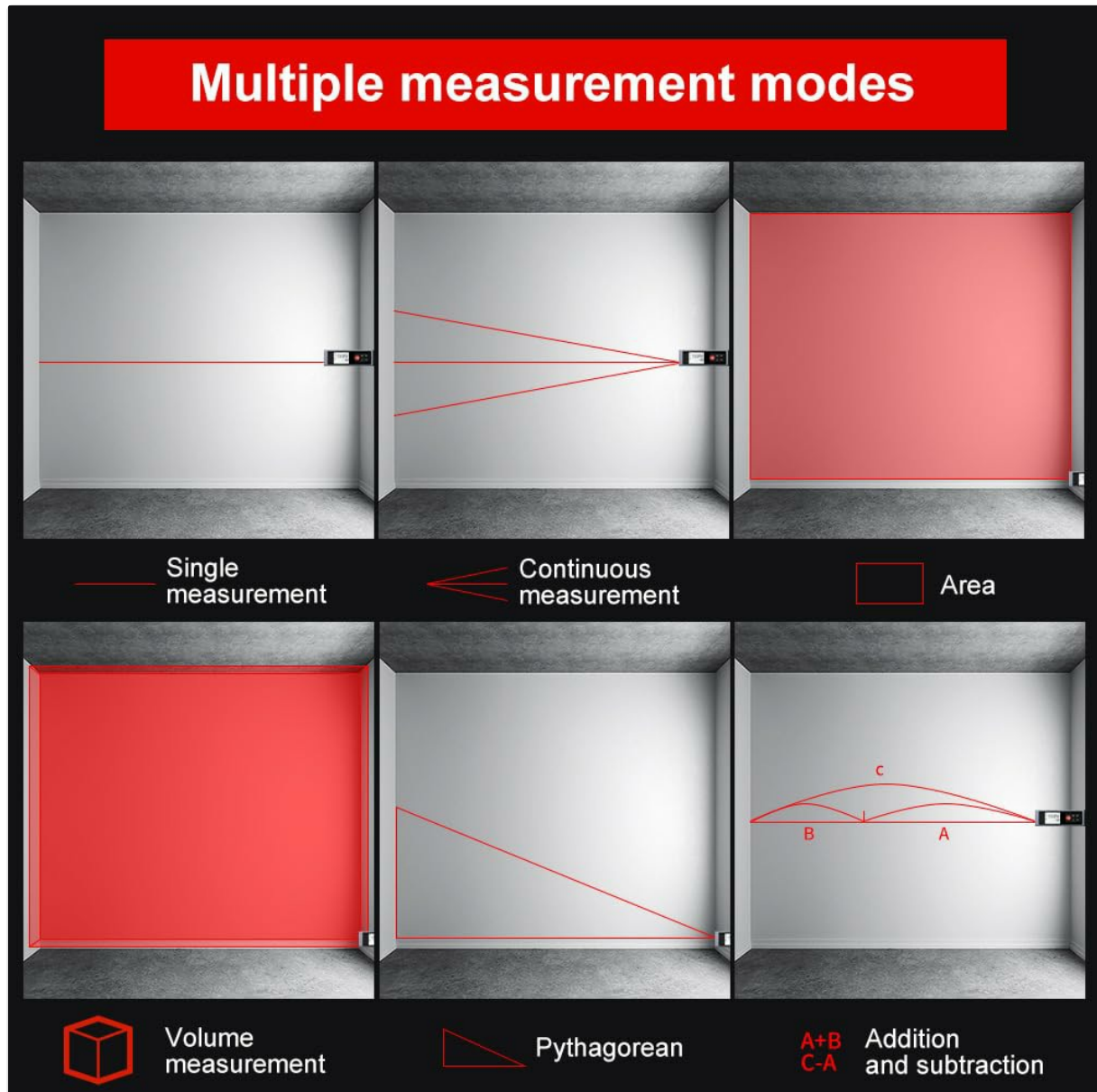

Image: Visual representation of the different measurement modes available on the device, including single, continuous, area, volume, Pythagorean, and addition/subtraction.

To cycle through measurement modes, press the **Function / Front/rear reference button** () repeatedly until the desired mode icon appears on the display.

- **Length Measurement:** Standard single or continuous measurement.
- **Area Measurement:** Measure two sides (length and width) to calculate the area.
- **Volume Measurement:** Measure three sides (length, width, height) to calculate the volume.
- **Pythagorean Measurement (Indirect Measurement):** Used to calculate inaccessible distances (e.g., height of a building) by measuring two or three other distances. Follow the on-screen prompts for each segment measurement.
- **Addition/Subtraction:** Add or subtract measurements.

Addition/Subtraction Function



Image: The device display illustrating the addition and subtraction functions, showing how multiple measurements are combined or differentiated.

5.6 Field Measurement

The real-time measurement mode allows for on-the-go calculations from walls and various surfaces as you move, providing dynamic distance updates.

Field measurement

The real-time measurement mode enables on-the-go calculations from walls and various surfaces as you move



Image: A hand holding the AquilaPro KL02100, demonstrating its use for field measurements with the laser beam active.

6. MAINTENANCE

- **Cleaning:** Use a soft, damp cloth to clean the device. Do not use abrasive cleaners or solvents. Pay special attention to keeping the laser lens clean for accurate measurements.
- **Storage:** Store the device in a cool, dry place, away from direct sunlight and extreme temperatures.
- **Battery:** Recharge the battery regularly, even if the device is not used frequently, to maintain battery health.

7. TROUBLESHOOTING

Problem	Possible Cause	Solution
Device does not power on	Low battery; Device malfunction	Charge the battery; Contact support if issue persists

Problem	Possible Cause	Solution
Inaccurate measurements	Dirty laser lens; Incorrect benchmark setting; Unstable surface	Clean the laser lens; Verify benchmark (front/rear); Ensure stable measurement surface
Laser beam not visible	Bright ambient light; Device malfunction	Use in lower light conditions; Contact support

8. SPECIFICATIONS

- **Brand:** AquilaPro
- **Model Number:** KL02100
- **Measuring Range:** 328ft (100m)
- **Accuracy:** ±0.078 inch (2mm)
- **Units:** Meters (m), Inches (in), Feet (ft)
- **Laser Class:** Class II, <1mW
- **Battery Type:** Lithium-Ion (Rechargeable via USB)
- **Material:** Aluminium
- **Item Weight:** 25 Grams
- **Product Dimensions:** 28L x 15W x 86H Millimeters
- **Water Resistance Level:** IP54
- **Included Components:** Lanyard

9. WARRANTY AND SUPPORT

For warranty information and technical support, please refer to the documentation provided at the point of purchase or contact AquilaPro customer service. Keep your purchase receipt as proof of purchase.