

## DeerRun BA06

# DeerRun BA06 Walking Pad Treadmill User Manual

Model: BA06 | Brand: DeerRun

## 1. INTRODUCTION

---

Thank you for choosing the DeerRun BA06 Walking Pad Treadmill. This manual provides essential information for the safe and efficient use of your new fitness equipment. Please read all instructions carefully before operation and retain this manual for future reference.

### Important Safety Information

- Always consult with a healthcare professional before starting any new exercise program.
- Ensure the treadmill is placed on a flat, stable surface away from water and heat sources.
- Keep children and pets away from the treadmill during operation.
- Wear appropriate athletic footwear.
- Do not operate the treadmill if it is damaged or malfunctioning.
- The maximum user weight capacity for this treadmill is 300 lbs (136 kg).

## 2. PRODUCT OVERVIEW

---

The DeerRun BA06 Walking Pad Treadmill is designed for home use, offering a compact and convenient way to stay active. It features smart control options, a clear LED display, and a quiet motor for an optimal workout experience.

### Key Features

- **APP-Controlled Workouts & Community Engagement:** Control your walking pad via the PitPat app, track progress, participate in challenges, and connect with a fitness community.
- **Dynamic LED Display & Remote Control:** Monitor speed, time, distance, and calories. Adjust speed and stop the treadmill with the included remote control.
- **Quiet and Powerful Performance:** Equipped with a 2.5HP motor, supporting users up to 300 lbs, with ultra-quiet operation and speeds from 0.6 to 3.8 mph.
- **Secure and Comfortable Stride:** Features a 15.48" x 39.48" non-slip running belt with shock absorption, supported by a robust steel frame.
- **Space-Efficient Design:** Compact and lightweight with built-in wheels for easy movement and storage under desks,

sofas, or beds.

## Included Components

Your DeerRun BA06 Walking Pad Treadmill package includes the following items:

- Treadmill Base
- Motor Housing
- Remote Control
- Power Cord
- Lubricating Oil
- L-shaped Wrench
- Screwdriver
- User Manual

**Burn More. Sit Less.**  
A Smarter Way to Stay Active Every Day

Icons: Heart, Bluetooth, PitPat logo (An online competition platform)

App Screenshots:

- Courses:** Aerobic Exercises, Walking, Warm-up, Muscle Build, Aerobic Exercise, Instruction, HIIT Training, Stretch.
- Social Club:** Community Club, My, Events, RANKING, PICKS, OWNED, JOINED, PitPat Pro League Grand, PitPat Q&A/Feedback, Old Gamers, PitPat Runners/Walkers.
- Record Data:** Statistics, Sync data to Health, Total 47358 mins, Running 345.15 km, Cycling 63.17 km, Time 789:18:47, Distance 408.66 km, Calories 27483 kcal, Days 109, Exercise Times 196.
- Bluetooth & Remote Control:** Free Running, Accelerate slowly and stay focused at high speeds to prevent falls, 0.00 miles, 3 miles/h, 10:12:21, 1032 kcal, Speed 6, 9, Speed-, Stop, Speed+.

Labels: Courses, Social Club, Record Data, Bluetooth & Remote Control

Figure 2.1: Included Components

### 3. SETUP

The DeerRun BA06 Walking Pad Treadmill requires no assembly. Follow these steps to prepare your treadmill for first use:

1. **Unpack the Treadmill:** Carefully remove the treadmill and all accessories from the packaging. Retain the original packaging for potential future returns or transport.
2. **Choose a Location:** Place the treadmill on a firm, level surface. Ensure there is adequate clear space around the treadmill (at least 2 feet on all sides and 6 feet behind) for safe operation.
3. **Connect Power:** Plug the power cord into the treadmill's power input port, then plug the other end into a grounded electrical outlet. Ensure the power switch on the treadmill is in the 'ON' position.
4. **Initial Inspection:** Before starting, visually inspect the running belt for any debris or damage. Ensure the belt is centered and tensioned correctly.



Figure 3.1: DeerRun Walking Pad Treadmill Ready for Use

### 4. OPERATING INSTRUCTIONS

#### Using the Remote Control

The included remote control allows for easy adjustment of your workout settings.

1. **Power On/Off:** Press the power button on the treadmill or the remote to turn the unit on or off.
2. **Start/Stop:** Press the 'Play/Pause' button on the remote to start or pause the treadmill. The treadmill will typically start with a 3-second countdown.
3. **Adjust Speed:** Use the '+' and '-' buttons on the remote to increase or decrease the walking speed. The speed range is 0.6 to 3.8 mph.

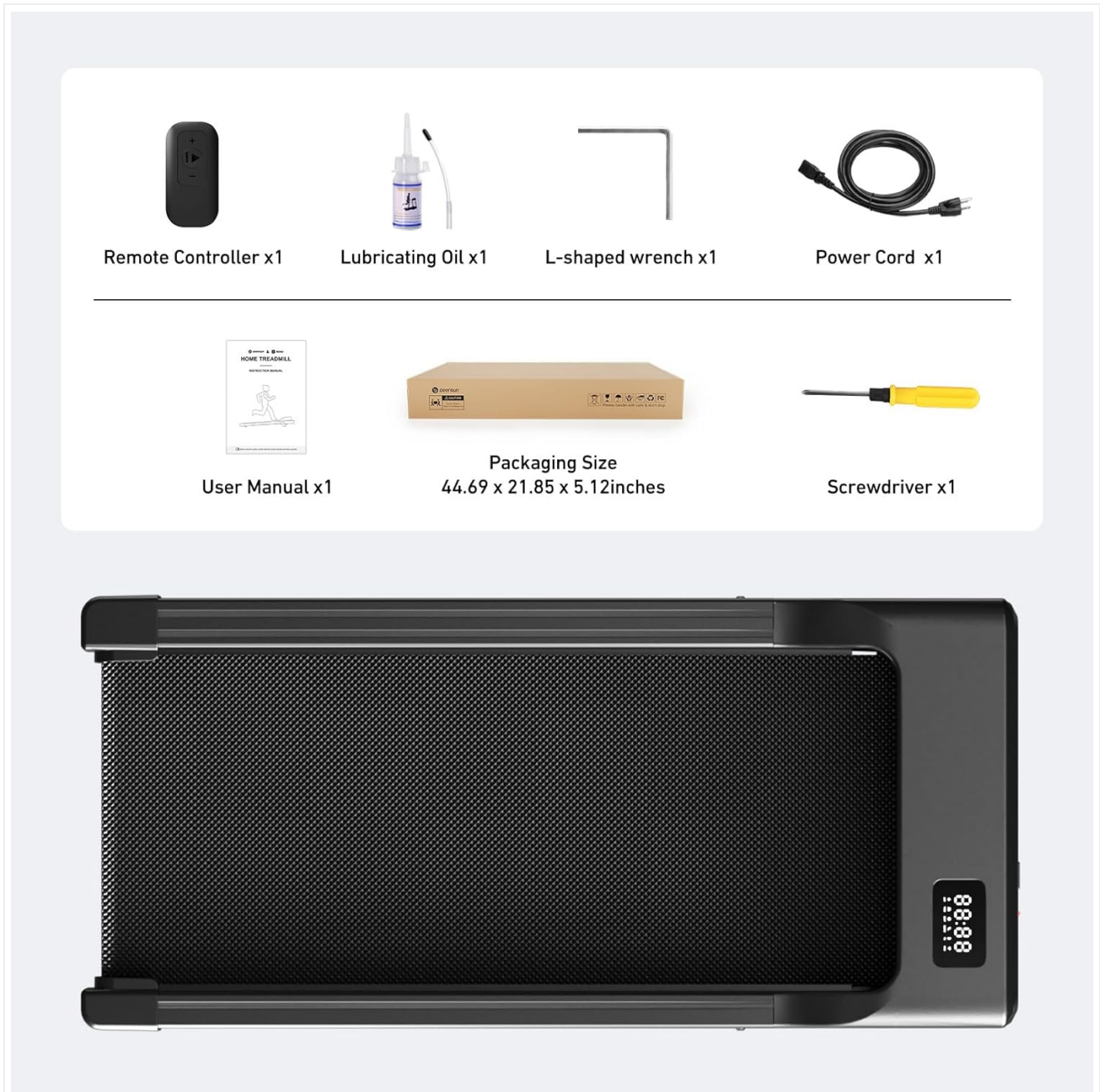

Figure 4.1: Operating with Remote Control

## Using the PitPat App

Enhance your workout experience by connecting your treadmill to the PitPat app.

1. **Download the App:** Search for 'PitPat' in your device's app store and install it.
2. **Connect to Treadmill:** Open the app and follow the on-screen instructions to pair your device with the DeerRun BA06 treadmill via Bluetooth.
3. **Control and Track:** Use the app to start/stop the treadmill, adjust speed, monitor your workout data (steps, calories, distance, time), and access various training programs and challenges.

## Space-Saving & Easy to Move



Figure 4.2: App Control Interface

### LED Display Information

The integrated LED display cycles through various workout metrics:

- **Speed:** Current walking/jogging speed (mph).
- **Time:** Duration of your workout.
- **Distance:** Total distance covered.
- **Calories:** Estimated calories burned.

### General Operation Tips

- Always step onto the treadmill when it is stationary or moving at a very low speed.
- Maintain a comfortable pace and adjust speed gradually.
- If you feel unwell, stop the treadmill immediately.

Your browser does not support the video tag. Please update your browser to view this content.

Video 4.3: DeerRun Walking Pad in Use (including incline demonstration)

## 5. MAINTENANCE

Regular maintenance ensures the longevity and optimal performance of your DeerRun BA06 Walking Pad Treadmill.

### Cleaning

- **Exterior:** Wipe down the treadmill's exterior with a soft, damp cloth after each use. Avoid abrasive cleaners.
- **Running Belt:** Periodically clean the running belt to remove dust and debris. Ensure the treadmill is unplugged before cleaning.

### Lubrication

The running belt requires lubrication to reduce friction and extend its lifespan. Use the provided lubricating oil or a compatible silicone-based treadmill lubricant.

1. **Frequency:** Lubricate the belt every 3-6 months, or after approximately 100 hours of use, depending on usage.
2. **Application:** Lift the edge of the running belt and apply a small amount of lubricant evenly along the center of the deck. Run the treadmill at a low speed for a few minutes to distribute the oil.

### Storage

The compact design and built-in wheels make storing your treadmill easy.

- **Moving:** Tilt the treadmill and use the transport wheels to move it to your desired storage location.
- **Placement:** Store it upright against a wall or horizontally under a bed or sofa.

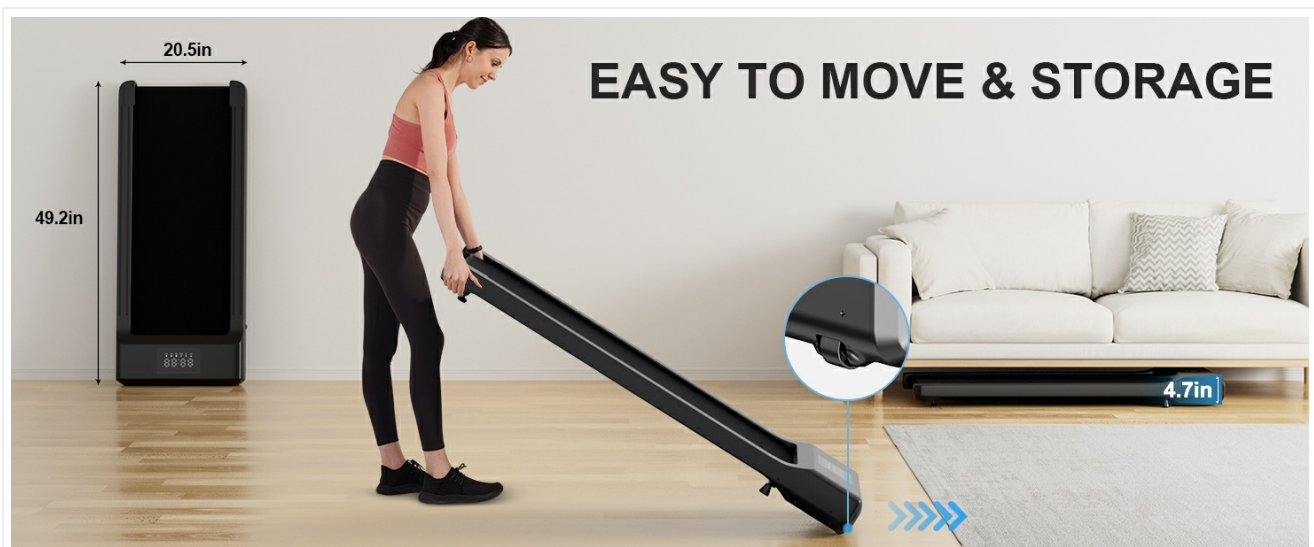

Figure 5.1: Easy Storage of the Walking Pad

## 6. TROUBLESHOOTING

If you encounter any issues with your DeerRun BA06 Walking Pad Treadmill, please refer to the following common problems and solutions:

Problem	Possible Cause	Solution
Treadmill does not power on.	Power cord not connected, power switch off, circuit breaker tripped.	Ensure power cord is securely plugged in, power switch is ON, and check your household circuit breaker.
Belt stops or slips during use.	Belt too loose, insufficient lubrication, motor overload.	Adjust belt tension (refer to maintenance section), apply lubricant, ensure user weight is within limits.

Problem	Possible Cause	Solution
Unusual noise during operation.	Loose components, belt friction, motor issue.	Check for loose screws and tighten. Lubricate the belt. If noise persists, contact customer support.
Remote control not responding.	Battery low or depleted, remote not paired.	Replace remote battery. Refer to the pairing instructions in the app or contact support for remote pairing.

If the problem persists after attempting these solutions, please contact DeerRun Customer Support.

## 7. SPECIFICATIONS

---

Below are the technical specifications for the DeerRun BA06 Walking Pad Treadmill:

Feature	Detail
Model Number	BA06
Brand	DeerRun
Product Dimensions (L x W x H)	132D x 62.5W x 16.5H Centimetres (52 x 24.6 x 6.5 inches)
Item Weight	38.34 Pounds (17.39 kg)
Material	Alloy Steel
Maximum Horsepower	2.5 HP
Speed Range	0.6 - 3.8 Miles per Hour
Maximum Weight Recommendation	300 lbs (113.4 kg)
Running Belt Dimensions (L x W)	39.8 x 15.4 Inches (101 x 39 cm)
Display Type	LED
Control Program Name	PitPat
Assembly Required	No

# Burn More. Sit Less.

A Smarter Way to Stay Active Every Day



Figure 7.1: Product Dimensions and Capacity

## 8. WARRANTY AND SUPPORT

DeerRun is committed to customer satisfaction. Your BA06 Walking Pad Treadmill comes with a comprehensive 12-month warranty from the date of purchase.

### Customer Support

For any questions, assistance, or warranty claims, please contact our dedicated support team:

- **Email:** [support@deerruntreadmill.com](mailto:support@deerruntreadmill.com)
- **Phone:** +1 888-589-0777

Our online support is available 24/7 to provide the assistance you need. Please keep your original packaging for hassle-free returns or service if required.

