

[Manuals.plus](#) /

› [FREELIGHT](#) /

› FREELIGHT 5/6 Inch 5CCT LED Recessed Light with Night Light User Manual

FREELIGHT 5/6 Inch 5CCT LED Recessed Light

FREELIGHT 5/6 Inch 5CCT LED Recessed Light with Night Light User Manual

This manual provides detailed instructions for the installation, operation, and maintenance of your FREELIGHT 5/6 Inch 5CCT LED Recessed Lights.

PRODUCT OVERVIEW

The FREELIGHT 5/6 Inch 5CCT LED Recessed Light is a versatile lighting solution designed for various indoor applications. It features two distinct lighting modes: a standard downlight mode with 5 selectable color temperatures and a warm 2000K night light mode. These lights are dimmable, ETL and FCC certified, and designed for easy retrofit installation into existing 5/6 inch recessed housing cans.

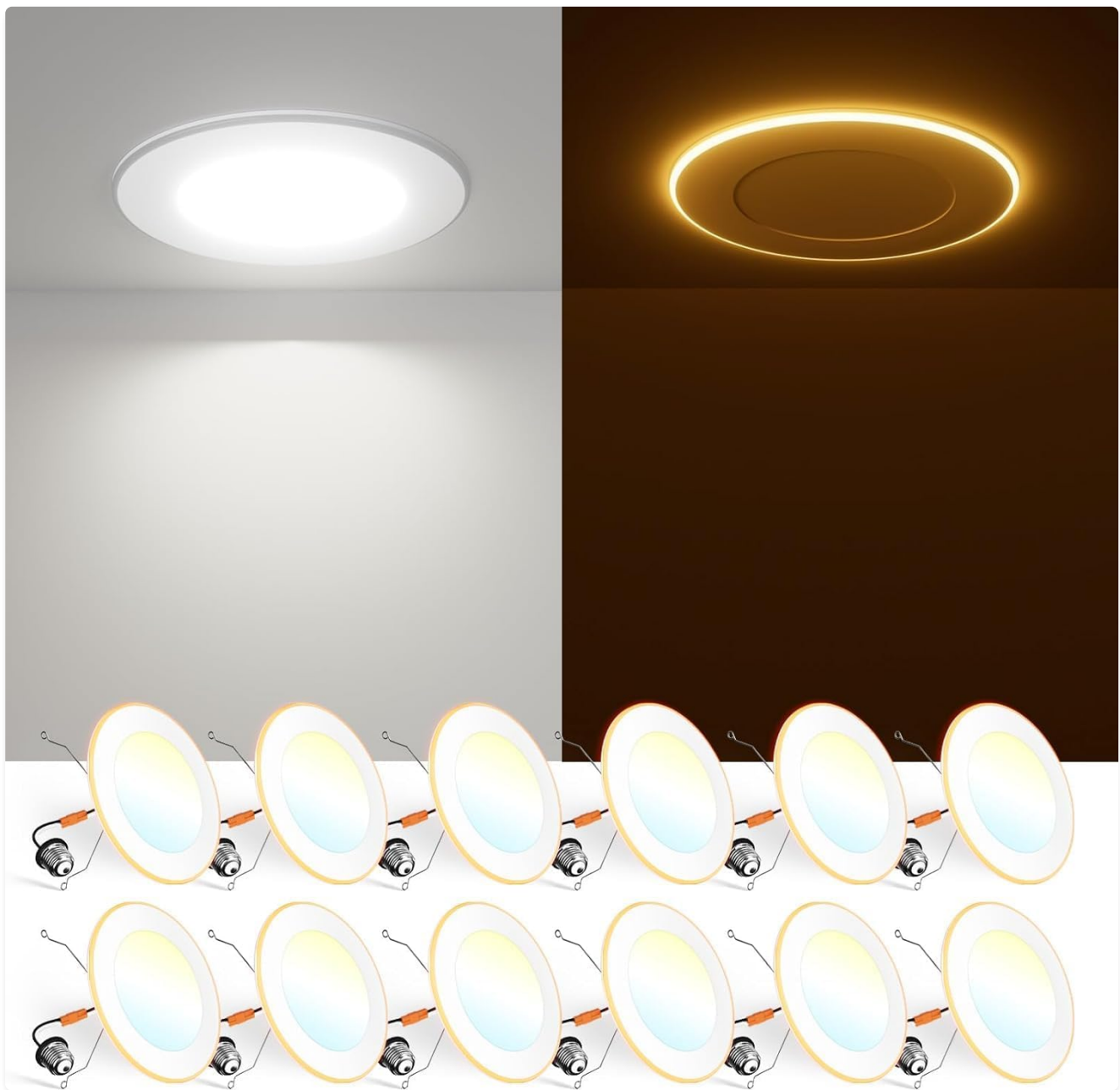

Figure 1: FREELIGHT 5/6 Inch 5CCT LED Recessed Lights, illustrating both downlight and night light modes, and a 12-pack of the lights.

Key Features:

- **Dual Mode Lighting:** Seamlessly switch between a bright downlight and a soft 2000K night light.
- **5CCT Selectable:** Choose from 2700K (Soft White), 3000K (Warm White), 4000K (Cool White), 5000K (Daylight), and 6000K (Cool Daylight) to match your ambiance.
- **Dimmable:** Adjust brightness from 5% to 100% in both downlight and night light modes with compatible dimmers.
- **Easy Retrofit Installation:** Designed to fit 5/6 inch recessed housing cans with a standard E26 base adapter.
- **Certified Safety:** ETL, FCC, Damp rated, and IC rated for safe and energy-efficient operation.

SETUP AND INSTALLATION

Follow these steps for proper installation of your FREELIGHT LED Recessed Lights. Ensure power is turned off at the circuit breaker before beginning installation.

Your browser does not support the video tag.

Video 1: Installation Guide for FREELIGHT 5/6 Inch 5CCT LED Recessed Light. This video demonstrates the step-by-step process of installing the recessed light, including attaching springs, screwing in the E26 base adapter, connecting the TP24 connector, and securing the light into the can.

1. **Prepare the Light:** Snap the springs into the clips on the back of the LED recessed light.
2. **Screw in Adapter:** Screw the E26 base adapter into the existing recessed can.
3. **Connect Wiring:** Connect the TP24 connector from the light to the E26 base adapter.
4. **Secure the Light:** Squeeze the springs together and gently push the light into the recessed can until the C-clips secure it in place.
5. **Final Adjustment:** Ensure the light is flush with the ceiling.

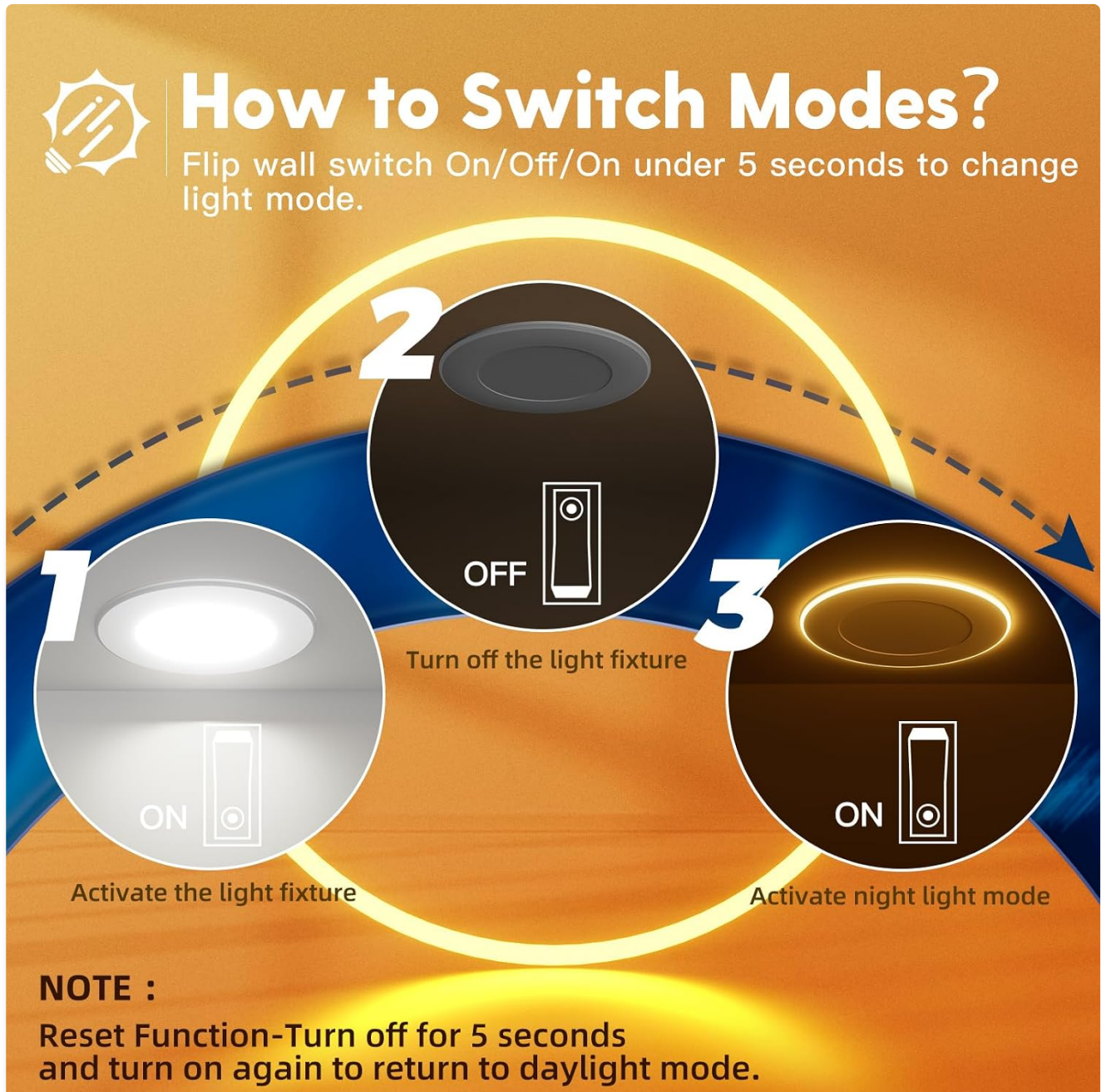

Figure 2: Visual guide for the installation steps, from preparing the springs to securing the light in the ceiling.

OPERATING INSTRUCTIONS

Your FREELICHT LED Recessed Light offers multiple functionalities for customized lighting.

1. Switching Between Downlight and Night Light Modes

The light features two modes: a standard downlight mode and a 2000K night light mode. You can switch between these modes using your existing wall switch:

- Turn the wall switch **ON** to activate the downlight mode.
- To switch to night light mode, quickly turn the wall switch **OFF** and then **ON** again within 5 seconds.
- To return to downlight mode, quickly turn the wall switch **OFF** and then **ON** again within 5 seconds.



Figure 3: Illustration of the wall switch operation to toggle between downlight and night light modes.

2. Synchronization Reset Function

If your lights become out of sync (e.g., some are in downlight mode while others are in night light mode), you can reset them:

- Turn off the light switch for **more than 8 seconds**.
- Turn the switch back **ON**. All lights will reset to the downlight mode.

Your browser does not support the video tag.

Video 2: Demonstration of switching between downlight and night light modes, and the synchronization reset function for multiple lights.

3. 5CCT Color Temperature Selection

Before installation, you can select one of five color temperatures for the downlight mode using a switch located on the back of the light fixture. This setting will apply to the downlight mode once installed.

- **2700K:** Soft White
- **3000K:** Warm White
- **4000K:** Cool White
- **5000K:** Daylight
- **6000K:** Cool Daylight

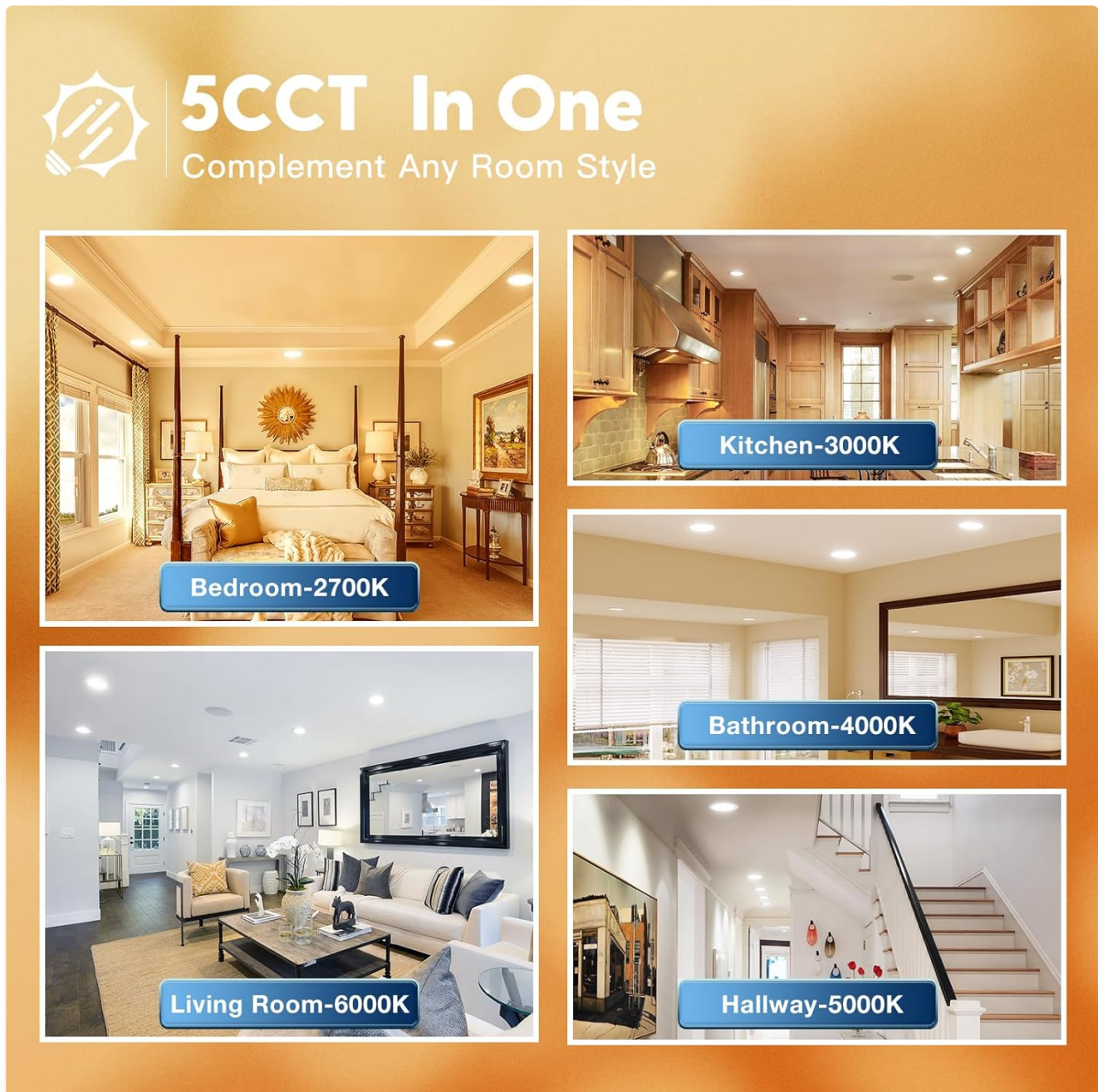

Figure 4: Examples of different color temperatures in various room environments.

4. Dimming Functionality

Both the downlight and night light modes are dimmable from 5% to 100% with most compatible LED dimmers. This

allows you to adjust the light intensity to suit your preference and activity.

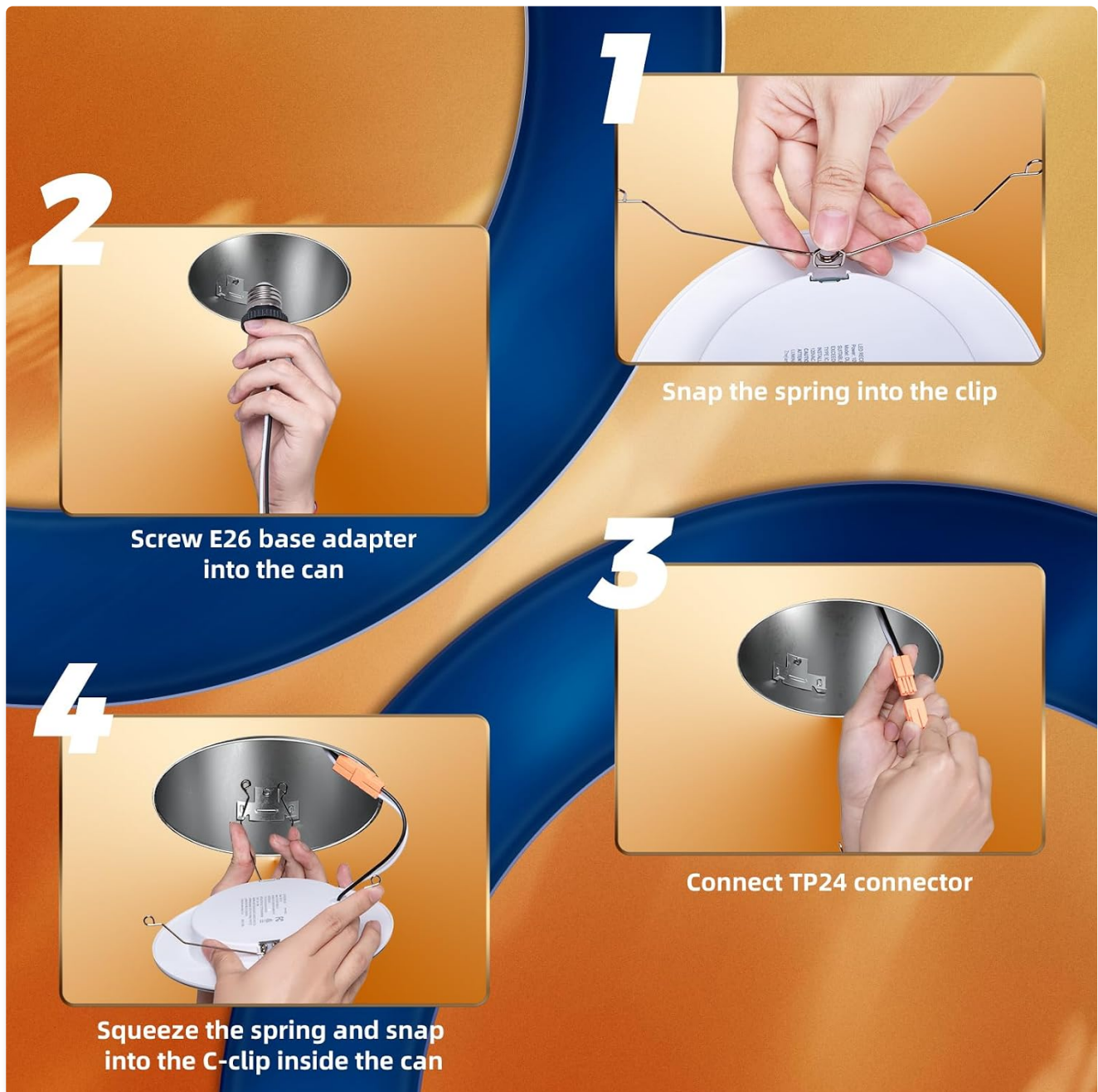

Figure 5: Visual representation of the dimming range for both lighting modes.

MAINTENANCE

To ensure the longevity and optimal performance of your FREELIGHT LED Recessed Lights, follow these simple maintenance guidelines:

- **Cleaning:** Disconnect power before cleaning. Use a soft, dry cloth to wipe the surface of the light. Avoid abrasive cleaners or solvents that may damage the finish or electrical components.
- **Inspection:** Periodically check the light fixture for any signs of damage or loose connections. If any issues are found, consult a qualified electrician.
- **Bulb Replacement:** These LED lights are integrated fixtures and do not require bulb replacement.

TROUBLESHOOTING

If you encounter any issues with your FREELIGHT LED Recessed Lights, refer to the following common troubleshooting steps:

Problem	Possible Cause	Solution
Light does not turn on.	No power, loose connection, faulty switch.	Check circuit breaker. Ensure all connections are secure. Test the wall switch.
Lights are out of sync (some in downlight, some in night light).	Switching sequence interrupted or inconsistent.	Turn off the wall switch for more than 8 seconds, then turn it back on. All lights will reset to downlight mode.
Light flickers or dims unexpectedly.	Incompatible dimmer, loose wiring, power fluctuations.	Ensure you are using a compatible LED dimmer. Check wiring connections. Consult an electrician if power fluctuations are suspected.
Incorrect color temperature.	5CCT switch set incorrectly.	Before installation, ensure the 5CCT switch on the back of the fixture is set to your desired color temperature.

SPECIFICATIONS

Feature	Detail
Brand	FREELIGHT
Model	5/6 Inch 5CCT LED Recessed Light
Power Consumption	10W (equivalent to 110W incandescent)
Lumen Output	1000LM
Color Temperature (CCT)	Selectable: 2700K, 3000K, 4000K, 5000K, 6000K
Night Light CCT	2000K
Dimming Range	5% - 100% (with compatible dimmers)
Material	Polycarbonate
Certifications	ETL, FCC, Damp Rated, IC Rated
Input Voltage	120V
Flicker Free	Yes

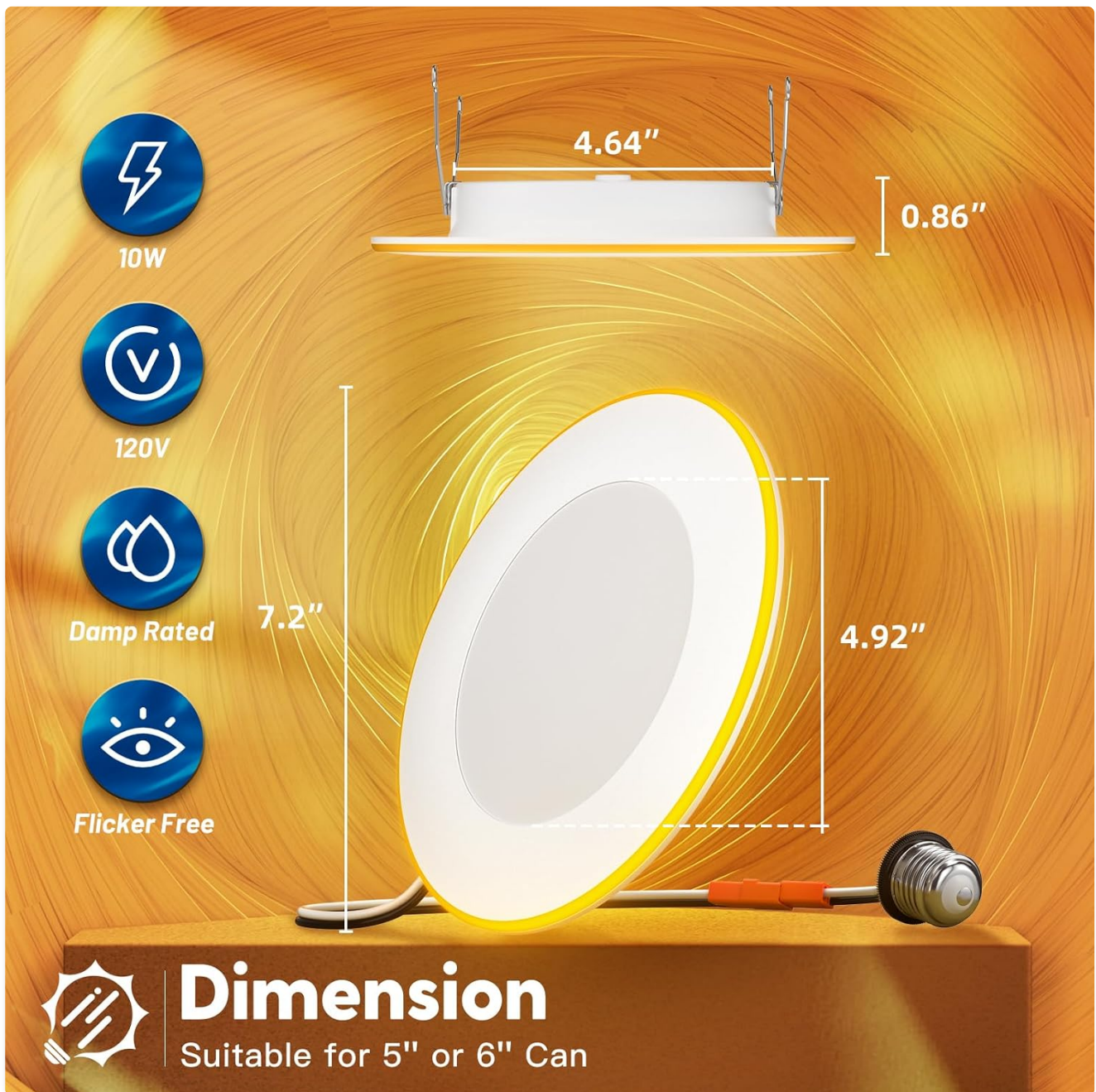

Figure 6: Product dimensions and key technical specifications.

WARRANTY AND SUPPORT

For any issues or inquiries regarding your FREELIGHT product, please contact our customer support team. You can reach us via Amazon Orders or directly at:

Support@freelicht.com

We are committed to providing high-quality products and excellent customer service.