

Oasser B0CR2VLXML

Oasser 150 PSI Tire Inflator Air Compressor User Manual

Model: B0CR2VLXML

INTRODUCTION

Thank you for choosing the Oasser 150 PSI Tire Inflator. This portable air compressor is designed for convenient and efficient inflation of various items, including car tires, motorcycle tires, bicycle tires, and sports balls. It features a dual LCD display, multiple inflation modes, and dual power supply options for versatility. Please read this manual thoroughly before use to ensure proper operation and maintenance.

SAFETY INFORMATION

- Keep the device away from children.
- Do not operate the device in wet conditions or near flammable liquids or gases.
- Avoid prolonged continuous operation to prevent overheating. Allow for cooling periods.
- Ensure the correct pressure setting for the item being inflated to prevent over-inflation and potential damage or injury.
- Do not point the air nozzle at people or animals.
- Store the device in a cool, dry place when not in use.

PACKAGE CONTENTS

Verify that all items are present in the package:

- Oasser 150 PSI Tire Inflator
- Air Hose (60cm)
- Type-C Charging Cable
- 12V DC Cigarette Lighter Cable (3m)
- Various Nozzles (e.g., Presta valve adapter, ball needle)
- Storage Bag
- User Manual

Package Includes



Figure 1: Contents included in the Oasser Tire Inflator package.

PRODUCT OVERVIEW

The Oasser Tire Inflator features a compact design with a powerful pure copper motor for efficient inflation. It includes a large color LCD display that shows both real-time and preset pressure values. The device offers dual power supply options: a built-in 6000mAh rechargeable Li-ion battery and a 12V DC cigarette lighter cable for continuous power.

Large Bright Color LCD Display

Monitoring tire pressure, stop inflating when desired pressure reaches



Figure 2: Dual LCD display showing real-time and preset pressure.

Additional features include a USB output port for use as a power bank and an integrated LED light with three modes (Long Bright, Flash, SOS) for emergency situations.

SETUP

Charging the Device

Before first use, fully charge the tire inflator using the provided Type-C charging cable. Connect the Type-C cable to the device's charging port and the other end to a compatible USB power adapter (not included).

Connecting to Power Source

The device can be powered in two ways:

- **Cordless Operation:** Use the built-in 6000mAh rechargeable battery. Ensure the battery is sufficiently charged.
- **Corded Operation:** Connect the 12V DC cigarette lighter cable to your vehicle's cigarette lighter socket and the other end to the inflator's DC input port. This provides continuous power and is suitable for inflating multiple tires.

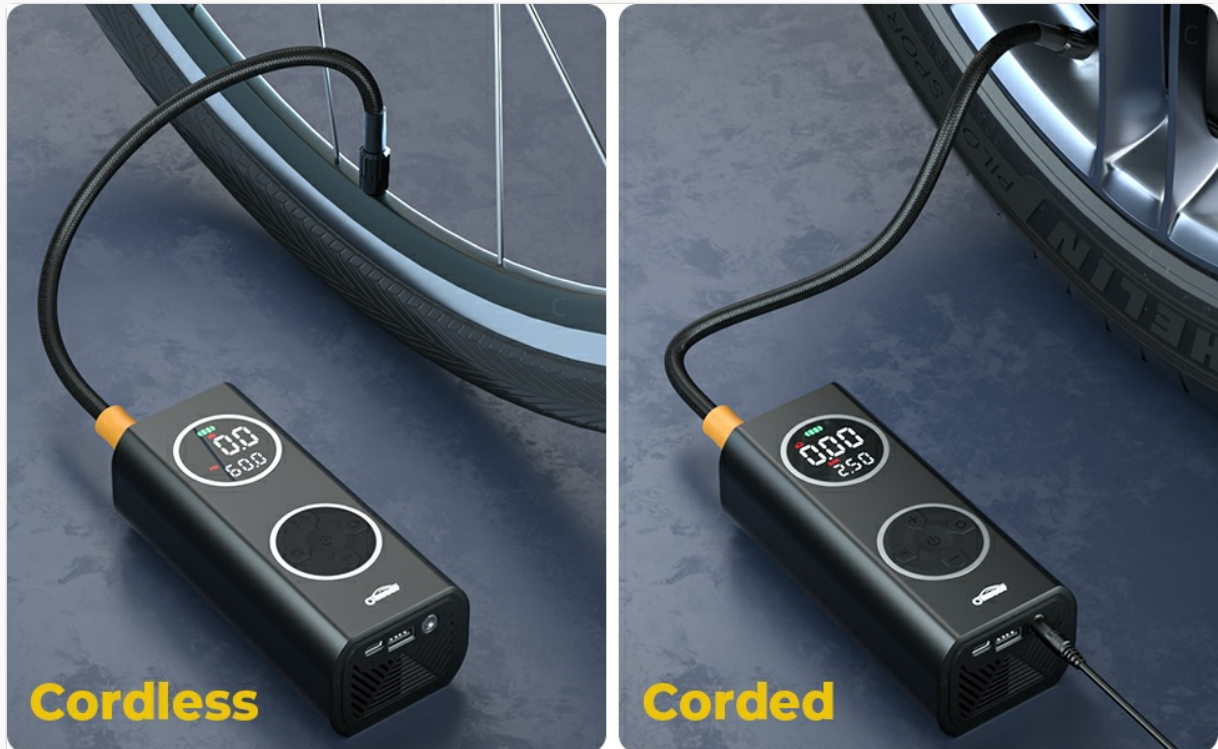

Figure 3: Cordless and Corded power supply options.

Attaching the Air Hose and Nozzle

Screw the air hose securely onto the inflator's air outlet. Select the appropriate nozzle for your item (e.g., Schrader valve for car/motorcycle, Presta adapter for some bicycles, ball needle for sports balls) and attach it to the other end of the air hose.

OPERATING INSTRUCTIONS

Powering On/Off

Press and hold the power button to turn the device on or off. The LCD screen will illuminate upon activation.

Selecting Inflation Mode

The inflator offers 5 preset modes. Press the 'M' (Mode) button to cycle through the following options:

- **Car Mode:** Default pressure 2.5 BAR
- **Motorcycle Mode:** Default pressure 2.5 BAR
- **Bicycle Mode:** Default pressure 60 PSI
- **Ball Mode:** Default pressure 8 PSI
- **Custom Mode:** Allows manual pressure setting (default 30 PSI)

Wide Applications

5 Shortcut Modes

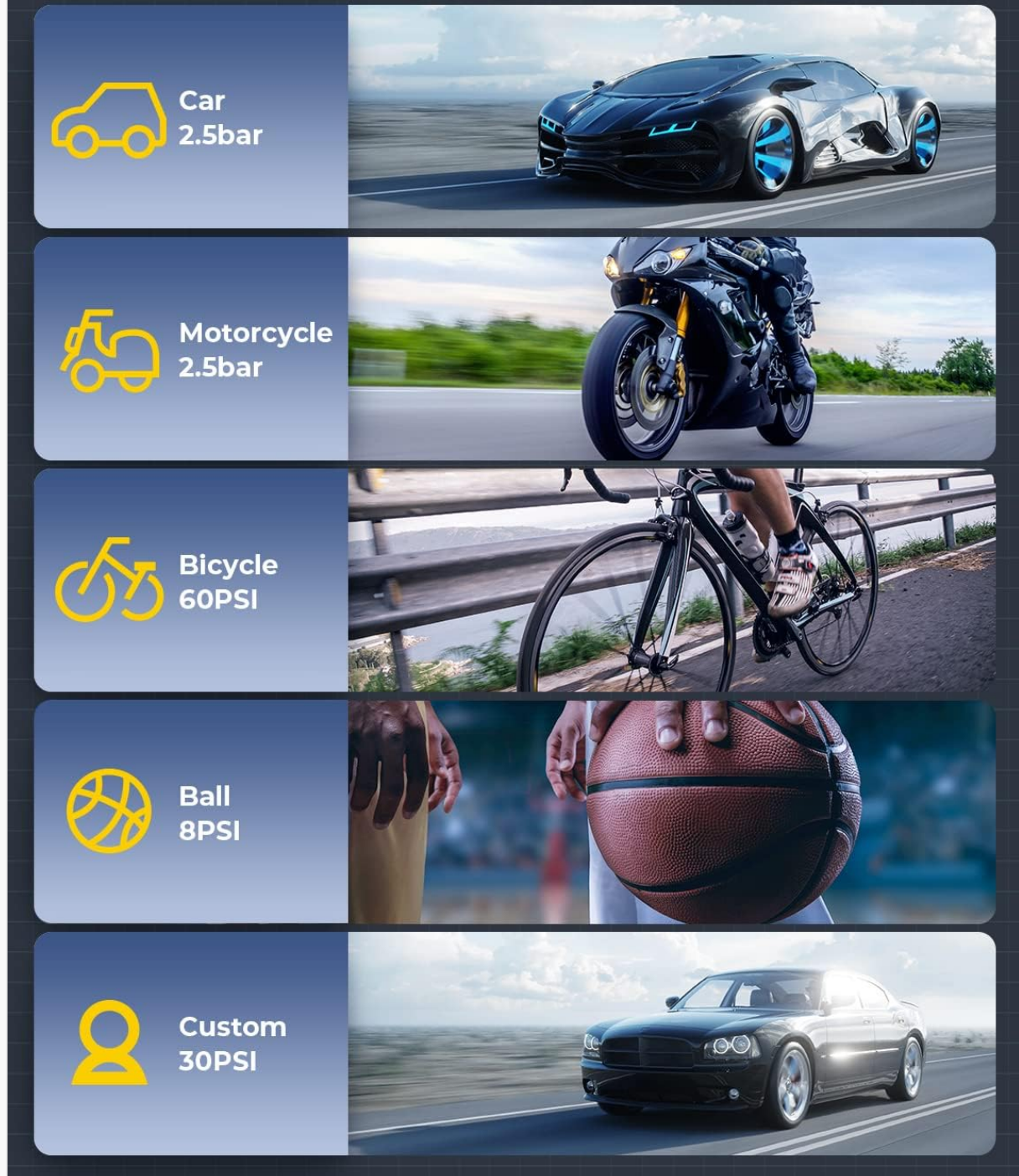

Figure 4: Five preset inflation modes for various applications.

Setting Desired Pressure

After selecting a mode, use the '+' and '-' buttons to adjust the preset pressure value. The top number on the LCD shows the real-time pressure, while the bottom number shows the target preset pressure.

Starting and Stopping Inflation

Connect the nozzle to the item's valve. The real-time pressure will display. Press the power button to start inflation. The device will automatically stop when the preset pressure is reached. Press the power button again to manually stop inflation at any time.

High-powered Pure Copper Motor



Figure 5: Inflator in use, connected to a tire.

Using as a Power Bank

The inflator can function as a power bank to charge mobile devices. Connect your device's USB charging cable to the USB output port on the inflator.



Figure 6: Charging a mobile device using the inflator's USB output.

Using the LED Light

Press the light button (usually indicated by a sun or lightbulb icon) to cycle through the LED light modes:

- **Long Bright:** Continuous illumination for general use.
- **Flash:** Flashing light for increased visibility.
- **SOS:** Morse code SOS signal for emergencies.

Bright LED Light

3 Lighting Modes



Long Bright



Flash



SOS



Figure 7: LED light with three modes.

MAINTENANCE

- Clean the exterior of the device with a soft, damp cloth. Do not use harsh chemicals or abrasive cleaners.
- Ensure the air hose and nozzles are free from dust and debris before and after use.
- Store the inflator and its accessories in the provided storage bag in a dry, cool place.
- Regularly charge the battery if the device is not used for extended periods to maintain battery health.

TROUBLESHOOTING

Problem	Possible Cause	Solution
Device does not turn on.	Low battery or no power connection.	Charge the device or connect to the 12V DC cigarette lighter cable.
Inflation is slow or weak.	Air hose not securely connected; nozzle blockage; low battery.	Ensure all connections are tight. Check nozzles for obstructions. Charge the device.
Device overheats during use.	Prolonged continuous operation.	Turn off the device and allow it to cool down for at least 10-15 minutes before resuming use.
Pressure reading is inaccurate.	Incorrect unit selected; faulty connection.	Ensure the correct pressure unit (PSI, BAR, KPA) is selected. Re-attach the air hose and nozzle securely.
Device does not stop at preset pressure.	Sensor malfunction.	Manually stop inflation. If the issue persists, contact customer support.

SPECIFICATIONS

- **Brand:** Oasser
- **Model:** B0CR2VLXML
- **Maximum Pressure:** 150 PSI
- **Power Source:** Rechargeable Li-ion Battery (6000mAh) / 12V DC Cigarette Lighter Cable
- **Operating Mode:** Automatic shut-off
- **Package Dimensions:** 24.2 x 15.5 x 7.7 cm
- **Weight:** 1.16 kg
- **Motor:** High-powered Pure Copper Motor
- **Cylinder Size:** 22mm
- **Max Inflation Rate:** 20L/min

WARRANTY AND SUPPORT

Specific warranty information is not provided in the product details. For warranty claims, technical support, or any questions regarding your Oasser Tire Inflator, please refer to the contact information provided with your purchase or visit the official Oasser website.