

Carrera 20062575

Carrera GO!!! Ferrari Power Racing Slot Car Racetrack Instruction Manual

Model: 20062575

INTRODUCTION

Welcome to the exciting world of Carrera GO!!! slot car racing! This manual provides essential information for setting up, operating, and maintaining your Ferrari Power Racing slot car track set. Designed for thrilling head-to-head races, this 1:43 scale system brings the excitement of real race car driving into your home. Please read these instructions carefully before assembly and use to ensure a safe and enjoyable experience.

SAFETY INFORMATION

Caution - Electric Toy: Not recommended for children under 8 years of age. As with all electric products, precautions should be observed during handling and use to prevent electric shock.

- Always supervise children during play.
- Do not use the product near water or in wet conditions.
- Disconnect the power adapter from the outlet when not in use or before cleaning.
- Inspect the power adapter, cord, and all components regularly for damage. Do not use if damaged.
- Use only the power adapter supplied with this product.

WHAT'S IN THE BOX

Your Carrera GO!!! Ferrari Power Racing set includes the following components:

- Two 1:43 Scale Cars: Ferrari 296 GT3 "AF Corse, No.21" (Red) and Ferrari 296 GT3 "Cetilar Racing, No.47" (Blue)
- 1:43 Scale Track sections (straights, curves, banked curves, narrow section, junction track)
- Two Speed Controllers
- Power Adapter
- Connection Track
- Lap Counter
- Guardrails and Supports



Image: Rear view of the product box, illustrating the track layout and included components such as cars, controllers, and track pieces.

SETUP INSTRUCTIONS

Follow these steps to assemble your Carrera GO!!! track:

- 1. Choose a Location:** Select a flat, stable surface large enough for the track layout (approximately 8.2 x 4.76 feet). Ensure there is access to a power outlet.
- 2. Assemble Track Sections:** Carefully connect the track pieces by aligning the connectors and pressing them firmly together. Refer to the track layout diagram provided on the box or in the included instructions for the recommended configuration.

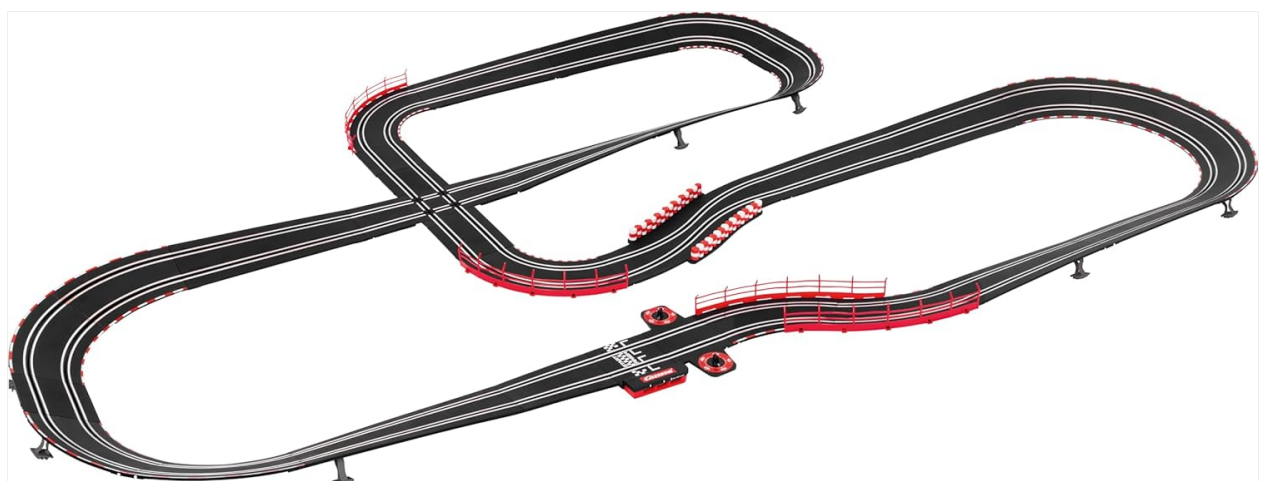

Image: An overhead view of the fully assembled Carrera GO!!! Ferrari Power Racing track, showing its various sections including straightaways, curves, and the junction track.

3. **Install Guardrails and Supports:** Attach the guardrails to the outer edges of curves and elevated sections. Place track supports under elevated track pieces to ensure stability.

4. **Connect Power and Controllers:**

- Insert the connection track into the designated slot in your track layout.
- Plug the two speed controllers into the corresponding ports on the connection track.
- Connect the power adapter to the connection track, then plug the adapter into a wall outlet.



Image: Two black Carrera GO!!! speed controllers with red trigger buttons, used to control the speed of the slot cars.

5. **Place Cars on Track:** Carefully place the Ferrari slot cars onto the track, ensuring the guide pins on the bottom of the cars are correctly seated in the track slot.



Image: A detailed view of the red Ferrari 296 GT3 "AF Corse, No.21" slot car, positioned on a section of the track.



Image: A detailed view of the blue Ferrari 296 GT3 "Cetilar Racing, No.47" slot car, positioned on a section of the track.

OPERATING INSTRUCTIONS

Once the track is assembled and powered, you are ready to race!

- **Speed Control:** Use the trigger on your speed controller to regulate the car's speed. Pull the trigger further back for more speed.
- **Turbo Boost:** Your speed controller features a "Turbo Boost" button. Press and hold this button for a temporary burst of extra speed, ideal for straightaways or overtaking opponents. Use it strategically!
- **Cornering:** Reduce speed when approaching curves to prevent cars from flying off the track. Practice is key to mastering the optimal speed for each turn.
- **Lap Counter:** The integrated lap counter will automatically register each completed lap for both cars, allowing for competitive racing.

MAINTENANCE

Regular maintenance ensures optimal performance and longevity of your slot car set.

- **Track Cleaning:** Keep the track surface clean and free of dust or debris. Use a soft, dry cloth to wipe down the track

rails. Dirty rails can affect electrical contact and car performance.

- **Car Maintenance:**
 - **Guide Pins:** Ensure the guide pins on the bottom of the cars are clean and undamaged. Replace if worn or broken.
 - **Contact Brushes:** The small metal brushes under the car make contact with the track. Ensure they are clean, straight, and make good contact. Gently bend them if necessary to ensure proper contact. Replace if heavily worn.
 - **Wheels and Axles:** Check for any hair or debris wrapped around the axles. Keep wheels clean for smooth operation.
- **Storage:** When not in use, disassemble the track and store all components in their original packaging or a suitable container to protect them from dust and damage.

TROUBLESHOOTING

If you encounter issues, try these solutions:

Problem	Possible Cause / Solution
Car does not move or moves slowly.	<ul style="list-style-type: none">• Check power adapter connection to outlet and track.• Ensure guide pin and contact brushes on the car are clean and making good contact with the track rails.• Verify all track sections are firmly connected.• Test with the other car/controller to isolate the issue.
Car flies off track frequently.	<ul style="list-style-type: none">• Driver is going too fast into curves. Reduce speed.• Guardrails are not properly installed or are missing.• Track surface may be uneven; ensure supports are correctly placed.
Lap counter not registering laps.	<ul style="list-style-type: none">• Ensure the car passes completely over the lap counter sensor.• Check for debris blocking the sensor.

SPECIFICATIONS

Feature	Detail
Product Model Number	20062575
Scale	1:43
Track Length	Over 28 feet (8.6 meters)
Assembled Dimensions	8.2 x 4.76 feet (250 x 145 cm)
Product Dimensions (Box)	22.83 x 4.72 x 15.74 inches
Item Weight	9.78 pounds

Feature	Detail
Recommended Age	6 years and up
Manufacturer	Carrera
Included Cars	Ferrari 296 GT3 "AF Corse, No.21", Ferrari 296 GT3 "Cetilar Racing, No.47"

WARRANTY AND SUPPORT

For information regarding product warranty, replacement parts, or technical support, please visit the official Carrera website or contact their customer service.

Official Website: www.carrera-toys.com

Carrera offers various accessories and track expansion sets to enhance your racing experience. Explore their range for endless possibilities.

© 2024 Carrera. All rights reserved.

Related Documents - 20062575

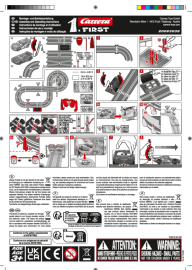
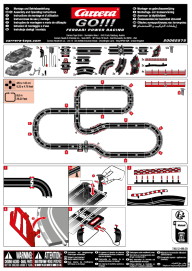
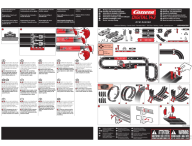
	<p>Carrera First Mario Kart Slot Car Race Track: Instructions and Safety Guide</p> <p>Comprehensive instructions and safety guidelines for the Carrera First Mario Kart slot car race track set, featuring battery-powered racing for kids aged 3+.</p>
	<p>Carrera GO!!! Ferrari Power Racing Slot Car Set Assembly and Operation</p> <p>Comprehensive assembly and operating instructions for the Carrera GO!!! Ferrari Power Racing slot car set (Model 20062575), featuring track layout, component details, safety warnings, and operational guidance.</p>
	<p>Carrera DIGITAL 143 DTM RACING Slot Car Set Assembly and Operating Instructions</p> <p>Comprehensive assembly and operating instructions for the Carrera DIGITAL 143 DTM RACING slot car set. Learn how to set up the track, program cars, and operate the system safely. Includes multilingual guidance and operational tips.</p>

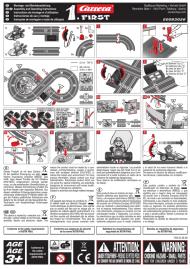

[Carrera FIRST Mario Kart Slot Car Race Track Assembly and Operating Instructions](#)

Assembly and operating instructions for the Carrera FIRST Mario Kart slot car race track set. Includes details on setup, safety precautions, battery installation, and maintenance.

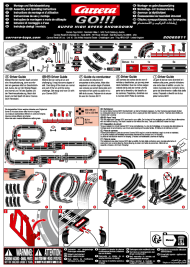

[Carrera GO!!! Super High Speed Showdown Slot Car Race Track Assembly and Operating Instructions](#)

Detailed assembly and operating instructions for the Carrera GO!!! Super High Speed Showdown slot car race track set (Model 20062611). Learn how to set up your track, operate the cars, and maintain components for exciting racing fun.

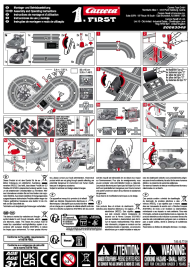

[Carrera FIRST Spidey Web Spin 63049 Slot Car Track Set Instructions](#)

Official instructions for the Carrera FIRST Spidey Web Spin 63049 slot car track set. Learn how to assemble and operate your new racing toy.