



Manuals.plus /

› Inefala /

› Inefala Android 15 Car Stereo User Manual for Toyota RAV4 (2001-2006)

Inefala 8-Core 4+64G Android 15 Car Stereo

Inefala Android 15 Car Stereo User Manual

For Toyota RAV4 (2001-2006) - Model: 8-Core 4+64G Android 15 Car Stereo

1. INTRODUCTION

This manual provides detailed instructions for the installation, operation, and maintenance of your Inefala Android 15 Car Stereo. Please read this manual thoroughly before installation and use to ensure proper function and to maximize your user experience. This unit is designed specifically for Toyota RAV4 models manufactured between 2001 and 2006.



Image 1.1: Front view of the Inefala Android 15 Car Stereo unit, showcasing its 9-inch display and Android 15 operating system with various application icons.

2. PRODUCT OVERVIEW

The Inefala Android 15 Car Stereo is an advanced in-dash navigation and entertainment system featuring a 9-inch HD touchscreen. It integrates modern connectivity and multimedia capabilities into your vehicle.

2.1 Key Features

- **Operating System:** Android 15
- **Processor:** 8-Core CPU
- **Memory:** 4GB RAM + 64GB ROM
- **Display:** 9-inch HD Touch Screen (1280x720 resolution)
- **Connectivity:** Wireless/Wired Apple CarPlay, Wireless/Wired Android Auto, Mirror Link, Bluetooth 5.0, Wi-Fi
- **Navigation:** Built-in GPS module with support for online and offline maps
- **Audio:** 36-band EQ, DSP Sound
- **Radio:** FM/RDS Radio
- **Camera Support:** AHD Backup Camera input
- **Control:** Steering Wheel Control learning function

2.2 Vehicle Compatibility

This unit is designed for Toyota RAV4 models from 2001 to 2006. Please verify the power cable port on the detail page matches your original car's port before purchase. This unit does **not** support original cars equipped with a JBL amplifier.

For Toyota RAV4 (2000–2003)



Not Fit



After Installation



Apple Carplay



Android Auto



Mirror Link



GPS Navigation



WiFi Function



HD 1280 x 768



SWC



DSP Sound



FM/RDS Radio



Bluetooth

Image 2.1: Diagram illustrating the compatibility of the car stereo with Toyota RAV4 models (2001-2006), showing a 'Not Fit' example with an older stereo and a 'Fit' example with the new unit installed, alongside icons representing key features like Apple CarPlay, Android Auto, GPS, and Wi-Fi.

3. PACKAGE CONTENTS

Verify that all items listed below are included in your package:

- Inefala Android Radio Unit
- Power Cable
- RCA Harness
- GPS Antenna

- AHD Backup Camera
- Rear Camera Input Cable
- External Microphone
- Dual USB Cable
- Installation Tool & Accessories

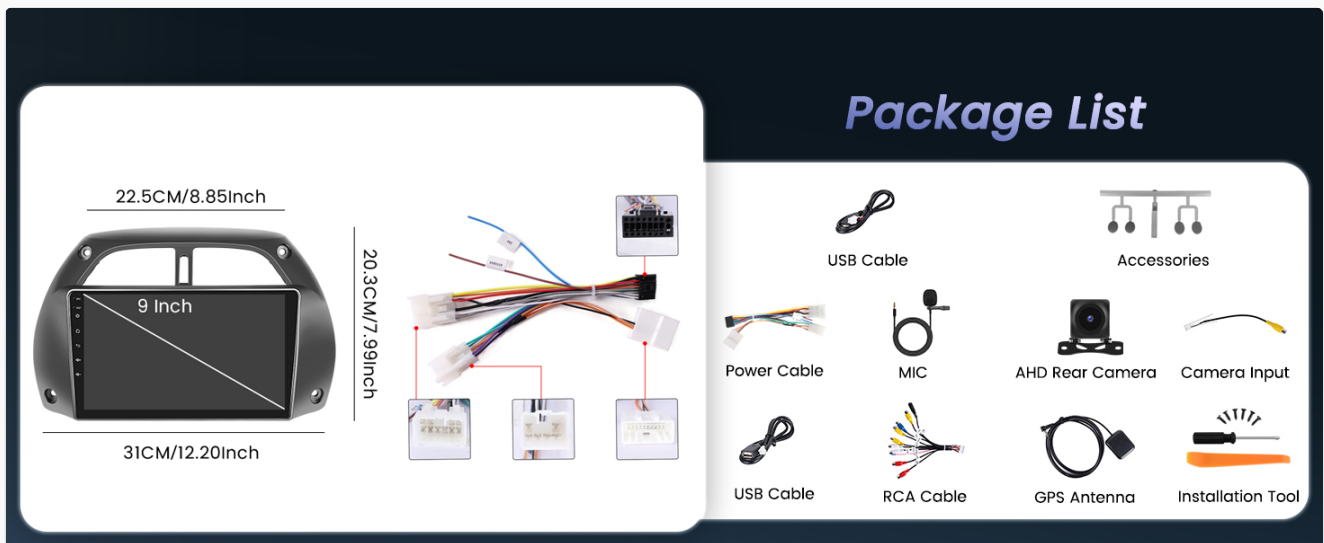

Image 3.1: Visual representation of the complete package contents, including the main unit, various cables (USB, power, RCA), GPS antenna, AHD rear camera, external microphone, and installation tools.

4. SETUP AND INSTALLATION

Professional installation is recommended. Ensure the vehicle's battery is disconnected before beginning installation.

4.1 Pre-Installation Check

1. Combine the red and yellow wires of the car stereo, then connect them to the positive pole of the 12V battery.
2. Connect the black wire to the negative pole of the battery.
3. After 2 seconds, check if the car stereo screen lights up. If it does, the stereo is functioning normally. If the screen does not turn on, recheck the wiring.

Important Tips:

- Double-check that the provided power cable port matches your car's port.
- If the harness contains spare sockets that do not fit, it is not necessary to connect them. They are for different car models.
- If the wiring harness is different or accessories are missing, contact customer support.



Image 4.1: A side-by-side comparison showing the original Toyota RAV4 dashboard before installation and the updated dashboard with the Inefala Android stereo successfully installed.

4.2 Wiring Diagram and Port Details

Refer to the following diagrams for connecting the various cables and understanding the unit's port layout.

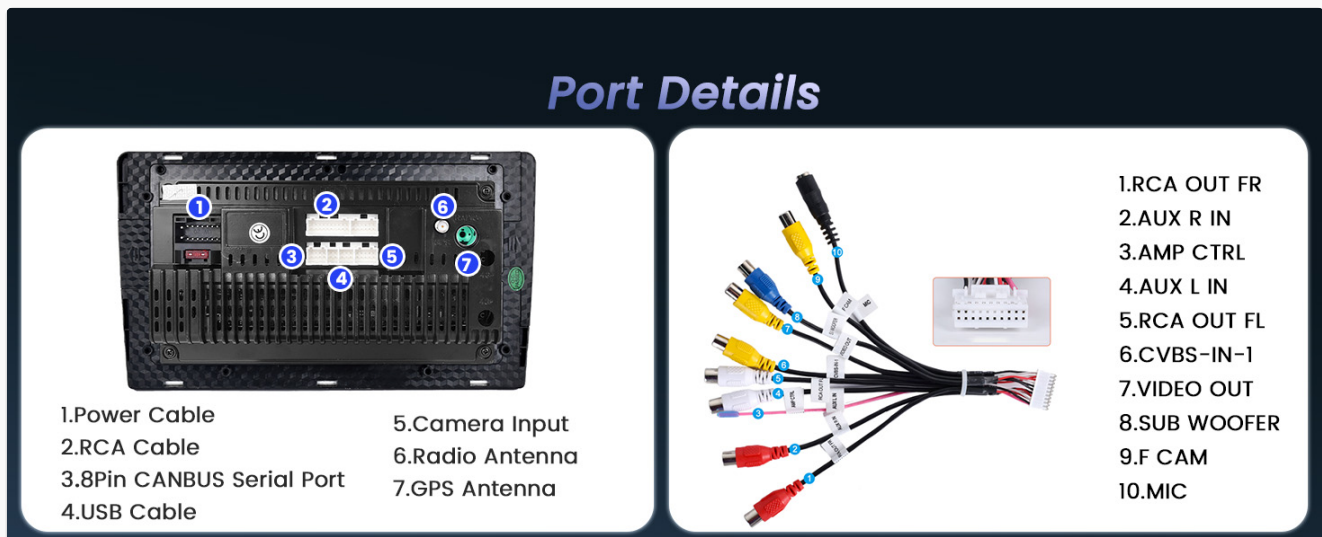

Image 4.2: Detailed view of the car stereo's rear panel, labeling each port (e.g., Power Cable, RCA Cable, USB Cable, Camera Input, GPS Antenna) and illustrating the corresponding cable connections.

4.3 Backup Camera Connection

The AHD backup camera provides a clear view when reversing. The reversing input must be plugged in even if the camera is not used, as it can affect Wi-Fi and Bluetooth signals.

1. Connect Cable 1 and Cable 5 to the positive pole of the car's reversing light cable.
2. Connect Cable 2 to the negative pole of the car's reversing light cable.
3. Connect Cable 3 and Cable 4 to the reverse trigger wire of the power cable (labeled "Reverse/Back"). If this wire is not present, it is not needed.

Reversing Camera Wiring

Tip: The reversing input must be plugged in even when the reversing camera is not used. Otherwise, your WiFi and Bluetooth signals will be affected!

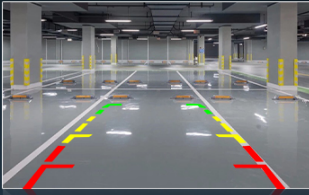

How to Connect the Backup Camera?

Cable 1 and cable 5: Need connect the positive pole of the car reversing light cable.

Cable 2: Connect the negative pole of the car reversing light cable.

Cable 3 and Cable 4: Connects to the reverse trigger wire of power cable (labeled "Reverse/Back"). No need to connect if without this wire. Pull it out and connect it if last step doesn't work.

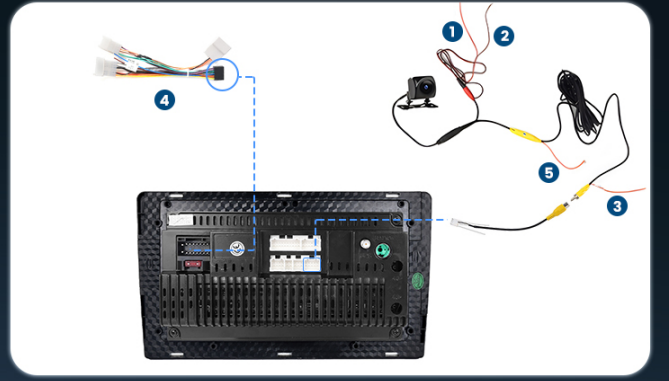

Image 4.3: A visual guide detailing the wiring connections for the AHD reversing camera, including connections to the car's reversing light and the stereo's trigger wire.

4.4 Steering Wheel Control Setup

The unit supports learning functions for your vehicle's steering wheel controls.

- **Without CANBUS box:** Activation of steering wheel controls requires key learning in the settings menu.
- **With CANBUS box:**
 - a. Connect the 20-pin white port in the power cable to the CANBUS itself.
 - b. Connect the remaining 8-pin white port to the corresponding port on the back of the radio.

CANBUS Matching Path: Settings > Factory Setup (Password 1234) > Can Settings.

Steering Wheel Control

Optional Note:

- a. If no CANBUS box: Activation of steering wheel controls requires key learning in settings.
- b. If with CANBUS box: (1). Need to connect the 20-pin white port in the power cable to the Canbus itself, and the remaining 8-pin white port to the corresponding port on the back of the radio. (2). Match the car model. CANBUS Matching Path: Settings - Factory Setup (Password 1234) - Can Settings.

Image 4.4: Screenshot of the steering wheel control learning interface, showing options to assign functions like volume, track skip, and mode to physical steering wheel buttons.

5. OPERATING INSTRUCTIONS

5.1 Basic Operation

- **Touch Screen:** The unit features a fully capacitive touch screen for intuitive operation.
- **Power On/Off:** Press and hold the power button (usually labeled with a power icon) to turn the unit on or off.

- **Volume Control:** Adjust volume using the on-screen controls or steering wheel buttons (if configured).

5.2 Wireless CarPlay & Android Auto

Enjoy seamless integration with your smartphone for navigation, music, calls, and messages.

- **Wireless Connection:**

- Turn on your phone's Bluetooth and search for the car stereo's Bluetooth device to pair.
- Click the "CP Link" / "Android Auto" app on the car stereo. (If your phone is Android, you may need to install the "Android Auto" app in advance).
- Wait a few seconds for the CarPlay/Android Auto wireless connection to establish automatically.
- After the first successful connection, it will start automatically on subsequent uses. You can then use voice assistance, navigation, music playback, and make/receive calls.

- **Wired Connection:**

- Connect your iOS / Android cell phone via the original USB cable.
- Click the "CP Link" / "Android Auto" app on the car stereo.
- Wait a few seconds for the CarPlay/Android Auto wired connection to establish automatically.

Note: For some Samsung and Huawei phones, Android Auto and Mirror Link functionality may be limited or unavailable. Android phones may require Google Services and the "Android Auto" app.

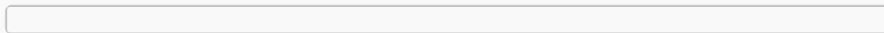

Image 5.1: Illustration of wireless CarPlay and Android Auto connectivity options, including hotspot and USB/Bluetooth connections, and examples of their respective interfaces.

Wireless Carplay & Android Auto

Wireless Connection:

1. Turn on your phone's Bluetooth, search for the car stereo's Bluetooth and pair it.
2. Click the "CP Link" / "Android Auto" app on the car stereo. (If your cell phone is the Android system, you need to install the "Android Auto" app in advance).
3. Wait for a few seconds and the CarPlay/Android Auto wireless connection will happen automatically.
4. After the first successful connection, simply turn on Bluetooth, and it will start automatically. And you can easily use functions like voice assistant, navigate, play music and make/receive phone calls.

Wired Connection:

1. Connect your iOS / Android cell phone via original USB cable
2. Click the "CP Link" / "Android Auto" app on the car stereo. (If your cell phone is the Android system, you need to install the "Android Auto" app in advance).
3. Wait for a few seconds and the CarPlay/Android Auto wired connection will happen automatically. And you can easily use functions like voice assistant, navigate, play music and make/receive phone calls.

Note: For Huawei and some Samsung phones, these are not supported. The phone needs to support Google Services and install the "Android Auto" app.

Image 5.2: Step-by-step instructions for establishing both wireless and wired connections for Apple CarPlay and Android Auto, highlighting the necessary app and Bluetooth pairing process.

5.3 Mirror Link

Mirror Link allows you to display your phone's screen directly on the car stereo's display.



Image 5.3: Visual representation of the Mirror Link feature, showing a smartphone screen mirrored onto the car stereo display, compatible with both Apple and Android systems.

5.4 GPS Navigation

The unit includes a built-in GPS module. You can use pre-installed navigation software like Waze or download other navigation apps from the Play Store.

- **Offline Maps:** Free offline maps can be used without an internet connection.
- **Online Maps:** Connect to Wi-Fi or a mobile hotspot for real-time traffic updates and online map functionality.



Image 5.4: Examples of GPS navigation interfaces, including Waze, and a depiction of downloading applications like YouTube and TikTok via Wi-Fi or hotspot connection.

5.5 Bluetooth Functions

The integrated Bluetooth 5.0 module supports hands-free calling, phone book download, and music streaming.

- **Hands-free Calling:** Pair your phone via Bluetooth to make and receive calls directly through the stereo. The built-in microphone captures your voice, and car speakers provide audio.
- **Music Playback:** Stream audio from your paired device to the car stereo.
- **Phone Book:** Download your phone's contacts for easy access.

Hands-free Bluetooth

Supports hands-free calling, phonebook downloads and music playback



- BT Call
- BT Music
- Phonebook

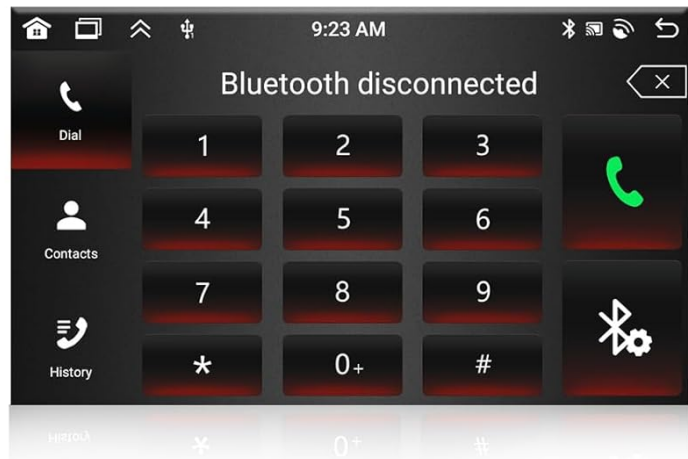

FM/RDS Radio

Channel broadcasts, weather forecasts and real-time traffic conditions are available



Image 5.5: Screenshots showing the hands-free Bluetooth interface for dialing and accessing contacts, and the FM/RDS radio interface with station presets and frequency display.

5.6 FM/RDS Radio

The unit features a stable FM/RDS radio with 18 preset stations.

- **Station Presets:** Easily save and recall your favorite radio stations.
- **RDS Functionality:** Receive channel broadcast information, weather forecasts, and real-time road conditions where available.

5.7 Customization

Personalize your stereo's appearance and audio settings.

- **Wallpapers:** Choose from 19 background options. Touch the color circle in the lower left corner of the screen to switch.
- **Desktop Themes:** Long-press the main interface to switch between 59 desktop themes.
- **Equalizer (EQ):** Utilize the 36-band EQ options to fine-tune your audio experience.

19 Wallpaper Options



59 Desktop Themes



Image 5.6: Displays the variety of 19 wallpaper options and 59 desktop themes available for customizing the car stereo's user interface.

59 UI Desktop Themes & 19 Wallpaper Options



Image 5.7: A dynamic visual showcasing the extensive customization options for the user interface, including 59 desktop themes and 19 wallpaper choices.

5.8 App Installation (Wi-Fi/Hotspot)

Connect the unit to Wi-Fi or a mobile hotspot to download additional applications from the Google Play Store, such as YouTube, TikTok, and more.

5.9 AHD Reversing Image

When connected to the AHD backup camera, the radio screen will automatically display the rearview video when the vehicle is in reverse gear.

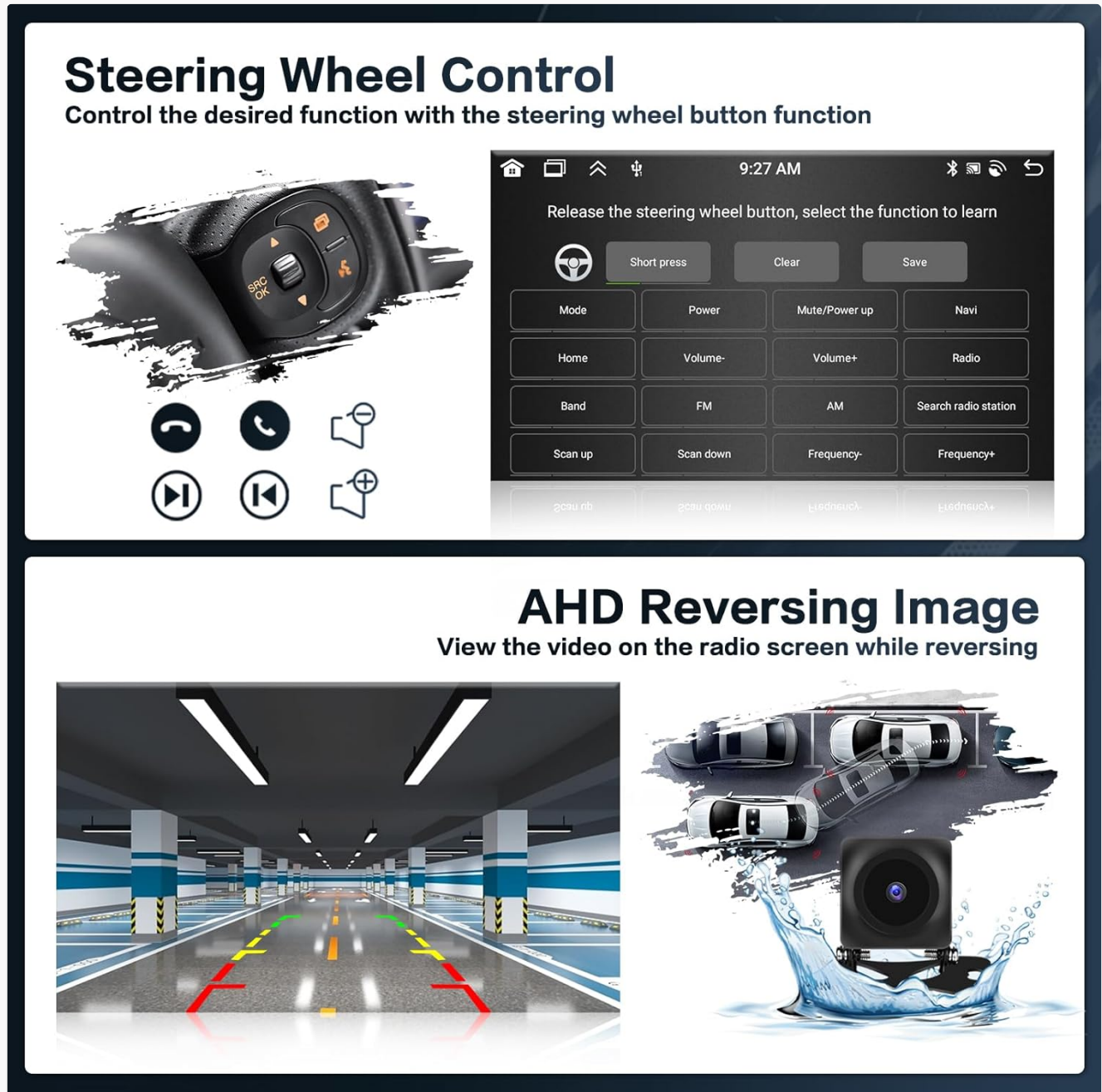

Image 5.8: Depicts the steering wheel control interface for assigning functions and a clear view of the AHD reversing image displayed on the car stereo screen.

6. MAINTENANCE

- **Screen Cleaning:** Use a soft, lint-free cloth to clean the touchscreen. Avoid abrasive cleaners or solvents.
- **Software Updates:** Periodically check for software updates via the system settings to ensure optimal performance and access to new features.
- **General Care:** Keep the unit free from dust and extreme temperatures.

7. TROUBLESHOOTING

If you encounter issues, refer to the following common problems and solutions:

- **No Power:** Check all power connections. Ensure the red and yellow wires are connected to 12V positive and the black wire to ground. Perform the pre-installation check (Section 4.1).
- **No Sound:** Check speaker connections. Verify volume levels and EQ settings. Ensure the correct audio source is selected.
- **Bluetooth/Wi-Fi Issues:** Ensure the reversing input cable is connected, even if no camera is used, as it can affect wireless signals. Re-pair Bluetooth devices. Check Wi-Fi network settings.
- **CarPlay/Android Auto Not Connecting:** For wireless, ensure Bluetooth is paired first. For wired, use the original USB cable. Some phone models may have compatibility limitations (refer to Section 5.2).
- **Backup Camera Not Displaying:** Check camera wiring (Section 4.3). Ensure the reverse trigger wire is correctly connected.

For further assistance, please contact customer support.

Installation tips & How to reach us?

A quick test before installation:

1. The red and yellow wires of the car stereo are combined first, then connected to the positive pole of the 12V battery. The black wire is connected to the negative pole of the battery.
2. After 2 seconds, check the car stereo, if the screen lights up, it means that the car stereo is functioning normally. If you test that the car player turns on, but the device does not work after installation, recheck the installation procedure.

Warm tips:

1. Please double-check that the power cable port we provide matches the port of your car
2. No need to connect the all sockets if they don't fit, because the harness may contains spare sockets to match different car model years
3. If the wiring harness is different or the accessories are missing or damaged, please refer them to our CS Department for processing, and we will resend them for you

STEP 1

Add to Cart

Buy Now

Ships from **Amazon**

Sold by **Inefala Direct**

Returns **30-day refund replacement**

Support **Product support included**

How to reach us:

Step 1: Click "Inefala Direct"
Step 2: Click "Ask a question"
Step 3: Please send us questions you met, and attach relevant pictures or videos will help to solve the problem faster!

STEP 2

Have a question for Inefala Direct?

Ask a question

About Seller

Welcome to Inefala store

Why Choose Us?

- Professional Technical Support Team & Customer Service Team to ensure your shopping experience.
- If you encounter any difficulties or doubts in installing or using the products of our store, you can contact our sellers (Inefala) through the Amazon platform or contact our customer service team by email: inefaloservices@163.com
- All messages will be replied within 24 HOURS, regardless of holidays.
- **One Year Warranty** from the beginning to the end of the use...

Image 7.1: Provides quick installation tips and instructions on how to contact customer support via Amazon's 'Ask a question' feature or direct email.

8. SPECIFICATIONS

Feature	Specification
Operating System	Android 15
Processor	8-Core
RAM	4GB
ROM	64GB
Screen Size	9 Inches
Resolution	1280 x 720
Display Type	IPS, 2.5D Glass Touchscreen
Bluetooth Version	5.0
Connectivity	Bluetooth, USB, Wi-Fi
Audio Output Mode	Stereo
Special Features	Wireless/Wired CarPlay & Android Auto, Mirror Link, GPS Navigation, FM/RDS Radio, AHD Reverse Input, Steering Wheel Learning, 36-band EQ, 19 Backgrounds, 59 Desktop Themes, 1080P Video Playback, Split Screen
Item Weight	3.27 pounds
Package Dimensions	13.35 x 10.04 x 5 inches

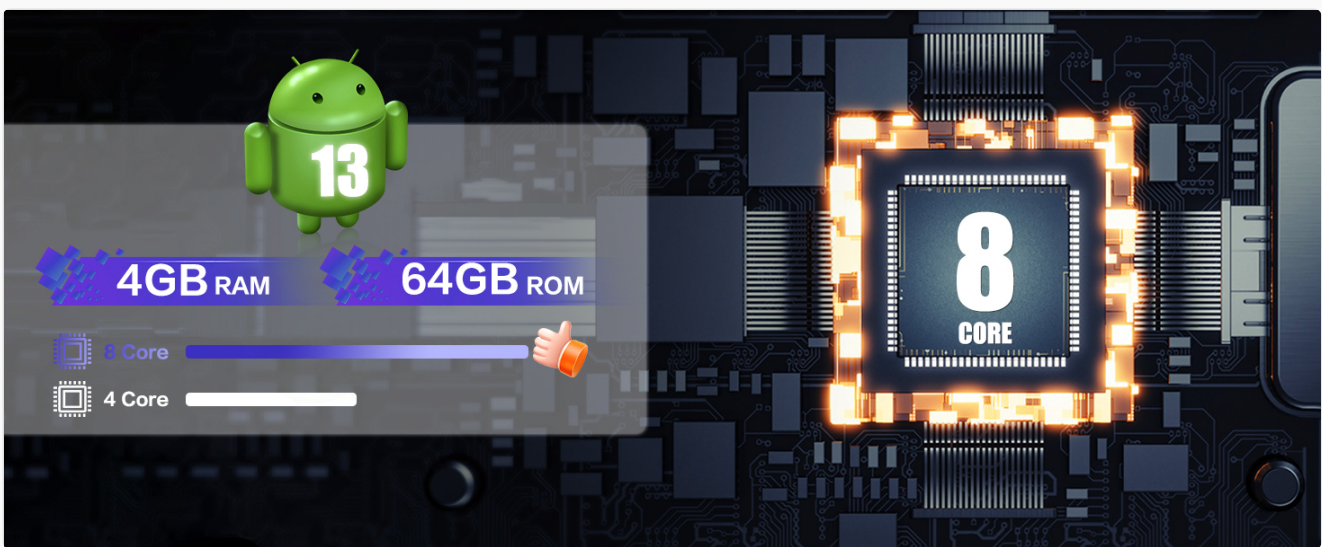

Image 8.1: Highlights the core specifications of the unit, including Android 13 (note: product title states Android 15, this image may be outdated), 8-core processor, 4GB RAM, and 64GB ROM.

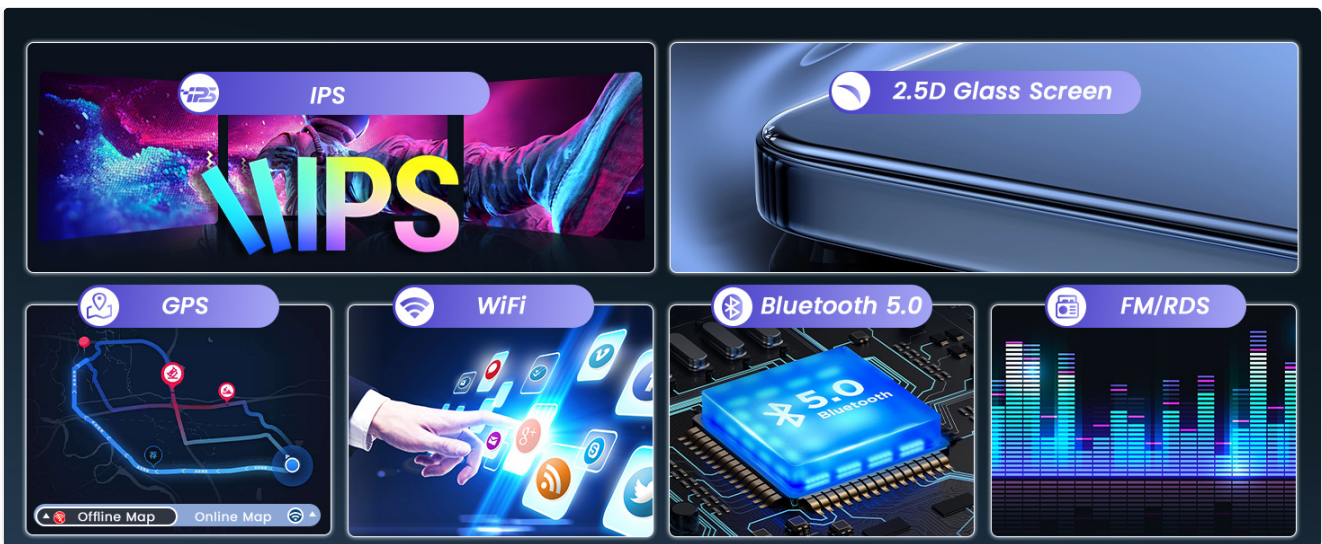

Image 8.2: Illustrates key display and connectivity features such as IPS screen technology, 2.5D curved glass, GPS navigation, Wi-Fi, Bluetooth 5.0, and FM/RDS radio capabilities.



Image 8.3: Showcases advanced functions including a 32-band Digital Sound Processor (DSP), split-screen multitasking, and the 1280x720 high-resolution display.

9. WARRANTY AND SUPPORT

9.1 Warranty Information

This Inefala car stereo unit comes with a **1-year warranty** from the date of purchase. Please retain your proof of purchase for warranty claims.

9.2 Customer Support

If you have any questions, require technical assistance, or need to report missing/damaged accessories, please contact Inefala customer support:

- **Via Amazon:** Go to the product page, click on the seller name ("Inefala Direct"), and then click "Ask a question."
- **Email:** inefalaservices@163.com

Please provide relevant pictures or videos when contacting support to help resolve issues faster.

