

APPASO APS2003

APPASO APS2003 3-Hole Brushed Nickel Kitchen Faucet Instruction Manual

Comprehensive guide for installation, operation, and maintenance of your APPASO kitchen faucet.

1. INTRODUCTION

This manual provides detailed instructions for the installation, operation, and maintenance of your APPASO APS2003 3-Hole Brushed Nickel Kitchen Faucet. Please read this manual thoroughly before installation and use to ensure proper function and longevity of your product.

2. SAFETY INFORMATION

- Always turn off the main water supply before beginning any installation or repair work.
- Wear appropriate personal protective equipment, such as safety glasses and gloves, during installation.
- Ensure all connections are secure to prevent leaks. Do not overtighten.
- If you are unsure about any part of the installation process, consult a qualified plumber.
- Keep small parts away from children to prevent choking hazards.

3. PACKAGE CONTENTS

Verify that all components are present before beginning installation:

PACKAGING

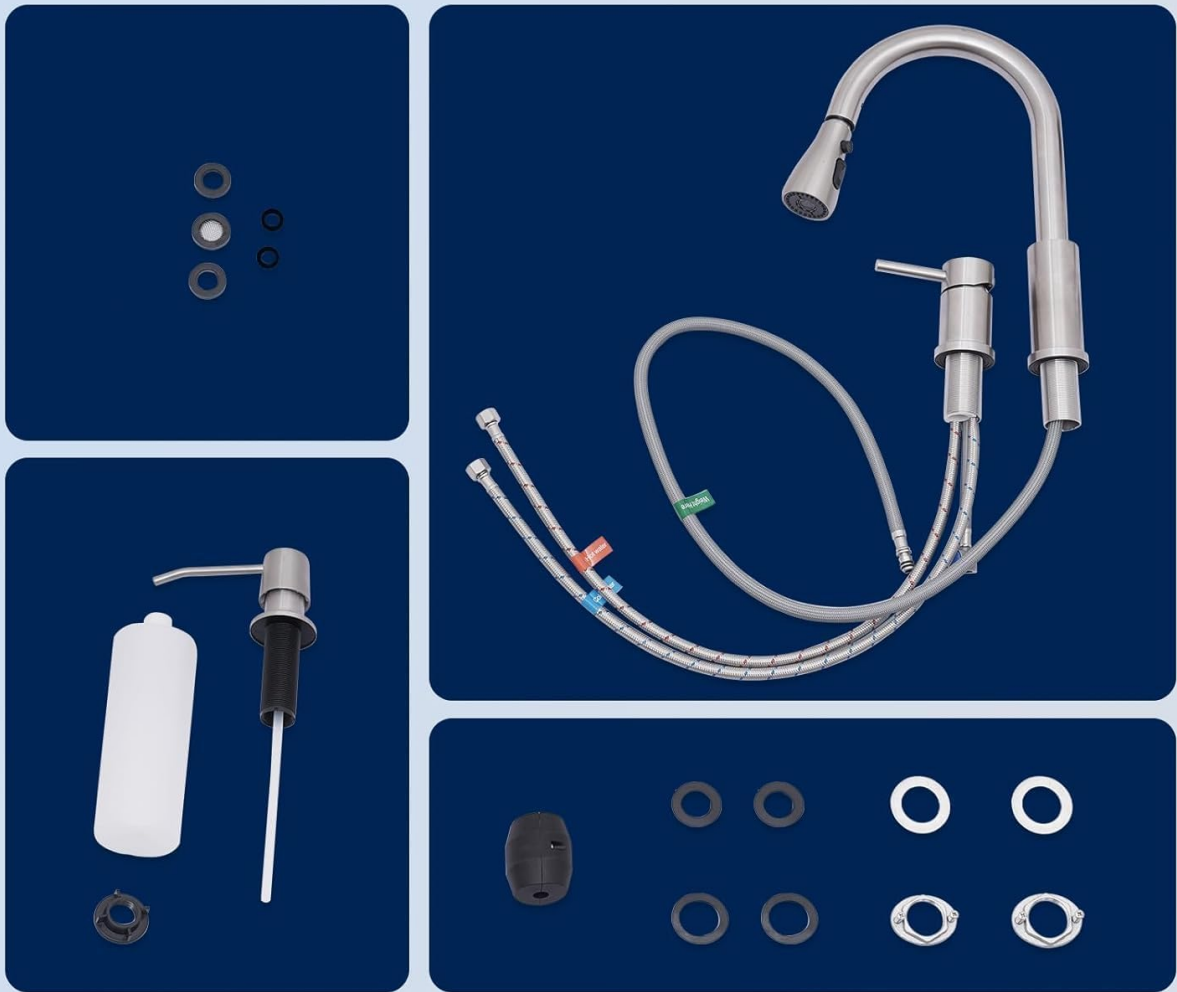

Image: All components included in the APPASO kitchen faucet package, neatly organized in foam inserts.

- Main Faucet Body with Pull-Down Sprayer
- Single Handle
- Soap Dispenser with Bottle
- Hot and Cold Water Supply Lines
- Mounting Hardware (nuts, washers, gaskets)
- Gravity Ball Weight
- Blue Key for Aerator Removal
- Instruction Manual

4. SPECIFICATIONS

Feature	Detail
Brand	APPASO
Model Name	APS2003

Finish Type	Brushed Nickel
Material	S304 Stainless Steel, PEX Hose, ABS Plastic Sprayhead
Mounting Type	2 or 3 hole sink
Hole Count	3
Number of Handles	1
Maximum Flow Rate	1.8 Gallons Per Minute
Hose Length	20 Inches
Spout Reach	6.3 Inches
Product Dimensions	16"D x 3"W x 12"H
Special Features	360 Swivel, Adjustable Hot Limit, Dual Function Sprayer, Leak Resistant, Pull Down Sprayer

SOAP DISPENSER SIZE

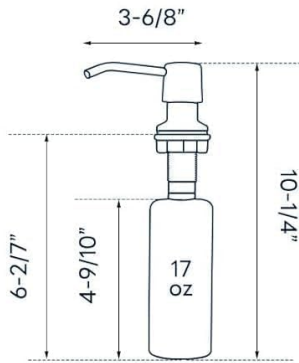

ADDITIONAL INFORMATION



Maximum deck thickness: 2"
(Without deck plate)



Mounting hole size: 1-2/5~1-1/2"



G 3/8

OPTIMAL SIZE

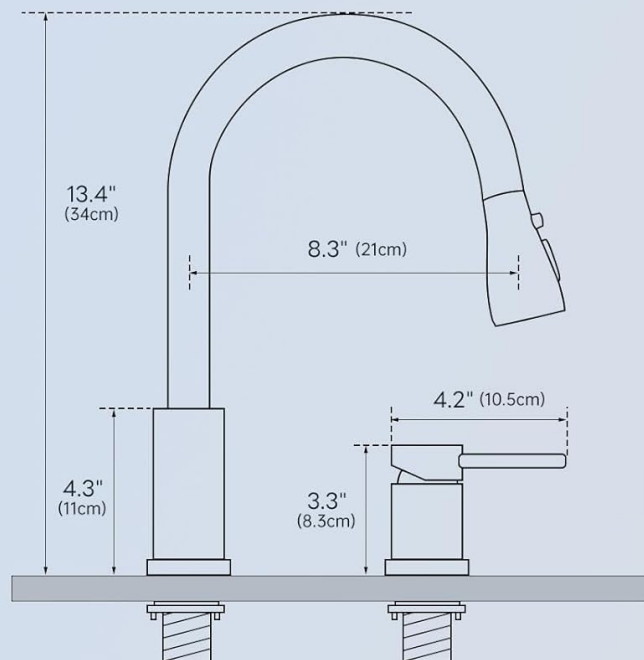

SUITABLE FOR 2 TO 3 HOLES

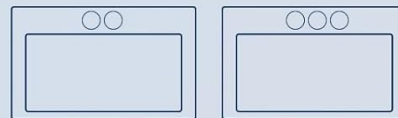

Image: Detailed diagram showing the dimensions of the faucet and soap dispenser, along with mounting hole requirements for 2 or 3-hole sinks.

5. INSTALLATION

5.1 Pre-Installation

- Ensure your sink has either 2 or 3 holes for proper installation.
- Clear the area under the sink and ensure easy access to water supply lines.
- Gather necessary tools: adjustable wrench, screwdriver, plumber's putty or silicone sealant, flashlight.

5.2 Installation Steps

1. **Mount the Faucet:** Insert the main faucet body and handle into the designated holes on your sink or countertop. Secure from underneath with the provided mounting hardware.
2. **Connect Water Supply Lines:** Attach the hot and cold water supply lines to your existing water valves. Ensure a tight, leak-free connection. The faucet features quick-connect fittings for ease of installation.
3. **Install Soap Dispenser:** Insert the soap dispenser pump into its hole and secure the bottle from underneath.

4. **Attach Gravity Ball:** Clip the gravity ball weight onto the pull-down hose under the sink. This ensures the sprayer retracts smoothly.
5. **Test for Leaks:** Turn on the main water supply and check all connections for any leaks. Operate the faucet to ensure proper water flow and temperature control.

Your browser does not support the video tag.

Video: An overview of the APPASO kitchen faucet components and a demonstration of its features, including the pull-down sprayer and soap dispenser. This video highlights the ease of installation and the quality of materials.

Your browser does not support the video tag.

Video: A detailed look at the APPASO 3-hole kitchen faucet, showcasing its design, included accessories like the soap dispenser, and the various spray modes. The video emphasizes the product's quality and ease of use.

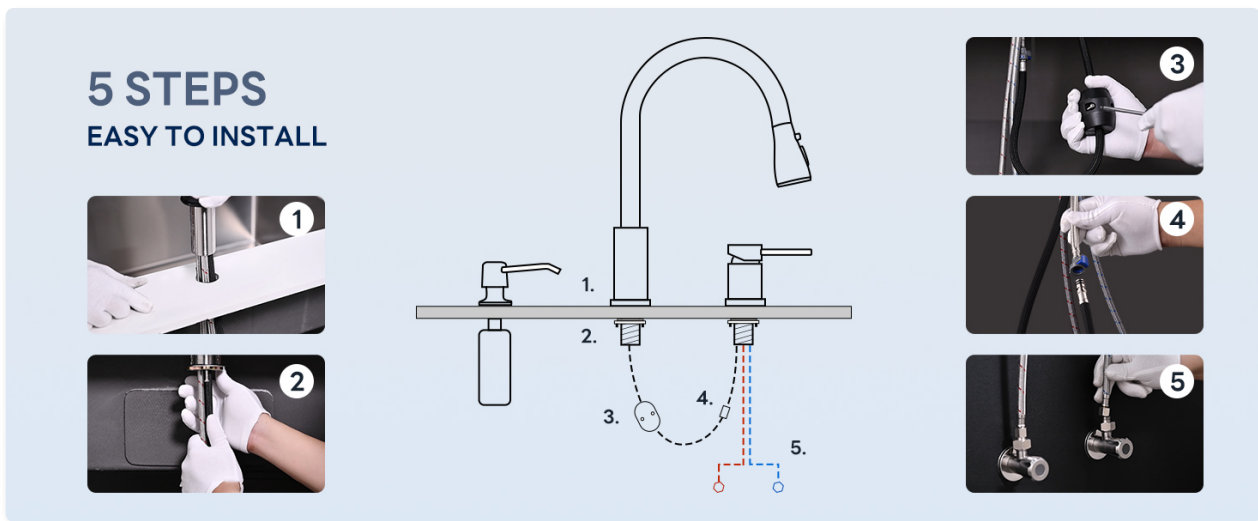

Image: A visual guide illustrating the five easy steps for installing the APPASO kitchen faucet, from mounting to connecting water lines and the soap dispenser.

6. OPERATION

6.1 Water Flow and Temperature Control

The single handle controls both water flow and temperature. Move the handle up to increase water flow and down to decrease it. Rotate the handle left for hot water and right for cold water.



Image: Close-up of the faucet handle, indicating hot (red) and cold (blue) water markings, highlighting the drip-free ceramic valve for smooth operation.

6.2 Pull-Down Sprayer with 3 Modes

The pull-down sprayer offers three distinct spray modes for various tasks:

- **Stream Mode:** Provides a gentle, aerated flow for fast filling of pots and pans, minimizing splashing.
- **Spray Mode:** Delivers a powerful spray for quick rinsing of dishes and produce.
- **Dual Broom Mode:** A strong, concentrated stream designed for effortless removal of stubborn dirt and food residue.

To switch between modes, press the button on the sprayer head. The 20-inch long hose and 360° free rotation allow for extended reach and flexibility.



STREAM
for fast filling

DOUBLE BROOM
for effortless cleaning



SPRAY
for quick rinsing

Image: Visual demonstration of the three spray modes: Stream for fast filling, Double Broom for effortless cleaning, and Spray for quick rinsing.

20 INCH EXTRA LONG PEX HOSE

Making dishwashing and food prep a breeze



Image: The pull-down sprayer extended from the faucet, illustrating the 20-inch hose length and 360-degree swivel capability for enhanced maneuverability.

7. MAINTENANCE

7.1 Cleaning the Faucet

To maintain the brushed nickel finish, clean the faucet regularly with a soft cloth and mild soap. Avoid abrasive cleaners, steel wool, or harsh chemicals, as these can damage the finish.

7.2 Cleaning the Aerator

If water flow becomes restricted or irregular, the aerator may need cleaning. Use the provided blue key to carefully remove the aerator from the sprayer head. Rinse any debris from the aerator screen under running water. Reinstall the aerator securely.

EASY TO CLEAN

For speedy cleaning, use your fingertips.

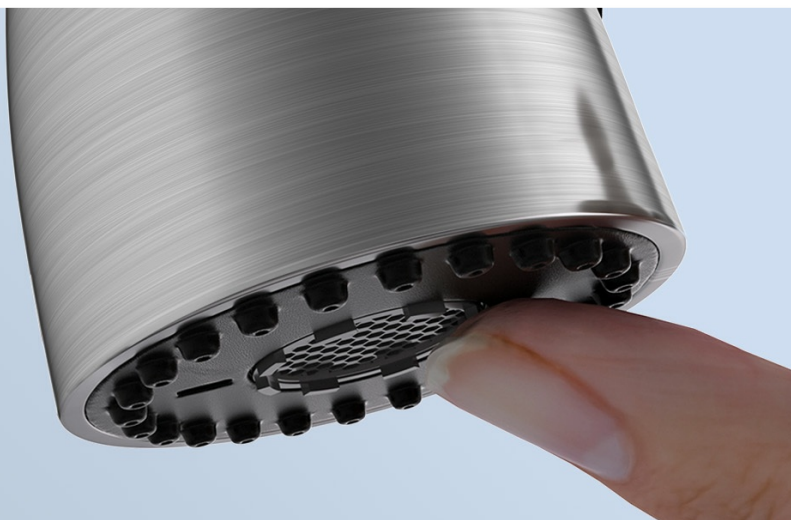

Image: A hand demonstrating the removal of the aerator from the faucet head using the blue key for easy cleaning.







8. TROUBLESHOOTING

Problem	Possible Cause	Solution
Low Water Flow	Clogged aerator; partially closed shut-off valve; kinked supply line.	Clean aerator (see Section 7.2); ensure shut-off valves are fully open; check supply lines for kinks.
Leaks from Faucet Base	Loose mounting nut; worn gasket.	Tighten mounting nut; replace gasket if damaged.
Leaks from Sprayer Head	Loose connection; damaged O-ring.	Ensure sprayer hose is tightly connected; inspect and replace O-rings if necessary.
Sprayer Does Not Retract	Gravity ball weight is misplaced or obstructed.	Adjust the position of the gravity ball weight on the hose; ensure no obstructions under the sink.

9. WARRANTY AND SUPPORT

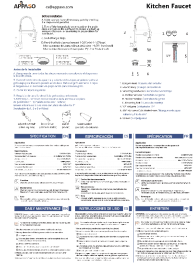
The APPASO APS2003 Kitchen Faucet comes with a limited warranty. For specific warranty details, please refer to the warranty card included in your package or contact APPASO customer support.

For technical assistance, replacement parts, or any other inquiries, please visit the official APPASO website or contact their customer service department.

	<p><u>APPASO Pull-Down Spring Kitchen Faucet: Installation and Care Guide</u></p> <p>Comprehensive installation and care guide for the APPASO Pull-Down Spring Kitchen Faucet. Includes pre-installation steps, detailed installation instructions, maintenance tips, troubleshooting solutions, warranty information, and contact details for APPASO.</p>
	<p><u>APPASO Kitchen Faucet Installation Guide</u></p> <p>Detailed instructions for installing your APPASO kitchen faucet, covering product components, dimensions, installation steps, and maintenance. Includes tips for a successful setup.</p>
	<p><u>APPASO Kitchen Faucet: Installation, Specs & Maintenance Guide</u></p> <p>Detailed installation, usage, and maintenance guide for the APPASO Commercial Pre-Rinse Kitchen Faucet. Covers specifications, parts, step-by-step installation, and cleaning instructions for optimal performance and longevity.</p>
	<p><u>APPASO Pull-Down Kitchen Faucet: Installation and Care Guide</u></p> <p>A comprehensive guide for installing, maintaining, and troubleshooting the APPASO Pull-Down Kitchen Faucet. Includes a detailed parts list, warranty information, and step-by-step instructions.</p>
	<p><u>APPASO Pull Out Kitchen Faucet - Installation and Maintenance Guide</u></p> <p>Detailed guide for the APPASO Pull Out Kitchen Faucet, covering specifications, installation guidance, maintenance procedures, and cleaning tips for optimal performance and longevity.</p>
	<p><u>APPASO Pull-Down Kitchen Faucet Installation and Care Guide</u></p> <p>Comprehensive installation and care guide for the APPASO pull-down kitchen faucet. Includes pre-installation checks, step-by-step installation instructions, maintenance tips, troubleshooting advice, and warranty information.</p>