

Shineforu B02801

Shineforu Ultra-Slim Bidet Attachment Instruction Manual

Model: B02801

1. INTRODUCTION

Thank you for choosing the Shineforu Ultra-Slim Bidet Attachment. This non-electric bidet is designed to provide a refreshing and hygienic cleaning experience with its dual-mode wash functions and adjustable water pressure. This manual provides detailed instructions for proper installation, operation, and maintenance to ensure optimal performance and longevity of your bidet attachment.

2. SAFETY INFORMATION

- Always turn off the water supply to your toilet before beginning installation or performing any maintenance.
- Ensure all connections are tight to prevent leaks. Do not overtighten.
- This product is designed for use with cold water only.
- Do not use abrasive cleaners or harsh chemicals on the bidet attachment, as this may damage the finish or internal components.
- Keep out of reach of children.

3. PACKAGE CONTENTS

Verify that all components are present before beginning installation:

- Bidet Attachment Unit
- T-Adapter (for water connection)
- Braided Metal Hose

- Rubber Washer
- Installation Guide



Image: All components included in the Shineforu Bidet Attachment package.

4. COMPATIBILITY CHECK

Before installation, ensure your toilet is compatible with the bidet attachment. Measure your toilet according to the diagram below:



Will this fit my toilet?

Measure your toilet according to the chart below to see if our bidet will fit your toilet.

MEASUREMENT AREAS	MIN	MAX
A Center Of Toilet To Wall	11.05 in	None
B Center Of Toilet To Edge of Toilet	None	7.75 in
C Distance Between Toilet Screws	4.33 in	7.48 in
D Screw To Edge of Toilet Bowl	1.25 in	3.50 in
E Screw To Toilet Tank	1.00 in	None

Image: Toilet measurement guide for bidet compatibility.

Toilet Measurement Guidelines

Measurement Area	Minimum	Maximum
A: Center Of Toilet To Wall	11.05 in	None
B: Center Of Toilet To Edge of Toilet	None	7.75 in
C: Distance Between Toilet Screws	4.33 in	7.48 in
D: Screw To Edge of Toilet Bowl	1.25 in	3.50 in
E: Screw To Toilet Tank	1.00 in	None

5. INSTALLATION GUIDE

Follow these steps for a quick and easy installation:

1. **Turn off Water Supply:** Locate the water supply valve for your toilet and turn it off completely. Flush the toilet to empty the tank.
2. **Remove Toilet Seat:** Lift the hinge covers and unscrew the bolts holding your current toilet seat to the toilet bowl. Remove the toilet seat.
3. **Assemble Bidet Unit:** If your bidet unit comes in two parts, assemble them by sliding the bidet arm into the mounting plate until it clicks securely.
4. **Position Bidet Attachment:** Place the bidet attachment on the toilet bowl, aligning the mounting holes with the toilet seat bolt holes. Adjust the position of the bidet attachment to ensure the nozzles are centered and clear of the toilet rim.
5. **Reinstall Toilet Seat:** Place your toilet seat back over the bidet attachment and secure it with the original bolts. Ensure the bidet is firmly held in place.
6. **Connect T-Adapter:** Disconnect the existing water supply hose from the toilet tank fill valve. Install the T-adapter onto the toilet tank fill valve. Ensure the rubber washer is correctly seated to prevent leaks.
7. **Connect Bidet Hose:** Connect one end of the braided metal hose to the T-adapter and the other end to the bidet attachment's water inlet. Hand-tighten all connections, then use a wrench for a final quarter-turn to ensure a secure, leak-free seal. Do not overtighten.
8. **Restore Water Supply:** Slowly turn the water supply valve back on. Check for any leaks at all connection points. If leaks occur, tighten the connections slightly.
9. **Test Bidet:** Once installation is complete and there are no leaks, test the bidet functions as described in the Operating Instructions section.

Quick & Easy Installation

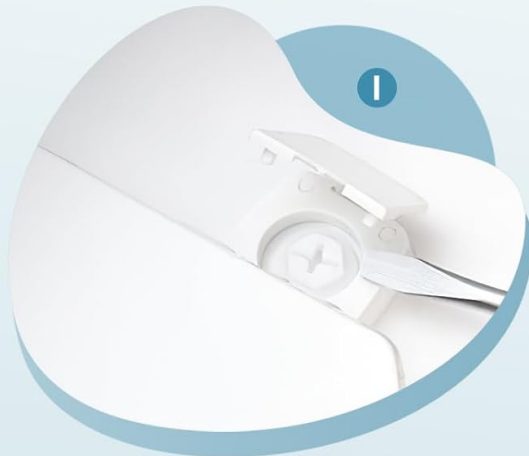

Remove the current toilet seat.



Adjust the brackets and reinstall the toilet seat.

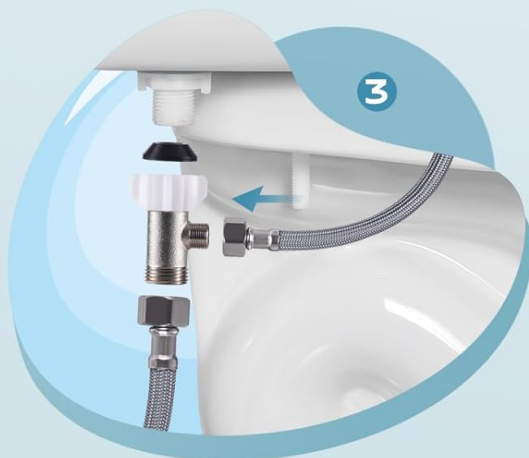

Connect the hose to the brass tee fitting.

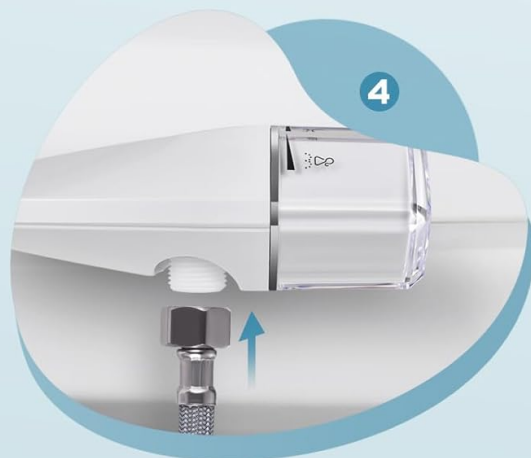

Connect the hose to the bidet.

Image: Quick and easy installation steps.



HOW TO INSTALL?

1. Remove the toilet seat.
2. Install the bidet on the toilet and adjust the angle.
3. Connect the T-adaptor and the water pipe.

NOTE

Please turn off the water valve and empty the toilet tank before installation!



Image: Visual guide for bidet installation.

6. OPERATING INSTRUCTIONS

The Shineforu Bidet Attachment features dual wash modes and adjustable water pressure for a personalized cleaning experience.

6.1. Control Knob

The control knob located on the side of the bidet unit allows you to select the wash mode and adjust water pressure.



Image: Bidet control knob for mode selection and pressure adjustment.

6.2. Dual Wash Modes

- **Rear Wash:** Rotate the control knob towards the 'Rear Wash' icon for posterior cleaning.
- **Feminine Wash:** Rotate the control knob towards the 'Feminine Wash' icon for a gentler, wider spray suitable for feminine hygiene.

Feminine/Rear Wash Modes



Image: Illustration of Rear Wash and Feminine Wash spray patterns.

6.3. Water Pressure Control

The water pressure can be adjusted by rotating the control knob. Turn it slowly to increase or decrease the water intensity to your preference. Return the knob to the 'OFF' position to stop the water flow.

6.4. Retractable Nozzles and Protective Guard Gate

The bidet features self-cleaning, retractable nozzles that extend only when in use and retract when the water is turned off, ensuring hygiene. A protective guard gate further shields the nozzles from debris when not in operation.

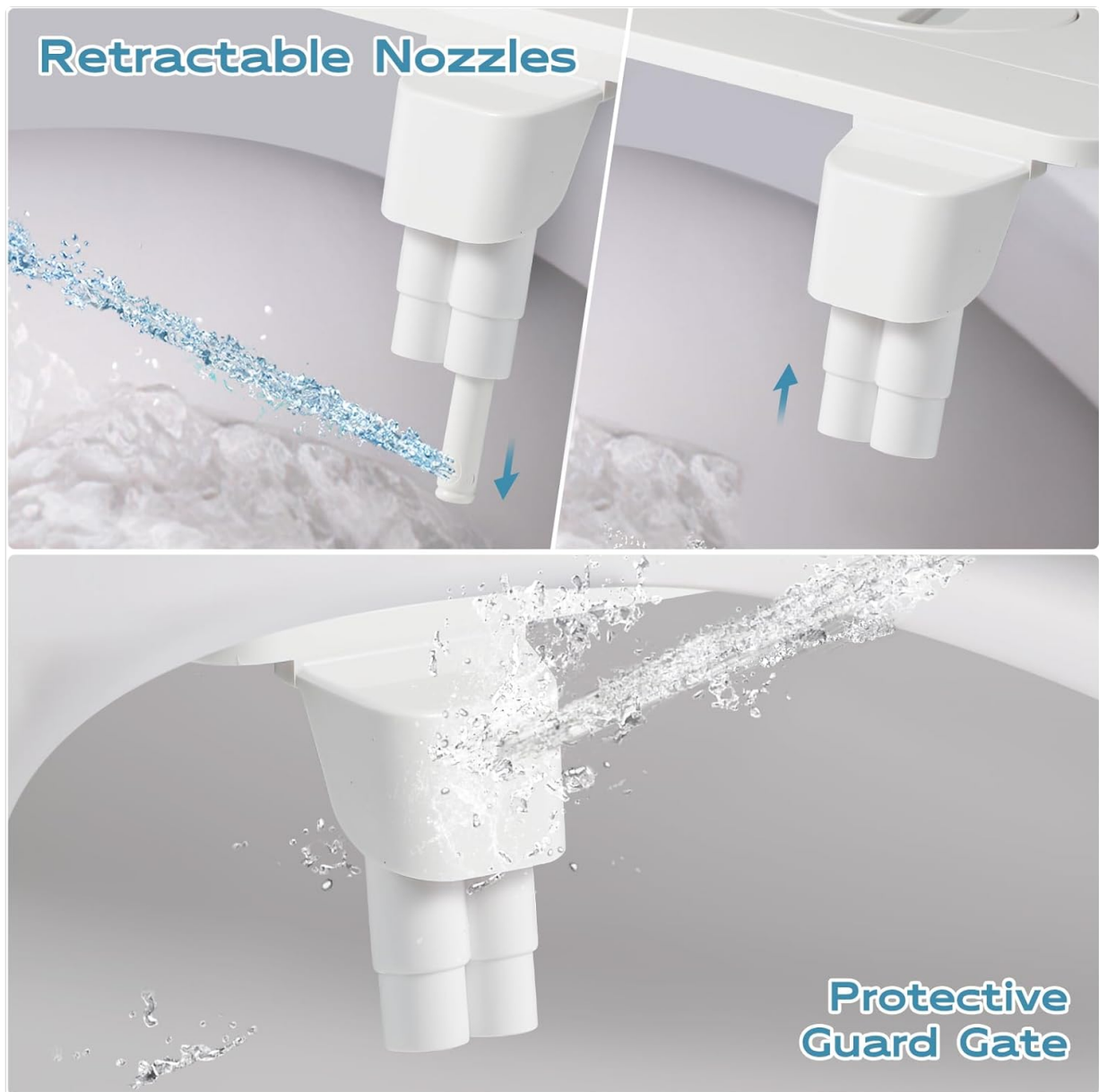

Image: Retractable nozzles and protective guard gate mechanism.

7. MAINTENANCE

Regular cleaning will help maintain the hygiene and performance of your bidet attachment.

- **Exterior Cleaning:** Wipe the exterior of the bidet attachment with a soft, damp cloth and a mild, non-abrasive cleaner. Do not use harsh chemicals, bleach, or abrasive pads.
- **Nozzle Cleaning:** The nozzles are self-cleaning. To manually clean, gently pull them down and wipe with a soft cloth or brush. Do not force the nozzles.
- **Deep Cleaning:** Periodically, you may wish to remove the bidet attachment for a more thorough cleaning of the toilet bowl and the bidet unit itself. Ensure the water supply is turned off before removal.

8. TROUBLESHOOTING

If you encounter issues with your bidet attachment, refer to the following common problems and solutions:

Troubleshooting Guide

Problem	Possible Cause	Solution
Water Leakage	Loose connections, missing/damaged washer, overtightened connections.	Ensure all connections are hand-tightened, then a quarter-turn with a wrench. Check for properly seated rubber washers. Do not overtighten. Apply plumber's tape if necessary.
No Water Spray / Weak Spray	Water supply valve closed, low household water pressure, clogged nozzles.	Ensure the toilet's water supply valve is fully open. Check household water pressure. Clean nozzles if clogged.
Nozzles Not Retracting	Debris obstructing nozzle movement, internal mechanism issue.	Gently clean around the nozzles to remove any debris. If the issue persists, contact customer support.
Water Sprays Incorrectly	Bidet not properly aligned, nozzle guard not clicked into place.	Ensure the bidet attachment is correctly positioned on the toilet bowl. Check if the nozzle guard is fully extended and clicked into its operational position.

9. SPECIFICATIONS

Product Specifications

Feature	Detail
Model Number	B02801
Product Dimensions	6.3 x 2.2 x 13 inches
Item Weight	1.16 Pounds
Power Source	Non-Electric (Water Pressure Operated)
Wash Modes	Feminine Wash, Rear Wash
Nozzle Type	Dual, Retractable, Self-Cleaning
Water Temperature	Cold Water Only

10. WARRANTY AND SUPPORT

The Shineforu bidet attachment comes with an **18-month warranty** from the date of purchase. This warranty covers manufacturing defects and malfunctions under normal use.

For warranty claims, technical assistance, or any questions regarding your product, please contact our customer support team:

- **Email:** support@shineforu.com

- **Website:** www.shineforu.com/support

Please have your model number (B02801) and purchase information ready when contacting support.
